

GLIM CUBE ALCOVE

I.BA99, I.BB01

PAGE 1 OF 1

LAST UPDATE: FEBRUARY 11, 2013

FIXTURE INSTALLATION

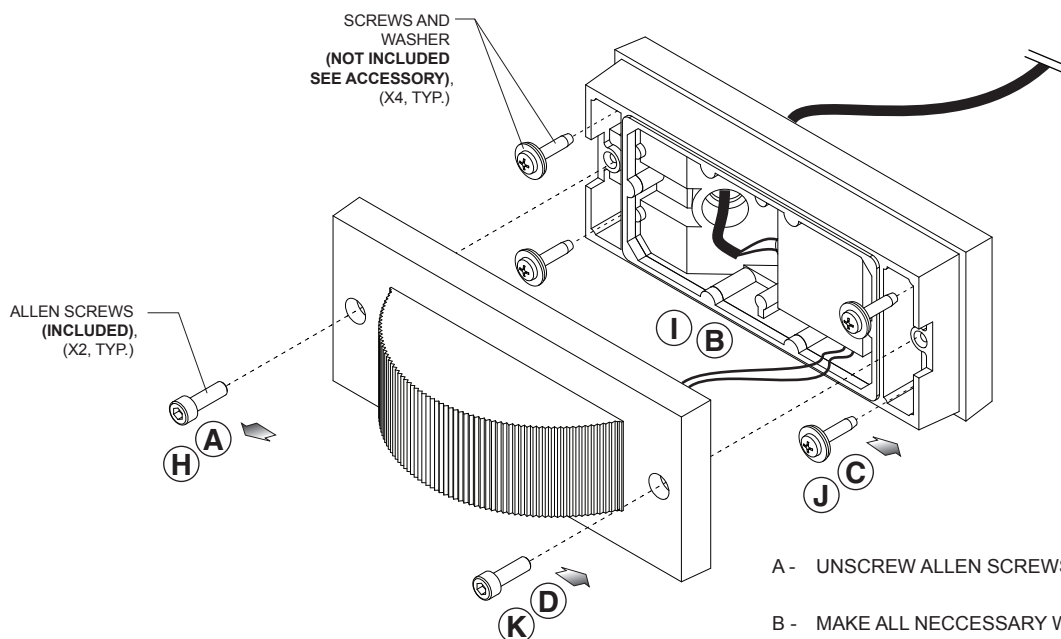

- A - UNSCREW ALLEN SCREWS AND OPEN FIXTURE (X2, TYP.).
- B - MAKE ALL NECESSARY WIRE CONNECTIONS.
- C - SECURE LAMP FIXTURE TO WALL USING SCREWS AND WASHER (X4, TYP.) **(NOT INCLUDED SEE ACCESSORY)**.
- D - CLOSE FIXTURE BY TIGHTENING ALLEN SCREWS (X2, TYP.), **(INCLUDED)** USING ALLEN HEAD KEY.

ACCESSORY INSTALLATION

- E - PASS WIRE THROUGH THE MOUNTING PLATE.
- F - INSTALL MOUNTING PLATE ON JUNCTION BOX USING MOUNTING SCREWS **(BY OTHERS)**, (X2, TYP.).
- G - FIX MOUNTING PLATE ON WALL USING PLATE SCREWS **(INCLUDED)**, (X2, TYP.).
- H - UNSCREW ALLEN SCREWS AND OPEN FIXTURE (X2, TYP.).
- I - MAKE ALL NECESSARY WIRE CONNECTIONS.
- J - ALIGN LAMP FIXTURE TO MOUNTING PLATE AND SECURE USING SCREWS AND WASHER (X4, TYP.), **(INCLUDED)**.
- K - CLOSE FIXTURE BY TIGHTENING ALLEN SCREWS (X2, TYP.), **(INCLUDED)** USING ALLEN HEAD KEY.

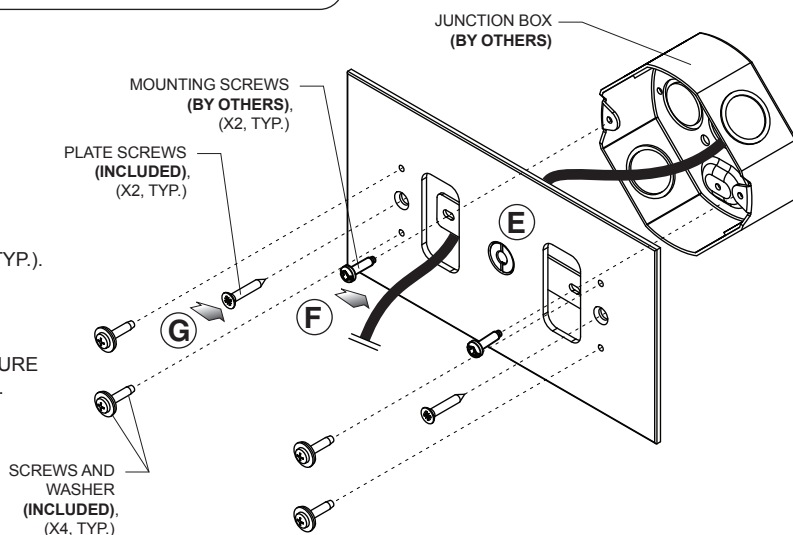

THIS PRODUCT MUST BE INSTALLED IN ACCORDANCE WITH THE APPLICABLE INSTALLATION CODE BY A PERSON FAMILIAR WITH THE CONSTRUCTION AND OPERATION OF THE PRODUCT AND THE HAZARDS INVOLVED.

MGD - R0
APP. BY: **MAB**



5455 de Gaspé
suite 100, Montréal (Québec)
Canada H2T 3B3
P.: 514.523.1339 F.: 514.525.6107

SISTEMALUX
GROUP

GLIM CUBE
ALCOVE