



## HUNTINGTON 1 - RECESSED

# LoPro

Brilliant by Design™, the Huntington 1 Recessed LoPro is sure to level up your space. Our patent pending Microstructure EdgeTech Optics™ (MEO) technology delivers unparalleled optic control, low glare visual comfort, exceptional performance, seamless illumination, and uniformity in unprecedented low-profile behind ceiling depths. Lens gaps, pixelation and hot spots are a thing of the past with our innovative Dual Lens Edge-lit MEO™ technology.

## FEATURES

- Low profile depth behind ceiling for use in any plenum installation:
  - 1.5" - 1.75" Depth (Remote Driver)
  - 2.14" - 2.45" Depth (Integral Driver)
- Design without compromise: Specify Batwing, Glare Control, Diffused (Lambertian) or Wall Wash Optics
- Specified Lumen Outputs (SLO) available: 193 lm/ft - 1480 lm/ft
- Minimalistic 1.5" Aperture
- Individual fixture lengths and seamless continuous runs with no lens breaks up to 500 feet
- Achieve up to 16 feet on center spacing with 35fc on work surface
- Drivers, wiring and serviceability completely accessible from below ceiling with our patent pending toolless "Push to Eject" system
- Toolless Latch System and Quick-Click 5 Wire system allows for simple, quick, and seamless installation
- Trim Flange, Spackle Flange, 15/16" or 9/16" Grid Lay-in 15/16" or 9/16" Grid Tegular, Bolt Slot or Armstrong Interlude/USG Identitee
- Proudly crafted in Huntington Beach, CA - USA

## HUNTINGTON 1 LINEUP

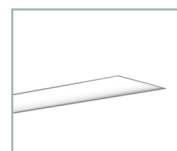

RECESSED

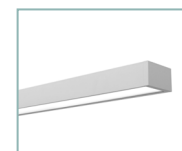

SURFACE

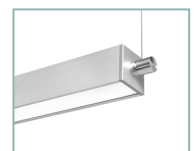

SUSPENDED

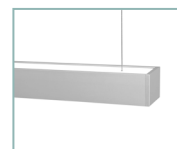

SUSPENDED  
DIRECT | INDIRECT

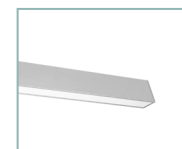

WALL | ARM  
DIRECT | INDIRECT



WALL | ARM

## PERFORMANCE OVERVIEW

4' Huntington 1 Direct - 3500K 80CRI - MEODF				
Lumen Output	LL (Low)	ML (Medium)	HL (High)	SLO* (Specified)
Delivered Lumens	772	1908	3760	772-5920
Consumed Wattage	7	18	38	7.3 - 65.6
Efficacy (lm/W)	105	105	99	90-105
SDCM	3	3	3	3

\*Specified Lumen Output (SLO) available in customizable lumen configurations (896 lm - 6852 lm). See SLO Configurator at [ExtantLighting.com](https://www.extantlighting.com)



## Ordering Information

PROJECT \_\_\_\_\_ TYPE \_\_\_\_\_  
PRODUCT \_\_\_\_\_ QTY \_\_\_\_\_

Product Family	Driver Location	Trim	Length
HTG-1R-LP Huntington Series 1.5" Aperture (Recessed - LoPro)	<input type="checkbox"/> <b>TD</b> Integral Driver	<b>TRIM FLANGE</b>	<input type="checkbox"/> ____* Specify length in 1 foot increments
	<input type="checkbox"/> <b>RD</b> Remote Driver	<input type="checkbox"/> <b>TFSA</b> Trim Flange - Silver Anodized <input type="checkbox"/> <b>TFWP</b> Trim Flange - Matte White <input type="checkbox"/> <b>TFBP</b> Trim Flange - Matte Black <input type="checkbox"/> <b>TFCC</b> Trim Flange - Custom Color  <b>TRIMLESS</b> <input type="checkbox"/> <b>SF</b> Spackle Flange (Mud-in)  <b>T-GRID</b> <input type="checkbox"/> <b>L1*</b> 15/16" Grid Lay-in <input type="checkbox"/> <b>L9*</b> 9/16" Grid Lay-in <input type="checkbox"/> <b>T1*</b> 15/16" Grid Tegular <input type="checkbox"/> <b>T9*</b> 9/16" Grid Tegular <input type="checkbox"/> <b>SB*</b> Bolt Slot Grid <input type="checkbox"/> <b>AI*</b> Armstrong Interlude/ USG Identitee <small>*White finish is standard on all T-Grid (Suspended Ceiling) trim options (L1, L9, T1, T9, SB and AI)</small>	<input type="checkbox"/> <b>R_x_</b> Rectangle <input type="checkbox"/> <b>L_x_</b> L Pattern <input type="checkbox"/> <b>U_x_x_</b> U Pattern  <input type="checkbox"/> <b>C_W_</b> Ceiling to Wall Transition Example: C14"W12" <input type="checkbox"/> <b>CP</b> Custom Pattern  <small>*Minimum Integral Driver length is 2'. Minimum Remote Driver lengths can be shorter, consult factory. Custom length fixtures can be ordered in 3" increments. Any length over 8' requires multiple fixture segments.</small>

Lumen Output	Optics	Color Temp	Voltage
<input type="checkbox"/> <b>DLL</b> Low (193 lm/ft @ 1.84 W)* <input type="checkbox"/> <b>DML</b> Medium (477 lm/ft @ 4.55 W)* <input type="checkbox"/> <b>DHL</b> High (940 lm/ft @ 9.46 W)* <input type="checkbox"/> <b>SLO-xx</b> *Specified Lumen Output available. (193 lm/ft - 1480 lm/ft)  <small>*Delivered lumen output &amp; consumed wattage based on "MEODF 835" (80 CRI - 3500K). See SLO Configurator for alternate outputs.</small>	<b>MEO</b> <input type="checkbox"/> <b>MEODF</b> Diffusing <input type="checkbox"/> <b>MEOBW</b> Batwing <input type="checkbox"/> <b>MEOGC</b> Glare Control <input type="checkbox"/> <b>MEOWW</b> Wall Wash (33° off Nadir)	<b>80+ CRI</b> <input type="checkbox"/> <b>830</b> 3000K <input type="checkbox"/> <b>835</b> 3500K <input type="checkbox"/> <b>840</b> 4000K  <b>90+ CRI</b> <input type="checkbox"/> <b>927</b> 2700K <input type="checkbox"/> <b>930</b> 3000K <input type="checkbox"/> <b>935</b> 3500K <input type="checkbox"/> <b>940</b> 4000K <input type="checkbox"/> <b>XX</b> Optional Color Temp & CRI Available	<input type="checkbox"/> <b>VU</b> 120V-277V <input type="checkbox"/> <b>V3</b> 347V

Driver	Options
<input type="checkbox"/> <b>D'_</b> 1% 0-10V <input type="checkbox"/> <b>DN</b> NON DIM <input type="checkbox"/> <b>DL5</b> Lutron 5-Series EcoSystem <input type="checkbox"/> <b>DL1</b> Lutron Hi-Lume 1% EcoSystem <input type="checkbox"/> <b>DL2</b> Lutron Hi-Lume 1% 2-wire (120V only) <input type="checkbox"/> <b>DE*</b> .1% 0-10V <input type="checkbox"/> <b>DD1</b> 1% DALI <input type="checkbox"/> <b>DDE</b> .1% DALI <input type="checkbox"/> <b>XX</b> Other (Please Specify)  <small>*Dim to Off available. Please Specify "-OFF" next to driver option if required.</small> <small>*1% minimum dimming level and other custom dimming levels and settings available. Consult factory.</small>	<input type="checkbox"/> <b>EMB_*</b> Emergency Battery Pack(s) <input type="checkbox"/> <b>EMC_*</b> Emergency Circuit(s) <input type="checkbox"/> <b>SOC *</b> Occupancy Sensor <input type="checkbox"/> <b>SDL*</b> Daylight Sensor <input type="checkbox"/> <b>2C</b> 2 Circuit (Direct Light and Indirect Light Controlled Independently) <input type="checkbox"/> <b>BCS*</b> Brilliant Communications Solutions (wired/wireless) <input type="checkbox"/> <b>CP</b> Chicago Plenum Approved <input type="checkbox"/> <b>JA8</b> JA8 Compliant <input type="checkbox"/> <b>QAF</b> Extant Express 9-Day Quick Ship  <small>EMB: Specify quantity of battery packs. Minimum 4' unit.  Note: Remote Driver (RD) fixtures will have remote battery packs. Integral Driver (TD) fixtures will require a deeper housing. (See Page 7 for Details)  EMC: Specify quantity of emergency circuits.  SOC &amp; SDL: Specify spacing/location of sensors(s).  BCS: includes wired and wireless integration from our partners at nLight™, Enlighted, Legrand, Crestron, Osram, Lutron and many more. Contact Extant for details.</small>



## Dimensions

### TF - TRIM FLANGE

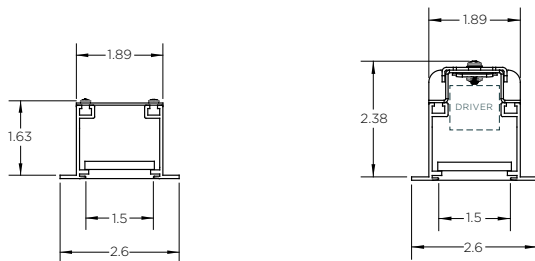

REMOTE

INTEGRAL

### SF - SPACKLE FLANGE

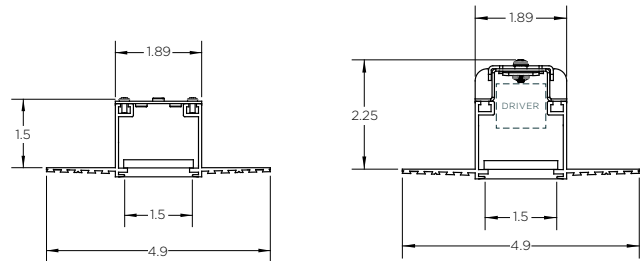

REMOTE

INTEGRAL

### L1 - 15/16" GRID LAY-IN

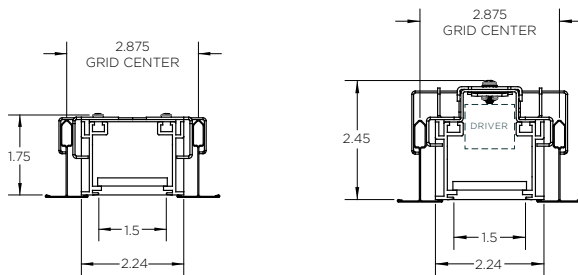

REMOTE

INTEGRAL

### L9 - 9/16" GRID LAY-IN

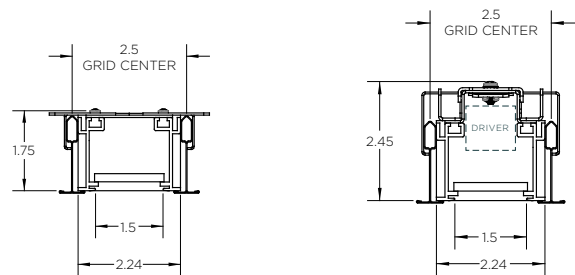

REMOTE

INTEGRAL

### T1 - 15/16" GRID TEGULAR

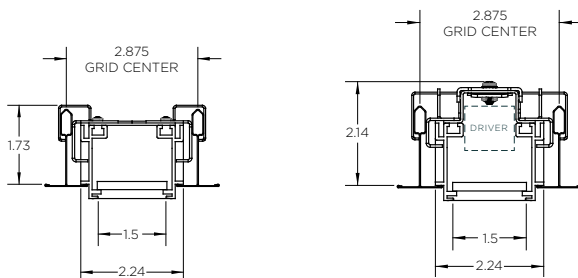

REMOTE

INTEGRAL

### T9 - 9/16" GRID TEGULAR

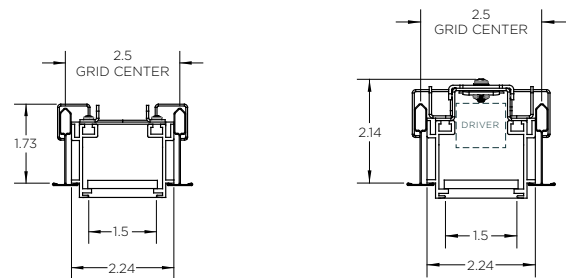

REMOTE

INTEGRAL

### SB - BOLT SLOT GRID

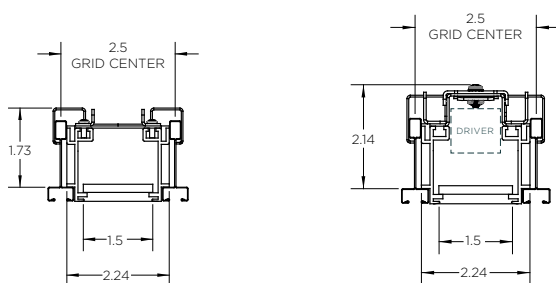

REMOTE

INTEGRAL

### AI - ARMSTRONG INTERLUDE/ USG IDENTITEE

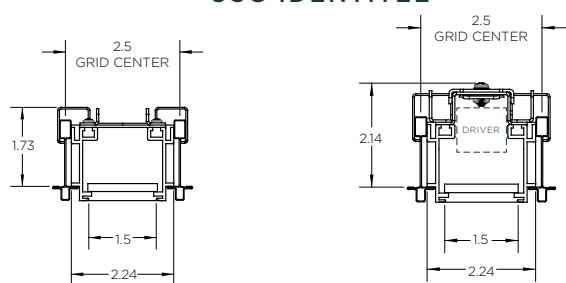

REMOTE

INTEGRAL

T-GRID FIXTURES WILL ALWAYS SIT LEVEL  
WITH CEILING TILE



## Specifications

**Construction** Heavy gauge 6063 extruded aluminum housing.

**Optics** Microstructure EdgeTech Optics (MEO)<sup>TM</sup> utilizes high efficiency Microstructure Lenses and Light Guide Plates for high optical extraction and precise light management. Specify Batwing, Glare Control, Diffused or Wall Wash Optics.

**Light Output** (3) Standard lumen packages are available: Low (DLL), Medium (DML) and High (DHL). Specified Lumen Output (SLO) packages available. Please see the (SLO) configurator at [ExtantLighting.com](http://ExtantLighting.com).

**LEDs** Latest generation of premium Nichia 3-step MacAdam Ellipse LED's available in (90+ CRI) 2700K, 3000K, 3500K, 4000K or (80+ CRI) 3000K, 3500K or 4000K. LED modules are easily accessible and replaceable.

**Voltage** Universal 120/277V (VU) and 347V (V3) available. Consult factory for driver options when 347V is specified.

**Emergency Battery** Factory provided low profile 10W emergency battery for UL924 required 90-minute run time (optional).

**Finish** Standard finishes include silver anodized, powder coated white or powder coated black. Powder coated white finish standard on all T-Grid trim options. Custom colors available.

**Continuous Rows** Innovative Toolless Latch System and Quick-Click 5-Wire System ensures simple installation. Seamless continuous rows with no lens breaks, pixelation or hot spots up to 500 feet.

**Patterns** Standard Rectangle Pattern (R), U Pattern (U), and L Pattern (L) available.

**Mounting** Trim Flange, Spackle Flange, 15/16" or 9/16" Grid Lay-in, 15/16" or 9/16" Grid Tegular, Bolt Slot or Armstrong Interlude/USG Identitee.

**Approvals** UL and cUL Listed. Approved for Dry/Damp locations. IC Rated. Made in the USA. Chicago Plenum Approved. JA8 Compliant.

**Lumen Maintenance** (L70) 70% of initial light output = Reported > 60,000 hours | Calculated > 200,000 hours (L90) 90% of initial light output = Reported > 60,000 hours | Calculated > 200,000 hours.

**Warranty** HTG 1 offered with a 5-year limited warranty. 5-year limited warranty covers LED, driver and fixture. For further details, refer to General Warranty and Obligations at [ExtantLighting.com](http://ExtantLighting.com).

**Patents** Extant Lighting's intellectual property is protected under Patent Pending Status by the U.S. Patent Office.

\* Due to our culture of always striving for product enhancement, specifications and information within this document are subject to change without notice. 2020 Extant Lighting, Inc. All rights reserved.

## Patterns

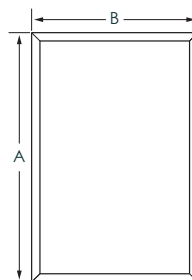

R\_\_X\_\_  
Rectangle  
Provide Ax B  
Example: R6'x4'

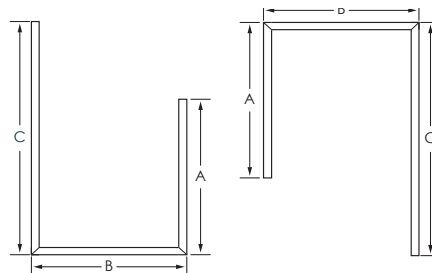

U\_\_X\_\_X\_\_  
U-Shape  
Provide Ax BxC  
Example: U6'x4'x4'

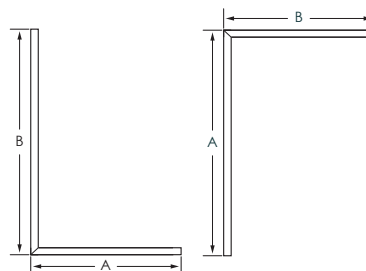

L\_\_X\_\_  
L-Shape  
Provide Ax B  
Example: L6'x4'

**Note:** All miters/patterns shown and ordered in Plan View.

## Microstructure EdgeTech Optics (MEO)™

Our innovative MEO™ design utilizes high efficiency Microstructure Lenses and Light Guide Plates for high optical extraction and precise light management. MEO™ delivers exceptional light quality with seamless illumination and uniformity with no pixelation, hot spots or lens breaks up to 500' continuous rows.

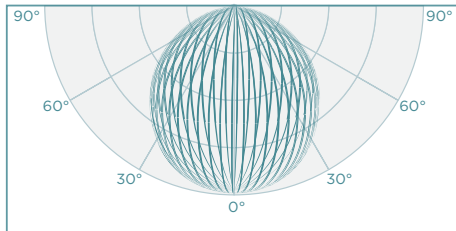

**MEO DF**  
LAMBERTIAN

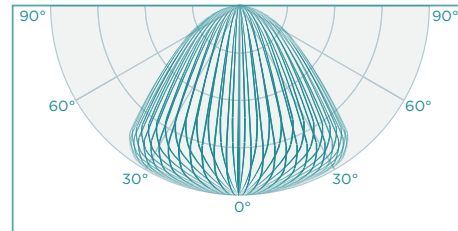

**MEO GC**  
GLARE CONTROL

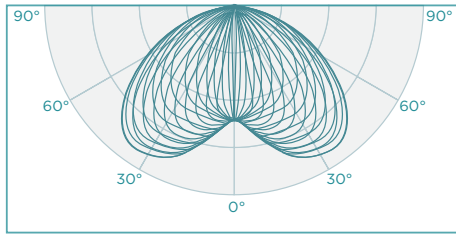

**MEO BW**  
BATWING

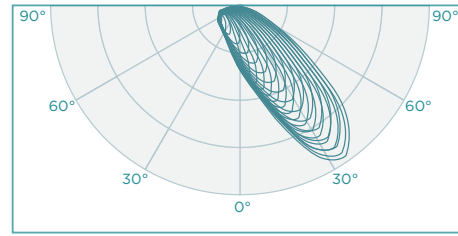

**MEO WW**  
WALL WASH



## Thoughtful Engineering...

Thoughtful engineering is at the core of all of our fixture designs. All of our products are thoughtfully engineered and include innovative features that create a sophisticated fixture that is also contractor friendly and easy to install and service.

### PUSH AND EJECT SYSTEM

Innovative "Push and Eject" System allows for toolless removal and installation of the Light Guide Plate. This thoughtful engineering creates easy access into the housing for simple installation and serviceability.

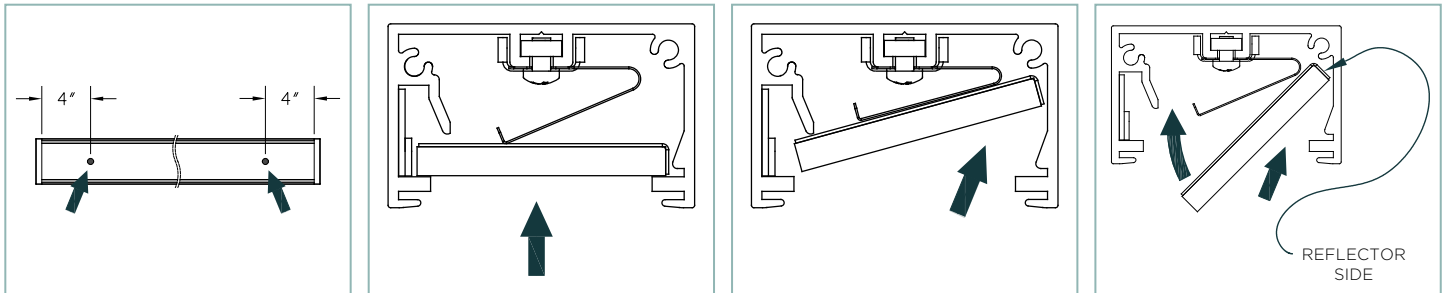

### TOOLLESS LATCH SYSTEM

Our Toolless Latch System is designed to securely connect the extrusions of the continuous runs without the use of any tools, screws or external parts. Our innovative design allows the contractor to perfectly align the extrusion with the built-in alignment pins and cinch up the extrusion with the Toolless Latch System for a tight fit. The Toolless Latch System eliminates gaps and ensures perfect alignment.

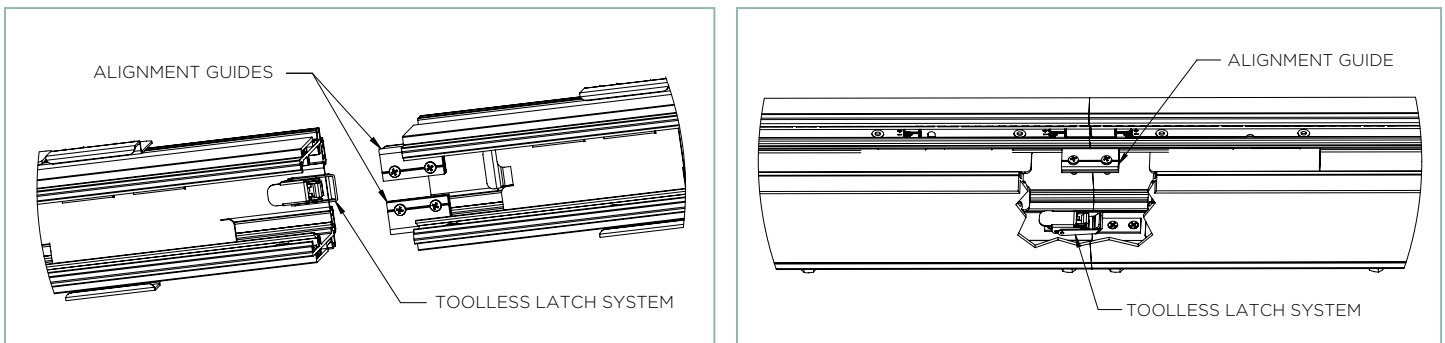

### QUICK-CLICK 5-WIRE SYSTEM

Our Quick-Click 5-Wire System connects all continuous run through wiring with a simple push and click connection. The Quick-Click System is contractor friendly and decreases installation time and cost and ensures proper wiring.

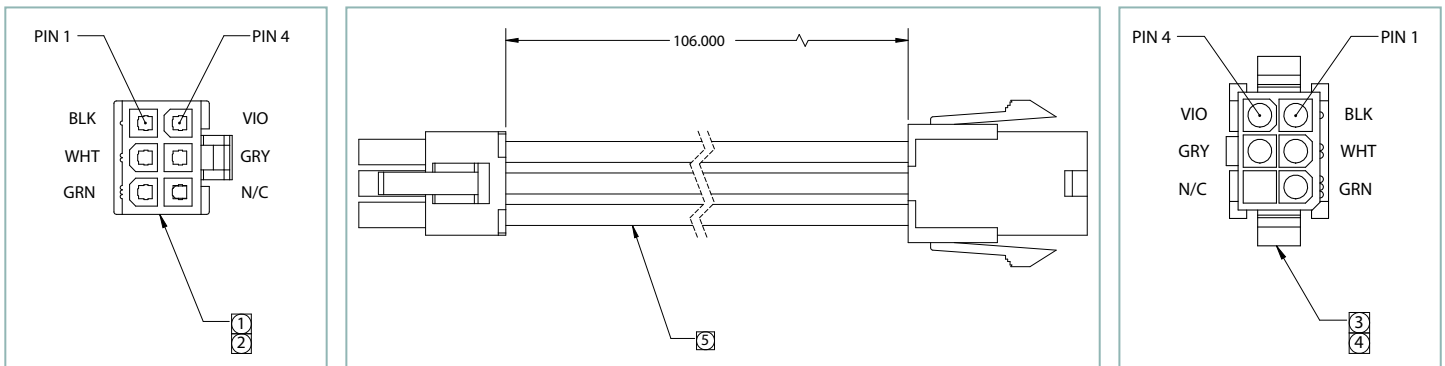

## Dimensions - EMB Fixtures

The dimensions shown below are only for recessed fixtures that contain an Emergency Battery Pack. Dimensions for all fixtures that do not include an EMB can be found on page 3.

### T-GRID

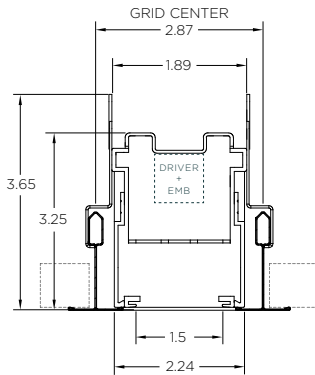

L1 - 15/16" Grid Lay-in

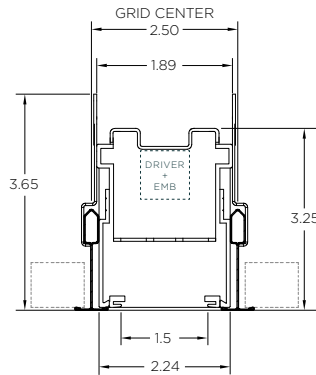

L9 - 9/16" Grid Lay-in

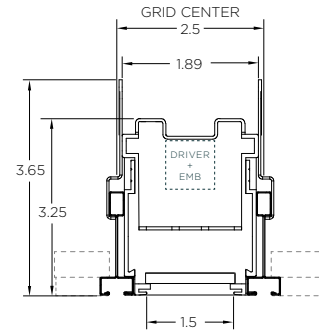

SB - Bolt Slot Grid

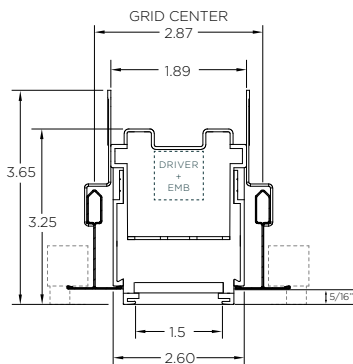

T1 - 15/16" Grid Tegular

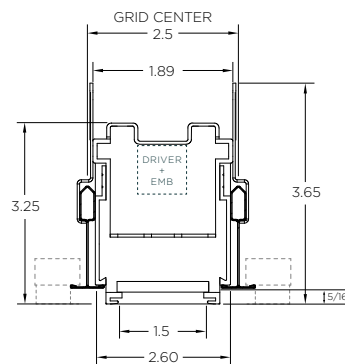

T9 - 9/16" Grid Tegular

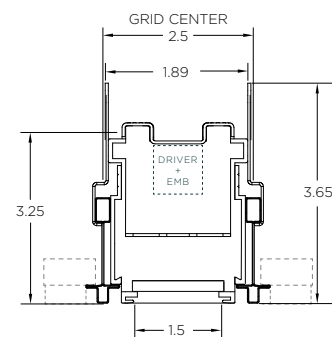

AI - Armstrong Interlude/  
USG Identitee

### FLANGE

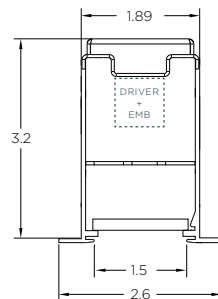

TF - Trim Flange

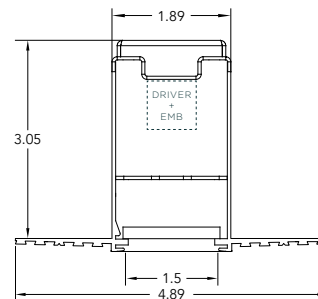

SF - Spackle Flange

