

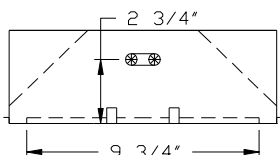

CERTIFIED TEST REPORT No. 26733

FINELITE - 1' X 2' FLUORESCENT RECESSED LUMINAIRE, CAT# HPR-x-1X2-1FT40-DCO
WHITE REFLECTOR, FROSTED PLASTIC SIDE AND CENTER LENS
ONE SYLVANIA 40 WATT CFL LAMP, CAT# FT40DL/835/RS. LUMEN RATING = 3150 LMS.
ONE SYLVANIA QHE1X40DL/UNV ISN SC BALLAST OPERATING AT 120 VAC AND 34.5 WATTS

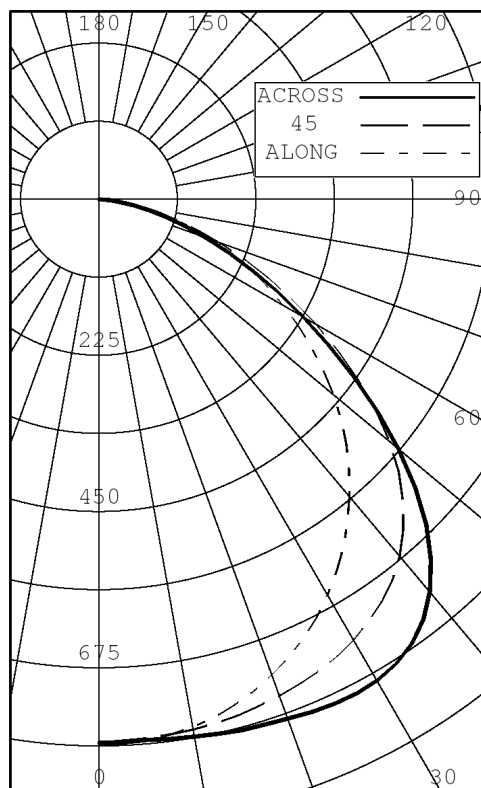

LUMINANCE SUMMARY CD./SQ.M.

ANGLE	ALONG	45	ACROSS
45	5124	6318	6801
55	4681	5736	5640
65	4064	4564	4176
75	3230	3239	2847
85	2075	1417	1347

INTENSITY (CANDLEPOWER) SUMMARY OUTPUT LUMENS

ANGLE	ALONG	22.5	45	67.5	ACROSS	
0	783	783	783	783	783	
5	783	782	780	781	782	76
10	772	773	776	783	786	
15	754	758	770	785	792	218
20	728	737	760	785	796	
25	696	712	749	786	802	345
30	656	680	732	780	800	
35	610	643	707	761	782	438
40	558	599	670	722	738	
45	501	546	616	654	663	459
50	439	484	543	561	561	
55	372	413	454	451	446	385
60	304	337	357	344	337	
65	238	261	266	250	243	253
70	174	189	185	170	165	
75	116	123	116	105	102	121
80	65	68	60	52	50	
85	25	24	17	16	16	25
90	0	0	0	0	0	

ZONAL LUMENS AND PERCENTAGES

ZONE	LUMENS	% LAMP	% LUMINAIRE
0-30	639	20.27	27.53
0-40	1076	34.17	46.40
0-60	1920	60.96	82.80
0-90	2319	73.63	100.00
40-90	1243	39.47	53.60
60-90	399	12.67	17.20
90-180	0	0.00	0.00
0-180	2319	73.63	100.00

** EFFICIENCY: 73.6% **

LUMINOUS LENGTH: 22.000 INS
WIDTH: 9.750 INS

S/MH: 1.5
SC(ALONG): 1.2, SC(ACROSS): 1.5

CERTIFIED BY:

Ryder Trunney

DATE:
FEB 23, 2010

PREPARED FOR:

FINELITE
UNION CITY, CA

TESTED IN ACCORDANCE WITH IES PROCEDURES.

LIGHTING SCIENCES, INC.
7826 E. EVANS RD.
SCOTTSDALE, AZ, USA 85260

CERTIFIED TEST REPORT No. 26733

FINELITE - 1' X 2' FLUORESCENT RECESSED LUMINAIRE, CAT# HPR-x-1X2-1FT40-DCO
WHITE REFLECTOR, FROSTED PLASTIC SIDE AND CENTER LENS
ONE SYLVANIA 40 WATT CFL LAMP, CAT# FT40DL/835/RS. LUMEN RATING = 3150 LMS.
ONE SYLVANIA QHE1X40DL/UNV ISN SC BALLAST OPERATING AT 120 VAC AND 34.5 WATTS

INTENSITY(CANDLEPOWER) DATA
IN 2.5 DEGREE STEPS

ANGLE	PLANE						OUTPUT LUMENS
	ALONG	22.5	45	67.5	ACROSS	AVERAGE	
0.0	783	783	783	783	783	783	
2.5	786	784	781	781	784	783	
5.0	783	782	780	781	782	781	76
7.5	779	778	778	781	785	780	
10.0	772	773	776	783	786	778	
12.5	764	766	773	783	789	775	
15.0	754	758	770	785	792	771	218
17.5	742	748	765	784	793	766	
20.0	728	737	760	785	796	761	
22.5	712	725	755	786	799	755	
25.0	696	712	749	786	802	749	345
27.5	677	697	741	784	802	741	
30.0	656	680	732	780	800	730	
32.5	634	662	720	772	793	717	
35.0	610	643	707	761	782	702	438
37.5	585	622	691	745	764	683	
40.0	558	599	670	722	738	660	
42.5	530	573	645	691	704	632	
45.0	501	546	616	654	663	599	459
47.5	471	516	582	611	615	563	
50.0	439	484	543	561	561	522	
52.5	406	449	500	507	504	478	
55.0	372	413	454	451	446	432	385
57.5	338	375	405	396	390	385	
60.0	304	337	357	344	337	340	
62.5	271	299	310	296	288	296	
65.0	238	261	266	250	243	254	253
67.5	205	225	224	208	202	215	
70.0	174	189	185	170	165	178	
72.5	144	155	149	136	132	144	
75.0	116	123	116	105	102	113	121
77.5	89	94	87	77	75	85	
80.0	65	68	60	52	50	59	
82.5	44	44	37	29	28	37	
85.0	25	24	17	16	16	19	25
87.5	9	7	6	5	5	6	
90.0	0	0	0	0	0	0	

LIGHTING SCIENCES, INC.
7826 E. EVANS RD.
SCOTTSDALE, AZ, USA 85260

CERTIFIED TEST REPORT No. 26733

FINELITE - 1' X 2' FLUORESCENT RECESSED LUMINAIRE, CAT# HPR-x-1X2-1FT40-DCO
WHITE REFLECTOR, FROSTED PLASTIC SIDE AND CENTER LENS
ONE SYLVANIA 40 WATT CFL LAMP, CAT# FT40DL/835/RS. LUMEN RATING = 3150 LMS.
ONE SYLVANIA QHE1X40DL/UNV ISN SC BALLAST OPERATING AT 120 VAC AND 34.5 WATTS

AVERAGE LUMINANCE DATA

CD./SQ.M (FOOTLAMBERTS)

ANGLE	ALONG	22.5	45	67.5	ACROSS
0	5658(1651)	5658(1651)	5658(1651)	5658(1651)	5658(1651)
30	5476(1598)	5693(1661)	6121(1786)	6526(1904)	6672(1947)
40	5267(1537)	5661(1652)	6327(1846)	6825(1992)	6959(2031)
45	5124(1495)	5582(1629)	6318(1844)	6703(1956)	6801(1985)
50	4937(1440)	5461(1593)	6107(1782)	6319(1844)	6303(1839)
55	4681(1366)	5210(1520)	5736(1674)	5703(1664)	5640(1646)
60	4395(1282)	4885(1425)	5160(1506)	4989(1456)	4871(1421)
65	4064(1186)	4468(1304)	4564(1332)	4285(1250)	4176(1219)
70	3668(1070)	4013(1171)	3927(1146)	3593(1048)	3486(1017)
75	3230(942)	3457(1009)	3239(945)	2941(858)	2847(831)
80	2710(791)	2835(827)	2515(734)	2174(634)	2090(610)
85	2075(605)	1966(573)	1417(413)	1320(385)	1347(393)

LIGHTING SCIENCES, INC.
7826 E. EVANS RD.
SCOTTSDALE, AZ, USA 85260

CERTIFIED TEST REPORT No. 26733

FINELITE - 1' X 2' FLUORESCENT RECESSED LUMINAIRE, CAT# HPR-x-1X2-1FT40-DCO
WHITE REFLECTOR, FROSTED PLASTIC SIDE AND CENTER LENS
ONE SYLVANIA 40 WATT CFL LAMP, CAT# FT40DL/835/RS. LUMEN RATING = 3150 LMS.
ONE SYLVANIA QHE1X40DL/UNV ISN SC BALLAST OPERATING AT 120 VAC AND 34.5 WATTS

COEFFICIENTS OF UTILIZATION

ZONAL CAVITY METHOD

EFFECTIVE FLOOR CAVITY REFLECTANCE = .20

CC WALL	90				80				70				50				30				10				0
	70	50	30	10	70	50	30	10	70	50	30	10	50	30	10	50	30	10	50	30	10	50	30	10	0
RCR																									
0	0.900	0.900	0.900	0.90	0.880	0.880	0.880	0.88	0.860	0.860	0.860	0.86	0.820	0.820	0.82	0.780	0.780	0.78	0.750	0.750	0.75	0.74			
1	0.830	0.800	0.770	0.74	0.810	0.780	0.750	0.73	0.790	0.770	0.740	0.72	0.730	0.710	0.69	0.700	0.690	0.67	0.680	0.660	0.65	0.64			
2	0.760	0.710	0.660	0.62	0.750	0.690	0.650	0.61	0.730	0.680	0.640	0.60	0.650	0.620	0.59	0.630	0.600	0.58	0.610	0.590	0.57	0.55			
3	0.700	0.630	0.570	0.52	0.680	0.610	0.560	0.52	0.670	0.600	0.550	0.51	0.580	0.540	0.51	0.560	0.530	0.50	0.550	0.520	0.49	0.47			
4	0.650	0.560	0.500	0.45	0.630	0.550	0.490	0.45	0.620	0.540	0.490	0.44	0.520	0.480	0.44	0.510	0.470	0.43	0.490	0.460	0.43	0.41			
5	0.600	0.500	0.440	0.39	0.580	0.490	0.430	0.39	0.570	0.490	0.430	0.38	0.470	0.420	0.38	0.460	0.410	0.38	0.440	0.400	0.37	0.36			
6	0.550	0.450	0.380	0.34	0.540	0.440	0.380	0.34	0.520	0.430	0.380	0.33	0.420	0.370	0.33	0.410	0.360	0.33	0.400	0.360	0.32	0.31			
7	0.500	0.400	0.340	0.29	0.490	0.390	0.330	0.29	0.480	0.390	0.330	0.29	0.380	0.320	0.29	0.370	0.320	0.28	0.360	0.310	0.28	0.27			
8	0.470	0.360	0.300	0.26	0.460	0.360	0.300	0.25	0.440	0.350	0.290	0.25	0.340	0.290	0.25	0.330	0.280	0.25	0.320	0.280	0.25	0.23			
9	0.430	0.330	0.260	0.22	0.420	0.320	0.260	0.22	0.410	0.320	0.260	0.22	0.310	0.260	0.22	0.300	0.250	0.22	0.290	0.250	0.22	0.20			
10	0.400	0.300	0.230	0.20	0.390	0.290	0.230	0.20	0.380	0.290	0.230	0.20	0.280	0.230	0.19	0.270	0.230	0.19	0.270	0.220	0.19	0.18			

LUMINAIRE INPUT WATTS 34.5

LABORATORY RESULTS MAY NOT BE REPRESENTATIVE OF FIELD PERFORMANCE.
BALLAST AND FIELD FACTORS HAVE NOT BEEN APPLIED.

TEST DISTANCE EXCEEDS FIVE TIMES THE GREATEST
LUMINOUS OPENING OF LUMINAIRE.