

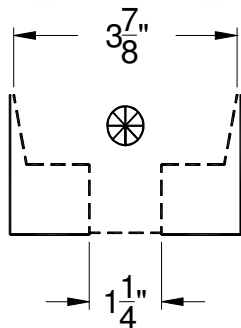

INDEPENDENT TEST LABORATORY REPORT No. 29349

FINELITE - LINEAR PENDANT FIXTURE, CAT# S18-1T5HO-EP
WITH SEMI-SPECULAR REFLECTOR AND DIFFUSE FLAT PLASTIC LENS
ONE SYLVANIA 54 WATT T5 LAMP, CAT# FP54/835/HO/ECO. LUMEN RATING = 4450 LMS.
ONE SYLVANIA QHE 2X54T5HO/UNV BALLAST OPERATING AT 120 VAC AND 62.8 WATTS

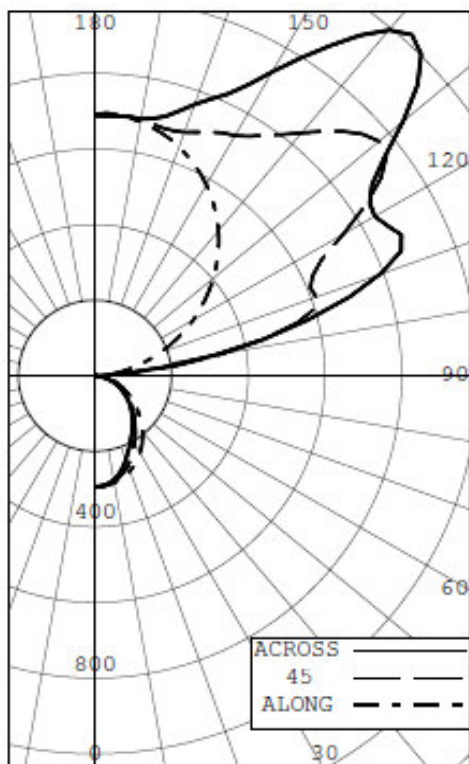

LUMINANCE SUMMARY CD./SQ.M.

ANGLE	ALONG	45	ACROSS
45	6697	5675	5363
55	6075	5272	4935
65	5650	4934	4517
75	5753	4403	3944
85	4658	3451	2996

INTENSITY (CANDLEPOWER) SUMMARY						OUTPUT LUMENS
ANGLE	ALONG	22.5	45	67.5	ACROSS	
0	295	295	295	295	295	
5	294	293	292	293	291	28
15	280	278	271	265	260	76
25	253	247	229	217	211	106
35	215	205	183	173	170	118
45	170	160	143	138	136	114
55	125	118	108	104	101	99
65	86	80	75	70	68	75
75	53	44	41	38	37	44
85	15	13	11	10	9	13
90	0	0	0	0	0	
95	27	115	91	69	65	114
105	124	316	546	577	576	466
115	239	540	626	813	883	624
125	351	548	911	878	882	664
135	455	562	914	1168	1204	661
145	545	589	777	985	1066	497
155	616	626	712	795	824	331
165	666	670	680	699	711	195
175	693	688	691	689	690	67
180	690	690	690	690	690	

ZONAL LUMENS AND PERCENTAGES

ZONE	LUMENS	% LAMP	% LUMINAIRE
0-30	210	4.72	4.90
0-40	328	7.37	7.64
0-60	541	12.17	12.61
0-90	673	15.13	15.69
40-90	345	7.76	8.05
60-90	132	2.96	3.07
90-180	3619	81.32	84.31
0-180	4292	96.45	100.00

** EFFICIENCY: 96.4% **

LUMINOUS LENGTH: 44.500 INS
WIDTH: 1.250 INS

S/MH: 1.0
SC (ALONG): 1.2, SC (ACROSS): 1.0

CERTIFIED BY:

Ryder Tunnay

DATE:
AUG 16, 2011

PREPARED FOR:

FINELITE
UNION CITY, CA

TESTED IN ACCORDANCE WITH IES PROCEDURES.

LIGHTING SCIENCES, INC.
7826 E. EVANS RD.
SCOTTSDALE, AZ, USA 85260

INDEPENDENT TEST LABORATORY REPORT No. 29349

FINELITE - LINEAR PENDANT FIXTURE, CAT# S18-1T5HO-EP
WITH SEMI-SPECULAR REFLECTOR AND DIFFUSE FLAT PLASTIC LENS
ONE SYLVANIA 54 WATT T5 LAMP, CAT# FP54/835/HO/ECO. LUMEN RATING = 4450 LMS.
ONE SYLVANIA QHE 2X54T5HO/UNV BALLAST OPERATING AT 120 VAC AND 62.8 WATTS

INTENSITY(CANDLEPOWER) DATA

ANGLE	PLANE						OUTPUT LUMENS
	ALONG	22.5	45	67.5	ACROSS	AVERAGE	
0	295	295	295	295	295	295	
5	294	293	292	293	291	292	28
10	289	287	285	283	280	285	
15	280	278	271	265	260	271	76
20	268	264	252	241	236	252	
25	253	247	229	217	211	231	106
30	235	227	206	194	189	210	
35	215	205	183	173	170	188	118
40	193	182	163	155	152	168	
45	170	160	143	138	136	148	114
50	147	138	125	121	119	129	
55	125	118	108	104	101	111	99
60	104	99	91	87	84	93	
65	86	80	75	70	68	75	75
70	69	62	58	53	52	58	
75	53	44	41	38	37	42	44
80	33	28	25	23	23	26	
85	15	13	11	10	9	11	13
90	0	0	0	0	0	0	
95	27	115	91	69	65	80	114
100	71	274	335	323	315	281	
105	124	316	546	577	576	447	466
110	181	446	614	773	796	580	
115	239	540	626	813	883	635	624
120	296	552	746	795	843	666	
125	351	548	911	878	882	738	664
130	404	551	967	1064	1051	827	
135	455	562	914	1168	1204	868	661
140	502	576	839	1106	1194	842	
145	545	589	777	985	1066	789	497
150	583	606	734	868	930	741	
155	616	626	712	795	824	713	331
160	644	651	686	743	765	696	
165	666	670	680	699	711	684	195
170	683	682	689	688	690	686	
175	693	688	691	689	690	690	67
180	690	690	690	690	690	690	

LIGHTING SCIENCES, INC.
7826 E. EVANS RD.
SCOTTSDALE, AZ, USA 85260

INDEPENDENT TEST LABORATORY REPORT No. 29349

FINELITE - LINEAR PENDANT FIXTURE, CAT# S18-1T5HO-EP
WITH SEMI-SPECULAR REFLECTOR AND DIFFUSE FLAT PLASTIC LENS
ONE SYLVANIA 54 WATT T5 LAMP, CAT# FP54/835/HO/ECO. LUMEN RATING = 4450 LMS.
ONE SYLVANIA QHE 2X54T5HO/UNV BALLAST OPERATING AT 120 VAC AND 62.8 WATTS

AVERAGE LUMINANCE DATA

CD./SQ.M (FOOTLAMBERTS)

ANGLE	ALONG	22.5	45	67.5	ACROSS
0	8213 (2397)	8213 (2397)	8213 (2397)	8213 (2397)	8213 (2397)
30	7563 (2207)	7324 (2137)	6639 (1937)	6252 (1824)	6074 (1772)
40	7010 (2046)	6638 (1937)	5920 (1727)	5667 (1654)	5539 (1616)
45	6697 (1954)	6296 (1837)	5675 (1656)	5456 (1592)	5363 (1565)
50	6372 (1859)	6022 (1757)	5439 (1587)	5262 (1535)	5138 (1499)
55	6075 (1773)	5750 (1678)	5272 (1538)	5075 (1481)	4935 (1440)
60	5813 (1696)	5518 (1610)	5094 (1486)	4835 (1411)	4695 (1370)
65	5650 (1649)	5277 (1540)	4934 (1440)	4632 (1352)	4517 (1318)
70	5641 (1646)	5056 (1475)	4721 (1378)	4367 (1274)	4225 (1233)
75	5753 (1679)	4804 (1402)	4403 (1285)	4055 (1183)	3944 (1151)
80	5373 (1568)	4471 (1305)	4017 (1172)	3706 (1081)	3614 (1054)
85	4658 (1359)	4040 (1179)	3451 (1007)	3138 (915)	2996 (874)

LIGHTING SCIENCES, INC.
7826 E. EVANS RD.
SCOTTSDALE, AZ, USA 85260

INDEPENDENT TEST LABORATORY REPORT No. 29349

FINELITE - LINEAR PENDANT FIXTURE, CAT# S18-1T5HO-EP
WITH SEMI-SPECULAR REFLECTOR AND DIFFUSE FLAT PLASTIC LENS
ONE SYLVANIA 54 WATT T5 LAMP, CAT# FP54/835/HO/ECO. LUMEN RATING = 4450 LMS.
ONE SYLVANIA QHE 2X54T5HO/UNV BALLAST OPERATING AT 120 VAC AND 62.8 WATTS

COEFFICIENTS OF UTILIZATION

ZONAL CAVITY METHOD

EFFECTIVE FLOOR CAVITY REFLECTANCE = .20

CC WALL	90				80				70				50				30				10				0
	70	50	30	10	70	50	30	10	70	50	30	10	50	30	10	50	30	10	50	30	10	50	30	10	0
RCR																									
0	1.071	1.071	1.071	0.07	0.950	0.950	0.950	0.95	0.840	0.840	0.840	0.84	0.620	0.620	0.62	0.420	0.420	0.42	0.240	0.240	0.24	0.15			
1	0.980	0.930	0.890	0.86	0.870	0.830	0.800	0.76	0.760	0.730	0.700	0.67	0.540	0.530	0.51	0.370	0.360	0.35	0.210	0.210	0.20	0.13			
2	0.890	0.810	0.750	0.69	0.790	0.720	0.670	0.62	0.690	0.640	0.590	0.55	0.480	0.450	0.42	0.330	0.310	0.29	0.190	0.180	0.17	0.11			
3	0.810	0.720	0.640	0.58	0.720	0.640	0.570	0.52	0.630	0.560	0.510	0.47	0.420	0.390	0.36	0.290	0.270	0.25	0.170	0.160	0.15	0.10			
4	0.740	0.630	0.550	0.49	0.660	0.560	0.490	0.44	0.580	0.500	0.440	0.39	0.370	0.330	0.30	0.260	0.230	0.21	0.150	0.140	0.13	0.08			
5	0.680	0.540	0.470	0.41	0.600	0.490	0.430	0.37	0.530	0.440	0.380	0.33	0.330	0.290	0.26	0.230	0.200	0.18	0.130	0.120	0.11	0.07			
6	0.620	0.500	0.410	0.35	0.560	0.450	0.370	0.32	0.490	0.390	0.330	0.29	0.300	0.250	0.22	0.210	0.180	0.16	0.120	0.110	0.10	0.06			
7	0.570	0.450	0.360	0.31	0.510	0.400	0.330	0.28	0.450	0.350	0.290	0.25	0.270	0.220	0.19	0.190	0.160	0.14	0.110	0.090	0.08	0.06			
8	0.530	0.400	0.320	0.27	0.470	0.360	0.290	0.24	0.410	0.320	0.260	0.22	0.240	0.200	0.17	0.170	0.140	0.12	0.100	0.080	0.07	0.05			
9	0.490	0.360	0.280	0.23	0.440	0.320	0.260	0.21	0.380	0.290	0.230	0.19	0.220	0.180	0.15	0.150	0.130	0.11	0.090	0.070	0.06	0.04			
10	0.450	0.330	0.250	0.20	0.400	0.290	0.230	0.19	0.360	0.260	0.210	0.17	0.200	0.160	0.13	0.140	0.110	0.09	0.080	0.070	0.06	0.04			

LUMINAIRE INPUT WATTS 62.8

LABORATORY RESULTS MAY NOT BE REPRESENTATIVE OF FIELD PERFORMANCE.
BALLAST AND FIELD FACTORS HAVE NOT BEEN APPLIED.

TEST DISTANCE EXCEEDS FIVE TIMES THE GREATEST
LUMINOUS OPENING OF LUMINAIRE.