

Hailey



Features

- Available in 9", 10", 12", 15", 18" and 20" diameter
- Provides excellent coverage and uniformity, suitable for general and localized lighting
- Options allow for application and design flexibility
- Stays ON in case of a power interruption with the optional, emergency ballast
- Quality components combined with the most current technology for high efficiency and reduced lighting costs

Applications

Hailey is ideal for illuminating spaces where the quality of light and style are important. It lends itself to commercial spaces, especially in the hospitality industry, where natural finishes convey a warm ambience.

TMSLIGHTING

ESTABLISHED 1923

Construction

High grade spun aluminum, solid copper, steel or 316L stainless steel construction, for indoor and outdoor applications. Sizes range from 9" to 20" in diameter.

Lamp

Operates with integrated Cree™ LED (32W max., CRI 80), compact fluorescent (57W max.), metal halide (100W max.), or incandescent (200W max.) light sources. A 17W LED screw type lamp is available (120V, PAR 38, CCT 4000K, E26 base).

Note: LED systems use 120-277V supply voltage, and are not compatible with 347V. Incandescent and metal halide systems, and those using the 17W LED PAR 38 lamp, use a medium base lamp holder (E26).

Only integrated LED sources are supplied, not lamps.

LED Driver / Ballast

The LED source is controlled by an advanced driver to deliver consistent power.

Ballasts are integral and electronic. They are efficient with a high power factor greater than 90%, and quiet with an "A" sound rating.

Diffuser

Globe: clear and prismatic glass globes are available for lamp protection and greater diffusion.

Globe with Cast Guard: the combination is available for greater diffusion and more robust lamp protection.

Note: G1, G3, and G11 are used with 100IN, 32CF, and 15LED max.

Option

Wire Guard: a steel, chrome-plated wire guard is available for lamp protection against light projectiles, wildlife, and serves as a vandal deterrent. Sizes fit reflectors from 10" to 20" in diameter.

Surge Suppressor

All 120V, 277V, and universal voltage fixtures are equipped with a 6kV surge suppressor.

Dimming

The LED dimming option is the 0-10V, current-sinking type.

Note: Use a current-sinking dimming system (by others) for LED dimming.

Dimming is not available with 347V systems.

Compatibility of this product is not guaranteed with all control systems.

Hailey



Features

- Available in 9", 10", 12", 15", 18" and 20" diameter
- Provides excellent coverage and uniformity, suitable for general and localized lighting
- Options allow for application and design flexibility
- Stays ON in case of a power interruption with the optional, emergency ballast
- Quality components combined with the most current technology for high efficiency and reduced lighting costs

TMSLIGHTING

ESTABLISHED 1923

Emergency

For integrated LED systems, integral and remote mount emergency back-ups are available in the standard temperature and cold temperature type.

The test switch and indicator light would be remote.

Note: The emergency option is not available with the 17W LED PAR 38 lamp.

See specifications in "Emergency Backups for Pendant Lights".

Mounting

Mount to a ceiling, directly to a standard 4" electrical junction box. Hailey is available with either the stem mount (1/2" NPT std., 5ft. / 1.524 m max.) or the drop cord with the optional aircraft cable mount (10 ft. / 3.048 m max.).

Note: The aircraft cable or ceiling slope adapter may be required to comply with the local seismic/earthquake code.

Follow the installation instructions, and adhere to your local electrical code.

Mounting Accessories

Aircraft Cable: for drop cord mounting, the steel cable provides additional support.

Ceiling Slope Adapter: for stem mounting, keeps the pendant hanging vertically, correcting up to a 20° slope max.

Finish

Available in several TMS specialty, brushed, powder-coated finishes, and custom RAL finishes by special order; see page 3, and the "Finishes and Diffusers" chart.

Note: A clear coat is applied to copper, yet patina will form over a period.

Compliances

QPS-C/US, or UL-C/US certified to UL1598 standards. Rated IP20 with the drop cord/ aircraft cable for use in dry, indoor locations; IP23 with the optional, stem mount, for outdoor locations.

The Consultants Europe (CE) listing is available upon request.



Hailey

TMSLIGHTING

ESTABLISHED 1923

HAI

1 2 3 4 5 6 7 8 9 10 11 12

Project: _____
Type: _____
Quantity: _____

Notes:

1 • Location

I: Indoor
O: Outdoor

2 • Diameter

9: 9" (23 cm) dia.
10: 10" (25 cm) dia.
12: 12" (31 cm) dia.
15: 15" (38 cm) dia.
18: 18" (46 cm) dia.
20: 20" (51 cm) dia.

3 • Lamping

17LED: 17W LED, PAR 38, screw type lamp (supplied)
15LED: 15W LED (9"-15" dia.)
19LED: 19W LED (12"-20" dia.)
32LED: 32W LED (18" and 20" dia.)

4 • Mounting

CRD: 120" Drop cord (indoor)
C___: Stem mount 1", 6", 12", 18", 24", 36", 48" or 60"

5 • LED CCT (color temp.)

30K: 3000K (CRI 80)
35K: 3500K (CRI 80)
40K: 4000K (CRI 80)

6 • Voltage

120: 120V
277: 277V

7 • Finish

AN: Anodized (bright)
BR: Brushed aluminum
CO: Solid copper (brushed; conduit mount would be black)
GA: Galvanized (rough; conduit mount will be flat silver)
SS: Stainless steel 316L (brushed; conduit mount would be silver metallic)

F05: White
F06: Clay brown

These are some popular finishes. For the complete selection, please see the "Finishes and Diffusers" chart.

8 • Globes

—: None
G1: Clear, elongated globe
G3: Prismatic, elongated globe
G9: Large, clear, elongated globe
G10: Large, elongated, prismatic globe
G11: Clear, elongated globe with cast guard
G11P: Prismatic, elongated globe with cast guard
G12: Clear, elongated, large globe with cast guard
Note: G1, G3, and G11 are used with 100IN, 32CF, and 15LED max.

9 • Dimming

—: None
DIML: LED dimming (0-10V, current-sinking)
Note: Use a current-sinking dimming system (by others) for LED dimming.
Dimming is not available with 347V systems.
Compatibility of this product is not guaranteed with all control systems.

10 • Emergency

—: None
EM: Integral LED (min. operating temp 5°C/40°F)
EMC: Integral LED cold pack (min. operating temp -20°C/-4°F)
EMR: Remote LED (dry location only; 20 ft. / 6.096 m max. distance from lamp to EM; min. operating temp. 5°C/40°F)
EMCR: Remote LED cold pack (20 ft. / 6.096 m max. distance from lamp to EM; min. operating temp. -20°C/-4°F)

11 • Mounting Accessories

—: None
ACC: Aircraft cable for drop cord mounting (10 ft. / 3.048 m length).
BL: Ceiling slope adapter for stem mounting (20° slope max.)

12 • Wire Guard

—: None
W10: 10" Wire guard
W12: 12" Wire guard
W15: 15" Wire guard
W18: 18" Wire guard
W20: 20" Wire guard

Note: Some options may not be compatible with others. To ensure compatibility between options, please visit tmslighting.com, on the "details" page of this luminaire, and use the configuration tool.



Hailey

TMSLIGHTING

ESTABLISHED 1923

Drop Cord Mount

Optional LED driver

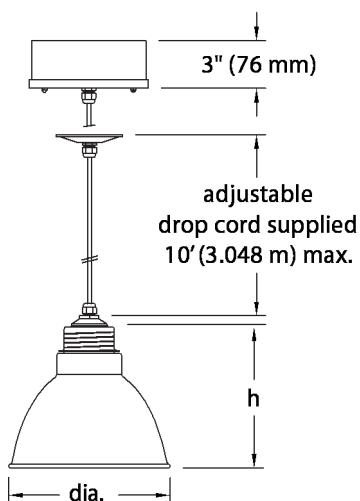

Stem Mount

Optional LED driver

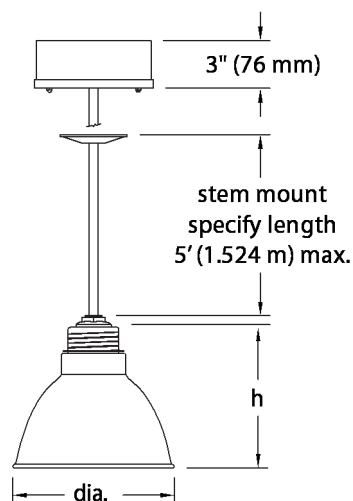

HAI-I/O-09

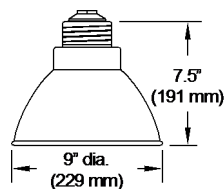

HAI-I/O-10

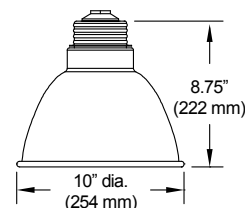

HAI-I/O-12

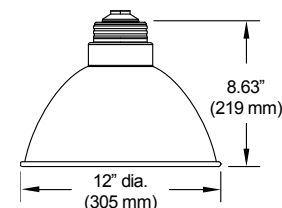

HAI-I/O-15

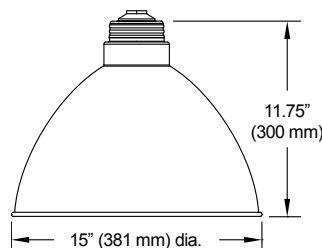

HAI-I/O-18

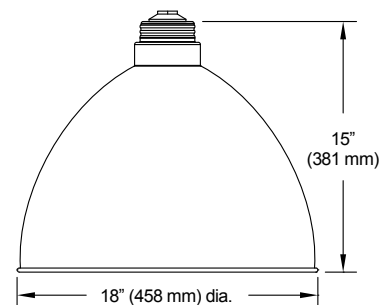

HAI-I/O-20

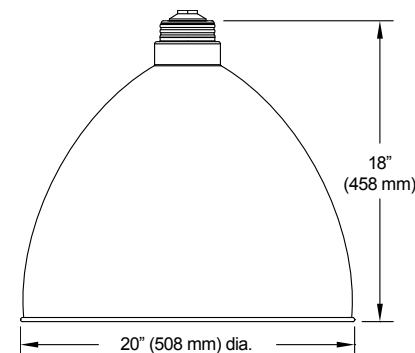

Custom

TMS Lighting can customize this and many of our standard fixtures. The dimensions, lamp types, enclosure and colors could be modified to suit your lighting and architectural requirements. Contact your local representative for more details: <http://tmslighting.com/info/agents>

Specifications are subject to change without notice.

TMS Lighting Inc.
247A Summerlea Road,
Brampton, Ontario,
Canada. L6T 4E1
Web Site: tmslighting.com

North America: (905) 793-1174
Toll-free: (866) 793-1174
Fax: (905) 793-1175
UK & Europe: 44-1474-250-654