

# 1912D

## Ceiling Fixture



### Features

#### Housing

Die-formed Cold-rolled Steel

Finish Option: -62 Satin Nickel, -05 Black, -30 Oil Rubbed Bronze

#### Optical

Shade: High Transmission Glass Create Excellent Light Distribution and Uniformity

LED: High Efficiency, High CRI, Binned and Mixed to Reach Uniform Light

#### Electrical

High Power Factor, Low THD

#### Lamp

Built-in LED Module (Color Temperature Option – 3000K, 4000K)

#### Certifications

ETL/cETL Listed

#### Warranty

5 Years Warranty on Driver and LED Module

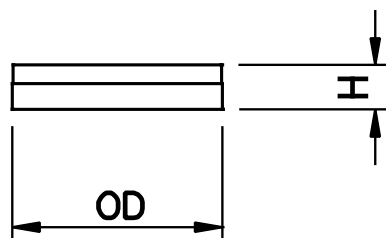

### LED Type

| Model          | Input Voltage | Input Wattage | Lumen (Typ) / CRI | CT             | Finish       | Shade         | Dimension (OD X H) |
|----------------|---------------|---------------|-------------------|----------------|--------------|---------------|--------------------|
| 1912D-62-xxxxK | 120V          | 18W           | 950 / > 80        | 3000K or 4000K | Satin Nickel | Frosted Glass | 10.9" x 2.3"       |