

1' X 4' LED SURFACE MOUNT SPECIFICATION GRADE TROFFER

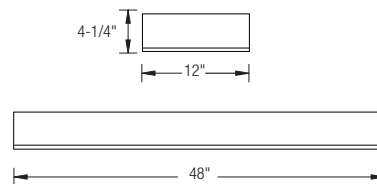

CALCULATED
L70
LIFETIME
83,000 HRS

CALCULATED
L80
LIFETIME
50,000 HRS



2400
LUMENS
21
WATT
According to
DLC Test Results

3400
LUMENS
29
WATT
According to
DLC Test Results

4000
LUMENS
34
WATT
According to
DLC Test Results

5000
LUMENS
42
WATT
According to
DLC Test Results

6000
LUMENS
52
WATT
According to
DLC Test Results

The OSMT-LED is a high-quality yet economical surface-mounted troffer luminaire powered by LED lighting technology. An excellent highly efficient general illumination fixture ideal for office spaces, schools, hospitals, and many other indoor locations. Fixture is designed to flush mount onto drywall/hardpan ceilings.

PRODUCT FEATURES:

- Fixture is cold-welded to provide extra strength and durability during installation and downstream maintenance
- Four keyway slots/mounting holes on the back of the housing provides several mounting options
- Mitered door frame prevents light leaks, and minimizes dust from entering fixture
- Constructed of one-piece ribbed unutilized housing and corners that interlock, preventing damage to luminaire
- Frosted 0.100" thick #12 pattern acrylic lens, standard
- Housing and door frame interface provides a superior mechanical light seal
- Post-painted with a 93% reflective white coat to improve fixture efficacy
- Rated at 85+ CRI and available in multiple CCTs
- Life tested to ensure light output of L70 up to 83,000 hrs and L80 up to 50,000 hrs

- All sides and corners are turned in and hemmed, removing sharp edges for safe handling and installation
- Tested to LM-79 and LM-80 standards
- LED lighting technology offers the highest return on initial investment over the lifetime of the fixture
- Emergency battery back-up comes pre-installed on the fixture and emergency push button is installed on the fixture for easy access and aesthetics.
- Dimmable down to 1% with compatible dimming systems
- LED light engine is completely removable and upgradable
- Four corner tie points are standard for safety wire support when required and built-in earthquake clips standard
- Same-day shipping on most options (Consult factory)

OPTICS - The OSMT-LED uses a prismatic acrylic lens to scatter the light emitted from the LED chips into functional light. The LED offered in the OSMT-LED has the highest return on initial investment compared to other standard lighting solutions. Lens is attached to a door frame which is easily pivoted and removable without the use of tools.

DURABILITY - Our heavy-duty 20-gauge steel housing is engineered for maximum strength and extended life. Fixture is cold-welded to provide extra strength and corners interlock to prevent aesthetic damage to the fixture and. Sides and corners are uniformly turned in and hemmed to remove sharp edges for safe handling and easy installation. Fixture flush mounts onto drywall/hardpan ceilings.

PERFORMANCE - The OSMT-LED powered lighting technologies offer a higher return on investment than any other lighting technology. The light engines found in the OSMT-LED are rated at 85+ CRI and available in multiple CCTs: 3000K, 3500K, 4000K and 5000K. All LEDs and LED fixtures are rated and tested to LM-79 and LM-80 standards. The LEDs are also binned to a 3-step MacAdam ellipses to achieve consistent color from fixture to fixture.

THERMAL MANAGEMENT - LED light engines are attached directly to the housing which keeps the engines cool. Our advanced thermal management system allows the light output of the LED engines to be maintained at 70% of initial lumens at 83,000 hours of operation.

ELECTRICAL - Powered by high-quality constant-current power LED drivers which are rated for 50 to 60Hz at 120-277V input, produce less than 20% THD, and have a power factor of .90 to 1.00.

MAINTENANCE - LED engines and driver can be accessed through the bottom by removing hinged door frame and driver box cover. LED engines are removable and upgradable even after fixture installation. Fixture can be regularly and safely wiped down to ensure optimal fixture performance.

DIMMING - The OSMT-LED comes standard with **DIM10**, 0-10V dimming on either 120 or 277V. Dimmable down to 1% of initial lumens. Also available in Lutron dimming options. Consult factory for dimmer compatibility. **LUTH** - Lutron Hilume Dimming down to 1% compatible with 3 wire and EcoSystem Controls available on all fixtures up to 50 Watts. **LUT2W** - Lutron 2 Wire Dimming down to 1% compatible with 2 wire and Forward Phase Control Systems available on all fixtures up to 50 Watts. **LUTFTB** - Lutron Hilume Fade to Black Dimming down to 1% compatible with EcoSystem Controls available on all fixtures up to 75 Watts. **DIMST** - Step Dimming allows fixtures to be turned on at 100% or 50% is available for fixtures up to 50 Watts. **ELDO10.1** - EldoLED SoloDrive 0-10V. Dimming down to .1%. available on all fixtures up to 100 Watts. **ELDODALI** - EldoLED PowerDrive 0-10V. Dimming down to .1%. available on all fixtures up to 100 Watts. **ELDODMX** - EldoLED PowerDrive Dimming down to .1%. available on all fixtures up to 100 Watts. Please see EldoLED website for wiring diagrams and a list of compatible DMX and Dali control systems.

OPTIONS - Fixtures can be shipped pre-installed with daylight harvesting controls, occupancy sensors, and/or power pack. Available manufacturer options include Leviton, Wattstopper, Hubbell Automation, and others.

QUALITY CONTROL - Every fixture is turned on and rigorously tested by our QC Department before shipping.

WARRANTY - Limited 5 Year Warranty



Ordering Information: Example: 14-OSMT-LED-3400L-DIM10-MVOLT-30K-85

FIXTURE SIZE	SERIES	TYPE	LUMENS	DIMMING	VOLTAGE	CCT	CRI	EMERGENCY	OTHER OPTIONS
14 - 1' X 4'	OSMT-Oracle Surface Mount Troffer	LED	2400L (2400 lumens) 3400L (2880 lumens) 4000L (3900 lumens) 5000L (4650 lumens) 6000L (6100 lumens)	DIM10 - 0-10V Dimming DIMST - Step Dimming LUTH - Lutron Hilume LUT2W - Lutron 2Wire LUTFTB - Lutron Fade to Black ELDO10.1 - EldoLED 0-10V ELDODALI - EldoLED DALI ELDODMX - EldoLED DMX	MVOLT 347* * Consult factory for details	30K - (3000K) 35K - (3500K) 40K - (4000K) 50K - (5000K)	85	O-EMG-LED LENS A12 - A12 A19 - A19 A-SFW - Smooth Frosted White	FBF - Internal Fast Blow Fuse SBF - Internal Slow-Blow Fuse RIS - Radio Interference Suppressor GDF - Gasketed Door Frame USA - Made in America Compliance