

T8/T5 - 2' X 4' FLUORESCENT RECESSED DIRECT/INDIRECT CENTER MOUNT STYLE WITH LOUVER

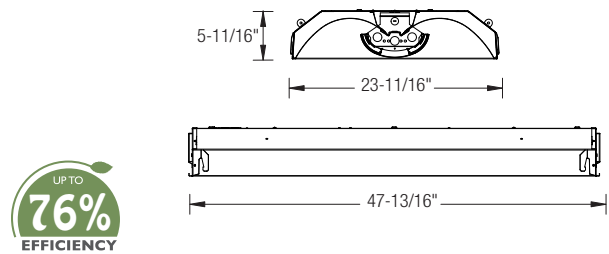

APPLICATION:

General illumination for health care facilities, educational institutions, airports, commercial offices, retail and many other applications.

PRODUCT FEATURES:

- Shiloh Series Louvers are designed to increase visual enhancement directly to the task while producing a glare-free environment
- Proprietary "light lock system" prevents light leakage at both ends of lamp shield
- Steel side reflectors intersect with housing to ensure seamless appearance
- Lamp shield pivots down for easy installation of lamps
- Ballast can be accessed from below the ceiling
- Lamp shield is 2/3 60% perforated white mesh metal and 1/3 white louvers
- Louvers are baked white enamel and backed by diffusing shield to eliminate lamp image
- Post-painted soft white powder coat finish maximizes distribution and efficiency while providing visual comfort
- All sides and corners are turned in and hemmed, removing sharp edges for safe handling and installation
- Four corner tie points are standard for safety wire support when required

- Built-in earthquake clips come standard
- Same-day shipping on most options (Consult factory)
- Supplied standard with Philips Advance, GE or Universal ballast
- Wide variety of dimming and daylight harvesting options available
- Consult factory for continuous row mounting
- CEE qualified ballast comes standard on most fixture options (Consult factory for details)
- NEC required ballast disconnect is standard

LISTING

UL/C-UL listed to US and Canadian standards

WARRANTY

Guaranteed for one year against mechanical defects

Ordering Information > Example: 24-OBLD-2-32-T8-ADV-10-MVOLT

24	OBLD								
FIXTURE SIZE 24-2' X 4'	TRIM TYPE (Blank)-Grid (Consult factory for Slot T mounting option)			VOLTAGE² (Blank)- MVOLT (120/277) 120 277 347	# OF BALLAST (Blank) - 1 Ballast 2 - 2 Ballasts	BALLAST FACTOR (Blank)- Normal BF HBF- High BF LBF- Low BF	LAMP INSTALLED (Blank)- No lamp L30K- 3000K L35K- 3500K L41K- 4100K L50K- 5000K		
SERIES OBLD-Oracle Straight Blade Louvers Direct/ Indirect	# OF LAMPS/LAMP TYPE 1-32-T8 (1 lamp/32W/T8) 2-32-T8 (2 lamps/32W/T8) 3-32-T8 (3 lamps/32W/T8) 1-28-T5 (1 lamp/28W/T5) 2-28-T5 (2 lamps/28W/T5) 3-28-T5 (3 lamps/28W/T5) 1-54-T5HO (1 lamp/54W/T5HO) 2-54-T5HO (2 lamps/54W/T5HO)			*MASTER/SATELLITE MAS1-Master fixture w/ 1 ballast & 11 ft. flex MAS2-Master fixture w/ 2 ballast & 11 ft. flex SAT-Satellite fixture w/o ballast *must be ordered separately EX: 24-OBLD-2-32-T8-MAS2 and 24-OBLD-2-32-T8-SAT *Available only with 2 or 3 lamps T8 only. Dimming option is not available when ordering Master/Satellite.					
BALLAST CONFIGURATION & CODE									
	32W/T8	28W/T5	54W/T5HO	DESCRIPTION					
	(Blank)	-	-	Electronic Instant Start					
	EPS	(Blank) ¹	(Blank)	Electronic Program Start					
	ADV-7	-	ADV-7 ¹	Advance Mark-7 ²					
	ADV-10	-	ADV-10 ¹	Advance Mark-10 ²					
	-	ADV-OPT	-	Advance Optanium ²					
	ADV-ESS	-	-	Advance Essential ²					
	ADV-ROVR	-	ADV-ROVR	Advance Rover ²					
	LUT-EHD	LUT-EHD ¹	LUT-EHD ¹	Lutron Ecosystem H-Series ²					
	LUT-2W ¹	-	-	Lutron Tu-Wire ²					
	LUT-EC5	LUT-EC5 ¹	-	Lutron Ecosystem ²					
	LUT-EC3	LUT-EC3 ¹	LUT-EC3 ¹	Lutron Eco-10 ²					
	LUT-TVE ¹	-	-	Lutron Tve ²					
	LUT-H3D	LUT-H3D ¹	LUT-H3D	Lutron Hi-Lume 3D ²					
	-	-	LUT-ECO ¹	Lutron Ecosystem (347V Only) ²					

1- Requires 2 Ballasts for 3 lamps
2- Voltage must be specified for dimming ballast.

EMERGENCY BATTERY PACK OPTIONS (L. = LUMENS)	
ORDER CODE	DESCRIPTION
EMG-T8-BX-450	Up to 450 L. for T8 or BX
EMG-T8-BX-600	Up to 600 L. for T8 or BX
EMG-T8-BX-700	Up to 700 L. for T8 or BX
EMG-T8-BX-1400	Up to 1400 L. for T8 or BX
EMG-T5-520	Up to 520 L. for T5
EMG-T5-T5HO-700	Up to 700 L. for T5 or T5HO
EMG-T5-T5HO-1300	Up to 1300 L. for T5 or T5HO
EMG-T8-BX-T5-T5HO-3200	Up to 3200 L. for T8, BX, T5 or T5HO
EMG-SD-T8-BX-T5-T5HO-1400	Self-Diagnostic 1400 L. for T8, BX, T5 or T5HO
EMG-ICE-T8-BX-T5-T5HO-1400	ICE Pack 1400 L. for T8, BX, T5 or T5HO
GTG	Generator Transfer Device

MANY OTHER BODINE AND IOTA EMERGENCY PACKS ARE AVAILABLE. PLEASE CONSULT FACTORY. VISIT WWW.BODINE.COM OR WWW.IOTAENGINEERING.COM FOR MORE DETAILS.

OTHER OPTIONS	
24FK - Flange Kit for 2' X 4' Fixture	SBF - Internal Slow-Blow Fuse
C3 - 6' 3-wire Flex Cable (Single Circuit)	RIS - Radio Interference Suppressor
C4 - 6' 4-wire Flex Cable (Double Circuit)	DCR - Dust Cover
FBF - Internal Fast Blow Fuse	USA - Made in America Compliance