

NOMINAL LUMENS	DELIVERED LUMENS	WATTAGE
700	772	12W

Based on 4000K, 90+ CRI. Actual wattage may vary +/- 5%

INSTALLATION

Cut hole in ceiling. Insert luminaire into opening by squeezing spring clips on both sides of luminaire. The width in ceiling needed for the driver to fit is 3".

FEATURES

6" round regressed slim LED luminaire engineered for new construction, remodel or retrofit to accommodate insulated or dropped ceilings. Regressed lens delivers smooth, even comfortable illumination. Recessed housing not required for insulated ceilings. Remote driver allows easy installation and maintenance. Small aperture and shallow depth are ideal for unlimited applications.

LUMENS	700
CCT	27K, 30K, 35K, 40K, 50K and WDM (dim to warm technology)
CRI	90+
COLOR QUALITY	3-Step MacAdam Ellipse
CONSTRUCTION	Aluminum die-cast body and trim
TRIM OPTION	Round Indirect
TRIM COLORS	WH (White)
REFLECTOR COLORS	WH (White)
DIMMING	DIMTR (Triac)
EMERGENCY	16W high voltage inverter (remote)
LIFETIME	L70 at 50,000 Hours
PHOTOMETRIC TESTS	In Accordance with IES LM79-08, LM80 and TM-30, TM-21

- IC-Rated and Air-Tight ready and may be in direct contact with insulation.
- Can be installed in applications with limited plenum clearance.
- May be installed in drywall or suspended ceilings.
- Flicker-free 120V forward-phase Triac dimming down to 5%.
- Even illumination of luminaire is achieved by utilizing patent-pending optics along with edgelit LED technology.
- Aluminum die-cast body and trim.



SLIM TRIM



ACCESSORIES



RL-ACC-SLIM-1-10F
10-ft long extension



RL-ACC-SLIM-1-20F
20-ft long extension



RL-UNV-4/5/6
For use with: 4", 5", 6"
Universal mounting plate

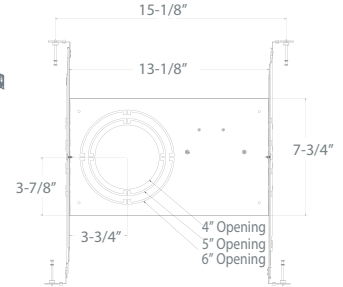

AL-ACC-SLIM-6-F-ROUGHPLATE
For use with: 6" downlights

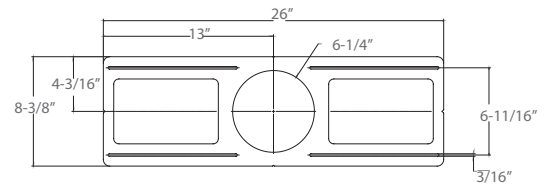
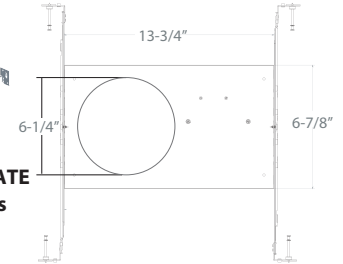

RL-ACC-SLIM-6-ROUGHPLATE
Rough-in plate for use with 6" downlights

EXAMPLE: **RL655-700L-DIMTR-120-30K-90-WH**

TYPE	LUMEN	CCT	CRI	FINISH
RL655	<input type="checkbox"/> 700L-DIMTR-120 <input type="checkbox"/> 700L-277-347 (Non-dimmable)	<input type="checkbox"/> 27K <input type="checkbox"/> 30K <input type="checkbox"/> 35K <input type="checkbox"/> 40K <input type="checkbox"/> WDM-30K-22K	<input type="checkbox"/> 90+	<input type="checkbox"/> WH-White

RL-ACC-SLIM-1-10F

OPTIONS
<input type="checkbox"/> RL-ACC-SLIM-1-10F - 10ft Long Extension
<input type="checkbox"/> RL-ACC-SLIM-1-20F - 20ft Long Extension
<input type="checkbox"/> RL-UNV-4/5/6 - Universal Mounting Plate for 4", 5" and 6"
<input type="checkbox"/> RL-ACC-SLIM-6-ROUGHPLATE - 6" Mounting Plate
<input type="checkbox"/> AL-ACC-SLIM-6-F-ROUGHPLATE - 6" Flanged Roughplate

RL655-700L-DIMTR-120-40K-90-WH

TEST NO.: **EL0119151**

INPUT WATTS: **11.8** LUMENS: **772** CRI: **90** EFFICACY: **65** CCT: **4000K** SPACING CRITERIA: **1.52**

Candle Power Distribution (Candelas)

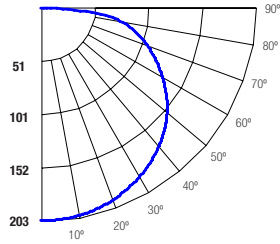

Zonal Lumens Summary

Zone	Lumens	%Lamp	%Fixt
0-20	75.15	9.70	9.70
0-30	162.87	21.10	21.10
0-40	274.60	35.60	35.60
0-60	527.95	68.40	68.40
0-80	737.04	95.50	95.50
0-90	771.64	100.00	100.00

Luminance (Average candela/M²)

Angle in Degrees	Average		
	0°	45°	90°
45	12829	12516	12309
55	13896	13456	13241
65	15673	15135	14835
75	19936	19199	16311
85	26757	19939	16665

Lumens Per Zone

Zone	Lumens
0-10	19.22
10-20	55.92
20-30	87.73
30-40	111.73
40-50	125.59
50-60	127.76
60-70	117.46
70-80	91.62
80-90	34.60

Candela Tabulation

θ	Candela
0	202.54
5	202.28
15	198.93
25	191.43
35	180.34
45	165.63
55	145.53
65	120.94
75	94.21
85	42.58
90	0.56

Coefficients of Utilization - Zonal Cavity Method
Effective Floor Cavity Reflectance 0.20

RC	80%				70%				50%				30%			10%			0%
	RW	70%	50%	30%	10%	70%	50%	30%	10%	50%	30%	10%	50%	30%	10%	50%	30%	10%	0%
ROOM CAVITY RATIO	0	119	119	119	119	116	116	116	116	111	111	111	106	106	106	102	102	102	100
1	106	101	95	91	104	98	94	89	94	90	86	90	87	84	86	84	81	79	79
2	95	86	78	71	93	84	77	70	80	74	69	77	72	67	74	69	65	63	63
3	86	74	65	58	83	73	64	57	69	62	56	67	60	55	64	58	54	52	52
4	78	65	55	48	76	64	54	47	61	53	47	58	52	46	56	50	45	43	43
5	72	58	48	40	69	56	47	40	54	46	40	52	45	39	50	44	39	36	36
6	66	51	42	35	64	50	41	35	49	40	34	47	39	34	45	39	34	31	31
7	61	46	37	30	59	46	37	30	44	36	30	42	35	30	41	34	29	27	27
8	57	42	33	27	55	41	33	27	40	32	27	39	32	26	38	31	26	24	24
9	53	39	30	24	51	38	30	24	37	29	24	36	29	24	35	28	23	22	22
10	49	35	27	22	48	35	27	22	34	27	21	33	26	21	32	26	21	19	19

Cone of Light

Beam Dia (ft)	Initial Footcandle at Nadir	Beam Vert. Spread (ft)	Beam Horiz. Spread (ft)
2	50.6	12	11.6
4	12.7	24	23.3
6	5.63	36	34.9
8	3.16	48	46.6
10	2.03	60	58.2
12	1.41	72	69.8

BEAM DIA. MEASURED AT 50% OF NADIR F.C.

RC - Ceiling Cavity Reflectance RW - Wall Reflectance