

FEATURES

The Elite LED Slim Surface Mount has been engineered to install into most standard junction boxes. Up to 900 usable lumens are directed from the luminaire to the work surface. Easy to install, applicable to junction box or recessed can installation.

LUMENS	900
CCT	30K, 40K, 50K
CRI	90+
COLOR QUALITY	3-Step MacAdam Ellipse
DIMMING	DIMTR (Triac Dimming)
FINISH	WH (White), BK (Black), SN (Satin Nickel), BZ (Bronze)
LIFETIME	50,000 Hours

OPTICS

The Elite LED Module system is much more than just a simple LED retrofit. The Elite LED system is a highly engineered work of design and optical science which produces up to 1200 lumens. Our meticulously crafted optics gather the light scattered by the LED chip and shape it into a functional beam with uniform light distribution.

DIMMING

Intended for Triac (120V) based on configuration. Minimum 90°C supply conductors.

COMPLIANCE

Non-conductive fixture for shower light application. Product complies with the requirements of the California Energy Commission regulated under Title 24.

LISTING

ETL listed for damp location (wet location - with covered ceilings)
Energy Star certified

WARRANTY

The Elite LED lighting system carries a five-year carefree warranty for parts and components. (Labor not included)

NOMINAL LUMENS	DELIVERED LUMENS	WATTAGE
900	898	14W

Based on 4000K, 90+ CRI. Actual wattage may vary +/- 5%

INSTALLATION

You MUST seal all gaps between the ceiling and fixture with weatherproof silicone sealant. This deters moisture and water from damaging fixtures and other mechanical ceiling elements.

EXAMPLE: **RL791-900L-DIMTR-120-30K-90-WH**

TYPE	LUMEN	CCT	CRI	FINISH	ACCESSORY
RL791	<input type="checkbox"/> 900L-DIMTR-120	<input type="checkbox"/> 30K <input type="checkbox"/> 40K <input type="checkbox"/> 50K	<input type="checkbox"/> 90+	<input type="checkbox"/> WH-White (standard) <input type="checkbox"/> RL791-RT-BK - Black Ring <input type="checkbox"/> RL791-RT-SN - Satin Nickel Ring <input type="checkbox"/> RL791-RT-BZ - Bronze Ring	<input type="checkbox"/> RL791-TORSION-SPRING <input type="checkbox"/> A-RL791-EMG-LED-WH Empty Base for Battery Backup



MOUNTING

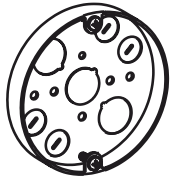

**Pancake J-Box
(Metal)**



**3.5" Round
(Plastic)**



**4" Octagonal
(Metal)**



**Fire Rated
J-Box**

Note: A 2-1/8" deep octagon junction box is recommended for through circuit wiring applications.

RING COLORS



RL791-RT-BK
Black



RL791-RT-SN
Satin Nickel



RL791-RT-BZ
Bronze

OPTION

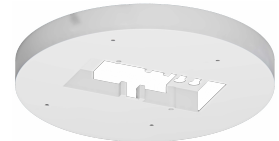

A-RL791-EMG-LED-WH
EMPTY BASE FOR BATTERY
BACKUP WHITE FINISH



Accessory

RL791-TORSION-SPRING

***For use in 6" downlight housing ONLY**