



At only 2.25" wide, the NLSD fits discretely into many architectural applications. It is suitable for continuous runs and offers a clean, unbroken look.

NLSD narrow linear direct surface/suspended



Features and Specifications:

Construction:

- Custom extruded diffuser offers high light transmission with excellent LED diffusion
- Precision fabricated steel housings are an economic alternative to extruded aluminum

Size Options:

- Available in 2', 3', 4', 6' and 8' lengths (nominal)

Listing & Ratings:

- All electrical components are U.L. listed or recognized
- All fixtures are U.L. Certified and Union made in the USA
- Meets Buy America Act (ARRA)

Mounting Options:

- Surface or cable mount (specify "AC" when ordering)

Driver:

- Universal voltage 120-277V standard
- Custom driver tuning available for specific lumen requirements
- 0-10V or Lutron dimming

Warranty:

- 5 years - part replacement only (see our terms & conditions page at www.lamarled.com for details)

See page 2 for lumen chart & dimensions

Ordering Guide / Example

NLSD48M-40D

NLSD						
Series	Size	Power	Lens Options	CCT	General Options	Run Configuration
NLSD = Direct surface/suspended	24 = 2' nominal 36 = 3' nominal* 48 = 4' nominal 72 = 6' nominal 96 = 8' nominal	L = Low M = Medium H = High	B = Bottom lens	30 = 3000K 35 = 3500K 40 = 4000K 50 = 5000K	EM = Emergency pack >90 min., >500 lumens (higher output & run time available - consult factory - 3'-8' only) BLK = Black metal construction D = 0-10V dimming to 1% (standard) DTD = 0-10V Dim to Dark LDH = Lutron EcoSystem Hi-lume digital 1% w/Fade to Black LD2 = Lutron 2-wire 120V 1% forward phase (40W max) AC = 4' aircraft cable mount	Blank = Individual BOR = Beginning of run (6' & 8' only) EOR = End of run (2'-8') INT = Intermediate (6' & 8' only)

Consult factory for additional options not shown or listed
4' AC cable kits and pre-wired power drop included with -AC option,
other lengths available - consult factory

Feed through wiring is included for continuous run models (BOR, INT and EOR)

Correlated Color Temperatures (CCTs) fall within the nominal range as per ANSI C78.377A
*Custom order on request - Minimum order quantities apply

Project Information:

Job Name:

Fixture Type:

Catalog #:

Date:

Comments:

Certification & Listings:

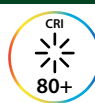

BEFORE INSTALLATION, PLEASE CONSULT YOUR LOCAL ORDINANCES AND BUILDING CODES FOR COMPLIANCE

Dimensions

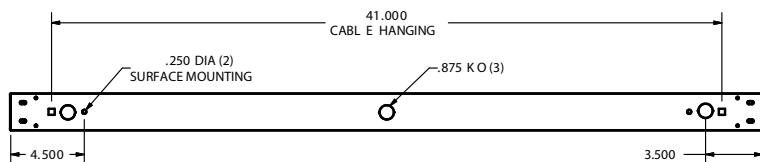
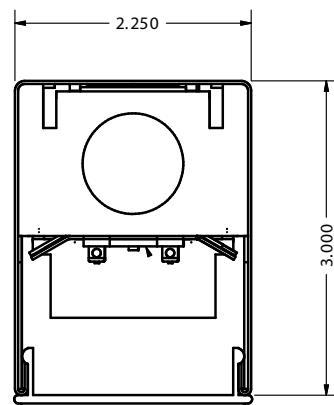
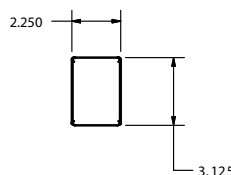
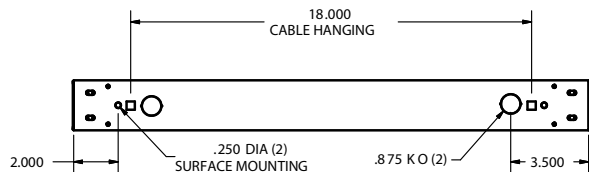

Length Chart

Size	
2'	23.125"
4'	46"
6'	69"
8'	92"

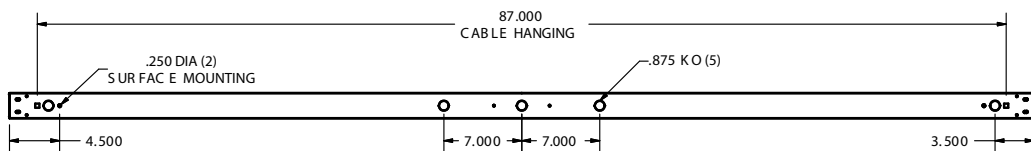
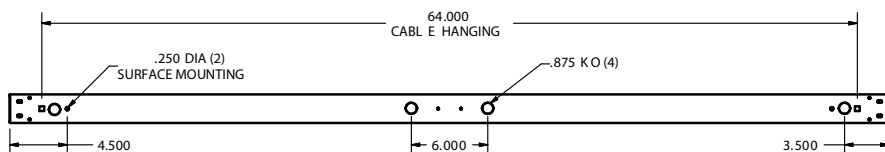

Typical Run Configuration (12' example shown)

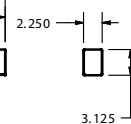
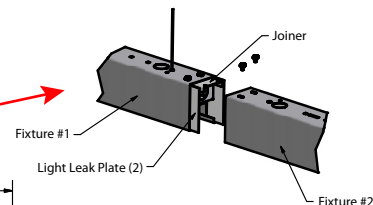
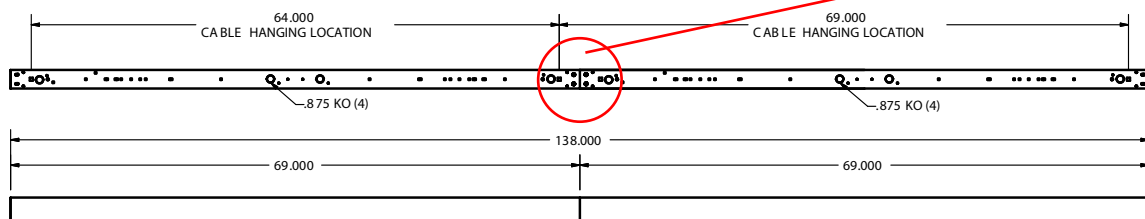

LED Lumen/Wattage Chart - 4000K

NLSD 4'

Low	Medium	High
24W	33W	52W
2455 Lu	3210 Lu	4614 Lu

Lumen Multipliers

3000K	.95
3500K	.97
5000K	1.03

LAMAR LED assumes no responsibility for misapplication of fixtures

Due to the rapid advancements in LED technology, please consult our website for the most current technical data.

Specifications subject to change without notice - Rev 0721