

**Top View** (with center arm)

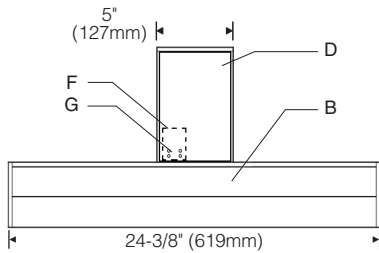

**Bottom View** (with right offset arm)

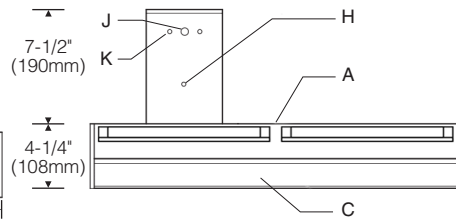

**Bottom View** (mast mount)

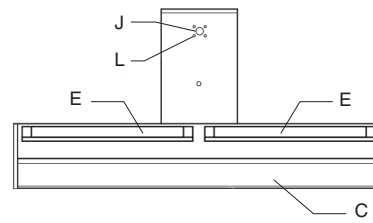

**Front View**

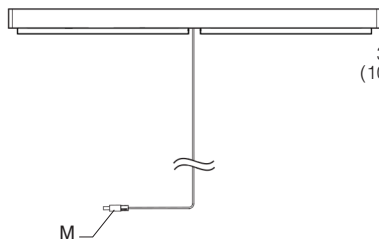

**End View**

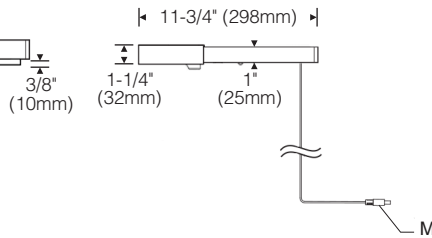

**Power Supply**

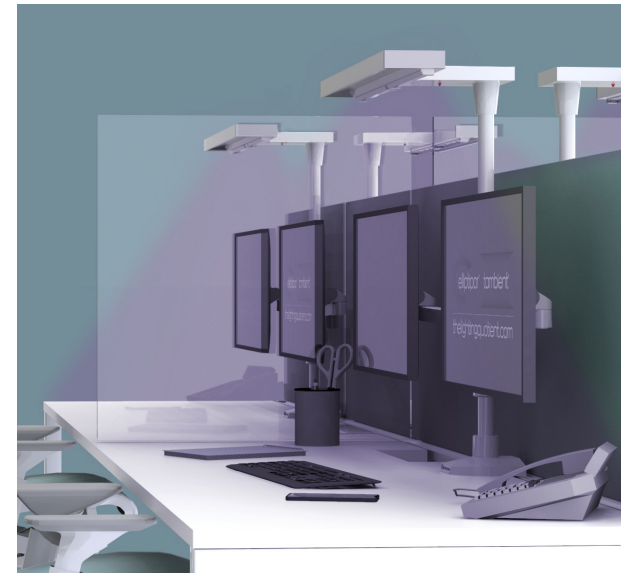
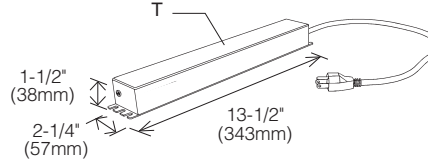

Mast mount G305 shown with **AMA-2W-BU** dual-arm mast and mounting base. Order mast/mounting base separately. Monitors not included.

**Specifications**

- |  |  |   |   |
|--|--|---|---|
| <b>A</b> Extruded aluminum housing and arm | <b>E</b> UV-C LED array                              | <b>J</b> Cable exit   | <b>M</b> 6-ft low-voltage power cable with barrel connector |
| <b>B</b> Top filler panel                  | <b>F</b> Internal wireless receiver for UV-C control | <b>K</b> Accepts 1" x 3" stanchion (order stanchion separately)       | <b>T</b> HPF power supply with 6-ft cord and plug           |
| <b>C</b> Bottom filler panel               | <b>G</b> Link buttons and LEDs                       | <b>L</b> Accepts monitor arm kit with mast (order AMA kit separately) |   |
| <b>D</b> Snap-in aluminum access cover     | <b>H</b> UV-C indicator LED                          |   |   |

**Finish:**

Painted surfaces: 6 stage pretreatment and electrostatically applied thermoset polyester powder coating for a durable abrasion, fade- and corrosion-resistant finish. Matching acrylic top and bottom filler panels.

**Disinfection Arrays:**

Two (2) replaceable, downward-facing linear UV-C LED arrays on painted mounting trays with integral visors.

**Light Engines:**

**None. This unit does not provide visible light.** Refer to data sheets [UV2.0](#), [UV3.0](#) and [UV4.0](#) for disinfection units incorporating task light and/or ambient uplight.

**Mounting:**

Predrilled for mounting to **TMS-13** support stanchion or **AMA** monitor arm kit with mast support. Required AMA mounting kit or stanchion and stanchion base ordered and priced separately.

**Electrical:**

120VAC/24VDC high power factor power supply in remote mounted aluminum enclosure with 5.5 x 2.1mm female barrel jack and 6ft 18/3 SJT power cord with NEMA 5-15P grounded plug head.

**Control:**

Remote ON/OFF control of UV-C disinfection LEDs via internal wireless receiver and accessory CLT signal transmitter. Order CLT signal transmitter separately

**Features**

- Plug-in unit for ultraviolet work surface disinfection
- Mercury-free UV-C LED technology
- Easy assembly to accessory support stanchion and desk edge mounting clamp or monitor arm support mast
- Removable disinfection arrays for service and upgrade
- Connects wirelessly to accessory transmitter for remote control by 3<sup>rd</sup>-party sensors and automated building controls



**Performance**

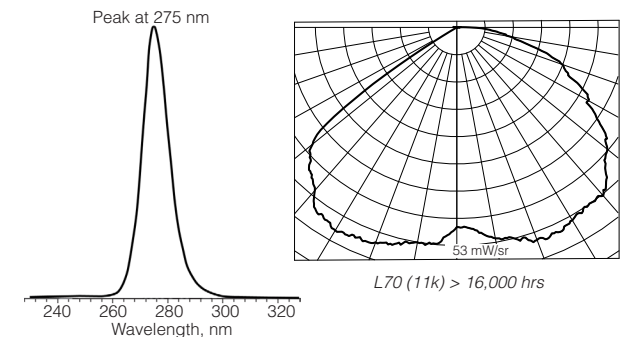

Project: \_\_\_\_\_

Type: \_\_\_\_\_

G 3 0 5 | 0 0 0 0 | - 1 | - 0 | 0 0 | 0 0

1 2 3 4 5 6 7 8

### 1 Style

**G305** = Work surface disinfection unit with twenty-four (24) downward facing UV LEDs, 275 nm peak intensity. Input: 23W including power supply

### 2 Visible Light Output / Power

**0000** = No visible light

### 3 Configuration

- 1** = Center arm for stanchion
- 2** = Offset arm left (for stanchion shifted 6" off center)
- 3** = Offset arm right (for stanchion shifted 6" off center)
- M** = Center arm for monitor arm mast

Configurations 1, 2, and 3 include 2 screws for stanchion attachment.

### 4 Finish

- 02** = Semigloss white
- PL** = Semigloss platinum

### 5 Power Supply

- 1** = High power factor 120VAC/24VDC plug-in power supply with 6' power cord and NEMA 5-15P grounded plug head. Includes quick-connect barrel jack for detachable 24-volt luminaire power cable.

### 6 Options

- 00** = No options
- FA** = Disinfection unit factory assembled to stanchion and base. Available for configuration 1, 2, and 3 only. Order stanchion and base separately.
- XX** = Custom modification (specify)

### 7 Color Temperature / CRI

**00** = No visible light

### 8 Control

**00** = Internal wireless receiver for remote ON/OFF control of UV-C disinfection LEDs via accessory **CLT** signal transmitter. Order **CLT** signal transmitter separately. Receiver is factory configured for automatic shut-OFF of UV-C disinfection within 10 seconds of loss of transmitter signal.

**NOTE: EXCESSIVE EXPOSURE TO UV-C RADIATION IS HARMFUL TO HUMAN SKIN AND EYES. OPERATE UV-C LEDs IN UNOCCUPIED SPACES ONLY.**

### Required Mounting Stanchion

(Required for Configurations 1, 2, and 3 only)

**Stanchion TMS-13 is required for Style G305 stanchion mounted unit** — ordered and priced separately. Go to [www.TheLightingQuotient.com](http://www.TheLightingQuotient.com) or select link below for details. Choose a size that combines with a **TMB-13** mounting base (below) and the mounting condition to position the unit at the desired height and provide the desired coverage for disinfection. Add finish code when ordering. Consult factory for sizes not shown.

- TMS-13** Mounting stanchion, 1" x 3".
- Examples: **TMS-13-238-02** 29-3/4" stanchion, semigloss white finish
- TMS-13-238-PL** 29-3/4" stanchion, semigloss platinum finish

### Required Mounting Base

(Required for Configurations 1, 2, and 3 only)

**Mounting Base TMB-13 is required for Style G305 stanchion mounted unit** — ordered and priced separately. A range of bases integrate with most work surfaces, select workstation panels and system-specific furniture details. Go to [www.TheLightingQuotient.com](http://www.TheLightingQuotient.com) or select link below for details. Add finish code when ordering. Consult factory for custom integrations. Includes 2 screws for stanchion attachment.

- TMB-13** Mounting base for TMS-13 mounting stanchion
- Examples: **TMB-13-99-02** Work surface edge clamp, semigloss white finish
- TMB-13-99-PL** Work surface edge clamp, semigloss platinum finish.

### Required Mast and Mounting Base

**Mast and mounting base AMA-05, AMA-10, AMA-1W, AMA-2W, AMA-3S, or AMA-3W is required for Style G305 mast-mounted luminaire** — ordered and priced separately. Go to [www.TheLightingQuotient.com](http://www.TheLightingQuotient.com) or select a link below for details. Add finish code when ordering.

- AMA-05-00** Standard base with square mast and 2 dynamic arms for VDTs 5 to 25 lbs each.
- AMA-05-BU** USB base with square mast and 2 dynamic arms for VDTs 5 to 25 lbs each.
- AMA-10-00** Standard base with round mast and pivot bracket for one VDT up to 50"/30 lbs.
- AMA-10-BU** USB base with round mast and pivot bracket for one VDT up to 50"/30 lbs.
- AMA-1W-00** Standard base with round mast and horizontal arm for one VDT up to 30"/20 lbs.
- AMA-1W-BU** USB base with round mast and horizontal arm for one VDT up to 30"/20 lbs.
- AMA-2W-00** Standard base with round mast and 2 horizontal arms for VDTs up to 30"/20 lbs each.
- AMA-2W-BU** USB base with round mast and 2 horizontal arms for VDTs up to 30"/20 lbs each.
- AMA-3S-00** Standard base with round mast, pivot bracket and 2 horizontal arms for VDTs up to 24"/15 lbs each.
- AMA-3S-BU** USB base with round mast, pivot bracket and 2 horizontal arms for VDTs up to 24"/15 lbs each.
- AMA-3W-00** Standard base with round mast, pivot bracket and 2 horizontal arms for VDTs up to 30"/15 lbs each.
- AMA-3W-BU** USB base with round mast, pivot bracket and 2 horizontal arms for VDTs up to 30"/15 lbs each.

### Required Disinfection Signal Transmitter

**Disinfection Signal Transmitter CLT is required for all G305 disinfection units** — ordered and priced separately. Link to any number of G305 units in range for ON/OFF control of UV-C disinfection. Connect to 3rd-party switching controls. 120 volt only. Signal range approximately 75 feet. Mount in electrical junction box by others.

- CLT-EN-02** Disinfection signal transmitter

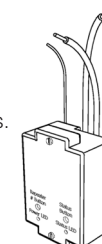

tambient from The Lighting Quotient  
 114 Boston Post Road, West Haven, Connecticut 06516, USA  
 Voice 203.931.4455 • Fax 203.931.4464 • [thelightingquotient.com](http://thelightingquotient.com)

Certain products illustrated may be covered by applicable patents and patents pending. These specifications supersede all prior publications and are subject to change without notice. Copyright © 2020 Sylvan R. Shemitz Designs, LLC, all rights reserved.