

Top View (with center arm)

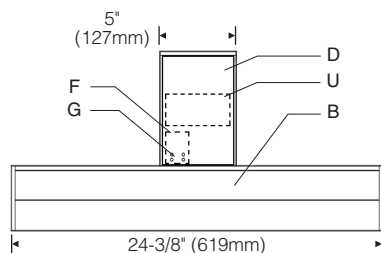

Bottom View (with right offset arm)

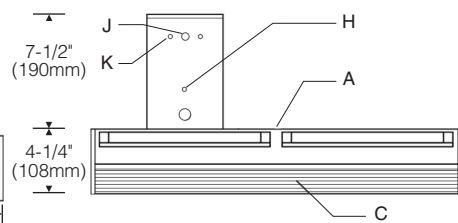

Bottom View (mast mount)

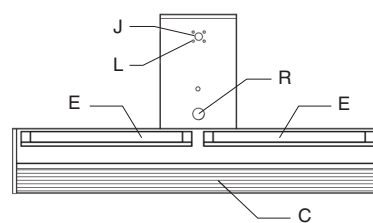

Front View

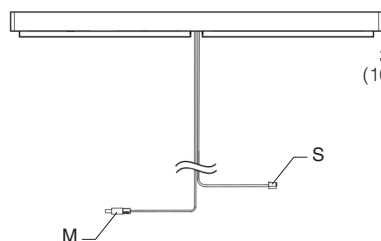

End View

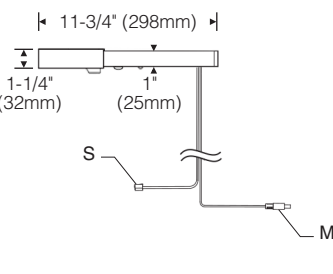

Power Supply

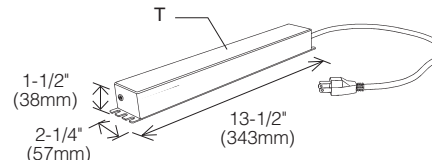

Mast mount G305 shown with **AMA-2W-BU** dual-arm mast and mounting base. Order mast/mounting base separately. Monitors not included.

Specifications

A Extruded aluminum housing and arm	E UV-C LED array	K Accepts 1" x 3" stanchion (order stanchion separately)	R Pushbutton switch/dimmer
B Top filler panel	F Internal wireless receiver for UV-C control	L Accepts monitor arm kit with mast (order AMA kit separately)	S Sensor cable (MS option)
C Snap-in acrylic task lens	G Link buttons and LEDs	M 6-ft low-voltage power cable with barrel connector	T HPF power supply with 6-ft cord and plug
D Snap-in aluminum access cover	H UV-C indicator LED		U Multi-mode controller
	J Cable exit		

Finish:

Painted surfaces: 6 stage pretreatment and electrostatically applied thermoset polyester powder coating for a durable abrasion, fade- and corrosion-resistant finish. Matching acrylic top filler panel.

Disinfection Arrays:

Two (2) replaceable, downward-facing linear UV-C LED arrays on painted mounting trays with integral visors.

Light Engine:

Light engine with extruded aluminum heat sink and holographic diffusers; removable for service or upgrade. Precision extruded acrylic glare control lens delivers asymmetric forward throw task light distribution for broad coverage and visual comfort.

Light Emitters:

3500K, 80+ CRI mid-power LEDs. Additional CCT and CRI options are available; consult factory.

Mounting:

Predrilled for mounting to **TMS-13** support stanchion or **AMA** monitor arm kit with mast support. Required AMA mounting kit or stanchion and stanchion base ordered and priced separately.

Electrical:

120VAC/24VDC high power factor power supply in remote mounted aluminum enclosure with 5.5 x 2.1mm female barrel jack and 6ft 18/3 SJT power cord with NEMA 5-15P grounded plug head.

Features

- All-in-one task light and workstation disinfection unit
- Mercury-free UV-C LED technology
- Removable light engines and disinfection arrays for service and upgrade
- Connects wirelessly to accessory transmitter for remote control by 3rd-party sensors and automated building controls



Control:

Pushbutton for ON/OFF and dimming control of task light. Dimming range 100%-5%. Auto-OFF control of task light via optional plug-and-play workstation motion sensor. Remote ON/OFF control of UV-C disinfection LEDs via dedicated internal wireless receiver and accessory **CLT** signal transmitter. Order **CLT** signal transmitter separately.

Project:

Type:

G 3 0 5 | 2 0 0 0 | - | - | 1 | - 0 | 3 5 | 0 1

1 2 3 4 5 6 7 8

NOTE: Refer to page UV2.2 for required CLT disinfection signal transmitter and required AMA mounting kit or TMS mounting stanchion and TMB mounting base. Each ordered and priced separately.

1 Style

G305 = Work surface disinfection unit with twenty-four (24) downward facing UV LEDs, 275 nm peak intensity. Input: 23W (disinfection only) including power supply

2 Visible Light Output / Power

2000 = 42 mid-power emitters
Input: 19W maximum, including power supply
Output: 1505 lm

3 Configuration

- 1** = Center arm for stanchion
- 2** = Offset arm left (for stanchion shifted 6" off center)
- 3** = Offset arm right (for stanchion shifted 6" off center)
- M** = Center arm for monitor arm mast

Configurations 1, 2, and 3 include 2 screws for stanchion attachment.

4 Finish

- 02** = Semigloss white
- PL** = Semigloss platinum



Performance (surface disinfection)

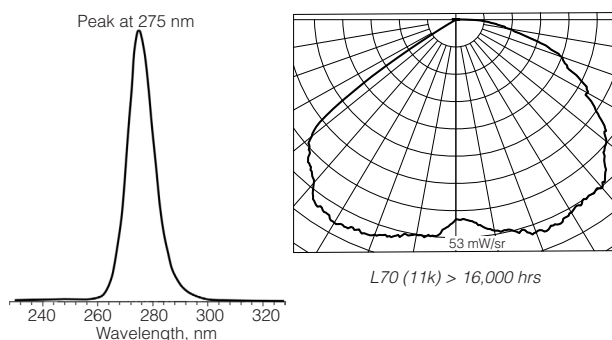

5 Power Supply

- 1** = High power factor 120VAC/24VDC plug-in power supply with 6' power cord and NEMA 5-15P grounded plug head. Includes quick-connect barrel jack for detachable 24-volt luminaire power cable.

6 Options

- 00** = No options
- FA** = Luminaire factory assembled to stanchion and base. Available for configuration 1, 2, and 3 only. Order stanchion and base separately.
- MS** = Plug-in motion sensor for task light
- FM** = Factory assembled (see FA above) with plug-in motion sensor (see MS above).
- XX** = Custom modification (specify)

Workstation Motion Sensor
(included with options **MS** and **FM**) — 24V PIR motion sensor. Mount to underside of work surface with adhesive pad or screw (provided). Includes 9-ft RJ11/RJ45 sensor cable.

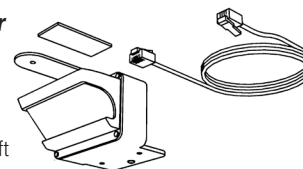

Performance (task light)

Beam shaping technology and precision extruded acrylic lens control glare and achieve superior work surface coverage and uniformity.

Contact factory for complete photometrics and lumen maintenance reports.

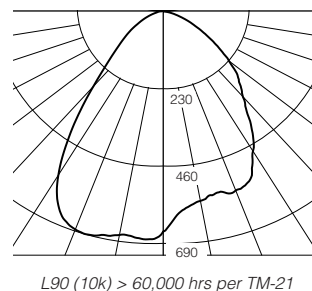

7 Color Temperature / CRI

35 = 3500K, 80+ CRI

Note: Additional CCT and CRI options are available; consult factory

8 Control

- 01** = Pushbutton for ON/OFF and dimming control of task light. Dimming range 100%-5%. Auto-OFF control of task light via optional plug-and-play workstation motion sensor. End-of-life timer signals recommended light engine replacement after 50,000 hours of use. Remote ON/OFF control of UV-C disinfection LEDs via dedicated internal wireless receiver and accessory **CLT** signal transmitter. Order **CLT** signal transmitter separately.

NOTE: EXCESSIVE EXPOSURE TO UV-C RADIATION IS HARMFUL TO HUMAN SKIN AND EYES. OPERATE UV-C LEDs IN UNOCCUPIED SPACES ONLY.



tambient from **The Lighting Quotient**
114 Boston Post Road, West Haven, Connecticut 06516, USA
Voice 203.931.4455 • Fax 203.931.4464 • thelightingquotient.com

Certain products illustrated may be covered by applicable patents and patents pending. These specifications supersede all prior publications and are subject to change without notice. Copyright © 2020 Sylvan R. Shemitz Designs, LLC, all rights reserved.

Required Mounting Stanchion*(Required for Configurations 1, 2, and 3 only)*

Mounting stanchion TMS-13 is required for Style G305 stanchion mounted luminaire — ordered and priced separately. Go to www.TheLightingQuotient.com or select link below for details. Choose a size that combines with a **TMB-13** mounting base (below) and the mounting condition to position the luminaire at the desired height and provide the desired coverage for lighting and disinfection. Add finish code when ordering. Order mounting base separately. Consult factory for sizes not shown.

TMS-13 Mounting stanchion, 1" x 3".

Examples: **TMS-13-238-02**
29-3/4" mounting stanchion for use with TMB-13-99 universal work surface edge clamp mounting base. Semigloss white finish.

TMS-13-238-PL
29-3/4" mounting stanchion for use with TMB-13-99 universal work surface edge clamp mounting base. Semigloss platinum finish.

Required Mounting Base*(Required for Configurations 1, 2, and 3 only)*

Mounting base TMB-13 is required for Style G305 stanchion mounted luminaire — ordered and priced separately. A range of bases integrate with most work surfaces, select workstation panels and system-specific furniture details. Go to www.TheLightingQuotient.com or select link below for details. Add finish code when ordering. Includes 2 screws for stanchion attachment. Order mounting stanchion separately. Consult factory for custom integrations.

TMB-13 Mounting base for TMS-13 mounting stanchion

Examples: **TMB-13-99-02**
Universal work surface edge clamp mounting base. Semigloss white finish.

TMB-13-99-PL
Universal work surface edge clamp mounting base. Semigloss platinum finish.

Required Mast and Mounting Base*(Required for Configuration M only)*

Mast and mounting base AMA-05, AMA-10, AMA-1W, AMA-2W, AMA-3S, or AMA-3W is required for Style G305 mast-mounted luminaire — ordered and priced separately. Go to www.TheLightingQuotient.com or select a link below for details. Add finish code when ordering.

AMA-05-00 Standard base with square mast and 2 dynamic arms for VDTs 5 to 25 lbs each.

AMA-05-BU USB base with square mast and 2 dynamic arms for VDTs 5 to 25 lbs each.

AMA-10-00 Standard base with round mast and pivot bracket for one VDT up to 50"/30 lbs.

AMA-10-BU USB base with round mast and pivot bracket for one VDT up to 50"/30 lbs.

AMA-1W-00 Standard base with round mast and horizontal arm for one VDT up to 30"/20 lbs.

AMA-1W-BU USB base with round mast and horizontal arm for one VDT up to 30"/20 lbs.

AMA-2W-00 Standard base with round mast and 2 horizontal arms for VDTs up to 30"/20 lbs each.

AMA-2W-BU USB base with round mast and 2 horizontal arms for VDTs up to 30"/20 lbs each.

AMA-3S-00 Standard base with round mast, pivot bracket and 2 horizontal arms for VDTs up to 24"/15 lbs each.

AMA-3S-BU USB base with round mast, pivot bracket and 2 horizontal arms for VDTs up to 24"/15 lbs each.

AMA-3W-00 Standard base with round mast, pivot bracket and 2 horizontal arms for VDTs up to 30"/15 lbs each.

AMA-3W-BU USB base with round mast, pivot bracket and 2 horizontal arms for VDTs up to 30"/15 lbs each.

Required Disinfection Signal Transmitter

Disinfection Signal Transmitter CLT is required for all G305 disinfection units — ordered and priced separately. Link to any number of G305 units in range for ON/OFF control of UV-C disinfection. Connect to 3rd-party switching controls. 120 volt only. Signal range approximately 75 feet. Mount in electrical junction box by others.

CLT-EN-02 Disinfection signal transmitter

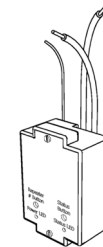

tambient from **The Lighting Quotient**
114 Boston Post Road, West Haven, Connecticut 06516, USA
Voice 203.931.4455 • Fax 203.931.4464 • thelightingquotient.com

Certain products illustrated may be covered by applicable patents and patents pending. These specifications supersede all prior publications and are subject to change without notice. Copyright © 2020 Sylvan R. Shemitz Designs, LLC, all rights reserved.