

LALO-OPTICS (02)

Linear Fixtures



Ideal for lighting direct and indirect surface mount applications, LALO is now available as a fully assembled fixture. LALO Optics is available in satin and black finishes, with an extruded optical lens. Beam angles offered in 17°. It is suitable for installation in the storage area of a clothes closet when specified with LEDs at 4.0 watts or less per foot.

Part Number Builder

Static White



Product	W/FT	CCT	Rated	Efficiency	Lens	Input/Output	Connector/Wire In	Connector/Wire Out	Wire Color	Wire Type	Mounting	Finish	Length* (in)	
LL2SW				STD	17									
Voltage: 24 VDC														
Typical lumens at 5.0W/ft with CL lens at 3000K: 395 lm/ft	1.5 3.0 4.0 5.0 6.0	20 22 24 27 30 35 40	DRY (IP20)	STD Standard	17	S1 S2	BW BRL CON6 CON24	CLS	WH BK N/A	CL2 CL2P N/A	SST MG	ST BK		
	1.5 3.0 4.0 5.0	24 27 30 35 40	DMP (IP54)			P1 P2	BW BRL CON6 CON24	BW BRL CON6 CON24						
	1.5 3.0 4.0 5.0	20 22 24 27 30 35 40	WET (IP67)			Pass through								

*Available in 1" increments for 1.5W/ft - 5.0W/ft and 2" increments for 6.0W/ft. Maximum length of 98.43" not including end caps. Tolerance +0.0"/-0.5. Minimum fixture length 6".

Static White High Efficacy



Product	W/FT	CCT	Rated	Efficiency	Lens	Input/Output	Connector/Wire In	Connector/Wire Out	Wire Color	Wire Type	Mounting	Finish	Length* (in)	
LL2SW				STD	17									
Voltage: 24 VDC														
Typical lumens at 6.0W/ft with CL lens at 3000K: 671 lm/ft	1.5HE 3.0HE 6.0HE	20 22 24 27 30 35 40	DRY (IP20)	STD Standard	17	S1 S2	BW BRL CON6 CON24	CLS	WH BK N/A	CL2 CL2P N/A	SST MG	ST BK		
		24 27 30 35 40	DMP (IP54)			P1 P2	BW BRL CON6 CON24	BW BRL CON6 CON24						

*Available in 2" increments, maximum length of 98.43" not including end caps. Tolerance +0.0"/-0.5. Minimum fixture length 6".

- If selecting **BRL**, select N/A for wire color and type
- **BW** comes in standard 24"- request custom length (Max 120") by writing it in inches next to "BW" in the order code box (ex. BW48)
- **Connector/Wire In or Out** not needed to specify product. Standard configuration is Type S1, Connector/Wire In: BW & Connector/Wire Out: CLS
- Specify **CL2P** for plenum rated wire
- **One Step, One Bin** based on 5W/ft

- 5 year warranty
- Field modifications void warranty
- Data subject to change, all data has +/- 5% tolerance
- Compatible for use with Q-Tran power supplies
- Suitable for installation in the storage area of a clothes closet when specified with LEDs at 4.0 watts or less per foot

LALO-OPTICS (02)

Linear Fixtures



Static White High Efficacy Plus



Product	W/FT	CCT	Rated	Efficiency	Lens	Input/Output	Connector/Wire In	Connector/Wire Out	Wire Color	Wire Type	Mounting	Finish	Length* (in)
LL2SW				STD	17								
Voltage: 24 VDC	3.0HE+ 6.0HE+	27 30 35 40	DRY (IP20) WET (IP67)	STD Standard	17	S1 S2	BW BRL CON6 CON24	CLS	WH BK	CL2 CL2P	SST MG	ST BK	Max continuous length: 3.0W - 196" 6.0W - 118"
Typical lumens at 6.0W/ft with CL lens at 3000K: 944 lm/ft						P1 P2	BW BRL CON6 CON24	BW BRL CON6 CON24					

Single (Closed exit)
Pass through

*Available in 2" increments, maximum length of 98.43" not including end caps. Tolerance +0.0"/-0.5. Minimum fixture length 6".

Static White Individually Addressable



Product	W/FT	CCT	Rated	Efficiency	Lens	Input/Output	Connector/Wire In	Connector/Wire Out	Wire Color	Wire Type	Mounting	Finish	Length* (in)
LL2IA	5.0		DRY	STD	17								
Voltage: 24 VDC	5.0	27 30 35 40	DRY (IP20)	STD Standard	17	S1 S2	BW CON6 CON24	CLS	WH BK	CL2 CL2P	SST MG	ST BK	*Available in 4" increments, maximum length of 98.43" not including end caps. Tolerance +0.0"/-0.5. Minimum fixture length 6".
						P1 P2	BW CON6 CON24	BW CON6 CON24					

Single (Closed exit)
Pass through

Warm Dim



Product	W/FT	CCT	Rated	Efficiency	Lens	Input/Output	Connector/Wire In	Connector/Wire Out	Wire Color	Wire Type	Mounting	Finish	Length* (in)
LL2WD	6.0		DRY	STD									
Voltage: 24 VDC	6.0	19/27 19/30	DRY (IP20)	STD Standard	17	S1 S2	BW BRL CON6 CON24	CLS	WH BK N/A	CL2 CL2P N/A	SST MG	ST BK	*Available in 2" increments, maximum length of 98.43" not including end caps. Tolerance +0.0"/-0.5. Minimum fixture length 6".
						P1 P2	BW BRL CON6 CON24	BW BRL CON6 CON24					

Single (Closed exit)
Pass through

- If selecting **BRL**, select N/A for wire color and type
- **BW** comes in standard 24" - request custom length (Max 120") by writing it in inches next to "BW" in the order code box (ex. BW48)
- **Connector/Wire In or Out** not needed to specify product. Standard configuration is Type S1, Connector/Wire In: BW & Connector/Wire Out: CLS
- Specify **CL2P** for plenum rated wire

- 5 year warranty
- Field modifications void warranty
- Data subject to change, all data has +/- 5% tolerance
- Compatible for use with Q-Tran power supplies
- Suitable for installation in the storage area of a clothes closet when specified with LEDs at 4.0 watts or less per foot

LALO-OPTICS (02)

Linear Fixtures



Dynamic White



Product	W/FT	CCT	Rated	Efficiency	Lens	Input/Output	Connector/Wire In	Connector/Wire Out	Wire Color	Wire Type	Mounting	Finish	Length* (in)
LL2DW	6.0			STD	17								
Voltage: 24 VDC Typical lumens at 6.0W/ft with CL lens at 3000K: 227 lm/ft	6.0	20/27 20/30	DRY (IP20)	STD Standard	17	S1 S2 Single (Closed exit)	BW CON6 CON24	CLS	WH BK	CL2 CL2P	SST MG	ST BK	
		24/30	DMP (IP54)										
		20/27 20/30	WET (IP67)										
						P1 P2 Pass through	BW CON6 CON24	BW CON6 CON24					

*Available in 2" increments, maximum length of 98.43" not including end caps. Tolerance +0.0"/-0.5. Minimum fixture length 6".

Dynamic White High Efficacy



Product	W/FT	CCT	Rated	Efficiency	Lens	Input/Output	Connector/Wire In	Connector/Wire Out	Wire Color	Wire Type	Mounting	Finish	Length* (in)
LL2DW				STD	17								
Voltage: 24 VDC Typical lumens at 5.0W/ft with CL lens at 3000K: 244 lm/ft	3.0HE 5.0HE	20/27 20/30 27/40 27/55	DRY (IP20)	STD Standard	17	S1 S2 Single (Closed exit)	BW CON6 CON24	CLS	WH BK	CL2 CL2P	SST MG	ST BK	
		24/30 27/40	DMP (IP54)										
		20/27 20/30 27/40 27/55	WET (IP67)										
						P1 P2 Pass through	BW CON6 CON24	BW CON6 CON24					

*Available in 2" increments, maximum length of 98.43" not including end caps. Tolerance +0.0"/-0.5. Minimum fixture length 6".

Static Color



Product	W/FT	CCT	Rated	Efficiency	Lens	Input/Output	Connector/Wire In	Connector/Wire Out	Wire Color	Wire Type	Mounting	Finish	Length* (in)
LL2SC	5.0			STD	17								
Voltage: 24 VDC Typical lumens at 5.0W/ft with green CL lens in green: 490 lm/ft	5.0	GR BL RD AB	DRY (IP20)	STD Standard	17	S1 S2 Single (Closed exit)	BW BRL CON6 CON24	CLS	WH BK N/A	CL2 CL2P N/A	SST MG	ST BK	
			DMP (IP54)										
			WET (IP67)										
						P1 P2 Pass through	BW BRL CON6 CON24	BW BRL CON6 CON24					

*Available in 2" increments, maximum length of 98.43" not including end caps. Tolerance +0.0"/-0.5. Minimum fixture length 6".

- If selecting **BRL**, select N/A for wire color and type
- **BW** comes in standard 24"- request custom length (Max 120") by writing it in inches next to "BW" in the order code box (ex. BW48)
- **Connector/Wire In or Out** not needed to specify product. Standard configuration is Type S1, Connector/Wire In: BW & Connector/Wire Out: CLS
- Specify **CL2P** for plenum rated wire

- 5 year warranty
- Field modifications void warranty
- Data subject to change, all data has +/- 5% tolerance
- Compatible for use with Q-Tran power supplies
- Florida Fish and Wildlife Conservation Commission (FWC) rated Strips: DRY and WET rated, Red and Amber
- Suitable for installation in the storage area of a clothes closet when specified with LEDs at 4.0 watts or less per foot

LALO-OPTICS (02)

Linear Fixtures



RGB **5 YEAR WARRANTY**

Product	W/FT	CCT	Rated	Efficiency	Lens	Input/ Output	Connector/ Wire In	Connector/ Wire Out	Wire Color	Wire Type	Mounting	Finish	Length* (in)	
LL2RGB	6.0	RGB		STD	17									
Voltage: 24 VDC														
Typical lumens at 6.0W/ft with CL lens in green: 176 lm/ft														
	6.0	RGB	DRY (IP20)	STD Standard	17	S1 S2	BW CON6 CON24	CLS	WH BK	CL2 CL2P	SST MG	ST BK		
			DMP (IP54)			P1 P2	BW CON6 CON24	BW CON6 CON24						
			WET (IP67)			Single (Closed exit)		Pass through						

*Available in 2" increments, maximum length of 98.43" not including end caps. Tolerance +0.0"/-0.5. Minimum fixture length 6".

RGBW **5 YEAR WARRANTY**

Product	W/FT	CCT	Rated	Efficiency	Lens	Input/ Output	Connector/ Wire In	Connector/ Wire Out	Wire Color	Wire Type	Mounting	Finish	Length* (in)	
LL2RGBW	6.0			STD	17									
Voltage: 24 VDC														
Typical lumens at 8.0W/ft with CL lens at 3000K: 86 lm/ft														
	6.0	27 30	DRY (IP20)	STD Standard	17	S1 S2	BW CON6 CON24	CLS	WH BK	CL2 CL2P	SST MG	ST BK		
			DMP (IP54)			P1 P2	BW CON6 CON24	BW CON6 CON24						
						Single (Closed exit)		Pass through						

*Available in 4" increments, maximum length of 98.43" not including end caps. Tolerance +0.0"/-0.5. Minimum fixture length 6".

- **BW** comes in standard 24"- request custom length (Max 120") by writing it in inches next to "BW" in the order code box (ex. BW48)
- **Connector/Wire In or Out** not needed to specify product. Standard configuration is Type S1, Connector/Wire In: BW & Connector/Wire Out: CLS
- Specify **CL2P** for plenum rated wire

- 5 year warranty
- Field modifications void warranty
- Data subject to change, all data has +/- 5% tolerance
- Compatible for use with Q-Tran power supplies

LALO-OPTICS (02) Linear Fixtures



Technical Information

Static White [Calculated L70 = 30000 hrs]
Tested with LL2SW-**-30-DRY-STD

	1.5W/FT	3.0W/FT	4.0W/FT	5.0W/FT	6.0W/FT
	LM/FT	LM/FT	LM/FT	LM/FT	LM/FT
17	150	261	325	395	458

Static White High Efficacy

[Calculated L70 = 70000 hrs]
Tested with LL2SW-**-30-DRY-STD

	1.5HEW/FT	3.0HEW/FT	6.0HEW/FT
	LM/FT	LM/FT	LM/FT
17	193	354	671

Static White High Efficacy Plus

[Calculated L70 = 50000 hrs]
Tested with LL2SW-**-30-DRY-STD

	3.0HE+W/FT	6.0HE+W/FT
	LM/FT	LM/FT
17	511	944

Dynamic White [Calculated L70 = 70000 hrs]
Tested with LL2DW-6.0-**-DRY-STD

	3000K
	LM/FT
17	227

Dynamic White High Efficacy [Calculated L70 = 70000 hrs]
Tested with LL2DW-**-30-DRY-STD

	3.0W/FT	5.0W/FT
	LM/FT	LM/FT
17	155	244

Static Color [Calculated L70 = 30000 hrs]
Tested with LL2SC-5.0-**-DRY-STD

	Red	Green	Blue	Amber
	LM/FT	LM/FT	LM/FT	LM/FT
17	90	490	127	82

RGB [Calculated L70 = 55000 hrs]
Tested with LL2RGB-6.0-RGB-DRY-STD

	Red	Green	Blue
	LM/FT	LM/FT	LM/FT
17	87	176	50

RGBW [Calculated L70 = 70000 hrs]
Tested with LL2RGBW-6.0-30-DRY-STD

	Red	Green	Blue	3000K
	LM/FT	LM/FT	LM/FT	LM/FT
17	32	108	28	86

Temperature Ratings Dependent on LED Strip W/FT

Light Engine (LED Strip)	W/FT	Minimum Limit (°F)	Maximum Limit (°F)
Static White	1.5	-40	138
	3.0	-40	124
	4.0	-40	115
	5.0	-40	108
Static White High-Efficacy	1.5HE	-40	152
	3.0HE	-40	140
	6.0HE	-40	118

LALO-OPTICS (02)

Linear Fixtures



Lens

with LED visibility

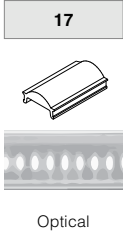

Mounting

2 clips provided for 4' or less; 4 clips provided for greater than 4'

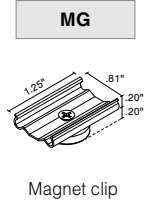
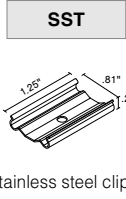

Type

SINGLE (Input only)

PASS THROUGH (Input/Output)

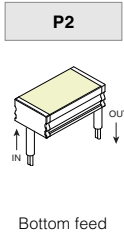
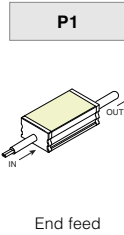
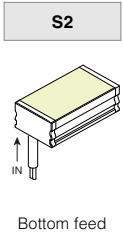
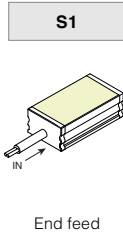

Finish



Connector/Wire – In/Out

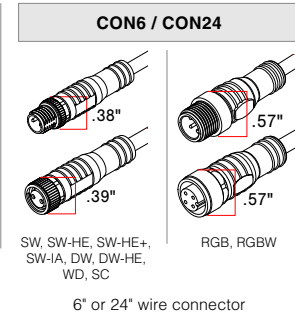
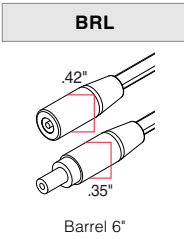
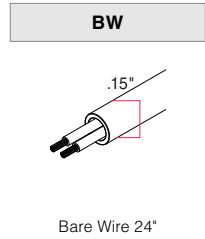

End Caps

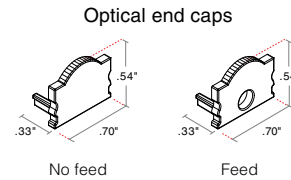

Cut Off

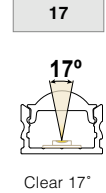

Dimensions

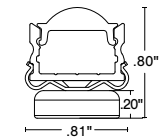
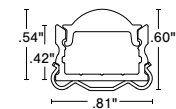
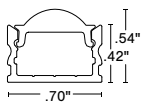

Length (in)

Add to nominal LED length for fixture length

