

HLEX SERIES

Hazardous Location Edge Lit LED Exit Light

- Class I, Division 2, Groups A, B, C & D
- Class II, Division 2, Groups F & G
- Class III
- UL 1598A Marine Outside Type
- Temperature Class (T-Rating)-T6
- Patent No. 7,287,347
- IP65
- ETL Listed

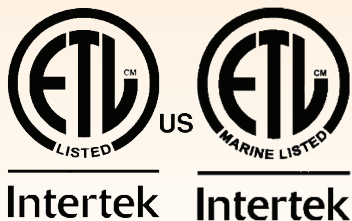

AZZ | R-A-L™
RIG-A-LITE

HLEX SERIES

Hazardous Location LED Edge Lit Exit Light

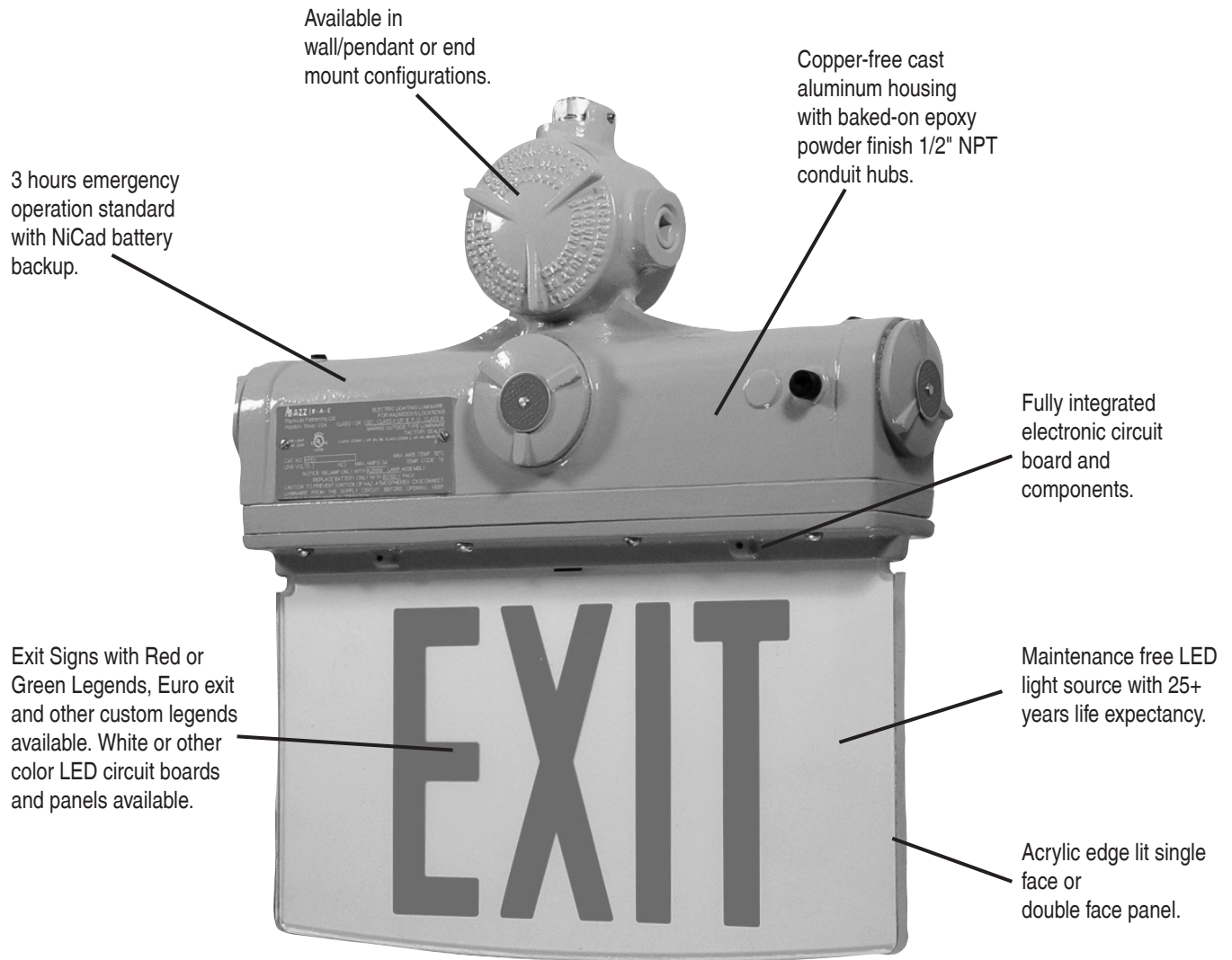

Patent Number 7,287,347

HLEX series fixture uses a maintenance free LED light source with a 25 year life expectancy. Emergency fixtures meet or exceed NFPA70, NFPA101, EPA Energy Star and OSHA requirements. These fixtures are also suitable for installation in wet or damp locations where salt water spray is possible.

LED

HLEX Series

Hazardous Locations • Class I, Division 2 • UL 844 • UL 1598A • UL 8750 • Wet Locations • IP65

Catalog Number Logic

HLEX

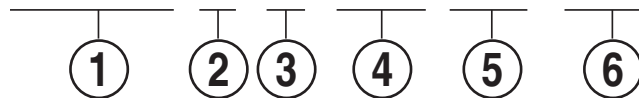

1

BASIC SERIES

HLEX Explosion Proof LED Exit Light
Class I, Division 2, Groups A, B, C, & D
Class II, Division 2, Groups F & G
Class III
UL 1598A Marine Outside Type
IP65
ETL Listed
Temperature Class (T-Rating)-T6

NUMBER OF FACES

1 = Single Face
2 = Double Face

3

LEGEND COLOR

R = Red
G = Green

4

VOLTAGE/FREQUENCY

DT = 120/277V 60 HZ
24 = 220-240V 50/60 HZ
Other voltages available- consult factory.

5

MOUNTING

WP = Wall/Pendant Mounting
EB = End Bracket

6

OPTIONS¹

EM = Emergency Battery Backup
EU = Green Running Man Exit Legend
SD = Self Diagnostics
X = Exit Legend in Other Languages
Language Must be Specified

¹Consult factory for pricing.

Maximum Input Power

Red no battery- 1.5 Watts
Red with battery- 2.5 Watts
Green no battery- 2.3 Watts
Green with battery- 3 Watts

Operating Temperature Range

Temperature Rating- T6
Red Legend
+10° C Minimum to +55° C Maximum
Green Legend
+10° C Minimum to +40° C Maximum

Catalog logic is for explaining catalog number structure only. Not all combinations are possible; consult factory for catalog numbers not listed in charts.

LED HLEX Series

Hazardous Locations • Class I, Division 2 • UL 844 • UL 1598A • UL 8750 • Wet Locations • IP65

HLEX Series Fixture Dimensions (inches)

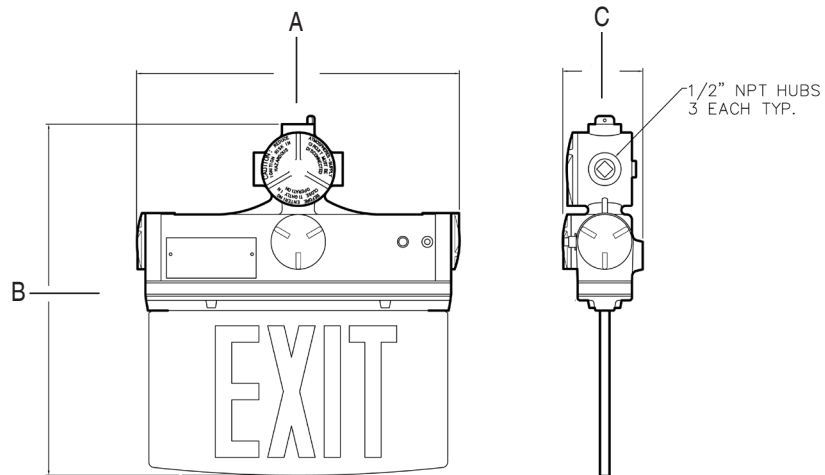

HLEX SERIES	Dimensions (inches)			Boxed Weight	Shipping Volume (Boxed Fixtures)
	A	B	C		
HLEX LED Exit Sign	14.88	16.00	3.69	14 lbs.	1.24 cu. ft.