

## VS46 Linear Luminaire



**Application:** The Vyv VS46 Linear Luminaire provides sleek lighting for both individual and continuous runs in indoor applications. Available with multiple mounting options.

**Mode Switching:** Use 'Antimicrobial+Light Mode' when both continuous antimicrobial action and illumination are needed and 'Enhanced Antimicrobial Mode,' which emits a higher dosage of Vyv's antimicrobial wavelengths, as an antimicrobial cleaning mode for when full illumination is not required. See installation instructions (INS-422) for wiring details.

## Product Specifications

**Lens:** Microlinear frosted lens is standard.

**Housing:** The VS46 is constructed from an extruded aluminum housing with internal components made from die formed cold rolled steel.

**Finish:** White antimicrobial polyester powder coat standard.

**Electrical:** LEDs coupled with high efficiency drivers provide quality illumination. Fixtures supplied with 0-10V dimming down to 1% as standard. Other dimming options are available (Consult Factory).

**LED:** Patented Vyv LED package. The range of CCT (correlated color temperature) follows the color uniformity guidelines of the American National Standard regarding specifications for the chromaticity of solid-state lighting (SSL) products as per ANSI C78.377-2017.

**Approvals:** Fixtures are cETLus listed for Damp Location. Wet location optional. EPA Est. 94839-RI-1. Covered by one or more of the following U.S. Patent Numbers: 9,333,274; 9,439,989; 9,713,223; 9,927,097; 10,357,582; 10,753,575



## Ordering

Project: \_\_\_\_\_ Date: \_\_\_\_\_  
 Luminaire Type: \_\_\_\_\_ Approved By: \_\_\_\_\_  
 Product Code: \_\_\_\_\_

Series	Distribution	Mounting	Features	CCT	Size	Diffuser	Finish
VS46						MFL	
	<b>D</b> Direct (Symmetric)	<b>AC</b> Adjustable Aircraft Cable (48" Standard)	<b>N</b> Dual Mode (Antimicrobial+Light Mode & Enhanced Antimicrobial Mode)	<b>30</b> 3000K	<b>2</b> 2'	<b>MFL</b> Microlinear Frosted Lens	<b>WHT</b> White
	<b>A</b> Direct (Asymmetric)	<b>P</b> Pendant/ Canopy (24" Standard)	<b>W</b> Antimicrobial +Light Mode	<b>35</b> 3500K	<b>3</b> 3'		Antimicrobial Polyester Powder Coat
	<b>DI</b> Direct (Symmetric)/ Indirect**	<b>SP</b> Swivel Pendant/ Canopy (45°/24" Standard)		<b>40</b> 4000K	<b>4</b> 4'		<b>CA</b> Custom Colors (Consult Factory)
	<b>AI</b> Direct (Asymmetric)/ Indirect**	<b>S</b> Surface			<b>5</b> 5'		
		<b>W</b> Wall			<b>6</b> 6'		
					<b>7</b> 7'		
					<b>8</b> 8'		
					<b>XX</b> XX' (Specify Row Length)		

Voltage	Options	Indirect Lumens Per Foot
UNV		
UNV 120/277V	<b>Wiring</b>	<b>ILF035</b> 350 <b>ILF120</b> 1200
	<b>BP</b> In Line Fusing	<b>ILF055</b> 550 <b>ILF145</b> 1450
	<b>Approval</b>	<b>ILF080</b> 800 <b>ILF170</b> 1700
	<b>WL</b> Wet Location	<b>ILF100</b> 1000 <b>ILF220</b> 2200

\*\*Indirect distribution supplied with nonantimicrobial standard white light only and is switched off in enhanced mode. 2' and 3' lengths featuring Dual Mode available with remote driver only.

## Electrical

Input Frequency	50/60Hz
Power Factor	>.9
Control	On/Off via standard light switch Antimicrobial+Light Mode to Enhanced Antimicrobial Mode (optional) via low voltage switch or controls.

## Performance

Configuration	W Direct
Watts/ft	17.5
Lumens/ft	1,078
Lumens/Watt	62

## Dimensions

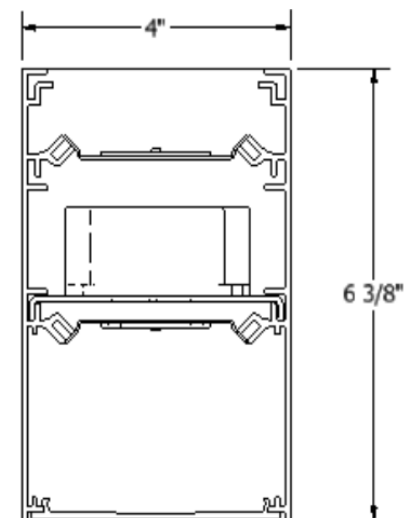

Consult Installation instructions for exact dimensions.

Some options may not be available in all combinations.  
 All fixture configurations subject to final factory approval.  
 Vyv will work with your facility to customize a design for lighting and antimicrobial action.  
 Vyv, Inc. reserves the right to upgrade and improve products without notice.

SPECIFICATIONS AND DATA SUBJECT TO CHANGE WITHOUT NOTICE

Updated August 1, 2022