

REMOVABLE CAP

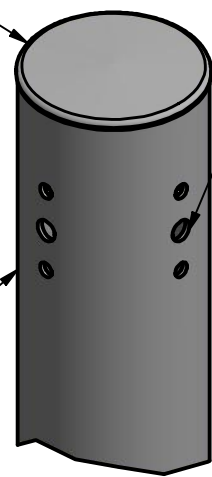

DRILL PER FIXTURE REQUIREMENTS:  
 D1 - DRILLED FOR 1 FIXTURE  
 D2 - DRILLED FOR 2 FIXTURES AT 90° OR 180°  
 D3 - DRILLED FOR 3 FIXTURES AT 90° OR 120°  
 D4 - DRILLED FOR 4 FIXTURES

POLE SHAFT

DRILLED MOUNT OPTIONS

TENON MOUNT OPTIONS:  
 T2- Ø2.38 OD X 4.00 LG  
 T2.5- Ø2.88 OD X 4.00 LG  
 T3- Ø3.00 OD X 5.00 LG  
 T4- Ø4.00 OD X 6.00 LG

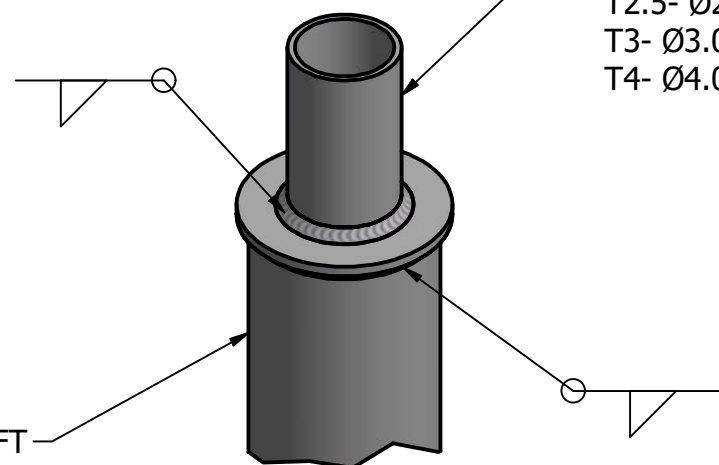

POLE SHAFT

TENON MOUNT OPTIONS

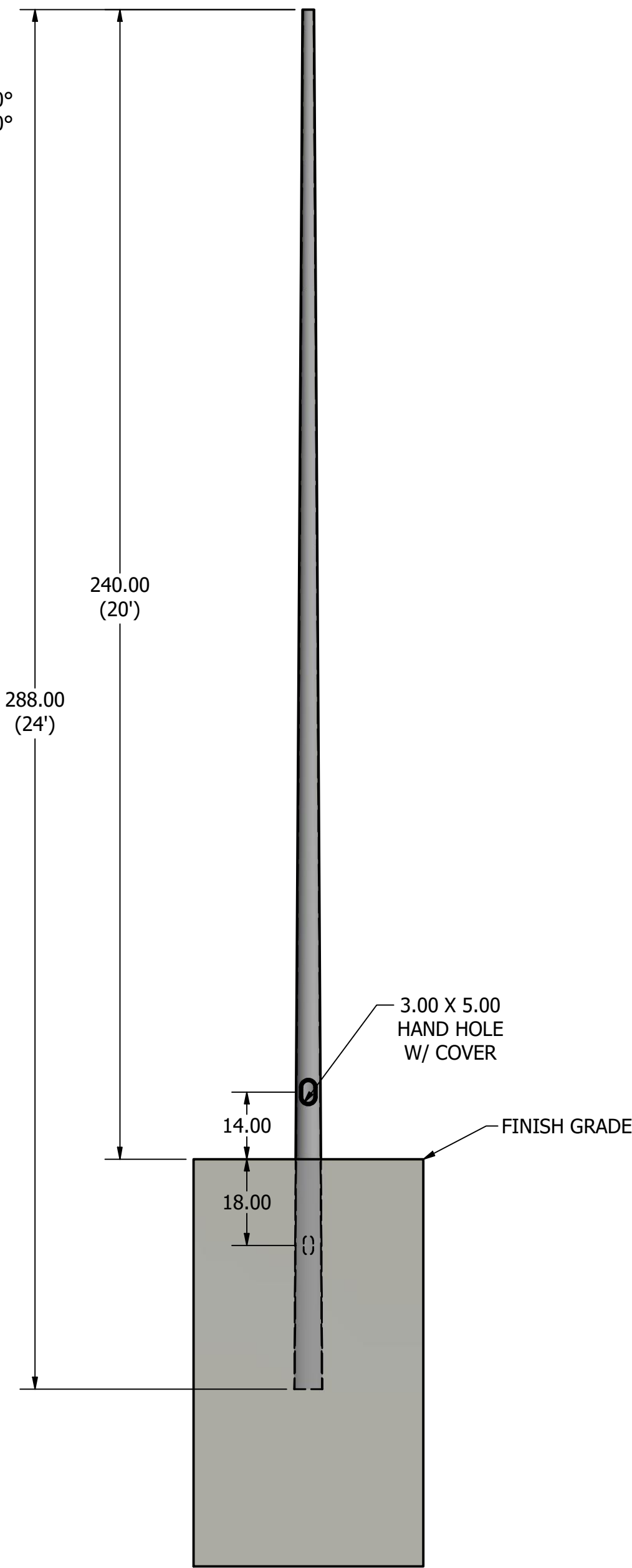

POLE DETAIL

POLE SPECIFICATIONS					
NO.	COMPONENT	ASTM DESIGNATION	MIN. YIELD (P.S.I)		
1.	POLE SHAFT	A-595 GR. A	55,000		
2.	BASE PLATE	A36	36,000		
3.	ANCHOR BOLTS	F1554 GR. 55	55,000		
4.	GALVANIZED HARDWARE	A153	-		
FINISH SPECIFICATIONS					
POLES SHALL HAVE A POLYESTER POWDER COAT FINISH IN A STANDARD COLOR.					
POLE DIMENSIONS					
POLE HGT. (FT.)	TOP DIA. (IN.)	BOTTOM DIA. (IN.)	GAGE	MTG. HGT. (FT.)	
24'	2.4	5.90	11 GAGE	20'	
ALLOWABLE WIND LOADING (SQ. FT.)					
WIND* EPA	INDICATED EPA	80 MPH	90 MPH	100 MPH	120 MPH
	-	12.2	9.8	7.9	6.2

\*WITH 1.3 GUST FACTOR

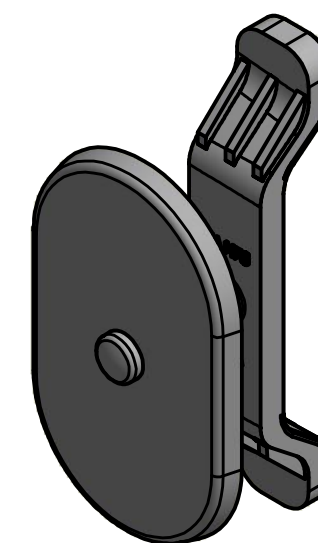

3.00 X 5.00 HAND HOLE COVER

NOTE: COAL TAR EPOXY COATING AVAILABLE AS AN OPTION FOR EMBEDDED PORTION PLUS 6 IN. OF THE POLE SHAFT.

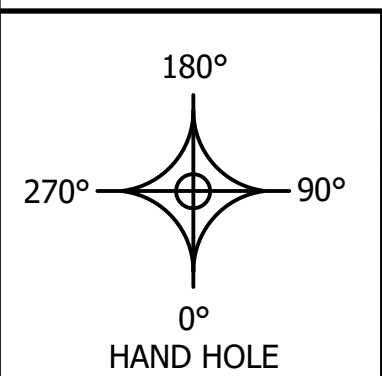

DRAWN: D. KONCHADA	DATE: 7/7/2020
REVISION:	DATE:
QUOTE:	PO.#
APPROVAL SIGNATURE:	

**UNITED LIGHTING STANDARDS**  
A DWM COMPANY

23171 Groesbeck Hwy.  
 Warren, MI 48089  
 P: (586) 774-5650 | F: (586) 774-5706  
[www.unitedlightingstandards.com](http://www.unitedlightingstandards.com)

SOME GEOGRAPHICAL AREAS HAVE SPECIAL WIND CONDITIONS THAT CAN CREATE WIND INDUCED VIBRATIONS CAUSING A FATIGUE PROBLEM. NO METHOD HAS YET BEEN FOUND FOR PREDICTING DESTRUCTIVE LIGHTING POLE VIBRATION. THESE CONDITIONS ARE UNIQUE AND CANNOT BE GUARANTEED AGAINST, AND ARE THE RESPONSIBILITY OF A LOCAL SITE ENGINEER.		
<b>WARNING: DO NOT INSTALL LIGHT POLE WITHOUT INTENDED LOADING.</b>		
TITLE:		
CATALOG:		
DWG NO: RTS-20-5911-EMB	SIZE: C	SHEET 1 OF 1