

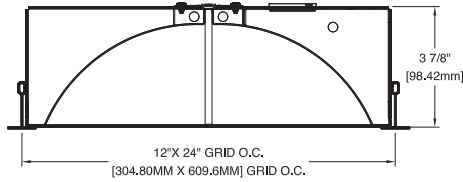

# Skyblade Series | SKBL 1x2

|         |     |       |
|---------|-----|-------|
| Date    |     | Notes |
| Project |     |       |
| Type    | Qty |       |



## Features

- Edge-Lit with LED optimized clear acrylic center beam.
- Concave housing delivers smooth semi-direct illumination.
- For installation in suspended grid ceilings, including Slot Grid and Tegular.
- High efficiency driver for custom lumen packages. 0-10V dimming to 1% standard.
- High efficacy LEDs in 80 or 90 CRI; two or three channel tunable white; tunable color.

## Ordering Guide

| MODEL            | OPTICS                  | CCT <sup>1</sup>  | LUMENS <sup>2</sup>   | SIZE     | MOUNTING <sup>3</sup>   | FINISH   | OPTIONS   |
|------------------|-------------------------|---|---|----------|---|--|---|
| <b>SKBL-D</b>    | <b>CA</b>               |   |   |          |   |  |   |
| SKBL-D<br>Direct | CA = Clear Acrylic Lens | 27 = 2700K 80CRI<br>30 = 3000K 80CRI<br>35 = 3500K 80CRI<br>40 = 4000K 80CRI<br>50 = 5000K 80CRI<br><br>For 90 CRI add "9" prefix. Ex: 940 = 4000K @ 90 CRI<br><br><b>TUNABLE WHITE<sup>1</sup></b><br><br><u>2-Channel</u><br>2DIM10 = for 0-10V<br>2DALI = for DALI<br>2DMX = for DMX<br>2PSQ = for Lutron<br>2SNS = for Signify<br>2CAS = for Casambi<br><br><u>3-Channel</u><br><br>3DLM = for DLM<br><br>For RGB and RGB/W options see page 3. | LO = 1613 (24W, 82LPW)<br>SO = 2200 (32W, 80LPW)<br>HO = 2750 (40W, 78LPW)<br>@3500K<br><br>Consult factory for additional lumen packages.<br><br>All values nominal. | 12 = 1x2 | G = Grid<br>MG = Mini Grid<br><br>SG = Slot Grid<br>S = Surface<br><br>See all mounting options page 2. | W = White<br>CC = Custom Color<br><br>AMW = Anti-Microbial White | <b>DIMMING DRIVERS</b><br>DIM10 = 0-10V (1.0%) - <b>Standard</b><br>DIMSR = 0-10V (5.0%) Sensor Ready<br>DIMST = Step Dimming (40%/100%)<br>DALI = DALI (5.0%)<br><br><b>LUTRON™ DIMMING DRIVERS</b><br>LDE1 = Hi-Lume 1% EcoSystem<br>LDE5 = 5-Series 5% EcoSystem<br>L3DA3W = Hi-Lume 1% 3-Wire<br>LTEA2W = Hi-Lume 1% 2-Wire 120V<br><br><b>SENSORS &amp; CONTROLS</b><br>ESN = Philips™ EasySense<br>DAY = Daylight Harvesting<br>OCC = Occupancy Sensor<br>LVC = 2-Channel LV Controller<br>VDO = Vive Sensor by Lutron<br><br><b>EMERGENCY</b><br>EPC4 = (4W) 400 Delivered Lumens<br>EPC7 = (7W) 700 Delivered Lumens<br>EPC10 = (10) 1000 Delivered Lumens<br>EPC12 = (12W) 1200 Delivered Lumens<br>GTD = Generator Transfer Device<br>EMC = Emergency Circuit |

<sup>1</sup>Tunable white, tunable color and RGB/W options detailed on page 3.

<sup>2</sup>Delivered Lumens are Standard Output (SO) and Low Output (LO) at 80+CRI 4000K CCT. Use the following multiplier to estimate delivered lumens at other CCTs: 2700K = 0.94, 3000K = 0.96, 3500K = 0.98, 5000K = 1.02. All values nominal. See page 2 for photometry.

<sup>3</sup>See page 2 for ceiling mounting options details and full specifications.



## Mounting Options

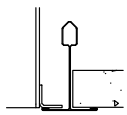

15/16" T-Bar  
(G)

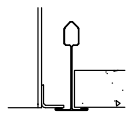

9/16" T-Bar  
(MG)

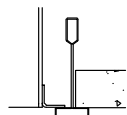

Slot Grid  
(SG)

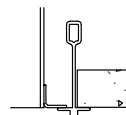

Interlude  
(XG)

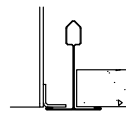

15/16" Tegular  
Flush  
(TGF)

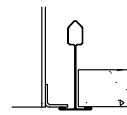

9/16" Tegular  
Flush  
(MTGF)

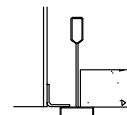

Slot Grid Flush  
(SGF)

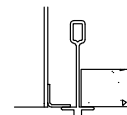

Interlude Flush  
(XGF)

## Grid Ceiling Install

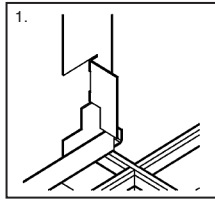

1. Position Fixture

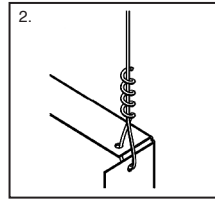

2. Secure Tie Wire

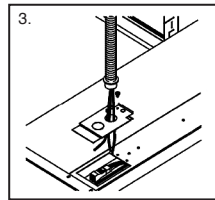

3.

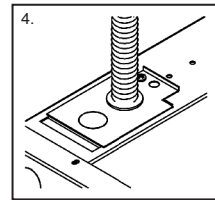

4.

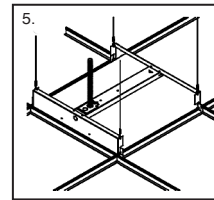

5.

## Photometry

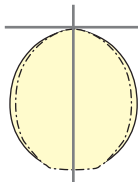

### SKBL-D-AS-40-SO-12

CCT: 3500K  
WATTS: 32  
LUMENS: 2200  
LPW: 80  
Distribution:  
100% Direct

Consult factory for additional lumen information.

## Specifications

**CONSTRUCTION:** 20 gauge CRS housing and internal components.

**REFLECTOR:** 20 gauge CRS finished in highly reflective baked white enamel.

**OPTICS:** LED optimized clear acrylic (CA) center lens.

**LED:** LED modules in 30/35/40 & 50K CCT, 80 CRI (90CRI available).  $L_{70}$  = 50,000 hours. 3 SDCM color consistency; field replaceable.

**DRIVER** Standard driver is Class 2 AOC 0-10V to 1%, 120/277V input, PF > 90%, THD < 20 @ 120V. Additional dimming protocols available. All drivers prewired from factory for connection to control system (by others); field replaceable.

**MOUNTING:** Standard installation is in an exposed inverted T-bar ceiling. Fixtures are supplied with four support brackets for additional support to T-bar. May also be installed in a plaster ceiling (F/TRL mounting option with Flange).

**FINISH:** Housing and components finished in baked white enamel. Anti-microbial finish available.

**CERTIFICATION:** Luminaires are cETLus listed conforming to UL STD. 1598 and certified to CSA STD C22.2 NO. 250.0. Suitable for dry & damp locations. Union Made in the United States of America. I.B.E.W. RoHS compliant.

Day-O-Lite offers a variety of tunable white and tunable color options for a range of human centric applications and budgets. It is recommended that a recognized authority on the benefits and best practices of tunable white be consulted prior to specification. As a rule, fewer channels will provide a basic level of performance for budget conscious applications. Conversely, an increased number of channels, a wider CCT range, higher CRI and more precise color consistency may be more appropriate depending on the application and desired results.

### HOW TO SPECIFY

Select from the various channel/control options below and insert desired **Ordering Code** into the **COLOR TEMP** column of the Ordering Guide on page 1. No need to add a dimming option as the codes include the chosen protocol.

### 2-CHANNEL TUNABLE WHITE OPTIONS

2700K - 6500K CCT range  
1000L/ft LED modules @ 4000K  
80+ CRI w/3SDCM color accuracy  
10W/ft. nominal power

#### Ordering Codes

**2DIM10** for 0-10V control  
**2DALI** for DALI control  
**2DMX** for DMX control  
**2PSQ** for Lutron Quantum control  
**2SNS** for control via Signify SNS sensors  
**2CAS** for control via Casambi BLE wireless devices

### LEGRAND BLANCO MULTI-CHANNEL OPTIONS

#### Blanco-2

Blanco-2 mixes two channels of white LEDs to approximate the blackbody curve for tunable white applications. CCT and intensity may be adjusted with controls by others.

3000K-5000K CCT range  
1000L/ft LED modules @ 4000K  
90+ CRI w/2SDCM color accuracy  
10W/ft. nominal power

#### Ordering Codes

**B2DLM** for DLM control

#### Blanco-3

Blanco-3 mixes three channels of white LEDs across a wider range of color temperatures for more demanding tunable white applications. CCT and intensity may be adjusted with controls by others.

2700K-6500K CCT range  
1000L/ft. LED modules @ 4000K  
90+ CRI w/2SDCM color accuracy  
10W/ft. nominal power

#### Ordering Codes

**B3DLM** for DLM control

### RGB & RGBW TUNABLE COLOR

3-Channel RGB = Red, Green, Blue  
4-Channel RGB/W = Red, Green, Blue + White of chosen CCT  
Dimming from 100% to 1%.  
90+ CRI w/3SDCM color accuracy  
10W/ft. nominal power

#### Notes:

RGB requires an RGB DMX or DALI controller (by others)

RGBW requires an RGBW DMX or DALI controller (by others)

All channels on one driver is standard, if isolating the White from the RGB channels is desired please consult factory.

RGB and RGBW are not recommended for tunable white applications.

#### Ordering Codes

**RGB** for DMX control  
**RGB27** for DMX control w/2700K white  
**RGB30** for DMX control w/3000K white  
**RGB35** for DMX control w/3500K white  
**RGB40** for DMX control w/4000K white  
**RGB50** for DMX control w/5000K white  
**RGB65** for DMX control w/6500K white  
Add Suffix **DAL** for DALI Control to codes above.

### 5-CHANNEL TUNABLE WHITE AND COLOR

RGBWW = Red, Green, Blue, Warm White, Cool White.

Consult factory for RGBWW tunable white/color options.

Day-O-Lite makes no claims as to the psychological or physiological efficacy of the white color tuning options offered herein.