

3G LIGHTING

3G-1PLI-D

1.5" LINEAR PENDANT
DIRECT

Narrow 1.5" aperture with one piece extruded aluminum housing
Individual or continuous runs available in multiple run configurations
Direct distribution with multiple lumen output options
LED system with performance up to 111 lumens per watt
Extruded acrylic lens with optimal performance and glare control
Asymmetric optics available
1% dimming standard with several driver options



ORDERING INFORMATION

PROJECT:	<input type="text"/>	TYPE:	<input type="text"/>
CATALOG #:	<input type="text"/>	DATE:	<input type="text"/>

CAT. NO	LUMEN OUTPUT	CRI	COLOR TEMP	VOLTAGE
3G-1PLI-D	L250 - LOW OUTPUT (250 LM/FT) ¹ L500 - MEDIUM OUTPUT (500 LM/FT) L750 - HIGH OUTPUT (750 LM/FT) L1000 - VERY HIGH OUTPUT (1000 LM/FT) ² LC___ - CUSTOM OUTPUT (SPECIFY LM/FT) [*] <small>*Specify custom lumen outputs in 50lm increments (ie: LC600, LC650, LC700) Custom output cannot exceed LC1000</small>	S80 - 83+ CRI H90 - 93+ CRI	27K - 2700K 30K - 3000K 35K - 3500K 40K - 4000K	UNV - 120/277V 347 - 347V (0-10V ONLY)

DRIVER	LENS OPTION	FINISH	CABLE LENGTH
DIM - 0-10V (STANDARD 100-1%) DHL2 - LUTRON HI-LUME LDE1 (100-1% ECOSYSTEM) DALI - DALI (eldoLED, 100-1%) ³ D01 - 0-10V (eldoLED, 100-0.1%)	FL - FLUSH DASY - ASYMMETRIC OPTIC	WH - WHITE (STANDARD) SV - SILVER BK - BLACK <small>All mounting canopies provided in white as standard</small>	60" - 60" (STANDARD) 120" - 120"

OPTIONS	LENGTH (FEET)
EMC - EMERGENCY CIRCUIT	S - ___' (STRAIGHT RUN) [*] L - ___'X ___' (L-SHAPE) U - ___'X ___' X ___' (U-SHAPE) R - ___'X ___' (RECTANGLE/SQUARE) T - ___'X ___' (T-SHAPE) X - ___'X ___' (X-SHAPE) CUS - ___' (CUSTOM LAYOUT - PROVIDE DRAWING) <small>*Individual units available in 2', 3', 4', 5', 6', and 8' Continuous runs available in 1' increments as standard</small>

¹ L250 (250LM/FT) not available in 2' and 3' lengths. Specify LC400 for 2' and 3' fixture lengths when outputs lower than 500LM/FT are required

² L1000 (1000LM/FT) not available with H90 (93+ CRI)

³ DALI-2 (Type 6) provided as standard. Please consult factory for DALI (Type 8) options

OCTOBER 14 2020

PERFORMANCE CHART BASED ON 4' LENGTH (83+ CRI AND 3500K SOURCE)

LENS OPTION	DELIVERED LUMENS (LM/FT)	SYSTEM WATTS (W/FT)	EFFICACY (LPW)
FLUSH	250	2.3	110
	500	4.5	111
	750	7.2	105
	1000	9.9	101
ASYMMETRIC	250	2.3	106
	500	4.5	105
	750	7.2	102
	1000	9.9	102
LUMEN OUTPUT ADJUSTMENT FACTORS	CCT	Multiplier	
	2700K	0.94	
	3000K	0.97	
	3500K	1.00	
	4000K	1.01	
EFFICACY (LPW) ADJUSTMENT FACTOR	CRI	Multiplier	
	93+	0.88	

PHOTOMETRY BASED ON 4' LENGTH (83+ CRI AND 3500K SOURCE)

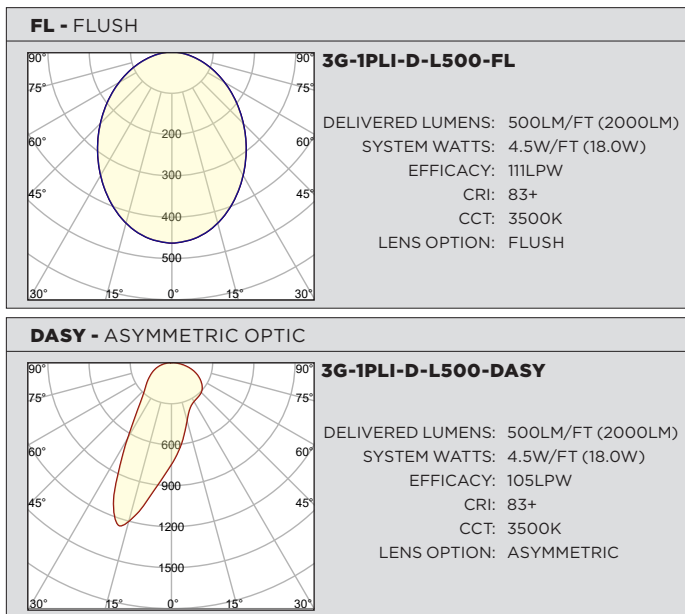

TECHNICAL**HOUSING**

Extruded aluminum housing with narrow 1.5" aperture
Machined aluminum end caps add 1/4" to each end of luminaire
Individual units and continuous runs available in 1' increments
24-gauge LED reflector with high reflectance white powder coated finish
Standard polyester powder coated matte white finish. Optional finishes available

OPTICS

Extruded, satin acrylic lens designed for optimal performance and glare control. Up to 8' continuous
High performance asymmetric optics available

ELECTRICAL

Luminaires are pre-wired with factory installed quick connects and branch circuit wiring
Standard 0-10V, constant current drivers with 100-1% dimming range and >0.9 power factor
Standard 120/277V universal voltage drivers. Optional 347V, 0-10V drivers
Lutron EcoSystem and eLdoLED DALI options available with 100-1% dimming range
All drivers are integral and easily accessible through luminaire aperture

LED SYSTEM

Proprietary LED system with color consistency <3 SDCM
Available in 27K, 30K, 35K, and 40K
Standard 83+CRI. Optional 93+CRI
R9 value of 56 for 93+CRI
L90 >60,000 hours
5 Year Warranty

MOUNTING

Toolless installation with 3G's proprietary mounting system
Internal, toolless joiner system (latch and hook) easily connects multiple sections together
LED reflectors remain within each fixture section during installation with 3G's click and lock spring system
Adjustable aircraft cable suspension with locking fasteners (60" length standard)
Standard, 18-gauge, 5 conductor single circuit power feed (clear braided finish)
All mounting canopies provided in white finish as standard
Suitable for various architectural ceilings (see mounting details)
Fixture weight: +/- 2.5 lb/ft

LISTING

ETL listed and tested to cUL standards. Suitable for dry and damp locations

WARRANTY

5 Year Warranty on LED and drivers
Manufacturer 1 Year Warranty for defects in material and workmanship under normal use
Ambient temperature at fixture should not exceed 25°C

DRAWINGS AND DIMENSIONS

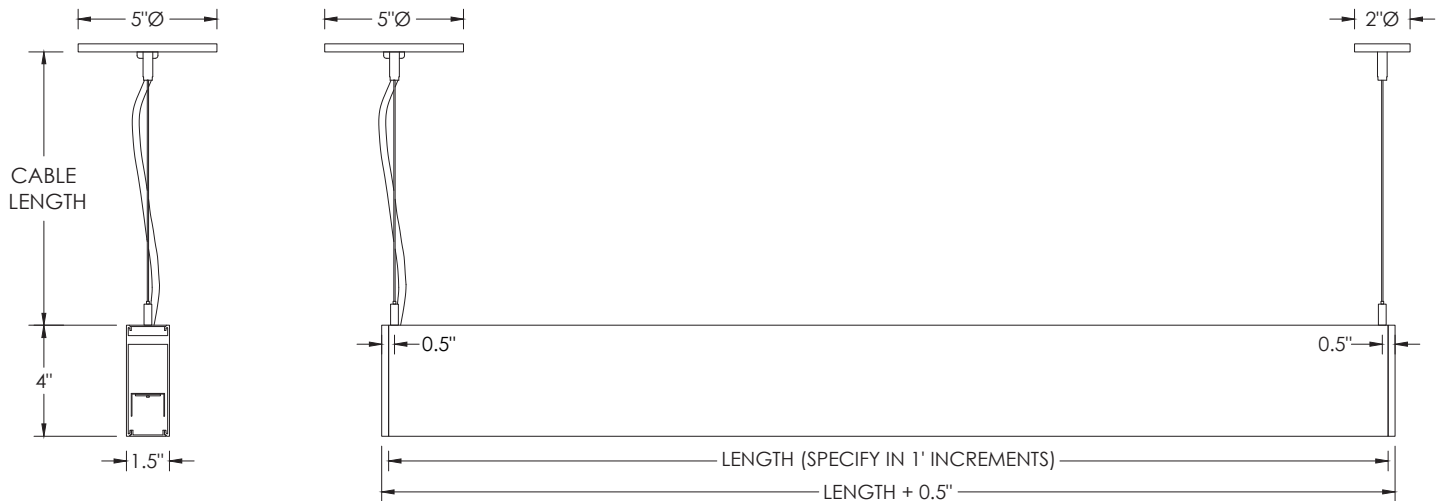

LENS OPTION

FL - FLUSH **ASY** - ASYMMETRIC

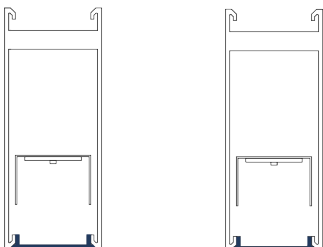

PATTERNS

Specify pattern shape and overall dimensions as shown below
Patterns are connected with fully illuminated 12"x12" L, T, and X-shaped sections
Please consult factory for custom patterns and shapes not shown below

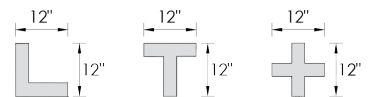

L-SHAPE	U-SHAPE	RECTANGLE/SQUARE	T-SHAPE	X-SHAPE
Provide dimensions of AxB Example: L - 6'x8'	Provide dimensions of AxBxC Example: U - 8'x10'x6'	Provide dimensions of AxB Example: R - 10'x8'	Provide dimensions of AxB Example: T - 14'x6'	Provide dimensions of AxB Example: X - 14'x14'

TYPICAL SECTION MOUNTING (AVAILABLE IN 1' INCREMENTS AS STANDARD)

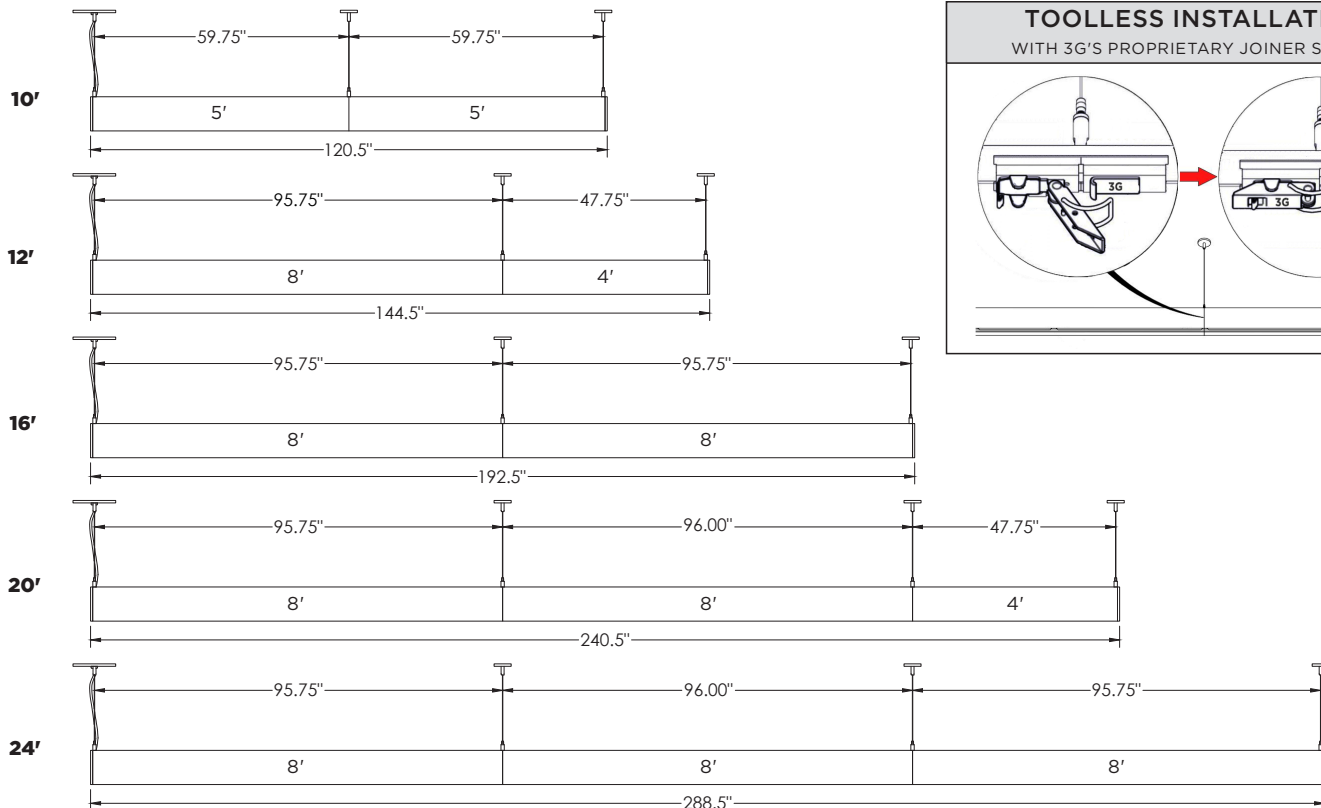

TOOLLESS INSTALLATION WITH 3G'S PROPRIETARY JOINER SYSTEM

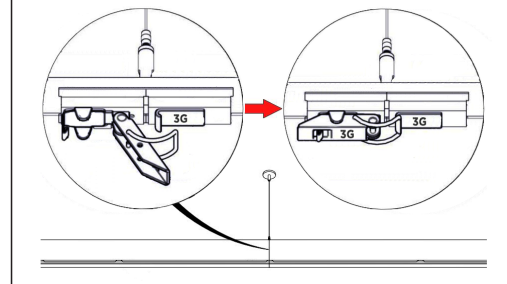

MOUNTING DETAILS

