

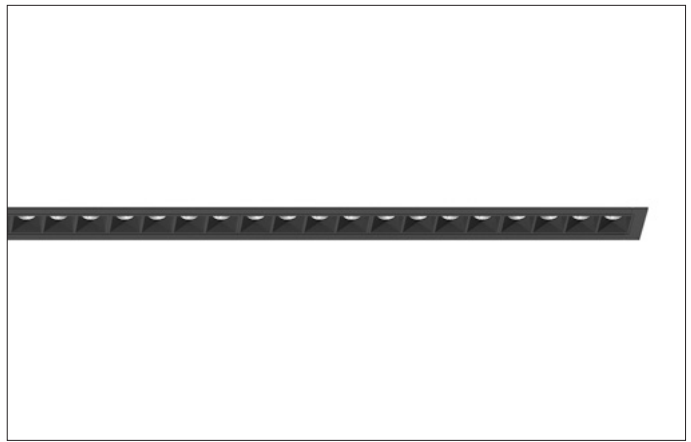

3G-1RMZSL

1.5" RECESSED ZONE SLOT



Narrow 1.5" aperture with one piece extruded aluminum housing
 High performance, mini downlights delivering up to 1250 lumens per foot
 Features matte black or matte white multi-faceted louvers
 Regressed LED source with enhanced glare control, UGR <16
 Available in individual units or continuous runs in 1' increments
 Suitable for drywall, wood, and various architectural ceilings
 100-1% dimming standard with several integral driver options

ORDERING INFORMATION

PROJECT:	<input type="text"/>	TYPE:	<input type="text"/>
CATALOG #:	<input type="text"/>	DATE:	<input type="text"/>

CAT. NO	LUMEN OUTPUT *	CRI	COLOR TEMP	BEAM ANGLE	VOLTAGE
3G-1RMZSL	D250 - 250LM/FT	H90 - 90+ CRI	27K - 2700K	15D - 15°	UNV - 120/277V 120 - 120V 347V - 347V ¹
	D500 - 500LM/FT		30K - 3000K	35D - 35°	
	D750 - 750LM/FT		35K - 3500K	55D - 55°	
	D1000 - 1000LM/FT		40K - 4000K		
	D1250 - 1250LM/FT				
* Delivered Lumens					

DRIVER	FLANGE TYPE & FINISH	LOUVER FINISH	OPTIONS
DIM - 0-10V (100-1%) LE - PHASE DIM (TRIAC/ELV, 100-1%) ² DALI - DALI (100-1%) ³ DO1 - 0-10V (100-1%) DHL2 - LUTRON HI-LUME (1% ECOSYSTEM)	WT - WHITE TRIM & WHITE HOUSING BT - BLACK TRIM & BLACK HOUSING FXW - FLANGELESS & WHITE HOUSING FXB - FLANGELESS & BLACK HOUSING XTR - TRIMLESS & WHITE HOUSING	BLV - BLACK WLW - WHITE	EMC - EMERGENCY CIRCUIT

RUN TYPE
S - ____' (STRAIGHT RUN)
<small>* Individual units available from 2' to 8' Continuous runs available in 1' increments only</small>

¹ 347V only available with "DIM" option (0-10V, 1%)
² Forward phase / reverse driver available in 120V only
³ DALI-2 (Type 6) provided as standard. Please consult factory for DALI (Type 8) options

SEPTEMBER 27, 2021



PERFORMANCE CHART BASED ON 35°, 90+ CRI AND 3500K SOURCE

FIXTURE LENGTH	DELIVERED LUMENS (LM/FT)	SYSTEM WATTS (W/FT)	EFFICACY (LPW)
4' - ZONE	250	3.0	85
	500	5.9	86
	750	8.7	89
	1000	11.4	90
	1250	13.9	91

LUMEN OUTPUT ADJUSTMENT FACTORS	CCT	Multiplier
	2700K	0.93
	3000K	0.96
	3500K	1.00
	4000K	1.02

PHOTOMETRY BASED ON 4' LENGTH, 90+ CRI AND 3500K SOURCE

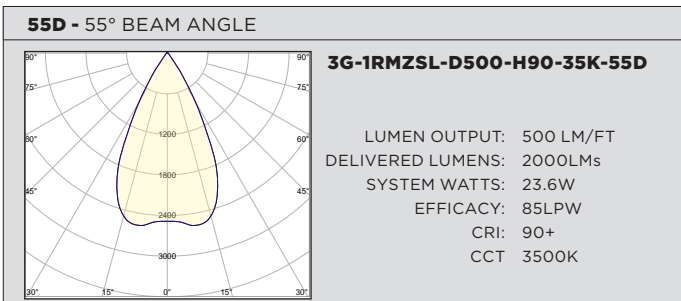
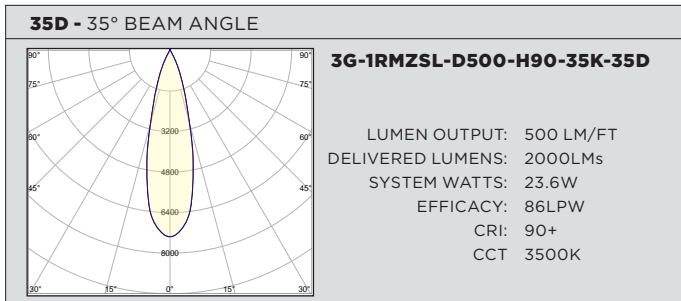
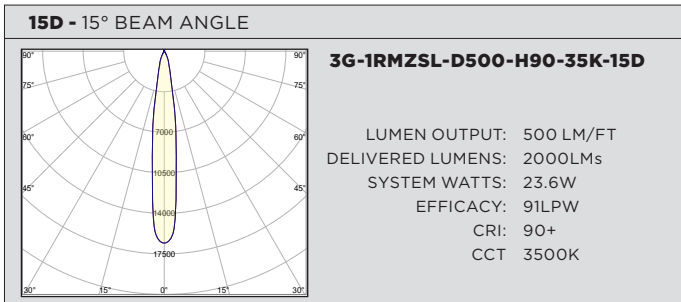

TECHNICAL**HOUSING**

Extruded aluminum housing with narrow 1.5" aperture
Individual units and continuous runs available in 1' increments
Trim flange with powder coated finish and minimal 0.400" overlap
Trimless model features a satin coat mudding flange for seamless ceiling
Standard polyester powder coated housing available in white and black
Matte black and matte white faceted louver finishes

OPTICS

1" apertures with regressed LED source for enhanced glare control
Proprietary polycarbonate multi-faceted reflectors
Available in 15°, 35° and 55°
UGR <16

ELECTRICAL

Luminaires are pre-wired with factory installed quick connects and branch circuit wiring
Standard 0-10V, constant current drivers with 100-1% dimming range and >0.9 power factor
120V Forward Phase/Reverse Phase driver option with 100-1% dimming range
Standard 120/277V universal voltage with several driver options
All drivers are integral and easily accessible through luminaire aperture

LED SYSTEM

Osram LED source
Color consistency <2 SDCM
Standard 90+ CRI
Available in 27K, 30K, 35K, and 40K
L90 >60,000 hours
5 year warranty

MOUNTING

Toolless installation with 3G's propriety mounting system
Internal, toolless joiner system (latch and hook) easily connects multiple sections together in continuous runs
Housing suspended via ¼" threaded rod or suspension cables (by others)
Trim fixture designed for use in drywall, wood, and other architectural ceilings
Trimless fixture designed for use in drywall, mud-in ceiling applications
Flangeless fixture designed for use in wood ceilings
Fixture weight: +/- 3 lbs/ft

LISTING

ETL listed and tested to cUL standards. Suitable for dry and damp for indoor use only

WARRANTY

5 Year Warranty on LED and drivers
Manufacturer 1 Year Warranty for defects in material and workmanship under normal use
Ambient temperature at fixture should not exceed 25°C

DRAWINGS AND DIMENSIONS HARD CEILING

WT - TRIM

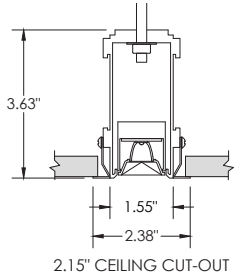

XTR - TRIMLESS

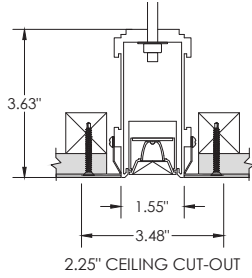

FX - FLANGELESS

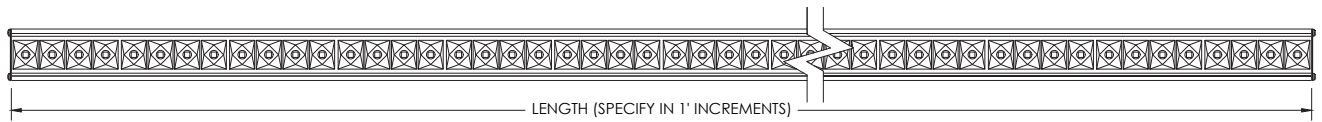
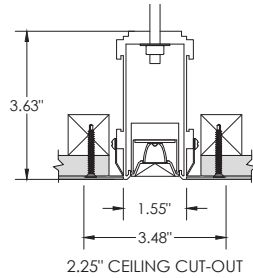

MOUNTING DETAILS

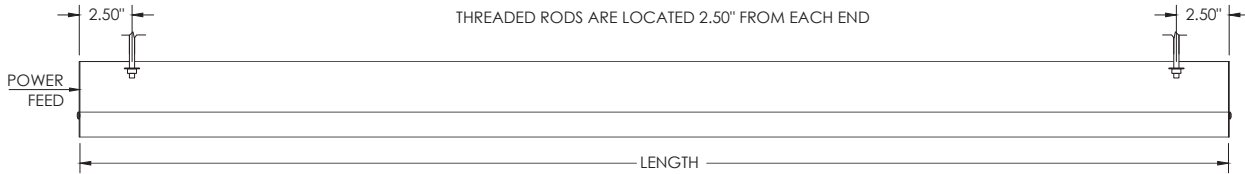

BEAM ANGLE

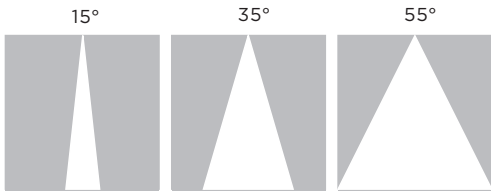

TYPICAL SECTION MOUNTING DETAILS AVAILABLE IN 1' INCREMENTS AS STANDARD

