

# BULLETTO LINE EVENT POLE

## Multi-headed Event Pole with Professional Adjustable Floodlight Projector

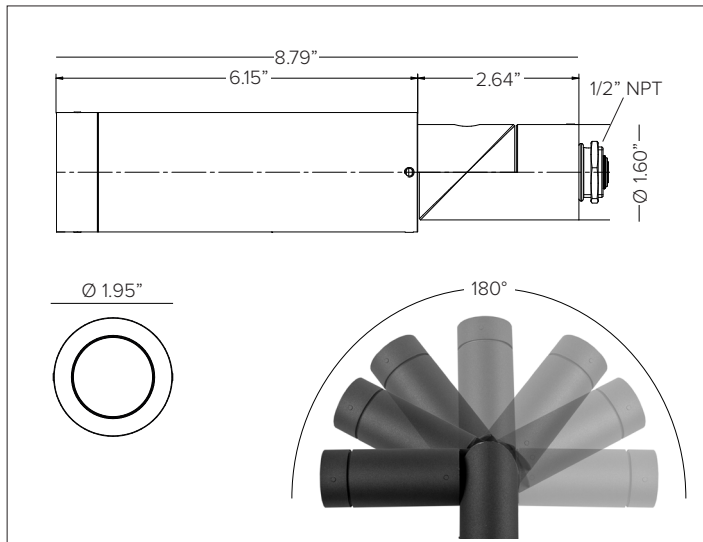

Event Pole with BULLETTO LINE shown in Ferrite Dark Grey finish.



### CONCEPT

Event pole with compact adjustable LED floodlight projector.

### FIXTURE MECHANICAL CHARACTERISTICS

<b>Housing</b>	1.95" W x 8.79" D
<b>Materials</b>	Aluminum body and joints for maximum heat dissipation.
<b>Finish</b>	Textured finish. ● Ferrite Dark Grey
<b>Power Connection</b>	Pre-cabled with 10' Belden direct burial 18-6 cable, optional 25ft length for pole mounting.
<b>Functionality</b>	Modular body for toolless maintenance. IP66 protection rated optical chamber with removable front cap for simple toolless field interchangeability of optics and accessories.
<b>Weight</b>	2lbs
<b>Protection</b>	IP66
<b>Resistance</b>	IK08

### POLE MECHANICAL CHARACTERISTICS

<b>Materials</b>	Steel pole: Hot-galvanized EN ISO 1461. Integral hatch door for utility power.
<b>Finish</b>	Textured finish. ● Ferrite Dark Grey
<b>Foundation</b>	31.5" x 31.5" x 31.5" H
<b>Anchor Bolts</b>	(4pcs) 3/4" x 24" x 3" J-Bolts included
<b>Horizontal Displacement</b>	CL1
<b>Thickness</b>	0.12"
<b>MPH</b>	140mph
<b>EPA</b>	(13ft) 0.215 sqft (4 fixtures max) (16ft) 0.431 sqft (8 fixtures max) (Individual fixture) 0.054 sqft

### CERTIFICATIONS

cULus Wet Location Listed.  
Tested in accordance with LM-79-08.  
Compliant for California installations.  
IEC 62471  
RoHS3 EU 215/863

### WARRANTY

5 year limited warranty

<sup>A</sup> Consult factory for use in marine grade environments.

### ELECTRICAL CHARACTERISTICS

<b>Power Supply</b>	Integral 4/1 smart driver (Non-Dimmable / 0-10V / Reverse Phase / Forward Phase).
<b>Wattage</b>	9W (NSP) / 17W (SP/FL/MWFL/WFL)
<b>Voltage</b>	Universal Voltage 120-277V AC 50/60Hz

### SOURCE

High efficiency LED Emitter

TM30	CCT (Nominal)	CRI	Rf	Rg	SDCM
	2700K	90	88	95	2
	3000K	90	91	98	2
	3500K	90	89	96	2
	4000K	90	88	94	2

### OPTIC

Optical system is dependent on beam angle. NSP version PMMA lens and fixed holographic filter. SP / FL / MWFL / WFL versions equipped with PMMA lens and interchangeable optical holographic lens, factory preset per specified optic with other beams included in packaging.

Beam	NSP 9°	SP 16°	FL 25°	MWFL 31°	WFL 42°
<b>Delivered Lumens</b>	<b>2700K</b> 407Lm	1394Lm	979Lm	930Lm	764Lm
	<b>3000K</b> 430Lm	1085Lm	1054Lm	1001Lm	823Lm
	<b>3500K</b> 445Lm	119Lm	1088Lm	1033Lm	849Lm
	<b>4000K</b> 460Lm	1153Lm	1120Lm	1063Lm	874Lm
<b>Efficacy</b>	70Lm/W max. Refer to photometric graphs for specific values.				
<b>Lifetime</b>	L96/B10 30,000hrs at max TA +25°C L95/B10 50,000hrs at max TA +25°C L94/B10 80,000hrs at max TA +25°C L93/B10 100,000hrs at max TA +25°C				
<b>Photobiological Classification</b>	Low risk safety RG1				

# BULLETTO LINE EVENT POLE

## SPECIFICATION INFORMATION



1 - PRODUCT CODE	2 - DRIVER	3 - FINISH	4 - WATTAGE	5 - OPTIC	6 - KELVIN	7 - CABLE
<b>BLL</b> — BULLETTO LINE	<b>41</b> — 4/1 Smart Dimming (Non-Dimming / 0-10V / Reverse Phase / Forward Phase)	<b>FE</b> — Ferrite Dark Grey <b>RAL</b> — <a href="#">Custom RAL</a>	<b>L1</b> — 7W <b>L2</b> — 17W	<b>NS</b> — NSP 9° <b>SP</b> — SP 16° <b>FL</b> — FL 25° <b>MF</b> — MWFL 31° <b>WF</b> — WF 42°	<b>27</b> — 2700K <b>30</b> — 3000K <b>35</b> — 3500K <b>40</b> — 4000K	<b>PM</b> — 25ft Cable
8 - EVENT POLE	9 - MOUNTING BRACKET	10 - POLE ACCESSORIES	11 - OPTICAL ACCESSORIES			
<a href="#">13ft Pole</a> See section for details <a href="#">16ft Pole</a> See section for details	<a href="#">1 Fixture Bracket</a> See section for details <a href="#">2 Fixture Bracket</a> See section for details <a href="#">3 Fixture Bracket</a> See section for details <a href="#">4 Fixture Bracket</a> See section for details	<a href="#">Decorative Base Cover</a> See section for details	<a href="#">Blade of Light Linear Spread Lens</a> See section for details <a href="#">Anti-glare Louver</a> See section for details <a href="#">Asymmetric Screen</a> See section for details <a href="#">Lumishape Optical Accessories</a> See section for details			

## OPTIC DETAILS

*Fixed Optic (NSP)*



*Interchangeable Multi Optic (SP / FL / MWFL / WFL)  
Factory preset per specified optic with other beams included in packaging.*



# BULLETTO LINE EVENT POLE

## 8 - EVENT POLE (REQUIRED)

13ft round powder coated steel pole. Hot-galvanized EN ISO 1461 with integral hatch door for utility power. Maximum of 1 bracket (4 fixtures).

Level	Single
Finish	● Ferrite Dark Grey
Part No.	<b>1USP01FE13S</b>

16ft round powder coated steel pole. Hot-galvanized EN ISO 1461 with integral hatch door for utility power. Maximum of 1 bracket (4 fixtures).

Level	Single	Dual
Finish	● Ferrite Dark Grey	
Part No.	<b>1USP01FE16S</b>	<b>1USP01FE16D</b>

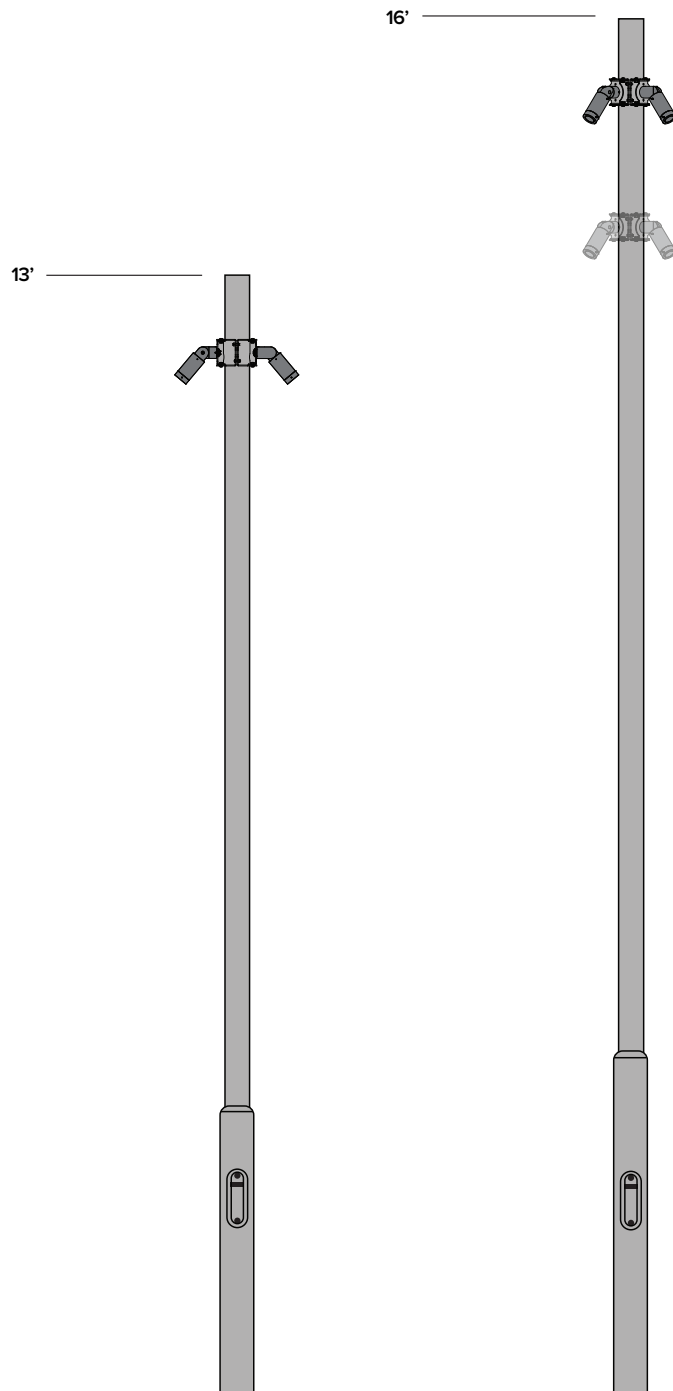

# BULLETTO LINE EVENT POLE

## 9 - MOUNTING BRACKET (REQUIRED)

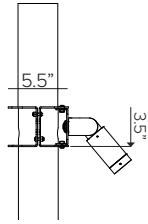
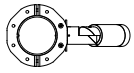

Mounting bracket, 1 fixture max.

Finish ● Ferrite Dark Grey

Part No. **1USP02BKTFES**

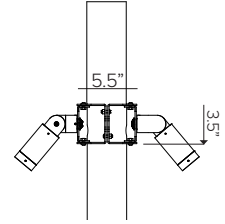
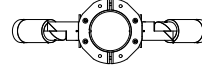

Mounting bracket, 2 fixtures max.

Finish ● Ferrite Dark Grey

Part No. **1USP02BKTFED**

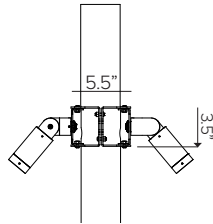
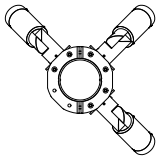

Mounting bracket, 3 fixtures max.

Finish ● Ferrite Dark Grey

Part No. **1USP02BKTFET**

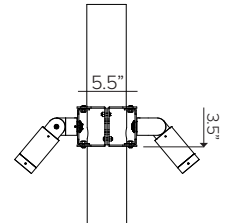
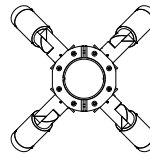

Mounting bracket, 4 fixtures max.

Finish ● Ferrite Dark Grey

Part No. **1USP02BKTFEQ**

## 10 – POLE ACCESSORY (OPTIONAL)

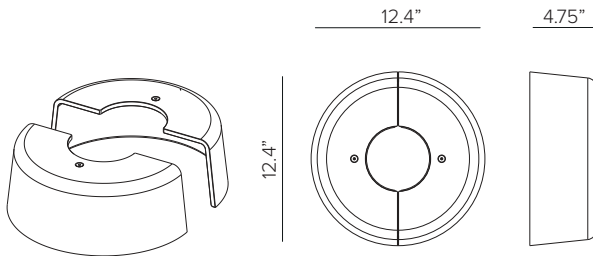

Aluminum decorative pole base cover.

Finish ● Ferrite Dark Grey

Part No. **1USP01CVR02FE**

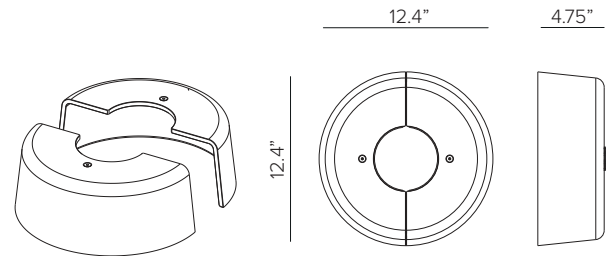

Iron decorative pole base cover. To be used in environments that may have impact.

Finish ● Ferrite Dark Grey

Part No. **1USP02CVR01FE**

**BULLETTO LINE EVENT POLE**

**11 – OPTICAL ACCESSORIES (OPTIONAL)**



Integral 'Blade of Light' linear spread lens PMMA holographic filter.

Part No. **1E3790**



Integral honeycomb anti-glare louver.

Finish ● Deep Black

Part No. **1E3792**

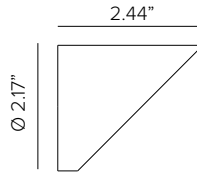
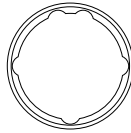
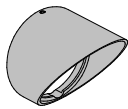

External asymmetric snoot. Powder coated stainless steel. Cutoff 20°.

Finish ● Ferrite Dark Grey

Part No. **1E3788**



Water jet cut stainless steel round pinhole LUMISHAPE light shield. **Performs best with SP optic.**

Finish ● Deep Black

Part No. **LSO3601**

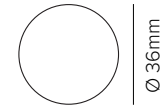

Water jet cut stainless steel round circular LUMISHAPE light shield. **Performs best with SP or FL optic.**

Finish ● Deep Black

Part No. **LSO3602**



Water jet cut stainless steel square pinhole LUMISHAPE light shield. **Performs best with SP optic.**

Finish ● Deep Black

Part No. **LSO3603**

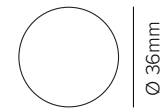

Water jet cut stainless steel regular square LUMISHAPE light shield. **Performs best with SP or FL optic.**

Finish ● Deep Black

Part No. **LSO3604**



Water jet cut stainless steel half LUMISHAPE light shield. **Stackable up to 4pcs per fixture; 4pcs accounts to 1 accessory toward maximum accessory count. Performs best with FL or MWFL optic.**

Finish ● Deep Black

Part No. **LSO3605**

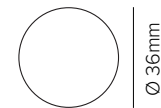

Water jet cut stainless steel quarter LUMISHAPE light shield. **Stackable up to 4pcs per fixture; 4pcs accounts to 1 accessory toward maximum accessory count. Performs best with FL or MWFL optic.**

Finish ● Deep Black

Part No. **LSO3606**

# BULLETTO LINE EVENT POLE

## INSTALLATION DETAILS

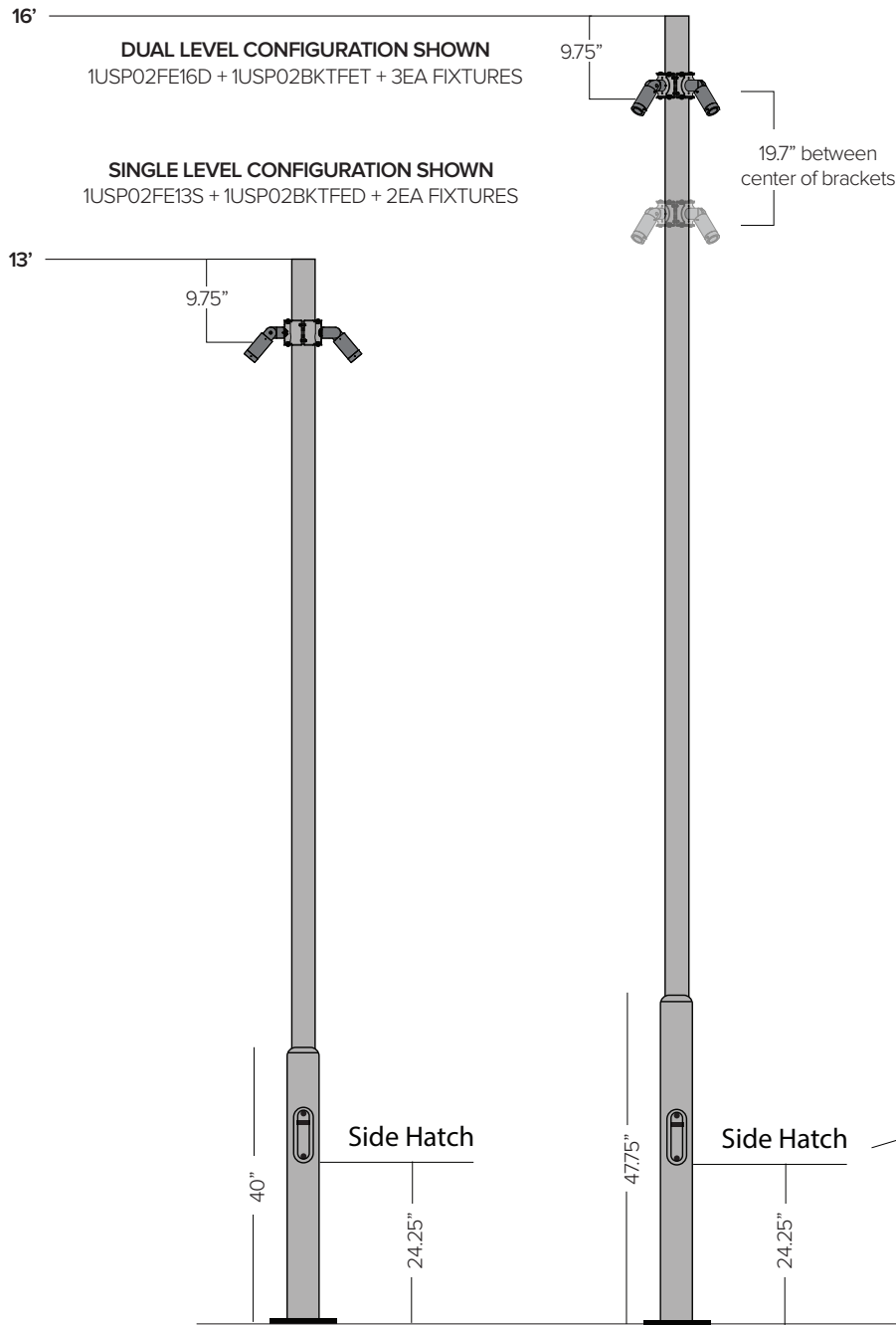

**SIDE HATCH DETAIL**

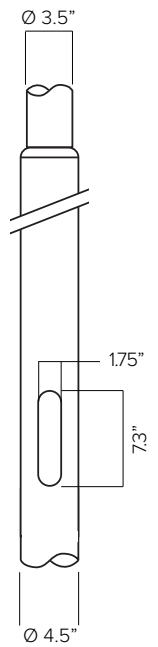

**POLE BASE DETAIL**

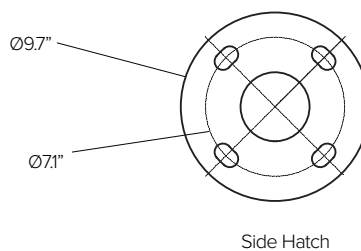

**ANCHOR BOLT DETAIL**

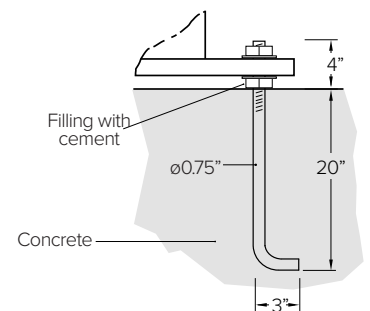

# BULLETO LINE EVENT POLE

## PHOTOMETRY

### NARROW SPOT

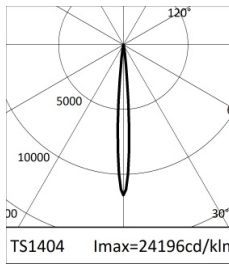

2700K		H(m)	D(m)	Emax(lx)	
-			8°		
Fixture Power	9W	1	0.15	11580	
Source Flux	479lm	2	0.30	2895	
Fixture Flux	362lm	3	0.44	1287	
Efficacy	40lm/W	4	0.59	724	
TS1404	Imax=24196cd/klm	Imax	11580cd	5	0.74 463

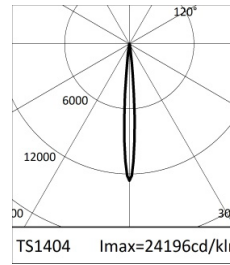

3000K		H(m)	D(m)	Emax(lx)	
-			8°		
Fixture Power	9W	1	0.15	12587	
Source Flux	520lm	2	0.30	3147	
Fixture Flux	394lm	3	0.44	1399	
Efficacy	44lm/W	4	0.59	787	
TS1404	Imax=24196cd/klm	Imax	12587cd	5	0.74 503

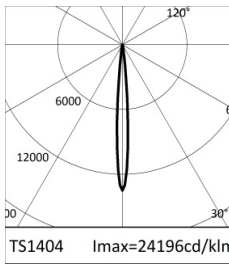

3500K		H(m)	D(m)	Emax(lx)	
-			8°		
Fixture Power	9W	1	0.15	13470	
Source Flux	557lm	2	0.30	3367	
Fixture Flux	421lm	3	0.44	1497	
Efficacy	47lm/W	4	0.59	842	
TS1404	Imax=24196cd/klm	Imax	13470cd	5	0.74 539

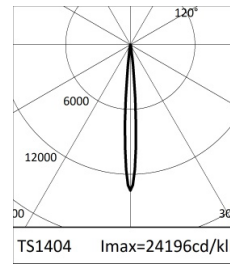

4000K		H(m)	D(m)	Emax(lx)	
-			8°		
Fixture Power	9W	1	0.15	13470	
Source Flux	557lm	2	0.30	3367	
Fixture Flux	421lm	3	0.44	1497	
Efficacy	47lm/W	4	0.59	842	
TS1404	Imax=24196cd/klm	Imax	13470cd	5	0.74 539

### SPOT

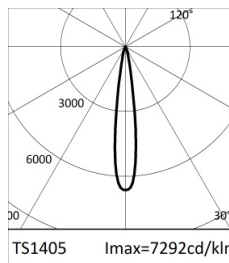

2700K		H(m)	D(m)	Emax(lx)	
-			15°		
Fixture Power	17W	1	0.27	6624	
Source Flux	908lm	2	0.54	1656	
Fixture Flux	679lm	3	0.81	736	
Efficacy	40lm/W	4	1.08	414	
TS1405	Imax=7292cd/klm	Imax	6624cd	5	1.35 265

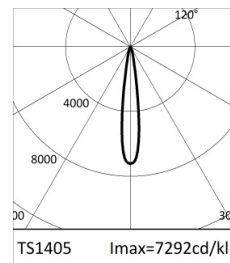

3000K		H(m)	D(m)	Emax(lx)	
-			15°		
Fixture Power	17W	1	0.27	7200	
Source Flux	987lm	2	0.54	1800	
Fixture Flux	738lm	3	0.81	800	
Efficacy	43lm/W	4	1.08	450	
TS1405	Imax=7292cd/klm	Imax	7200cd	5	1.35 288

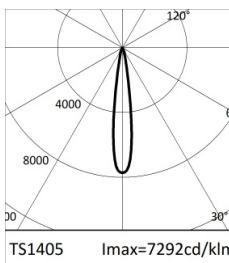

3500K		H(m)	D(m)	Emax(lx)	
-			15°		
Fixture Power	17W	1	0.27	7701	
Source Flux	1056lm	2	0.54	1925	
Fixture Flux	790lm	3	0.81	856	
Efficacy	46lm/W	4	1.08	481	
TS1405	Imax=7292cd/klm	Imax	7701cd	5	1.35 308

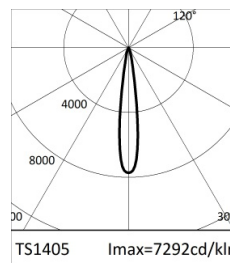

4000K		H(m)	D(m)	Emax(lx)	
-			15°		
Fixture Power	17W	1	0.27	7701	
Source Flux	1056lm	2	0.54	1925	
Fixture Flux	790lm	3	0.81	856	
Efficacy	46lm/W	4	1.08	481	
TS1405	Imax=7292cd/klm	Imax	7701cd	5	1.35 308

### FLOOD

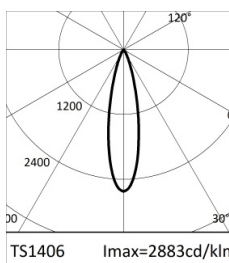

2700K		H(m)	D(m)	Emax(lx)	
-			24°		
Fixture Power	17W	1	0.43	2618	
Source Flux	908lm	2	0.85	655	
Fixture Flux	642lm	3	1.28	291	
Efficacy	38lm/W	4	1.71	164	
TS1406	Imax=2883cd/klm	Imax	2618cd	5	2.14 105

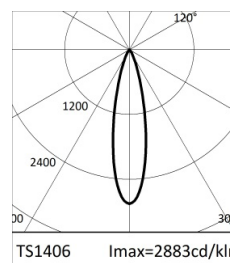

3000K		H(m)	D(m)	Emax(lx)	
-			24°		
Fixture Power	17W	1	0.43	2846	
Source Flux	987lm	2	0.85	712	
Fixture Flux	698lm	3	1.28	316	
Efficacy	41lm/W	4	1.71	178	
TS1406	Imax=2883cd/klm	Imax	2846cd	5	2.14 114

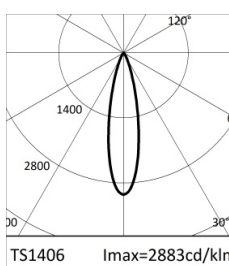

3500K		H(m)	D(m)	Emax(lx)	
-			24°		
Fixture Power	17W	1	0.43	3044	
Source Flux	1056lm	2	0.85	761	
Fixture Flux	747lm	3	1.28	338	
Efficacy	44lm/W	4	1.71	190	
TS1406	Imax=2883cd/klm	Imax	3044cd	5	2.14 122

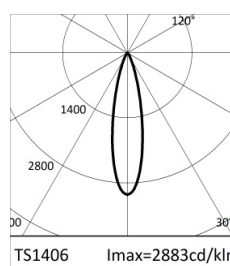

4000K		H(m)	D(m)	Emax(lx)	
-			24°		
Fixture Power	17W	1	0.43	3044	
Source Flux	1056lm	2	0.85	761	
Fixture Flux	747lm	3	1.28	338	
Efficacy	44lm/W	4	1.71	190	
TS1406	Imax=2883cd/klm	Imax	3044cd	5	2.14 122

# BULLETO LINE EVENT POLE

## PHOTOMETRY

### MEDIUM WIDE FLOOD

2700K		H(m)	D(m)	Emax(lx)	
-			31°		
Fixture Power	17W	1	0.55	1741	
Source Flux	908lm	2	1.09	435	
Fixture Flux	648lm	3	1.64	193	
Efficacy	38lm/W	4	2.18	109	
TS1407	Imax=1916cd/klm	Imax	1741cd	5	2.73

3000K		H(m)	D(m)	Emax(lx)	
-			31°		
Fixture Power	17W	1	0.55	1892	
Source Flux	987lm	2	1.09	473	
Fixture Flux	704lm	3	1.64	210	
Efficacy	41lm/W	4	2.18	118	
TS1407	Imax=1916cd/klm	Imax	1892cd	5	2.73

3500K		H(m)	D(m)	Emax(lx)	
-			31°		
Fixture Power	17W	1	0.55	2024	
Source Flux	1056lm	2	1.09	506	
Fixture Flux	753lm	3	1.64	225	
Efficacy	44lm/W	4	2.18	126	
TS1407	Imax=1916cd/klm	Imax	2024cd	5	2.73

4000K		H(m)	D(m)	Emax(lx)	
-			31°		
Fixture Power	17W	1	0.55	2024	
Source Flux	1056lm	2	1.09	506	
Fixture Flux	753lm	3	1.64	225	
Efficacy	44lm/W	4	2.18	126	
TS1407	Imax=1916cd/klm	Imax	2024cd	5	2.73

### WIDE FLOOD

2700K		H(m)	D(m)	Emax(lx)	
-			44°		
Fixture Power	17W	1	0.82	916	
Source Flux	908lm	2	1.63	229	
Fixture Flux	634lm	3	2.45	102	
Efficacy	37lm/W	4	3.27	57	
TS1408	Imax=1009cd/klm	Imax	916cd	5	4.08

3000K		H(m)	D(m)	Emax(lx)	
-			44°		
Fixture Power	17W	1	0.82	996	
Source Flux	987lm	2	1.63	249	
Fixture Flux	689lm	3	2.45	111	
Efficacy	41lm/W	4	3.27	62	
TS1408	Imax=1009cd/klm	Imax	996cd	5	4.08

3500K		H(m)	D(m)	Emax(lx)	
-			44°		
Fixture Power	17W	1	0.82	1065	
Source Flux	1056lm	2	1.63	266	
Fixture Flux	737lm	3	2.45	118	
Efficacy	43lm/W	4	3.27	67	
TS1408	Imax=1009cd/klm	Imax	1065cd	5	4.08

4000K		H(m)	D(m)	Emax(lx)	
-			44°		
Fixture Power	17W	1	0.82	1065	
Source Flux	1056lm	2	1.63	266	
Fixture Flux	737lm	3	2.45	118	
Efficacy	43lm/W	4	3.27	67	
TS1408	Imax=1009cd/klm	Imax	1065cd	5	4.08