

Q3 Series

Surface Mount



Food
Processing:



Made in USA with domestic & globally sourced components

APPLICATIONS:

- ETL/cETL Listed Wet Location
- NSF Certified Food Processing (Splash Zone)
- Industrial & Commercial

FEATURES:

- IP67 Rating
- IP65 Rating
- Durable Impact Modified Extruded Acrylic Enclosure
- Premium Driver
- Up to 135 ^{LM}/_W Delivered
- Every luminaire tested to assure customer satisfaction
- 5 year limited warranty
- Non-Dust Collecting Shape that is easily cleanable

SPECIFICATIONS

ENCLOSURE:

Nominal .125 thick wall, 3" diameter, impact modified extruded clear acrylic.

END CAPS:

Spun from nominal 18GA (.048) 304 grade stainless steel.

GASKETING:

Silicone end cap gasket standard for all models.

INTERIOR LUMINAIRE:

Metal components are of nominal .040 painted aluminum and 20GA (.036) 304 grade stainless steel

ELECTRICAL:

High efficiency LED/Driver combination with 80+ CRI. 4000K color temperature is standard with options for 2700, 3000, 3500 and 5000K. 0-10V dimming and other control options available. THD <10%@120V, <15%@277V, PF> .95. Fixture comes standard with a 3 wire watertight mini receptacle. Cord not included (see page 2 for available cord options).

OPTICS:

Rotatable fixture allows for setting precise optic direction. For use in direct, indirect or direct/indirect application with multiple optics packages available. Downlight LED's are masked by a high transmission polycarbonate overlay. Uplight in 2U version is not masked.

MOUNTING:

Standard chain mounting with wall/ceiling bracket and custom mounting available. All exterior hardware constructed of 304 grade stainless steel.

INSTALLATION:

Hassle free installation. Fixture comes pre-wired, ready to power up, no disassembly required. Simply mount bracket, attach fixture to bracket/mounting hardware, plug in and start realizing power savings.

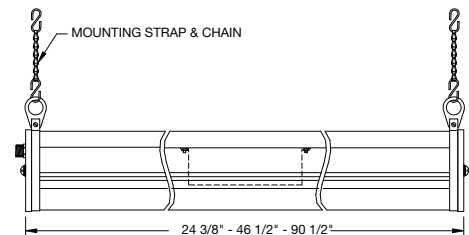
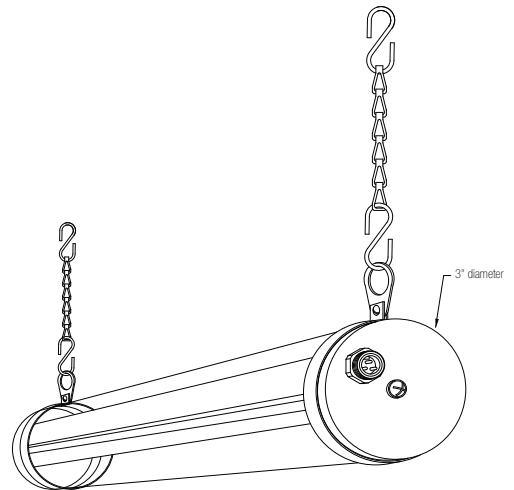

LENGTH (ft)	WEIGHT (lbs)
2	5
4	8
8	10

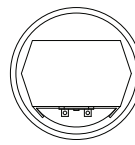

One Row Down

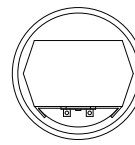

One Row Down H.O.

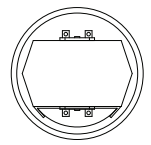

One Row Down, One Row Up

FEATURES | OPTIONS



STANDARD CHAIN (CN)

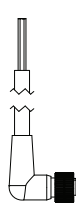

CORD WITH RIGHT ANGLE CONNECTOR

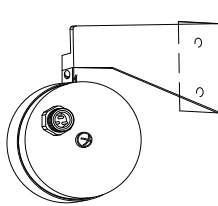

WALL MOUNTING BRACKET (WM)

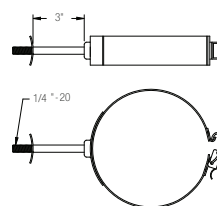

WALL MOUNTING BRACKET (QWM)

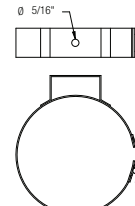

CABLE MOUNTING BRACKET (QCM)

DB-DH-8521

Due to continuous development and improvements, specifications are subject to change without notice. Paramount reserves the right to change lab test details or specifications without notice. Product use certifies agreement to Paramount terms and conditions.



US Lighting Manufacturer Since 1947

Q3 Series

PRODUCT CODE

SERIES	LENGTH	MOUNTING	VOLTAGE	CCT	CRI	LUMENS	LUMENS	LENS	DIMMING	OPTIONS
PMQ3			UNV							
PMQ3 ⁹ Wet Location			UNV 120-277V		CRI83 83 CRI CRI90 ² 90 CRI	DOWN	UP		LD ⁴ Dimming 0-10V ND Non Dimming	
	2 2 FT 4 4 FT 8 8 FT	CN Chain (Std.) SM Strap Bracket WM Wall Bracket QWM Quick Release Wall Bracket QCM Quick Release Cable Bracket		27K ¹ 2700K 3K 3000K 35K 3500K 4K 4000K 5K 5000K		19L 1859 lm 28L 2832 lm 14L 1393 lm 4 FT 37L 3717 lm 58L 5760 lm 29L 2785 lm 8 FT 74L 7434 lm 113L 11330 lm 56L 5570 lm	UNO UNO 16L 1570 lm 4 FT UNO UNO 31L 3141 lm 8 FT UNO UNO 63L 6282 lm		F1 GLR/HLR Fusing (Fast) F2 GMF/HLR Fusing (Slow) W1 6' 120V Cord with Plug (non dim) W6 6' Cord with Mini-Change Connector (non dim) WD6 Dimmable 6' Cord with Mini-Change Connector W12 12' Cord with Mini-Change Connector (non dim) WD12 Dimmable 12' Cord with Mini-Change Connector W20 20' Cord with Mini-Change Connector (non dim) WD20 Dimmable 20' Cord with Mini-Change Connector WC ³ Custom Cord	

1 = Only 90 CRI
2 = N/A 5000K
3 = Consult Factory
4 = REQUIRES special five wire Dimming Cord
8 = EPDM End Cap Gasket Standard

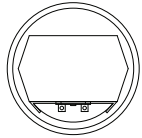

One Row Down

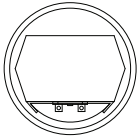

One Row Down H.O.

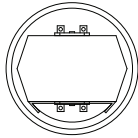

One Row Down, One Row Up

SERIES	LENGTH	MOUNTING	VOLTAGE	CCT	CRI	LUMENS	LUMENS	LENS	DIMMING	OPTIONS
PMSQ3			UNV							
PMSQ3 ⁹ Splash Zone (NSF)			UNV 120-277V		CRI83 83 CRI CRI90 ² 90 CRI	DOWN	UP		LD ⁴ Dimming 0-10V ND Non Dimming	
	2 2 FT 4 4 FT 8 8 FT	SM Strap Bracket (Std.) QWM Quick Release Wall Bracket QCM Quick Release Cable Bracket		27K ¹ 2700K 3K 3000K 35K 3500K 4K 4000K 5K 5000K		19L 1859 lm 28L 2832 lm 14L 1393 lm 4 FT 37L 3717 lm 58L 5760 lm 29L 2785 lm 8 FT 74L 7434 lm 113L 11330 lm 56L 5570 lm	UNO UNO 16L 1570 lm 4 FT UNO UNO 31L 3141 lm 8 FT UNO UNO 63L 6282 lm		F1 GLR/HLR Fusing (Fast) F2 GMF/HLR Fusing (Slow) W1 6' 120V Cord with Plug (non dim) W6 6' Cord with Mini-Change Connector (non dim) WD6 Dimmable 6' Cord with Mini-Change Connector W12 12' Cord with Mini-Change Connector (non dim) WD12 Dimmable 12' Cord with Mini-Change Connector W20 20' Cord with Mini-Change Connector (non dim) WD20 Dimmable 20' Cord with Mini-Change Connector WC ³ Custom Cord	
								L2 .125 Clear Acrylic Tube L6 .125 Clear Polycarbonate Tube		

1 = Only 90 CRI
2 = N/A 5000K
3 = Consult Factory
4 = REQUIRES special five wire Dimming Cord
9 = Neoprene End Cap Gasket Standard for Splash Zone

1 = Only 90 CRI
2 = N/A 5000K
3 = Consult Factory
4 = REQUIRES special five wire Dimming Cord
9 = Neoprene End Cap Gasket Standard for Splash Zone

Electrical Cord **NOT** included on Standard fixture
(see options chart at right for available cords).

NSF Food Processing Note: Splash Zone (PMS prefix) units may become soiled,
but are outside the danger of recontamination.

LUMEN OUTPUT: All listed lumen values are nominal. Lens transmission
and fixture efficiency affect overall lumens.

INDIVIDUAL UNITS STANDARD

NOT ALL COMBINATIONS POSSIBLE

DB-DH-8521