



ZUMALIGHTING
QUALITY OUTDOOR SOLUTIONS



MODEL
PORTO

TYPE
LED

SERIES
WALL & CEILING

ZUMA LIGHTING LLC
325 N LARCHMONT BLVD STE 406, LOS ANGELES, CA 90004
INFO@ZUMALIGHTING.COM • (310) 975-3126 • ZUMALIGHTING.COM

ORDERING INFORMATION

| |
|------------------------------|
| Model PORTO |
| Type LED |
| Series WALL & CEILING |



POR-15



POR-25



POR-45

| FIXTURE | WATTAGE | VOLTS | COLOR TEMP | OPTICS | LENS | COLOR | MOUNTING | OPTIONS |
|---------|-------------------------------------|--|------------|--------|---|------------------------|----------------------------------|--|
| POR-15 | POR-15 22W | U = 120v- 277v | 3K = 3000K | T1 | C = Clear Flat Glass Lens | DB = Dark Bronze | SA = Square Pole Arm | SF = Single Fuse |
| POR-25 | 37W | | 4K = 4000K | T2 | | | SF = Slipfitter | DF = Double Fuse |
| POR-45 | POR-25 65W 81W 112W | H = 347- 480v* | 5K = 5000K | T3 | S = SoftLED Flat Glass Lens | CC = Custom | MA = Mounting Arm Adapter | SP = Surge Protection |
| | POR-45 167W 256W | <i>*Only available with 37W, 81W, 167W, & 256W</i> | | T4 | | | Y = Yoke | PC = Photocell |
| | | | | T5 | P = Clear Flat Prismatic Glass Lens* | | BR = Two-Piece Swivel Bracket | S2 = Microwave Sensor w/ Dimming for Mounting Height of 8-40' (120-277v only) |
| | | | | | <i>*Only available with T5 optics</i> | | EH = Easy-Hang Wall Bracket | BU = Battery Backup, 90 Minutes |
| | | | | | | | K = ½" NPS Knuckle | |
| | | | | | | | NM = No Mount | |

Piedmont Overview

The Porto site & area fixture is available in three housing sizes and multiple wattages with a wide choice of mounting configurations and optical distributions designed to replace HID lighting systems from 70w up to 1000w MH or HPS. Typical applications include general area, parking, flood, security, and accent lighting for retail centers, industrial parks, schools and universities, public transit and airports, office buildings and medical facilities. Mounting heights of 10 to 35 feet can be used based on light level and uniformity requirements.

Housing

Die cast aluminum housing and front frame, integral heat sinking and driver compartment. Nickel-plated stainless steel hardware. Photocell adaptable.

Listing & Ratings

CSA Listed for wet locations, ANSI/UL 1598, 8750; IP66 Sealed LED Compartment.

Finish

Textured architectural bronze powder coat finish over a chromate conversion coating. Custom colors available upon request.

Lens

Tempered clear flat glass lens or soft LED flat glass lens, or tempered clear flat prismatic glass lens.

Wattage

PIE-12

22w: Array: 21.7w, System: 25w (175w HID Equivalent)

PIE-15

25w: Array: 24.78w, System: 28w (150w HID Equivalent)

37w: Array: 37.2w, System: 43w (250w HID Equivalent)

PIE-20

56w: Array: 55.8w, System: 63w (400w HID Equivalent)

Driver

Electronic Driver, 120-277V, 50/60Hz or 347-480V, 50/60Hz; Less Than 20% THD and PF>0.90. Standard Internal Surge Protection is 2kV for 25w, 6kV for 37w and higher wattage. 0-10V Dimming Standard for a Dimming Range of 100% to 10%; Dimming Source Current is 150 Microamps.

Controls

Fixtures Ordered with Factory-Installed Photocell or Motion Sensor Controls are Internally Wired for Switching and/or 1-10V Dimming Within the Housing. Remote Direct Wired Interface of 1-10V Dimming is Not Implied and May Not Be Available, Please Consult Factory. Fixtures are Tested with LEPC Controls and May Not Function Properly With Controls Supplied By Others. Fixtures are NOT Designed for Use with Line Voltage Dimmers.

Warranty

5-Year warranty for -40° to +50°C environment.

Mounting Options:



ZUMA LIGHTING LLC

325 N LARCHMONT BLVD STE 406, LOS ANGELES, CA 90004

INFO@ZUMALIGHTING.COM • (310) 975-3126 • ZUMALIGHTING.COM

Dimensions

POR-15

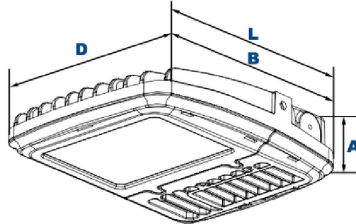

Dimensions

| | |
|-------------------|--------------|
| Width (D) | 9½" (240mm) |
| Length (B) | 11¾" (299mm) |
| Height (A) | 3¾" (92mm) |

Length with Mount (L)

| | |
|---------------------------------------|--------------|
| Square Pole Arm (SA): | 24¼" (617mm) |
| Slipfitter (SF): | 15½" (394mm) |
| Mounting Arm Adaptor (MA): | 16" (404mm) |
| Yoke (Y): | 14¾" (375mm) |
| Bracket (BR): | 15½" (394mm) |
| Easy-Hang Wall Bracket (KHEH): | 12¾" (324mm) |
| Knuckle (K): | 17¾" (450mm) |

POR-25

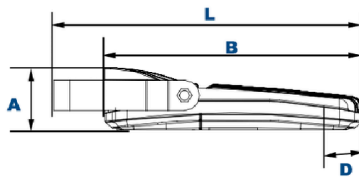

Dimensions

| | |
|-------------------|--------------|
| Width (D) | 13¾" (340mm) |
| Length (B) | 15" (381mm) |
| Height (A) | 3¾" (92mm) |

Length with Mount (L)

| | |
|---------------------------------------|--------------|
| Square Pole Arm (SA): | 19¼" (491mm) |
| Slipfitter (SF): | 18¾" (476mm) |
| Mounting Arm Adaptor (MA): | 19½" (486mm) |
| Yoke (Y): | 18" (457mm) |
| Bracket (BR): | 18¾" (476mm) |
| Easy-Hang Wall Bracket (KHEH): | 16" (406mm) |

POR-45

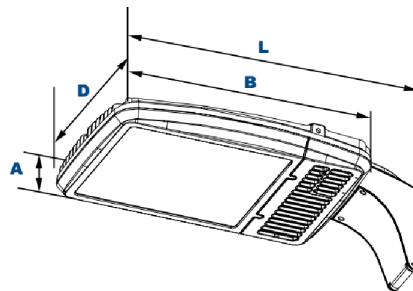

Dimensions

| | |
|-------------------|--------------|
| Width (D) | 15¼" (400mm) |
| Length (B) | 22" (559mm) |
| Height (A) | 4" (102mm) |

Length with Mount (L)

| | |
|-----------------------------------|--------------|
| Square Pole Arm (SA): | 27½" (699mm) |
| Slipfitter (SF): | 29¼" (743mm) |
| Mounting Arm Adaptor (MA): | 26½" (664mm) |
| Yoke (Y): | 26¼" (667mm) |
| Bracket (BR): | 25¼" (654mm) |

Photometric Performance

| LED Board Watts | Drive Current (mA) | Input Watts | Optics | 5000 CCT 80 CRI | | | | | 4000 CCT 80 CRI | | | | |
|-----------------|--------------------|-------------|---------------|-----------------|-----|---|---|---|-----------------|-----|---|---|---|
| | | | | Lumens | LPW | B | U | G | Lumens | LPW | B | U | G |
| POR-15 22w | 525 | 24 | C Type III | 2,875 | 116 | 1 | 0 | 1 | 2,681 | 108 | 1 | 0 | 1 |
| | | | F Type V | 2,742 | 111 | 1 | 0 | 0 | 2,557 | 103 | 1 | 0 | 0 |
| | | | I Narrow Beam | 2,682 | 112 | 1 | 0 | 0 | - | - | - | - | - |
| POR-15 37w | 525 | 43 | C Type III | 4,834 | 118 | 1 | 0 | 1 | 4,508 | 110 | 1 | 0 | 1 |
| | | | F Type V | 4,611 | 113 | 2 | 0 | 0 | 4,300 | 105 | 2 | 0 | 0 |
| | | | I Narrow Beam | 4,512 | 105 | 3 | 3 | 0 | - | - | - | - | - |

| LED Board Watts | Drive Current (mA) | Input Watts | Optics | 5000 CCT 80 CRI | | | | | 4000 CCT 80 CRI | | | | |
|-----------------|--------------------|-------------|------------|-----------------|-----|---|---|---|-----------------|-----|---|---|---|
| | | | | Lumens | LPW | B | U | G | Lumens | LPW | B | U | G |
| POR-25 81w | 525 | 87 | A Type I | 10,099 | 120 | 3 | 0 | 1 | 9,417 | 112 | 3 | 0 | 1 |
| | | | B Type II | 9,634 | 114 | 2 | 0 | 2 | 8,984 | 107 | 2 | 0 | 1 |
| | | | C Type III | 10,583 | 126 | 2 | 0 | 2 | 9,869 | 117 | 2 | 0 | 2 |
| | | | D Type IV | 9,940 | 118 | 1 | 1 | 2 | 9,269 | 110 | 1 | 1 | 2 |
| | | | F Type V | 10,095 | 120 | 3 | 0 | 1 | 9,414 | 112 | 3 | 0 | 1 |
| POR-25 112w | 525 | 120 | A Type I | 14,629 | 121 | 3 | 0 | 2 | 13,641 | 113 | 3 | 0 | 2 |
| | | | B Type II | 13,955 | 115 | 2 | 0 | 2 | 13,013 | 108 | 2 | 0 | 2 |
| | | | C Type III | 15,331 | 127 | 3 | 0 | 3 | 14,296 | 118 | 3 | 0 | 3 |
| | | | D Type IV | 13,499 | 112 | 2 | 1 | 3 | 12,588 | 104 | 2 | 1 | 2 |
| | | | F Type V | 14,624 | 121 | 3 | 0 | 1 | 13,637 | 113 | 3 | 0 | 1 |

| LED Board Watts | Drive Current (mA) | Input Watts | Optics | 5000 CCT 80 CRI | | | | | 4000 CCT 80 CRI | | | | |
|-----------------|--------------------|-------------|------------|-----------------|-----|---|---|---|-----------------|-----|---|---|---|
| | | | | Lumens | LPW | B | U | G | Lumens | LPW | B | U | G |
| POR-45 167w | 525 | 177 | A Type I | 20,821 | 116 | 4 | 0 | 3 | 19,416 | 109 | 4 | 0 | 2 |
| | | | B Type II | 19,863 | 111 | 3 | 0 | 3 | 18,522 | 104 | 3 | 0 | 2 |
| | | | C Type III | 21,820 | 122 | 3 | 0 | 3 | 20,347 | 114 | 3 | 0 | 3 |
| | | | D Type IV | 22,118 | 124 | 3 | 1 | 4 | 20,625 | 115 | 3 | 1 | 4 |
| | | | F Type V | 20,814 | 116 | 4 | 0 | 1 | 19,409 | 109 | 4 | 0 | 1 |
| POR-45 256w | 525 | 281 | A Type I | 31,918 | 116 | 5 | 0 | 3 | 29,763 | 108 | 5 | 0 | 3 |
| | | | B Type II | 30,449 | 111 | 3 | 0 | 3 | 28,393 | 103 | 3 | 0 | 3 |
| | | | C Type III | 33,449 | 122 | 4 | 0 | 4 | 31,191 | 114 | 4 | 0 | 4 |
| | | | D Type IV | 27,600 | 101 | 3 | 0 | 4 | 25,737 | 94 | 3 | 0 | 4 |
| | | | F Type V | 31,907 | 116 | 5 | 0 | 2 | 29,753 | 108 | 5 | 0 | 2 |