

DATE

PROJECT

TYPE

R2ANC | 2" LED Adjustable Recessed Downlight: New Construction IC and StopAire

	R2ANC05	R2ANC1	R2ANC2	R2ANC3
WATTAGE	8W	10W	14W	21W
LUMEN OUTPUT ¹	800Lm	1000Lm	1300Lm	1700Lm
BEAM SPREAD	14° Spot/26° Medium/33° Flood			
COLOR TEMPERATURE	2700K, 3000K, 3500K, 4000K, 3000K Crisp White (90+ CRI)			
CRI	83 (80min)/90+			
SYSTEM RATING	50,000 Hours @ 70% Lumen Maintenance			
INPUT WATTAGE	8W	10W	14W	21W
INPUT CURRENT (A) 120/277	.07/03	.08/04	.12/05	.18/08
INPUT VOLTAGE				
Standard Driver	90-305V AC, 50/60Hz			
Lutron HiLume®	120V AC, 50/60Hz			
Lutron EcoSystem® Dimming	120-277V AC, 50/60Hz			
eldoLED ECOdrive/SOLOdrive	120-277V AC, 50/60Hz			
DRIVER POWER FACTOR	> 0.90			
TOTAL HARMONIC DISTORTION (THD)	< 20%			
LISTINGS	<p>cCSAus Certified using US (UL) and Canadian (CSA) standards Suitable for damp locations R2ANC1 and R2ANC2 Series with 26° (M) and 33° (F) beam distributions are ENERGY STAR® Certified when used with C2302, C2304, C2302SQ, and C2304SQ trims The Crisp White LED option is not ENERGY STAR® Certified. The following dimming options are not ENERGY STAR® Certified: Lutron 12D3, MVD4; eldoLED MVD6, MVD7, MVD8 and MVD9 10W and 14W Housings using the MVD Driver combined with Standard CRI (all color temperatures) or High CRI (all color temperatures except Crisp White) using the C2304-CLR trim and flood beam can be used to comply with 2016 Title 24 Part 6 JAS high efficacy LED light source requirements Conforms to Washington State Energy Code for low air infiltration; tested in accordance with ASTM E283 CP housings are Chicago Plenum CCEA listed Assembled in the USA</p>			
WARRANTY	Five (5) year replacement after date of purchase Emergency Battery option is covered by a one (1) year replacement guarantee after date of purchase			

1. Lumen values are approximate, see photometric test results

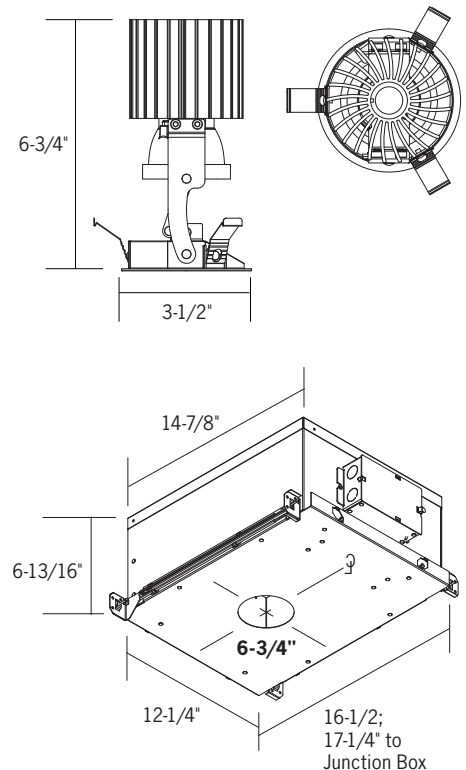

DATE

PROJECT

TYPE

R2ANC | 2" LED Adjustable Recessed Downlight: New Construction IC and StopAire

Ordering Information

Housing + Module + Trim = Complete System

Example Order Housing:	<input type="text" value="R2ANC112D3"/>
Module:	<input type="text" value="UMOD30KS"/>
Trim:	<input type="text" value="C2302-CLR"/>

Housing

Housing	LED Series	Electrical/Dimming	Options
R2ANC - New Construction Insulated Ceiling (IC) Stopaire Housing	05 - 8W/800lm 1 - 10W/1000lm 2 - 14W/1300lm 3 - 21W/1700lm	MVD¹ - 120-277V Triac, ELV and 0-10V Dimming 12D3² - Lutron Hi-lume 1% 2-Wire LED Driver (120V Forward Phase Only) MVD4² - Lutron Hi-lume 1% EcoSystem LED Driver with Soft-on, Fade-to-Black MVD6^{2,3} - 120-277V eldoLED ECOdrive 0-10V, Dim to 1% MVD7^{2,3} - 120-277V eldoLED ECOdrive DALI, Dim to 1% MVD8^{2,3} - 120-277V eldoLED SOLOdrive 0-10V, Dim to 0.1% MVD9^{2,3} - 120-277V eldoLED SOLOdrive DALI, Dim to 0.1%	CP⁴ - Chicago Plenum ER⁵ - Factory Installed 7W/200mA Emergency Battery Backup (Remote Test Switch)

Housing Accessories

Standard Hanger Bars Supplied with Housing

- RL-KIT** - Commercial Mounting Brackets
- HB-24** - 27" Flat Hanger Bars for RL-KIT
- HBC-24** - 25" C-Channel Hanger Bars for RL-KIT in Grid Ceiling Construction
- HB-30** - T-Bar Hanger Set

1. Triac and ELV dimming for 120V only.
2. Lutron and eldoLED Dimming options require above ceiling driver access
3. eldo LED Drivers are programmed for linear curve dimming as standard; for logarithmic curve dimming, please consult factory
4. Chicago Plenum Option cannot be used in an IC (Insulated Ceiling) application, cannot be used with Emergency Battery Backup Option
5. Emergency Backup Option cannot be used in an IC (Insulated Ceiling) application, requires above ceiling battery access 550 lumen nominal average for any Series 05, 1, 2, or 3

LED Module

LED Module	Color Temp/CRI	Beam Distribution
UMOD - 2" Universal LED Module	83 (80min) CRI 27K - 2700K 30K - 3000K 35K - 3500K 40K - 4000K 90+ CRI 27KC - 2700K 30KC - 3000K 35KC - 3500K 40KC - 4000K 90+ Crisp White 30KW - 3000K	S - 14° Spot M - 26° Medium F - 33° Flood

Replacement Optics and Accessories

- 2INOPTIC-S** - Spot Beam Replacement Optic
- 2INOPTIC-M** - Medium Beam Replacement Optic
- 2INOPTIC-F** - Flood Beam Replacement Optic
- FA-47** - Black Accessory Holder Clip; Accepts Two (2) Media
- R2ASNR1-B** - Dual Ring Snoot 60MM OD X 1" Long, Black, FA-47 Required
- FA-16 60MM** - Honeycomb Louver, FA-47 Required
- LF16-** 60MM** - 2-3/8" Diameter Lenses, FA-47 Required

**Color/Pattern Legend

- 73** (Spread Lens), **-LS** (Linear Spread Lens), **-SL** (Soft Light), **-SOL** (Solite), **-UV** (Optivex UV Filter), **-A** (Amber), **-B** (Blue), **-CL** (Clear), **-DPE** (Dichroic Peach), **-G** (Green), **-LB** (Light Blue), **-R** (Red), **-RO** (Rose), **-Y** (Yellow)

DATE

PROJECT

TYPE

R2ANC | 2" LED Adjustable Recessed Downlight: New Construction IC and StopAire

Trims



C2302-CLR*

Clear Full Cone Reflector



C2302-PL*

Platinum Full Cone Reflector



C2304WL-CLR*

Clear Angle Cut Reflector



C2304WL-PL*

Platinum Angle Cut Reflector



C2302-BLK

Black Full Cone Reflector



C2302-WHT

White Full Cone Reflector



C2304WL-BLK

Black Angle Cut Reflector



C2304WL-WHT

White Angle Cut Reflector

C2302 Series

Full Cone Reflector

OD: 3-5/8"; ID: 2-5/8"

Specification Grade Full Cone Reflector Trim. Wet location certified when used with an LF16 60MM lens. Accepts one (1) FA-16 60MM 2-3/8" Dia. Black Honeycomb Louver or (1) LF16 60MM 2-3/8" Dia. Tempered Glass Lens.

*Available with White Panted Flange, add -WPF to part number



C2304 Series

Wet Location Angle Cut Reflector

OD: 3-5/8"; ID: 2-5/8"

Specification Grade Angle Cut Reflector Trim. Clear glass lens provides wet location certification.

*Available with White Panted Flange, add -WPF to part number



C2304-CLR*

Clear Angle Cut Reflector



C2304-PL*

Platinum Angle Cut Reflector



C2304-BLK

Black Angle Cut Reflector



C2304-WHT

White Angle Cut Reflector



C2305-BLK

Black Pinhole Trim



C2305-WHT

White Pinhole Trim

C2304 Series

Angle Cut Reflector

OD: 3-5/8"; ID: 2-5/8"

Specification Grade Angle Cut Reflector Trim.

*Available with White Panted Flange, add -WPF to part number

C2305 Series

Pinhole Trim

Aperture: 1-1/2" Dia.; O.D.: 3-5/8"

DATE

PROJECT

TYPE

R2ANC | 2" LED Adjustable Recessed Downlight: New Construction IC and StopAire

Trims



C2302SQ-CLR-(B,P)
Clear Full Cone Reflector
Black or White Square Trim Plate



C2302SQ-PL-(B,P)
Platinum Full Cone Reflector
Black or White Square Trim Plate



C2304SQWL-CLR-(B,P)
Clear Angle Cut Reflector
Black or White Square Trim Plate



C2304SQWL-PL-(B,P)
Platinum Angle Cut Reflector
Black or White Square Trim Plate



C2302SQ-BLK-(B,P)
Black Full Cone Reflector
Black or White Square Trim Plate



C2302SQ-WHT-(B,P)
White Full Cone Reflector
Black or White Square Trim Plate



C2304SQWL-BLK-(B,P)
Black Angle Cut Reflector
Black or White Square Trim Plate



C2304SQWL-WHT-(B,P)
White Angle Cut Reflector
Black or White Square Trim Plate

C2302SQ Series

Full Cone Reflector with Square Trim Plate

SQ: 3-5/8"; ID: 2-5/8"

Specification Grade Full Cone Reflector Trim with Square Trim Plate. Wet location certified when used with an LF16 60MM 2-3/8" dia. glass lens. Accepts one (1) FA-16 60MM 2-3/8" dia. Black Honeycomb Louver or (1) LF16 60MM 2-3/8" dia. Tempered Glass Lens.

C2304SQWL Series

Wet Location Angle Cut Reflector with Square Trim Plate

SQ: 3-5/8"; ID: 2-5/8"

Specification Grade Angle Cut Reflector Trim with Square Trim Plate. Clear glass lens provides wet location certification.



C2304SQ-CLR-(B,P)
Clear Angle Cut Reflector
Black or White Square Trim Plate



C2304SQ-PL-(B,P)
Platinum Angle Cut Reflector
Black or White Square Trim Plate



C2304SQ-BLK-(B,P)
Black Angle Cut Reflector
Black or White Square Trim Plate



C2304SQ-WHT-(B,P)
White Angle Cut Reflector
Black or White Square Trim Plate



C2305SQ-BLK
Black Pinhole Trim



C2305SQ-WHT
White Pinhole Trim

C2304SQ Series

Angle Cut Reflector with Square Trim Plate

SQ: 3-5/8"; ID: 2-5/8"

Specification Grade Angle Cut Reflector Trim with Square Trim Plate.

C2305SQ Series

Pinhole Trim with Square Trim Plate

Aperture: 1-1/2" Dia.; SQ: 3-5/8"

DATE

PROJECT

TYPE

R2ANC | 2" LED Adjustable Recessed Downlight: New Construction IC and StopAire

Product Details

Construction

- Housing rated for Insulated Ceiling (IC) and StopAire applications; for use in direct contact with insulation materials
- 16-Gauge galvanized steel housing painted matte black inside and out
- Housing features a removable cover for driver access and utilizes a spring latch tether to provide secondary support of the Universal LED Module
- Quick-connect design enables easy installation and removal of Universal LED Module; three spring steel supports secure module into housing/ceiling
- For MVD dimming option, drivers are fully accessible from above or below the ceiling. For 12D3, MVD4, MVD6, MVD7, MVD8, and MVD9 dimming options, drivers are only accessible from above the ceiling.
- Output over voltage, over-current and short circuit protection.
- Approved for through-circuit wiring. Max.: (8) 12 AWG (4in/4out). Pre-wired junction box with knockouts. (7) 1/2" concentric knockouts.
- Matte black painted mechanism is constructed of 16-gauge sheet metal, an aluminum die-cast heat-sink, an acrylic TIR optic, and a thermoplastic optic holder. Mechanism adjustment features white graduation marks every 15° for consistent aiming, as well as a set screw to lock tilt adjustment in place.
- Module features adjustability to 45° when installed in a 1/2" to 1" thick ceiling, to 30° in 1-1/2" ceiling. Using the optional FA-47 accessory holder clip with two lenses/louvers, module adjusts to 45° in 3/4" thick ceiling, with snoot to 45° in 5/8" thick ceiling.
- Dual extension nailer bars are adjustable for 16" and 24" center joists (14-1/4" – 24-1/2"). Nailer bars enable easy installation and may be extended to rest on T-bar ceilings. Optional clip-on T-bar hangers also available.
- Many trim options available to complement any design style. See ordering information and details. **Note:** R2A series and R2RM series trims are not compatible with each other

Performance Summary

- Available in four wattage/lumen packages: 8W/800Lm, 10W/1000Lm, 14W/1300Lm, and 21W/1700Lm
- High output multi-chip LED array arranged into a single LED package, enabling precise optical control
- Select from 2700K, 3000K, 3500K and 4000K color temperatures; CRI 80 min., 83 typical; high CRI 90+ available
- A 3000K Crisp White LED is available, delivering 90+ color rendering with additional violet wavelengths that enhance white visibility
- Excellent fixture to fixture color consistency within a 2-step MacAdam Ellipse tolerance
- Precision TIR Optics produce 14°, 26°, and 33° beam distributions; optics are interchangeable and can be field replaced
- Driver with Class 2 output, RoHS Compliant
- All R2A adjustable downlights are available for non-dimming and dimming applications. For a list of compatible dimmers, refer to the Dimming Specifications sheet.

DATE

PROJECT

TYPE

R2ANC | 2" LED Adjustable Recessed Downlight: New Construction IC and StopAire

Photometrics

R2ANC3MVD/UMOD30KS/C2304-CLR

Fixture Aimed at 30° from Nadir
 Fixture Delivered Lumens: 1198
 Total Watts@120V: 20.6
 Lumens Per Watt: 58.1
 Center Beam Candle Power: 448
 Beam Distribution: 14°
 Spacing Criterion: 0.36
 Color Rendering Index (CRI)¹: 81
 Color Temperature (CCT)²: 3061K
 Designed for 50,000 Hour Lamp Life³
 LM-63 Test No. G17061305
 LM-79 Test No. 84022

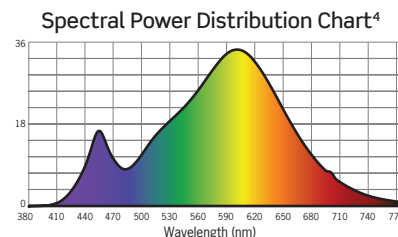
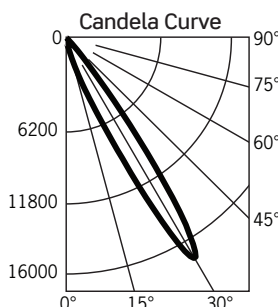

R2ANC3MVD/UMOD30KM/C2304-CLR

Fixture Aimed at 30° from Nadir
 Fixture Delivered Lumens: 1740
 Total Watts@120V: 20.6
 Lumens Per Watt: 84.5
 Center Beam Candle Power: 331
 Beam Distribution: 26°
 Spacing Criterion: 0.60
 Color Rendering Index (CRI)¹: 81
 Color Temperature (CCT)²: 3042K
 Designed for 50,000 Hour Lamp Life³
 LM-63 Test No. G17061406
 LM-79 Test No. 84023

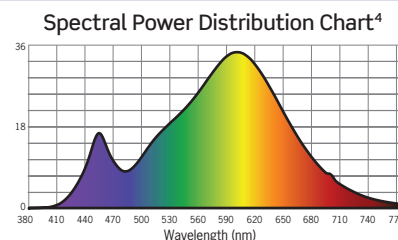
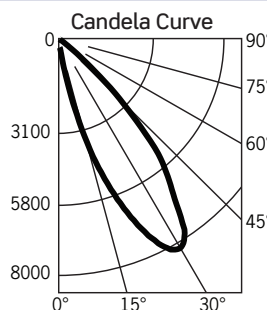

R2ANC3MVD/UMOD30KF/C2304-CLR

Fixture Aimed at 30° from Nadir
 Fixture Delivered Lumens: 1760
 Total Watts@120V: 20.6
 Lumens Per Watt: 85.4
 Center Beam Candle Power: 454
 Beam Distribution: 33°
 Spacing Criterion: 0.13
 Color Rendering Index (CRI)¹: 81
 Color Temperature (CCT)²: 3038K
 Designed for 50,000 Hour Lamp Life³
 LM-63 Test No. G17061312
 LM-79 Test No. 84024

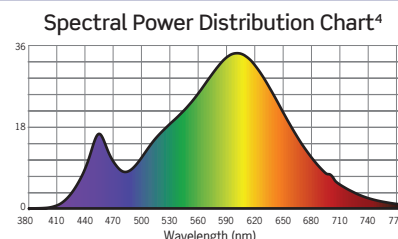
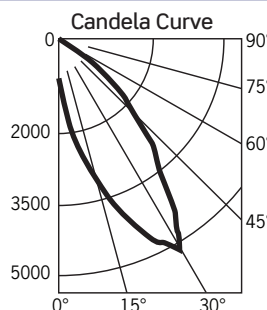

1. Accuracy of rendering colors 2. Color appearance of light source 3. Dependent on surrounding temperatures 4. Colors present within the light source

Photometric Multiplication Factors

Lumen output values fluctuate based on CCT. To estimate lumen output of the various CCT options, multiply 3000K results by the following:

CCT	STD CRI	HIGH CRI	CRISP WHITE	SERIES 05	SERIES 1	SERIES 2	PL & WHT REFLECTOR	BLACK REFLECTOR
2700K	0.94	0.70	0.79	0.45	0.58	0.76	1.0	0.94
3000K	N/A	0.75	0.79	0.45	0.58	0.76	1.0	0.94
3500K	1.0	0.81	0.79	0.45	0.58	0.76	1.0	0.94
4000K	1.0	0.87	0.79	0.45	0.58	0.76	1.0	0.94

DATE

PROJECT

TYPE

R2ANC | 2" LED Adjustable Recessed Downlight: New Construction IC and StopAire

Photometrics

APPLICATION DATA NOTES BASED UPON R2ANC3MVD/UMOD30K(S,M,F)/C2304-CLR:

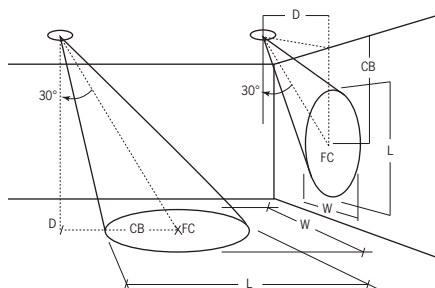

D - Offset distance between the luminaire to the illuminated plane in feet
 CB - Projected distance between the luminaire and the center point where the beam is aimed in feet
 FC - Horizontal or vertical illuminance at the center point where the beam is aimed in footcandles
 L - Beam length corresponding to the perimeter where the luminous intensity is 50% of center beam candlepower (CBCP) in feet
 W - beam width corresponding to the perimeter where the luminous intensity is 50% of center beam candlepower (CBCP) in feet

Luminaires Aimed At 30° From Nadir

		ILLUMINANCE ON HORIZONTAL PLANE					ILLUMINANCE ON VERTICAL PLANE				
		D	CB	FC	L	W	D	CB	FC	L	W
SPOT	5	2.9	427	1.3	1.3		3	5.2	256	2	1.3
	7.5	4.3	190	2	2		4	6.9	144	2.6	1.8
	10	5.8	107	2.7	2.7		5	8.7	92	3.3	2.2
	12.5	7.2	68	3.4	3.4		6	10.4	64	3.9	2.7
MEDIUM	5	2.9	223	2.5	2.7		3	5.2	157	3.3	2.3
	7.5	4.3	99	3.8	4		4	6.9	89	4.4	3.1
	10	5.8	56	5	5.3		5	8.7	57	5.5	3.9
	12.5	7.2	36	6.3	6.6		6	10.4	39	6.6	4.7
FLOOD	5	2.9	139	3.2	3.3		3	5.2	97	3.8	2.8
	7.5	4.3	62	4.8	4.9		4	6.9	55	5.1	3.8
	10	5.8	35	6.4	6.5		5	8.7	35	6.4	4.7
	12.5	7.2	22	8.1	8.1		6	10.4	24	7.6	5.7