

VERS-GRAZER-SK (04) Linear Fixtures - Suspended



Illuminated brilliantly through rich color and **VERS**atility, VERS fixtures are a stunning addition to all spaces of every size and utility. The Grazer offers superior narrow grazing properties ranging from 12-36°.

- 80 Suspension Kit configurations allow fixture to be seamlessly incorporated into any interior
- Create long, continuous lines of light with easy-to-use inline bracket and double feed joiner connectors
- High-quality VERS aluminum housings are available in satin, black, bronze, and white
- Integrated metal endcaps combined with an extruded aluminum housing give this fixture a polished modern look
- Len options include Clear 12° and Clear 25°
- Available in Static White, Static White High-Efficacy, Dynamic White, Dynamic White High-Efficacy, and RGB
- Optional External Louver Accessory offered in matte black or white finish

Part Number Builder

Static White



Product	W/FT	CCT	Rated	Lens	Louver	Input/ Output	Connector/ Wire In	Connector/ Wire Out	Wire Color	Wire Type	Mounting	Finish	Length* (in)
VERS-04-SK-SW						S2	BW	CLS	SV	AWM	SK		**
Voltage: 24 VDC	1.5 3.0 4.0 5.0 6.0	20 22 24 27 30 35 40	DRY (IP20)	GZR 25D	L1-WH L1-BK N/A	S2 Single (Closed exit)	BW	CLS	SV	AWM	SK	ST BK BZ WH	
Typical lumens at 5.0W/ft with GZR at 3000K: 449 lm/ft													
	1.5 3.0 4.0 5.0	24 27 30 35 40	DMP (IP54)										

*Available in 1" increments for 1.5W/ft - 5.0W/ft and 2" increments for 6.0W/ft. Maximum single fixture length of 98". See fixture detail on page 5. Minimum single fixture length 2'.

Shop drawings required for run lengths over 8ft.

** See page 6 for suspension kit options.

Static White High Efficacy



Product	W/FT	CCT	Rated	Lens	Louver	Input/ Output	Connector/ Wire In	Connector/ Wire Out	Wire Color	Wire Type	Mounting	Finish	Length* (in)
VERS-04-SK-SW						S2	BW	CLS	SV	AWM	SK		**
Voltage: 24 VDC	1.5HE 3.0HE 6.0HE 9.0HE	20 22 24 27 30 35 40	DRY (IP20)	GZR 25D	L1-WH L1-BK N/A	S2 Single (Closed exit)	BW	CLS	SV	AWM	SK	ST BK BZ WH	
Typical lumens at 6.0W/ft with GZR at 3000K: 751 lm/ft													
	1.5HE 3.0HE 6.0HE	24 27 30 35 40	DMP (IP54)										

*Available in 2" increments, maximum single fixture length of 98". See fixture detail on page 5. Minimum single fixture length 2'.

Shop drawings required for run lengths over 8ft.

** See page 6 for suspension kit options.

- **BW** comes in standard 36"- request custom length (Max 120") by writing it in inches next to "BW" in the order code box (ex. BW48)
- **One Step, One Bin** based on 5W/ft

- 5 year warranty
- Field modifications void warranty
- Data subject to change, all data has +/- 5% tolerance

- Compatible for use with Q-Tran power supplies
- Suitable for installation in the storage area of a clothes closet when using wattage of 4.0W/ft or less

VERS-GRAZER-SK (04) Linear Fixtures - Suspended



Dynamic White



Product	W/FT	CCT	Rated	Lens	Louver	Input/ Output	Connector/ Wire In	Connector/ Wire Out	Wire Color	Wire Type	Mounting	Finish	Length* (in)
VERS-04-SK-DW	6.0					S2	BW	CLS	SV	AWM	SK		**
Voltage: 24 VDC		20/27 20/30	DRY (IP20)	GZR 25D	L1-WH L1-BK N/A	S2 Single (Closed exit)	BW	CLS	SV	AWM	SK	ST BK BZ WH	
Typical lumens at 6.0W/ft with GZR at 3000K: 264 lm/ft		24/30	DMP (IP54)										

*Available in 2" increments, maximum single fixture length of 98". See fixture detail on page 5. Minimum single fixture length 2'.

Shop drawings required for run lengths over 8ft.

** See page 6 for suspension kit options.

Dynamic White High Efficacy



Product	W/FT	CCT	Rated	Lens	Louver	Input/ Output	Connector/ Wire In	Connector/ Wire Out	Wire Color	Wire Type	Mounting	Finish	Length* (in)
VERS-04-SK-DW						S2	BW	CLS	SV	AWM	SK		**
Voltage: 24 VDC		3.0HE 5.0HE 8.0HE	20/27 20/30 27/40 27/55	DRY (IP20)	GZR 25D	L1-WH L1-BK N/A	S2 Single (Closed exit)	BW	CLS	SV	AWM	SK	ST BK BZ WH
Typical lumens at 5.0W/ft with GZR at 3000K: 251 lm		3.0HE 5.0HE	24/30 27/40	DMP (IP54)									

*Available in 2" increments, maximum single fixture length of 98". See fixture detail on page 5. Minimum single fixture length 2'.

Shop drawings required for run lengths over 8ft.

** See page 6 for suspension kit options.

Warm Dim



Product	W/FT	CCT	Rated	Lens	Louver	Input/ Output	Connector/ Wire In	Connector/ Wire Out	Wire Color	Wire Type	Mounting	Finish	Length* (in)
VERS-04-SK-WD	6.0		DRY			S2	BW	CLS	SV	AWM	SK		**
Voltage: 24 VDC		19/27 19/30	DRY (IP20)	GZR 25D	L1-WH L1-BK N/A	S2 Single (Closed exit)	BW	CLS	SV	AWM	SK	ST BK BZ WH	
Typical lumens at 6.0W/ft with GZR at 3000K: 502 lm/ft													

*Available in 2" increments, maximum single fixture length of 98". See fixture detail on page 5. Minimum single fixture length 2'.

Shop drawings required for run lengths over 8ft.

** See page 6 for suspension kit options.

Only compatible with QZ and QZLP. Not compatible with other power supplies such as QTM-eLED+WD and QOM-eLED+WD.

- BW comes in standard 36" - request custom length (Max 120") by writing it in inches next to "BW" in the order code box (ex. BW48)

- 5 year warranty
- Field modifications void warranty

- Data subject to change, all data has +/- 5% tolerance
- Compatible for use with Q-Tran power supplies

VERS-GRAZER-SK (04) Linear Fixtures - Suspended



Static Color



whiteoptics®

5 YEAR WARRANTY



Product	W/FT	CCT	Rated	Lens	Louver	Input/ Output	Connector/ Wire In	Connector/ Wire Out	Wire Color	Wire Type	Mounting	Finish	Length* (in)
VERS-04-SK-SC	5.0					S2	BW	CLS	SV	AWM	SK		**
		GR BL RD AB	DRY (IP20) DMP (IP54)	GZR 25D	L1-WH L1-BK N/A	S2 Single (Closed exit)	BW	CLS	SV	AWM	SK	ST BK BZ WH	

Voltage: 24 VDC

Typical lumens
at 5.0W/ft with
GZR in green:
589 lm/ft

*Available in 2" increments, maximum single fixture length of 98". See fixture detail on page 5. Minimum single fixture length 2'.

Shop drawings required for run lengths over 8ft.

**See page 6 for suspension kit options.

RGB



whiteoptics®

5 YEAR WARRANTY

Product	W/FT	CCT	Rated	Lens	Louver	Input/ Output	Connector/ Wire In	Connector/ Wire Out	Wire Color	Wire Type	Mounting	Finish	Length* (in)
VERS-04-SK-RGB	6.0	RGB				S2	BW	CLS	SV	AWM	SK		**
			DRY (IP20) DMP (IP54)	GZR 25D	L1-WH L1-BK N/A	S2 Single (Closed exit)	BW	CLS	SV	AWM	SK	ST BK BZ WH	

Voltage: 24 VDC

Typical lumens
at 6.0W/ft
with GZR in
green:189 lm/ft

*Available in 2" increments, maximum single fixture length of 98". See fixture detail on page 5. Minimum single fixture length 2'.

Shop drawings required for run lengths over 8ft.

**See page 6 for suspension kit options.

- **BW** comes in standard 36"- request custom length (Max 120") by writing it in inches next to "BW" in the order code box (ex. BW48)

- 5 year warranty
- Field modifications void warranty
- Data subject to change, all data has +/- 5% tolerance
- Compatible for use with Q-Tran power supplies
- Florida Fish and Wildlife Conservation Commission (FWC) rated strips: DRY rated, Red and Amber

VERS-GRAZER-SK (04) Linear Fixtures - Suspended



Technical Information Delivered lumens

See photometric files for complete details.

Static White [Calculated L70 = 70000 hrs]

Tested with VERS-04-SK-SW-**-30-DRY-**-...-ST

	1.5W/FT		3.0W/FT		4.0W/FT		5.0W/FT		6.0W/FT	
	LM/FT	CRI	LM/FT	CRI	LM/FT	CRI	LM/FT	CRI	LM/FT	CRI
GZR	169	98	294	98	372	98	449	98	546	98
25D	162	98	281	98	344	98	422	98	491	98

Static White High Efficacy

[Calculated L70 = 70000 hrs]

Tested with VERS-04-SK-SW-**-30-DRY-**-...-ST

	1.5HE W/FT		3.0HE W/FT		6.0HE W/FT		9.0HE W/FT	
	LM/FT	CRI	LM/FT	CRI	LM/FT	CRI	LM/FT	CRI
GZR	216	98	404	97	751	98	1108	98
25D	184	98	359	97	704	98	994	98

Dynamic White

[Calculated L70 = 70000 hrs]

Tested with VERS-04-SK-DW-6.0-**-DRY-**-...-ST

	2000K		2700K		3000K	
	LM/FT	CRI	LM/FT	CRI	LM/FT	CRI
GZR	231	93	251	97	264	98
25D	214	94	227	97	242	98

Dynamic White High Efficacy

[Calculated L70 = 70000 hrs]

Tested with VERS-04-SK-DW-5.0HE-**-DRY-**-...-ST

	2000K		2700K		3000K		4000K		5500K	
	LM/FT	CRI	LM/FT	CRI	LM/FT	CRI	LM/FT	CRI	LM/FT	CRI
GZR	225	92	251	98	266	98	278	97	307	97
25D	223	93	250	98	256	98	259	97	287	97

Static Color [Calculated L70 = 30000 hrs]

Tested with VERS-04-SK-SC-5.0-**-DRY-**-...-ST

	Red		Green		Blue		Amber	
	LM/FT	Wavelength	LM/FT	Wavelength	LM/FT	Wavelength	LM/FT	Wavelength
GZR	124	635	589	521	137	467	95	595
25D	111	634	545	520	118	466	84	596

Warm Dim

[Calculated L70 = 70000 hrs]

Tested with VERS-04-SK-WD-6.0-**-DRY-**-...-ST

	2700K		3000K	
	LM/FT	CRI	LM/FT	CRI
GZR	492	98	502	97
25D	476	97	485	97

RGB [Calculated L70 = 55000 hrs]

Tested with VERS-04-SK-RGB-6.0-RGB-DRY-**-...-ST

	Red		Green		Blue	
	LM/FT	Wavelength	LM/FT	Wavelength	LM/FT	Wavelength
GZR	95	632	189	523	50	470
25D	79	632	175	521	45	469

Temperature Ratings Dependent on LED Strip W/FT

Light Engine (LED Strip)	W/FT	Minimum Limit (°F)	Maximum Limit (°F)
Static White	1.5	-40	138
	3.0	-40	124
	4.0	-40	115
	5.0	-40	108
Static White High-Efficacy	1.5HE	-40	152
	3.0HE	-40	140
	6.0HE	-40	118
	9.0HE	-40	95

Beam Angle

W/ft	1.5	3	4	5	6	1.5HE	3.0HE	6.0HE	9.0HE	DW	DW3.0HE	DW5.0HE	DW8.0HE	WD	Green	Blue	Red	Amber	RGB	RGBW
GZR	13°	13°	13°	14°	15°	15°	14°	14°	15°	13°	12°	12°	13°	15°	18°	20°	14°	16°	16°	18°
25D	27°	25°	26°	24°	28°	28°	26°	27°	29°	26°	25°	24°	27°	27°	34°	33°	27°	30°	31°	36°

VERS-GRAZER-SK (04)

Linear Fixtures - Suspended



Part Number Builder

POWER FEED SUSPENSION KIT

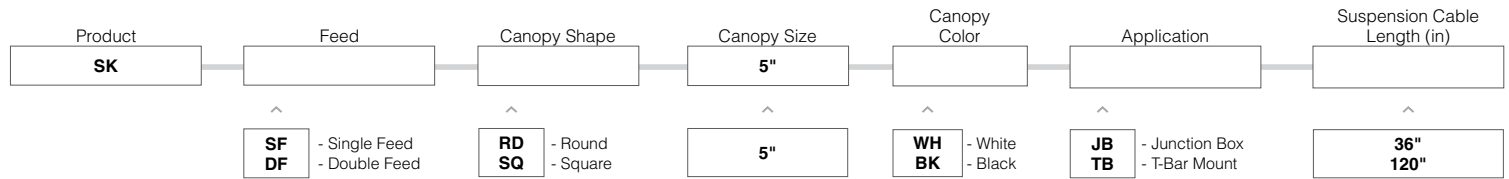

NON-FEED SUSPENSION KIT

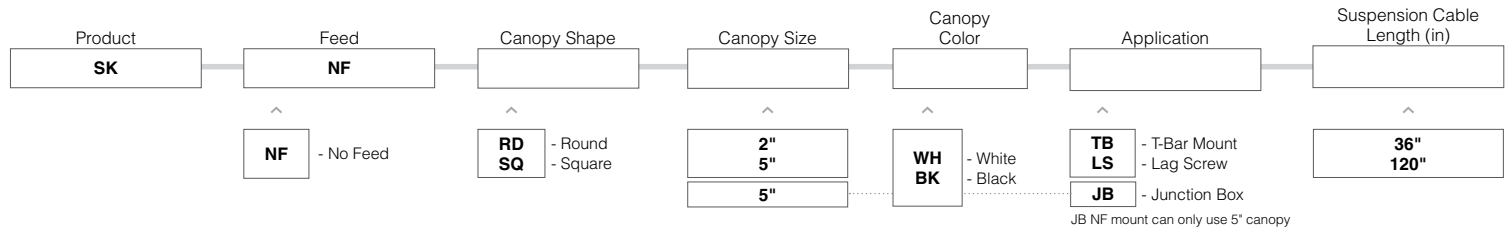

- Shop drawings required for run lengths over 8ft
- If no suspension length provided, 36" is standard
- Suspension cable maximum length: 120"
- Suspension cable is field cuttable
- Suspended fixtures over 6ft require additional suspension points. 8ft lengths will bow 0.25" in middle without additional support.
- Any run length over 8' requires inline brackets
- Consult factory for power over aircraft
- Consult factory for custom color of canopy
- Lag Screw is for mounting into drywall, wood, or other types of finished ceilings for non-feed mounting only

Kit Contents

- 1/16" Steel suspension cable – 36" standard
- Selected canopy
- Cable Gripper
- Cable Coupler

JBOX

- Bracket to mount to junction box (junction box not included)
- Wire strain relief
- Ties for securing electrical cable to suspension cable

T-BAR – feed

- Includes junction box specifically designed for T-BAR applications
- Bracket to mount to junction box
- Wire strain relief
- Ties for securing electrical wire to suspension cable

T-BAR – non-feed

- Bracket to mount to T-BAR (no junction box)

LAG SCREW – non-feed only

- Double ended screw, with a wood thread side and machine thread side
- One piece cable coupler

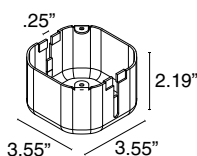

T-BAR JBOX

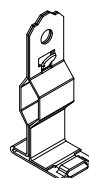

T-BAR CLIP



LAG SCREW

VERS-GRAZER-SK (04)

Linear Fixtures - Suspended



Canopy Options

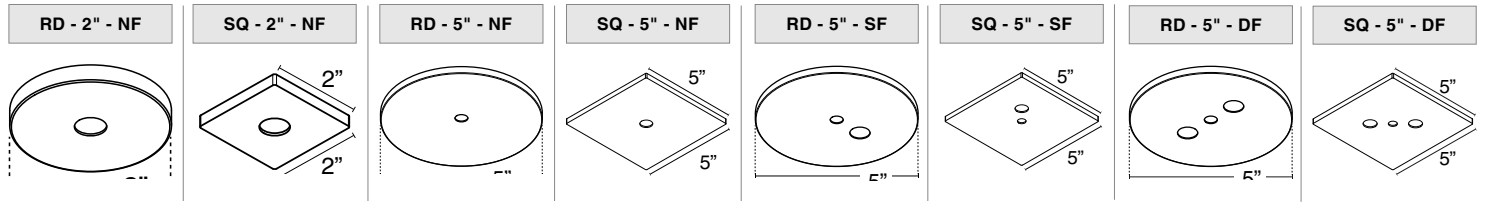

Canopy Finish

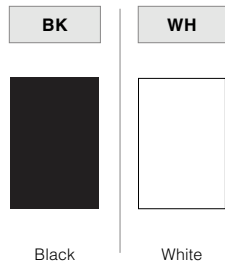

Joints/Connectors

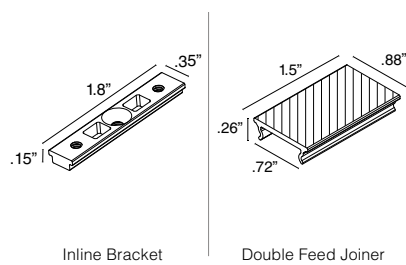

Application

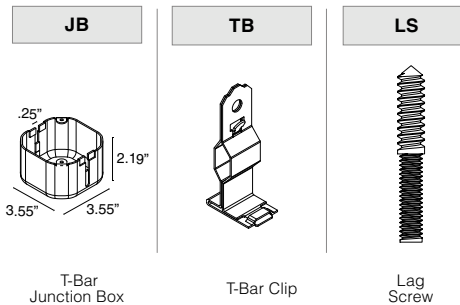

Kit Hardware

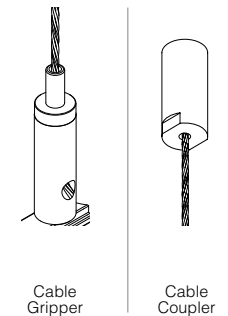

Mounting

- Maximum single fixture length: 98"
- Suspended fixtures over 6ft require additional suspension points. 8ft lengths will bow 0.25" in middle without additional support.
- Shop drawings required for run lengths over 8ft
- Any double fed fixture will come with double feed joiner and inline bracket

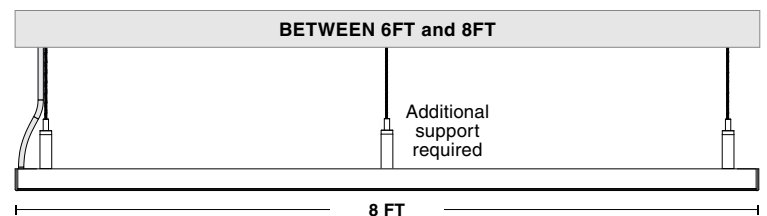
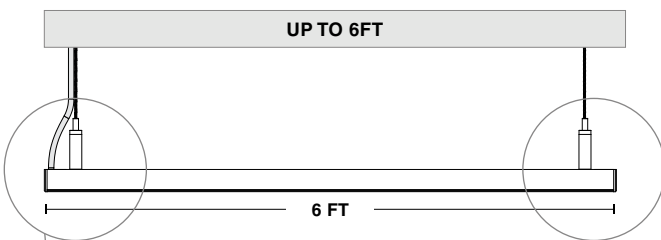

Power Feed Suspension

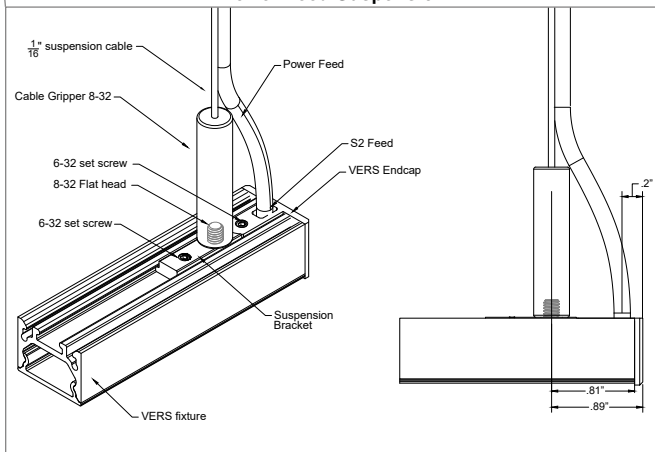

Non-Feed Suspension

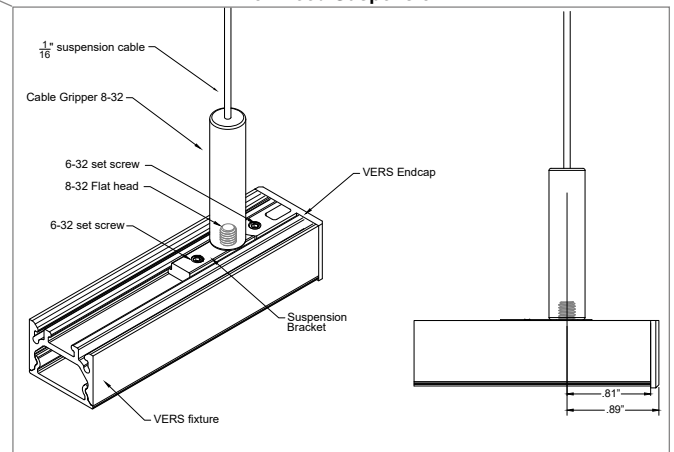

VERS-GRAZER-SK (04) Linear Fixtures - Suspended



Mounting

- Maximum single fixture length: 98"
- Suspended fixtures over 6ft require additional suspension points. 8ft lengths will bow 0.25" in middle without additional support.
- Shop drawings required for run lengths over 8ft
- Any double fed fixture will come with double feed joiner and inline bracket

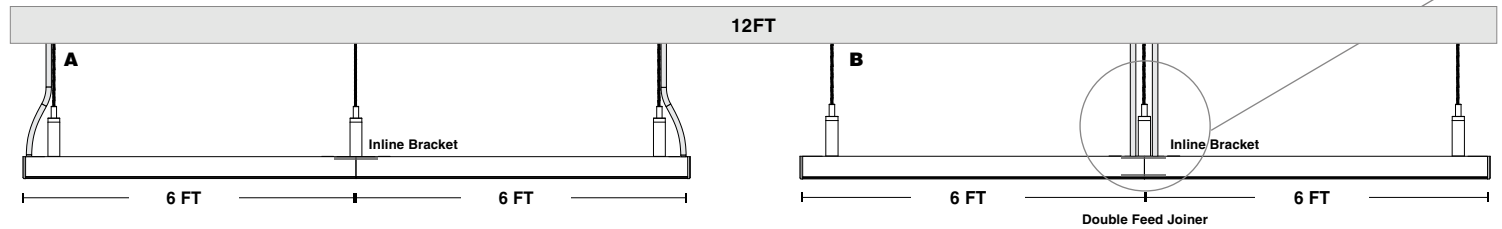
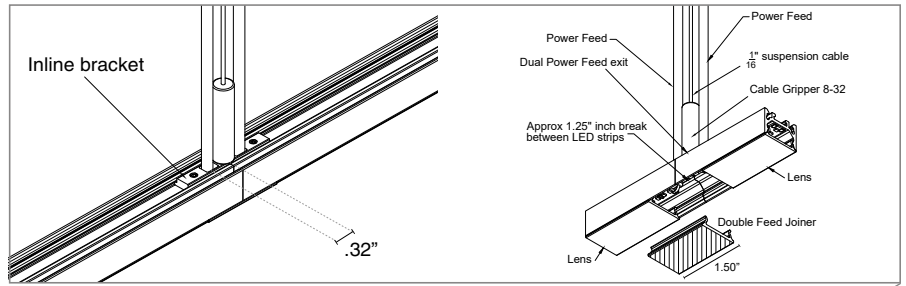

Part number example for a suspended VERS-04 dry rated static white fixture with a 25D lens in 1.5W/ft, 3000K, in a satin finish:

A VERS-04-SK-SW-1.5-30-DRY-25D-N/A-S2-BW-CLS-SV-AWM-SK-ST-144" (1X)
SK-SF-RD-5"-WH-JB-36" (2X)
SK-NF-RD-5"-WH-JB-36" (1X)

B VERS-04-SK-SW-1.5-30-DRY-25D-N/A-S2-BW-CLS-SV-AWM-SK-ST-144" (1X)
SK-SF-RD-5"-WH-JB-36" (1X)
SK-NF-RD-5"-WH-JB-36" (2X)

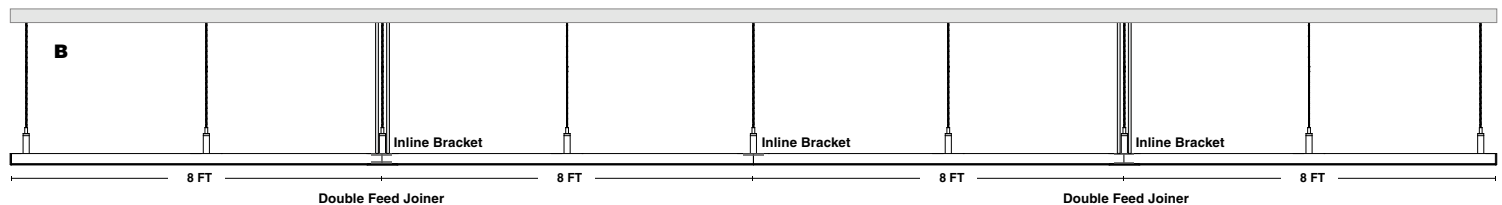
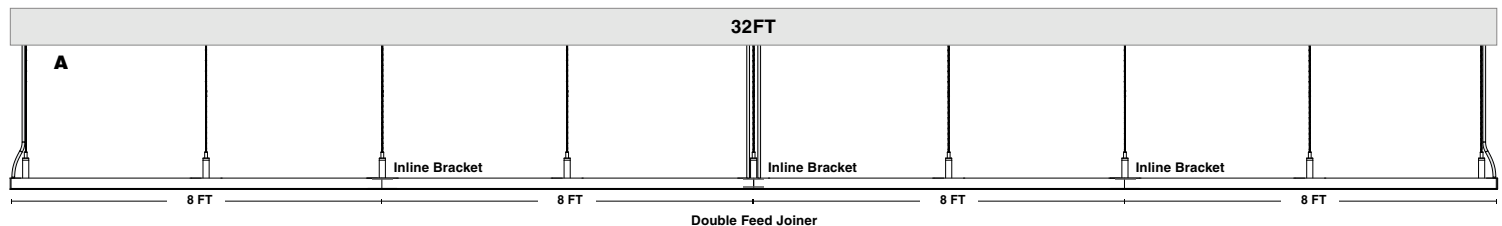
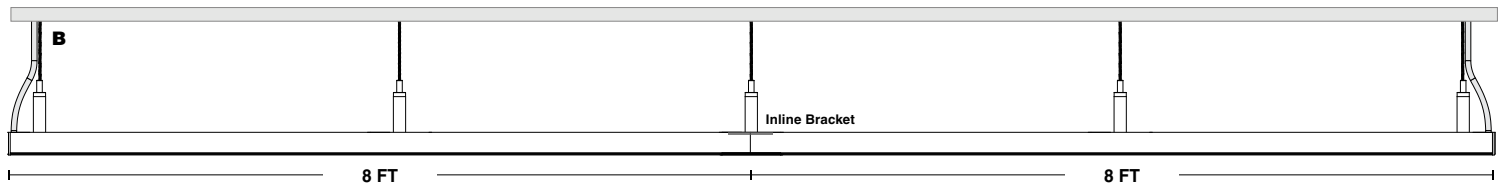
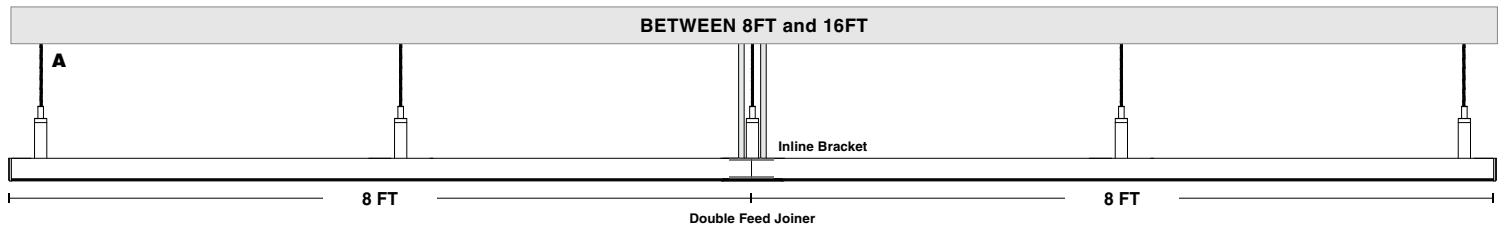

VERS-GRAZER-SK (04) Linear Fixtures - Suspended



SUSPENSION T-BAR POWER FEED ASSEMBLY

SK-SF-RD-5-**-TB-36

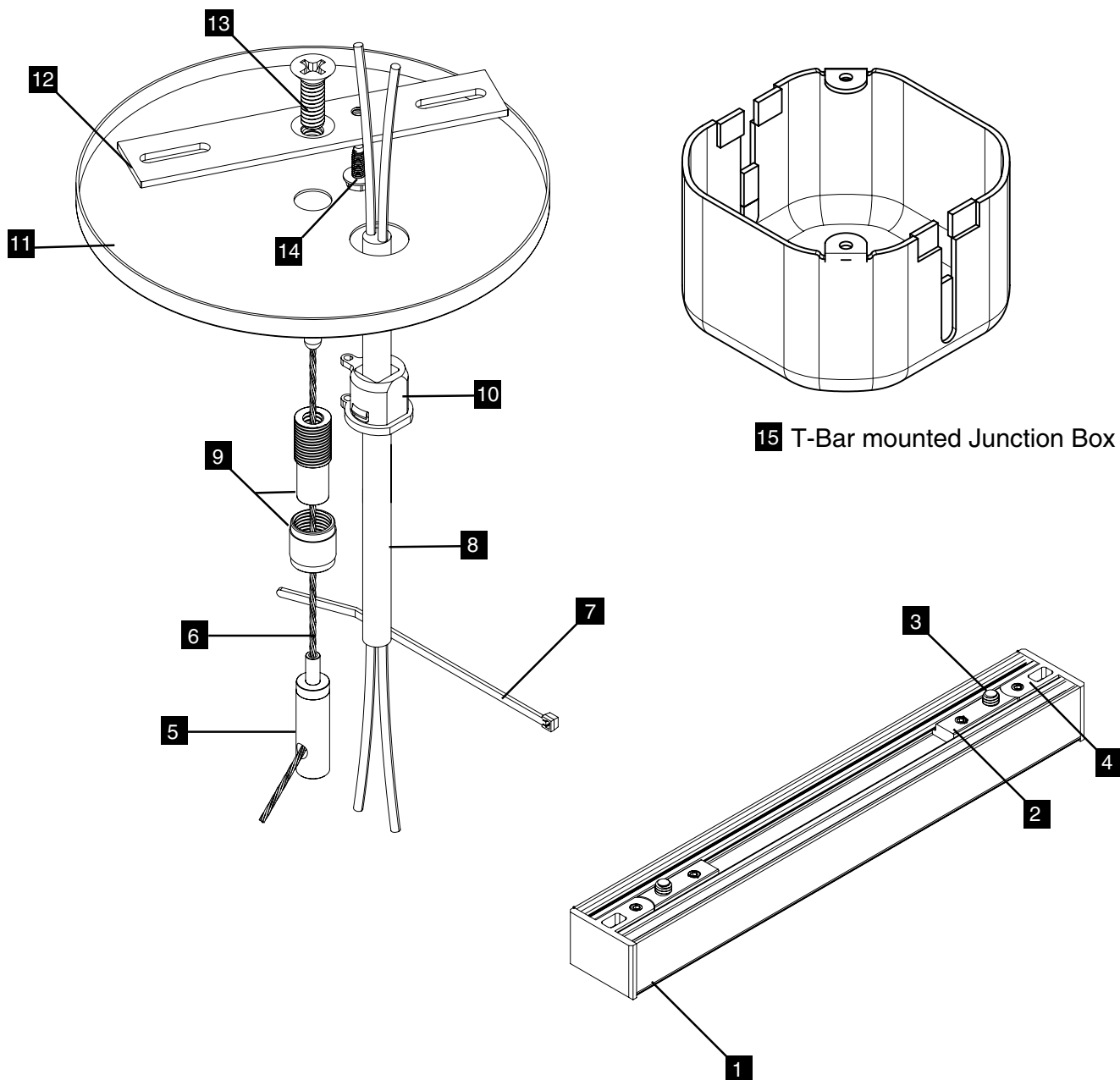

VERS SUSPENSION COMPONENTS

- | | | | | | | | | | | | | | |
|---|-----------|---|--------------------|----|---------------|----|--------|----|---------------|----|-------------|----|--------------|
| 1 | VERS | 2 | Suspension Bracket | 3 | 8-32 Screw | 4 | Endcap | 5 | Cable Gripper | 6 | 1/16" Cable | 7 | Tie |
| 8 | Lead Wire | 9 | Cable Coupler | 10 | Strain Relief | 11 | Canopy | 12 | Crossbar | 13 | 1/4"-20 | 14 | Ground Screw |

VERS-GRAZER-SK (04)

Linear Fixtures - Suspended



SUSPENSION POWER FEED ASSEMBLY - TO MOUNT TO JUNCTION BOX*

SK-SF-RD-5-**-JB-36

*JUNCTION BOX NOT INCLUDED

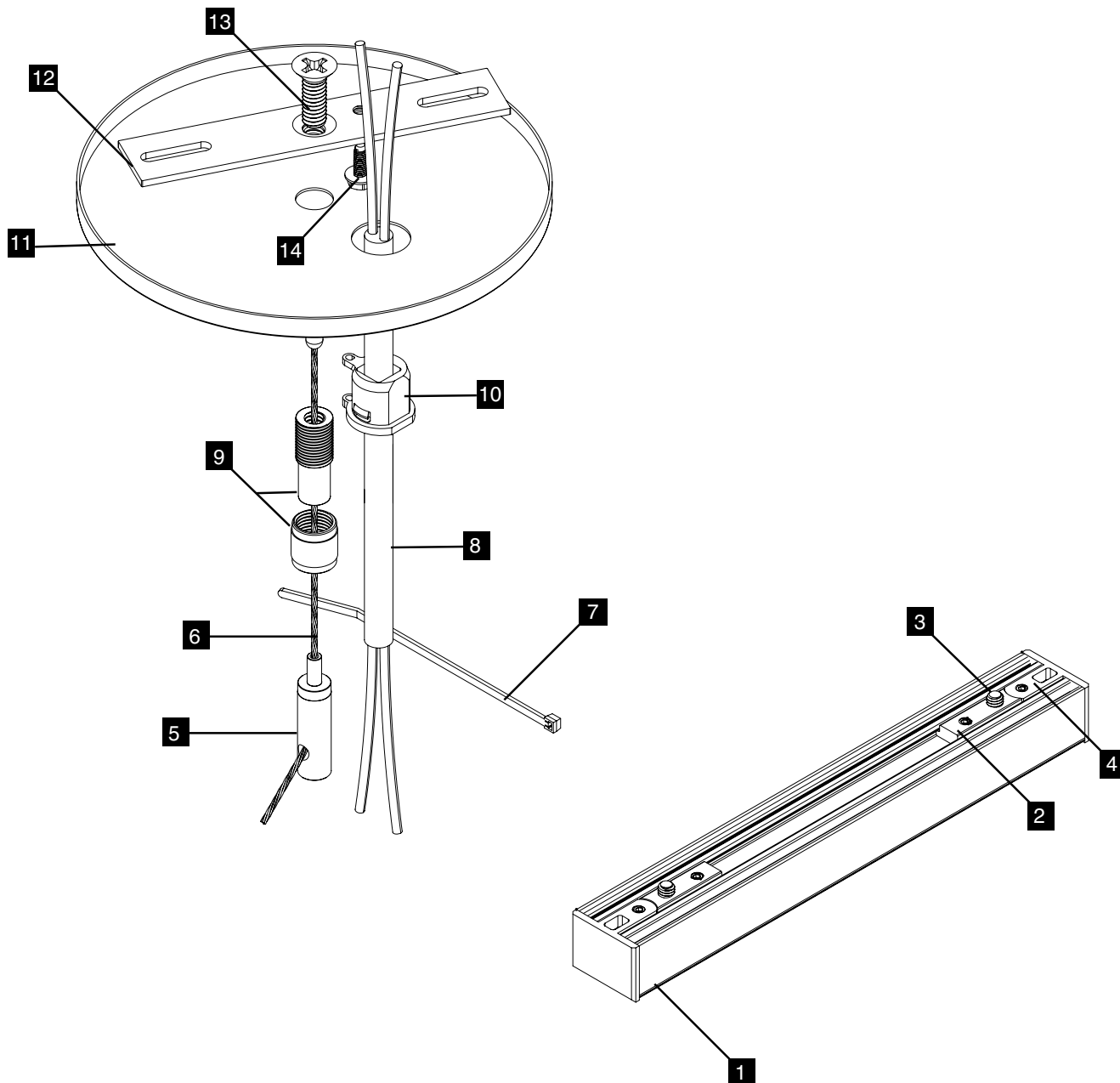

VERS SUSPENSION COMPONENTS

- | | | | | | | | | | | | | | |
|---|-----------|---|--------------------|----|---------------|----|--------|----|---------------|----|-------------|----|--------------|
| 1 | VERS | 2 | Suspension Bracket | 3 | 8-32 Screw | 4 | Endcap | 5 | Cable Gripper | 6 | 1/16" Cable | 7 | Tie |
| 8 | Lead Wire | 9 | Cable Coupler | 10 | Strain Relief | 11 | Canopy | 12 | Crossbar | 13 | 1/4"-20 | 14 | Ground Screw |

VERS-GRAZER-SK (04)

Linear Fixtures - Suspended



SUSPENSION T-BAR NON-FEED ASSEMBLY

SK-NF-RD-2-NF-^{*}-TB-36

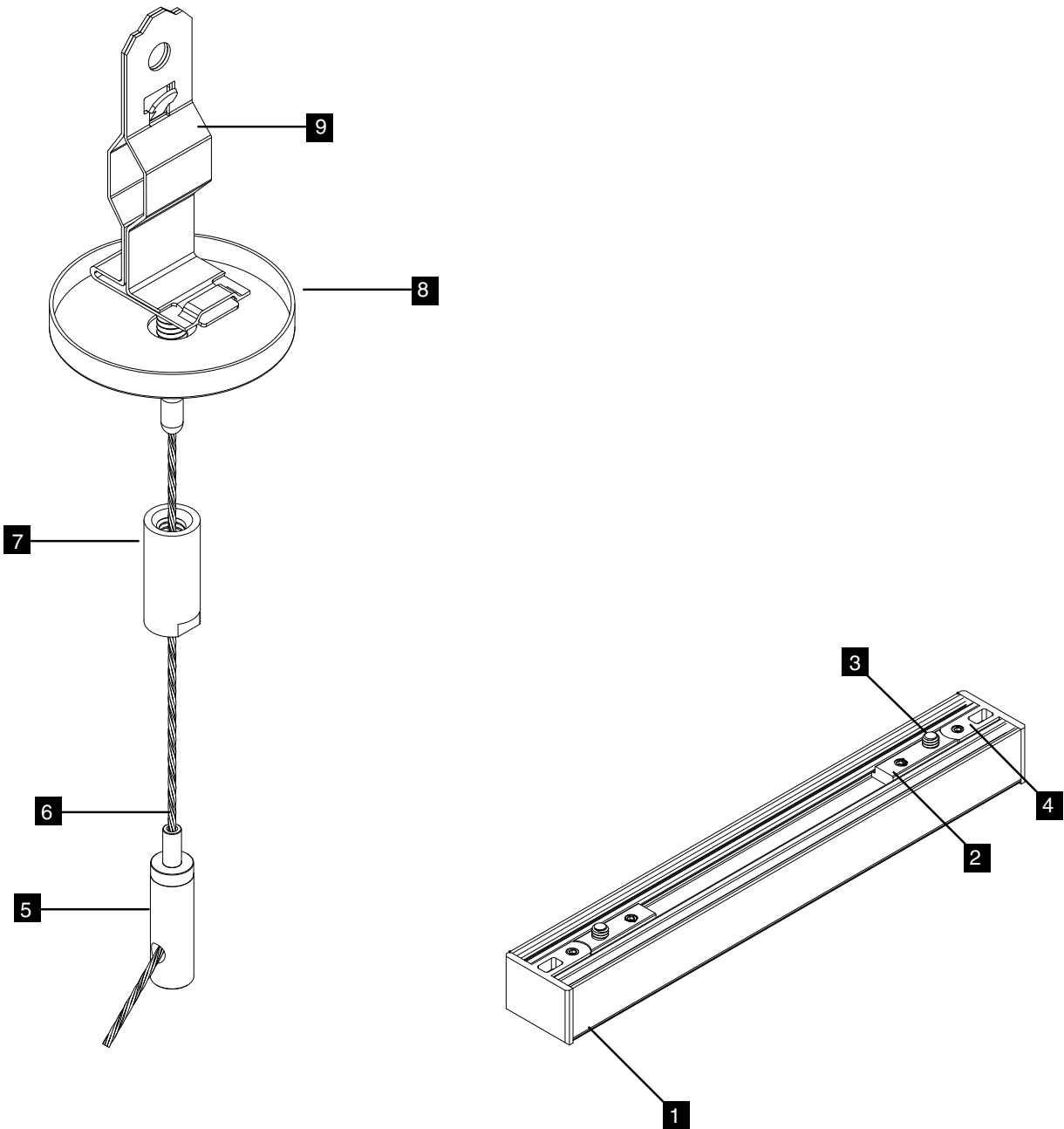

NON-POWERED FEED KIT

1	VERS	2	Suspension Bracket	3	8-32 Screw	4	Endcap	5	Cable Gripper
6	1/16" Cable	7	Cable Coupler	8	Canopy	9	T-Bar Clip		

VERS-GRAZER-SK (04)

Linear Fixtures - Suspended



LAG SCREW NON-FEED ASSEMBLY

SK-NF-RD-2-NF-*-LS-36

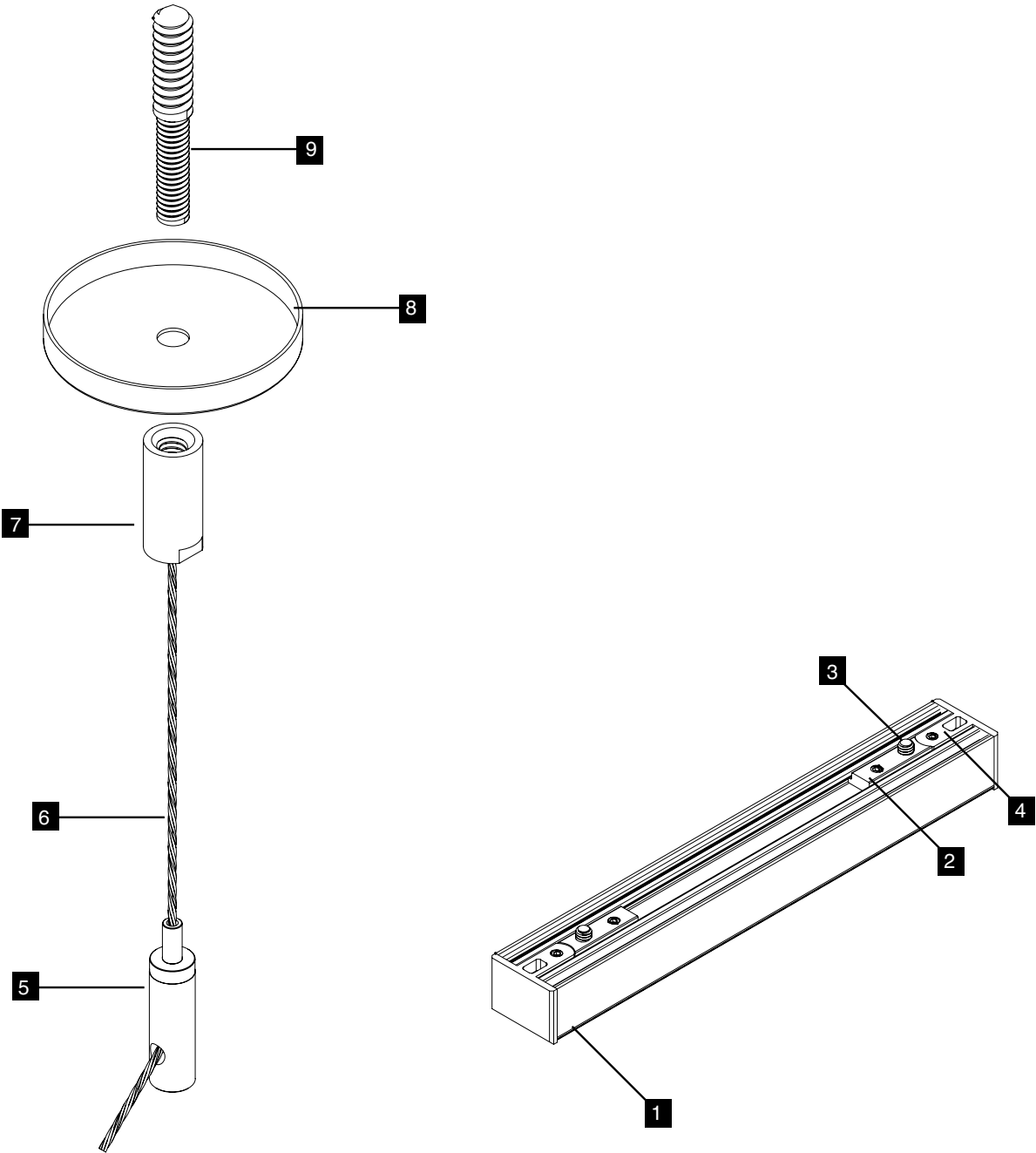

NON-POWERED FEED KIT

1	VERS	2	Suspension Bracket	3	8-32 Screw	4	Endcap	5	Cable Gripper
6	1/16" Cable	7	Cable Coupler	8	Canopy	9	Lag Screw		