

VERS-LOUVER-SK (07) Linear Fixtures - Suspended



Known for performance and **VERS**atility, the VERS Louver is designed to eliminate glare, rendering more precise light distribution.

- 80 Suspension Kit configurations allow fixture to be seamlessly incorporated into any interior
- Create long, continuous lines of light with easy-to-use inline bracket and double feed joiner connectors
- High-quality VERS aluminum housings are available in satin, black, bronze, and white
- Integrated metal endcaps combined with an extruded aluminum housing give this fixture a polished modern look
- Len options include Clear and Diffused
- Available in Static White, Static White High-Efficacy, Dynamic White, Dynamic White High-Efficacy, and RGB
- Optional External Louver Accessory offered in matte black or white finish

Part Number Builder

Static White



Product	W/FT	CCT	Rated	Lens	Input/Output	Connector/Wire In	Connector/Wire Out	Wire Color	Wire Type	Mounting	Finish	Length* (in)
VERS-07-SK-SW					S2	BW	CLS	SV	AWM	SK		**
Voltage: 24 VDC Typical lumens at 5.0W/ft at 3000K with CL lens: 205 lm/ft	1.5 3.0 4.0 5.0 6.0	20 22 24 27 30 35 40	DRY (IP20)	CL DF	S2 Single (Closed exit)	BW	CLS	SV	AWM	SK	ST BK BZ WH	
	1.5 3.0 4.0 5.0	24 27 30 35 40	DMP (IP54)									

*Available in 1" increments for 1.5W/ft - 5.0W/ft and 2" increments for 6.0W/ft. Maximum single fixture length of 98". See fixture detail on page 5. Minimum single fixture length 2'.

Shop drawings required for run lengths over 8ft.

** See page 6 for suspension kit options.

Static White High Efficacy



Product	W/FT	CCT	Rated	Lens	Input/Output	Connector/Wire In	Connector/Wire Out	Wire Color	Wire Type	Mounting	Finish	Length* (in)
VERS-07-SK-SW					S2	BW	CLS	SV	AWM	SK		**
Voltage: 24 VDC Typical lumens at 6.0W/ft at 3000K with CL lens: 382 lm/ft	1.5HE 3.0HE 6.0HE	20 22 24 27 30 35 40	DRY (IP20)	CL DF	S2 Single (Closed exit)	BW	CLS	SV	AWM	SK	ST BK BZ WH	
	1.5HE 3.0HE 6.0HE	24 27 30 35 40	DMP (IP54)									

*Available in 2" increments, maximum single fixture length of 98". See fixture detail on page 5. Minimum single fixture length 2'.

Shop drawings required for run lengths over 8ft.

** See page 6 for suspension kit options.

- **BW** comes in standard 36"- request custom length (Max 120") by writing it in inches next to "BW" in the order code box (ex. BW48)
- **One Step, One Bin** based on 5W/ft

- 5 year warranty
- Field modifications void warranty
- Data subject to change, all data has +/- 5% tolerance

- Compatible for use with Q-Tran power supplies
- Suitable for installation in the storage area of a clothes closet when using wattage of 4.0W/ft or less

VERS-LOUVER-SK (07) Linear Fixtures - Suspended



Dynamic White



Product	W/FT	CCT	Rated	Lens	Input/Output	Connector/Wire In	Connector/Wire Out	Wire Color	Wire Type	Mounting	Finish	Length* (in)
VERS-07-SK-DW	6.0				S2	BW	CLS	SV	AWM	SK		**
Voltage: 24 VDC												
Typical lumens at 6.0W/ft at 3000K with CL lens: 130 lm/ft												
		20/27 20/30	DRY (IP20)	CL DF	S2 Single (Closed exit)	BW	CLS	SV	AWM	SK	ST BK BZ WH	
		24/30	DMP (IP54)									

*Available in 2" increments, maximum single fixture length of 98". See fixture detail on page 5. Minimum single fixture length 2'.

Shop drawings required for run lengths over 8ft.

**See page 6 for suspension kit options.

Dynamic White High Efficacy



Product	W/FT	CCT	Rated	Lens	Input/Output	Connector/Wire In	Connector/Wire Out	Wire Color	Wire Type	Mounting	Finish	Length* (in)
VERS-07-SK-DW					S2	BW	CLS	SV	AWM	SK		**
Voltage: 24 VDC												
Typical lumens at 5.0W/ft at 3000K with CL lens: 125 lm/ft												
	3.0HE 5.0HE	20/27 20/30 27/40 27/55	DRY (IP20)	CL DF	S2 Single (Closed exit)	BW	CLS	SV	AWM	SK	ST BK BZ WH	
		24/30 27/40	DMP (IP54)									

*Available in 2" increments, maximum single fixture length of 98". See fixture detail on page 5. Minimum single fixture length 2'.

Shop drawings required for run lengths over 8ft.

**See page 6 for suspension kit options.

Warm Dim



Product	W/FT	CCT	Rated	Lens	Input/Output	Connector/Wire In	Connector/Wire Out	Wire Color	Wire Type	Mounting	Finish	Length* (in)
VERS-07-SK-WD	6.0		DRY		S2	BW	CLS	SV	AWM	SK		**
Voltage: 24 VDC												
Typical lumens at 6.0W/ft at 3000K with CL lens: 249 lm/ft												
		19/27 19/30	DRY (IP20)	CL DF	S2 Single (Closed exit)	BW	CLS	SV	AWM	SK	ST BK BZ WH	

*Available in 2" increments, maximum single fixture length of 98". See fixture detail on page 5. Minimum single fixture length 2'.

Shop drawings required for run lengths over 8ft.

**See page 6 for suspension kit options.

Only compatible with QZ and QZLP. Not compatible with other power supplies such as QTM-eLED+WD and QOM-eLED+WD.

- BW comes in standard 36" - request custom length (Max 120") by writing it in inches next to "BW" in the order code box (ex. BW48)

- 5 year warranty
- Field modifications void warranty
- Data subject to change, all data has +/- 5% tolerance
- Compatible for use with Q-Tran power supplies
- Suitable for installation in the storage area of a clothes closet when using wattage of 4.0W/ft or less
- Florida Fish and Wildlife Conservation Commission (FWC) rated strips: DRY rated, Red and Amber

VERS-LOUVER-SK (07) Linear Fixtures - Suspended



Static Color



Product	W/FT	CCT	Rated	Lens	Input/ Output	Connector/ Wire In	Connector/ Wire Out	Wire Color	Wire Type	Mounting	Finish	Length* (in)
VERS-07-SK-SC	5.0				S2	BW	CLS	SV	AWM	SK		**
		GR BL RD AB	DRY (IP20) DMP (IP54)	CL DF	S2 Single (Closed exit)	BW	CLS	SV	AWM	SK	ST BK BZ WH	

Voltage: 24 VDC

Typical lumens at
5.0W/ft in green
with CL lens:
280 lm/ft

*Available in 2" increments, maximum single fixture length of 98". See fixture detail on page 5. Minimum single fixture length 2".

Shop drawings required for run lengths over 8ft.

**See page 6 for suspension kit options.

RGB



Product	W/FT	CCT	Rated	Lens	Input/ Output	Connector/ Wire In	Connector/ Wire Out	Wire Color	Wire Type	Mounting	Finish	Length* (in)
VERS-07-SK-RGB	6.0	RGB			S2	BW	CLS	SV	AWM	SK		**
			DRY (IP20) DMP (IP54)	CL DF	S2 Single (Closed exit)	BW	CLS	SV	AWM	SK	ST BK BZ WH	

Voltage: 24 VDC

Typical lumens at
6.0W/ft in green
with CL lens:
88 lm/ft

*Available in 2" increments, maximum single fixture length of 98". See fixture detail on page 5. Minimum single fixture length 2".

Shop drawings required for run lengths over 8ft.

**See page 6 for suspension kit options.

- BW comes in standard 36"- request custom length (Max 120") by writing it in inches next to "BW" in the order code box (ex. BW48)

- 5 year warranty
- Field modifications void warranty
- Data subject to change, all data has +/- 5% tolerance
- Compatible for use with Q-Tran power supplies
- Florida Fish and Wildlife Conservation Commission (FWC) rated strips: DRY rated, Red and Amber

VERS-LOUVER-SK (07) Linear Fixtures - Suspended



Technical Information Delivered lumens

See photometric files for complete details.

Static White [Calculated L70 = 70000 hrs]

Tested with VERS-07-SK-SW-**-30-DRY-**-...-ST

	1.5W/FT			3.0W/FT			4.0W/FT			5.0W/FT			6.0W/FT			*
	LM/FT	CRI	UGR	LM/FT	CRI	UGR	LM/FT	CRI	UGR	LM/FT	CRI	UGR	LM/FT	CRI	UGR	
CL	79	97	≤ 13.3	136	98	≤ 15.5	169	98	≤ 16.1	205	98	≤ 16.7	266	98	≤ 18.2	
DF	69	97	≤ 13.8	118	98	≤ 15.7	145	98	≤ 16.6	175	98	≤ 17.3	213	98	≤ 18.1	

*NOTE - UGR is based on 4H X 8H room dimensions, where H is the mounted height of the luminaire.

Static White High Efficacy [Calculated L70 = 70000 hrs]

Tested with VERS-07-SK-SW-**-30-DRY-**-...-ST

	1.5HE W/FT			3.0HE W/FT			6.0HE W/FT			*
	LM/FT	CRI	UGR	LM/FT	CRI	UGR	LM/FT	CRI	UGR	
CL	109	98	≤ 14.7	198	97	≤ 16.9	382	98	≤ 19.3	
DF	86	98	≤ 14.8	164	98	≤ 17.2	300	98	≤ 19.3	

Dynamic White High Efficacy [Calculated L70 = 70000 hrs]

Tested with VERS-07-SK-DW-5.0HE-**-DRY-**-...-ST

	2000K			2700K			3000K			4000K			5500K			*
	LM/FT	CRI	UGR	LM/FT	CRI	UGR	LM/FT	CRI	UGR	LM/FT	CRI	UGR	LM/FT	CRI	UGR	
CL	110	94	≤ 14.3	119	98	≤ 14.6	125	98	≤ 14.5	131	97	≤ 14.6	141	97	≤ 14.9	
DF	87	93	≤ 14.5	96	98	≤ 14.9	102	98	≤ 15	106	98	≤ 15.2	115	97	≤ 15.5	

Dynamic White [Calculated L70 = 70000 hrs]

Tested with VERS-07-SK-DW-6.0-**-DRY-**-...-ST

	2000K			2700K			3000K			*
	LM/FT	CRI	UGR	LM/FT	CRI	UGR	LM/FT	CRI	UGR	
CL	113	93	≤ 14.9	120	97	≤ 15.2	130	98	≤ 16	
DF	92	94	≤ 14.8	98	97	≤ 15.1	106	98	≤ 15.4	

Static Color [Calculated L70 = 30000 hrs]

Tested with VERS-07-SK-SC-5.0-**-DRY-**-...-ST

	Red			Green			Blue			Amber			*
	LM/FT	Wavelength	UGR	LM/FT	Wavelength	UGR	LM/FT	Wavelength	UGR	LM/FT	Wavelength	UGR	
CL	60	635	≤ 12.5	280	519	≤ 18.4	66	467	≤ 13.2	46	595	≤ 11.9	
DF	51	634	≤ 12.9	235	519	≤ 18.4	55	467	≤ 13.3	35	596	≤ 11.4	

Warm Dim [Calculated L70 = 70000 hrs]

Tested with VERS-07-SK-WD-6.0-**-DRY-**-...-ST

	2700K			3000K			*
	LM/FT	CRI	UGR	LM/FT	CRI	UGR	
CL	242	97	≤ 17.3	249	97	≤ 17.7	
DF	190	97	≤ 17.4	201	97	≤ 17.6	

RGB [Calculated L70 = 55000 hrs]

Tested with VERS-07-SK-RGB-6.0-RGB-DRY-**-...-ST

	Red			Green			Blue			*
	LM/FT	Wavelength	UGR	LM/FT	Wavelength	UGR	LM/FT	Wavelength	UGR	
CL	49	632	≤ 12.2	88	524	≤ 14.6	26	470	≤ 10.2	
DF	41	632	≤ 12.1	78	526	≤ 14.4	23	470	≤ 10.1	

Temperature Ratings Dependent on LED Strip W/FT

Light Engine (LED Strip)	W/FT	Minimum Limit (°F)	Maximum Limit (°F)
Static White	1.5	-40	138
	3.0	-40	124
	4.0	-40	115
	5.0	-40	108

Light Engine (LED Strip)	W/FT	Minimum Limit (°F)	Maximum Limit (°F)
Static White High-Efficacy	1.5HE	-40	152
	3.0HE	-40	140
	6.0HE	-40	118
	9.0HE	-40	95

VERS-LOUVER-SK (07) Linear Fixtures - Suspended



Lens

with LED visibility

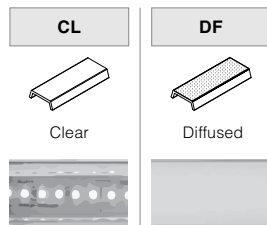

Beam Angle

NOTE: Nominal beam spread shown, beam spread varies based on light engine. For more detailed information, see IES PDF file.

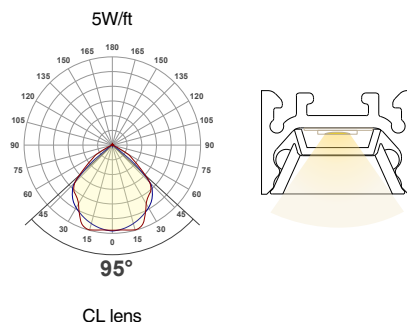

Finish

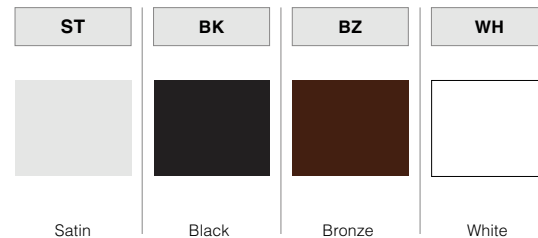

Input/Output

SINGLE (Input only)

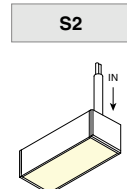

Connector/Wire – In/Out

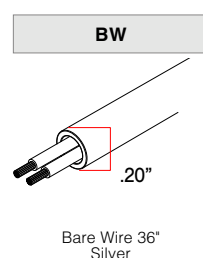

Mounting

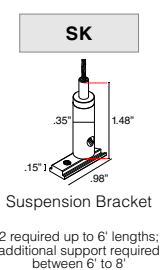

Dimensions

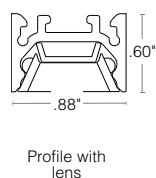

End Caps

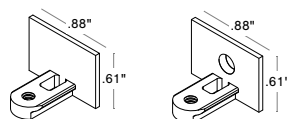

Light Engine Spacing Detail

Add to nominal LED length for fixture length

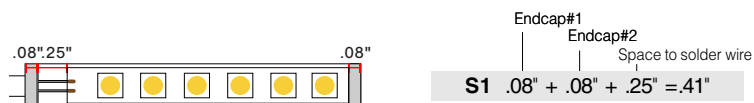

Joints/Connectors for Continuous Row Mounting

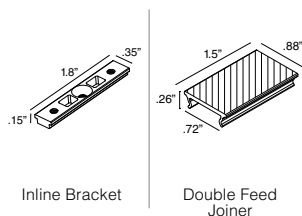

VERS-LOUVER-SK (07) Linear Fixtures - Suspended



Part Number Builder

POWER FEED SUSPENSION KIT

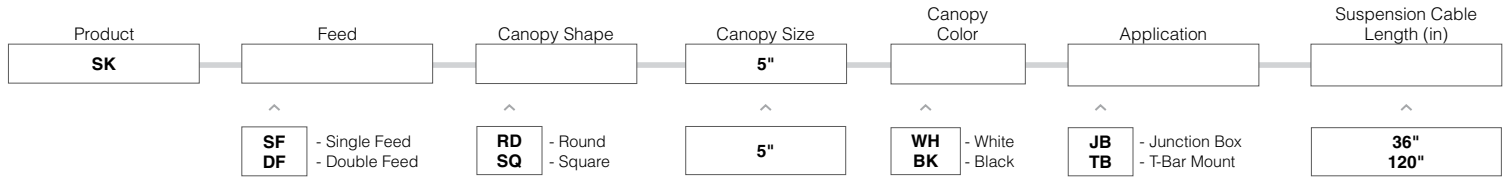

NON-FEED SUSPENSION KIT

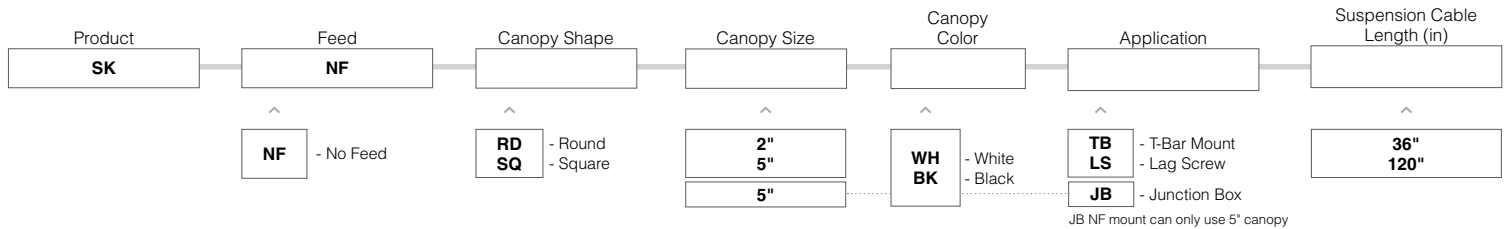

- Shop drawings required for run lengths over 8ft
- If no suspension length provided, 36" is standard
- Suspension cable maximum length: 120"
- Suspension cable is field cuttable
- Suspended fixtures over 6ft require additional suspension points. 8ft lengths will bow 0.25" in middle without additional support.
- Any run length over 8' requires inline brackets
- Consult factory for power over aircraft
- Consult factory for custom color of canopy
- Lag Screw is for mounting into drywall, wood, or other types of finished ceilings for non-feed mounting only

Kit Contents

- 1/16" Steel suspension cable – 36" standard
- Selected canopy
- Cable Gripper
- Cable Coupler

JBOX

- Bracket to mount to junction box (junction box not included)
- Wire strain relief
- Ties for securing electrical cable to suspension cable

T-BAR – feed

- Includes junction box specifically designed for T-BAR applications
- Bracket to mount to junction box
- Wire strain relief
- Ties for securing electrical wire to suspension cable

T-BAR – non-feed

- Bracket to mount to T-BAR (no junction box)

LAG SCREW – non-feed only

- Double ended screw, with a wood thread side and machine thread side
- One piece cable coupler

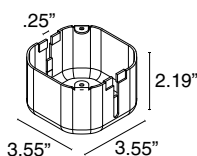

T-BAR JBOX

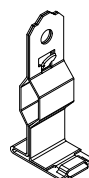

T-BAR CLIP



LAG SCREW

VERS-LOUVER-SK (07) Linear Fixtures - Suspended



Canopy Options

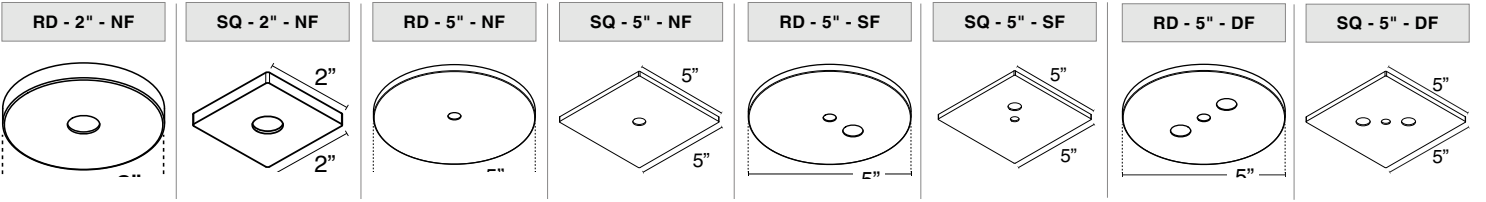

Canopy Finish

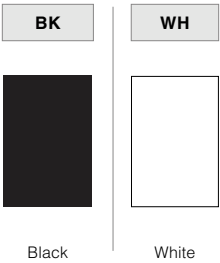

Joints/Connectors

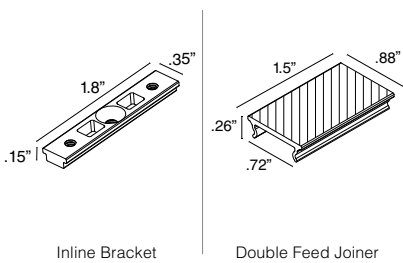

Application

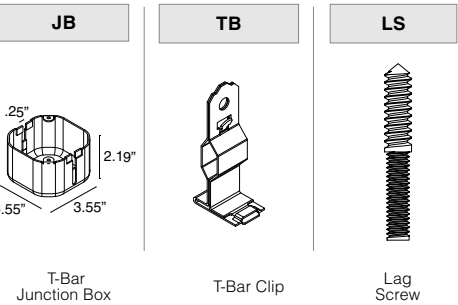

Kit Hardware

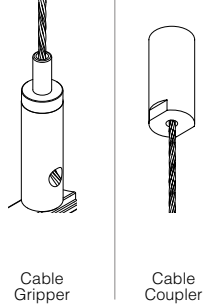

Mounting

- Maximum single fixture length: 98"
- Suspended fixtures over 6ft require additional suspension points. 8ft lengths will bow 0.25" in middle without additional support.
- Shop drawings required for run lengths over 8ft
- Any double fed fixture will come with double feed joiner and inline bracket

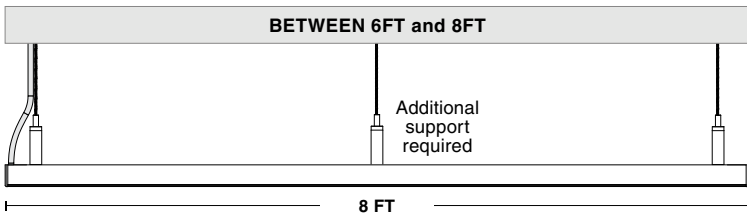
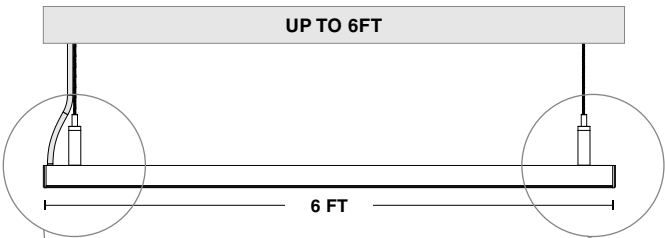

Power Feed Suspension

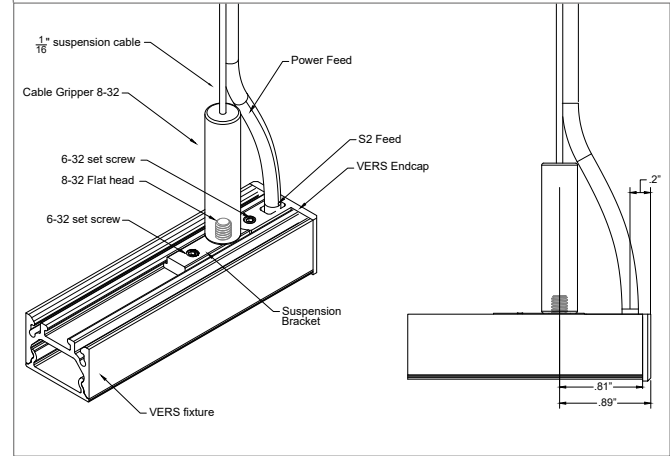

Non-Feed Suspension

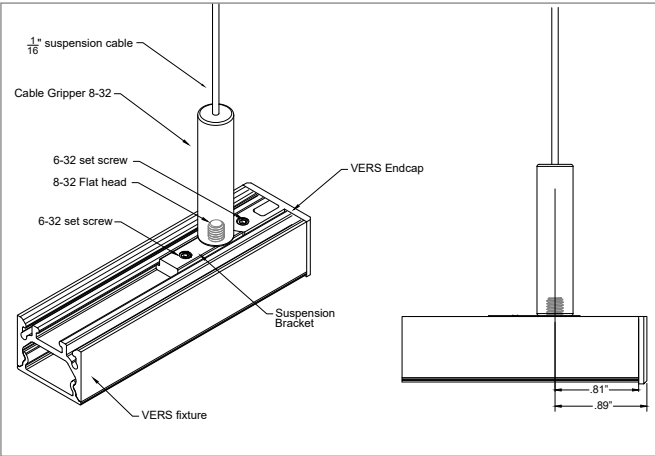

VERS-LOUVER-SK (07) Linear Fixtures - Suspended



Mounting

- Maximum single fixture length: 98"
- Suspended fixtures over 6ft require additional suspension points. 8ft lengths will bow 0.25" in middle without additional support.
- Shop drawings required for run lengths over 8ft
- Any double fed fixture will come with double feed joiner and inline bracket

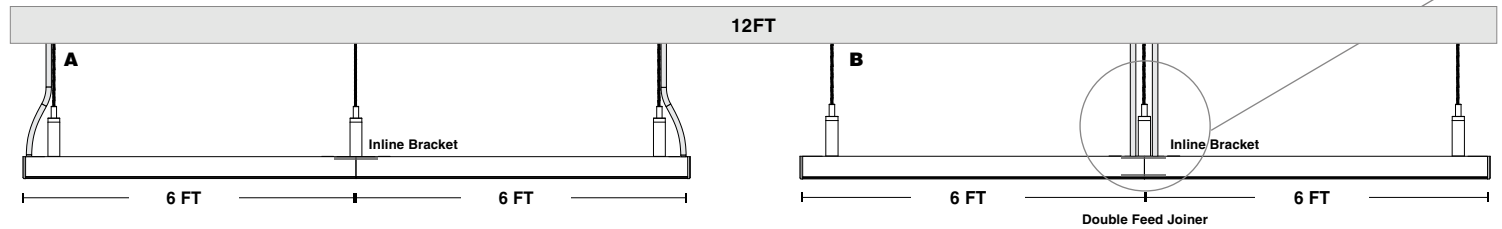
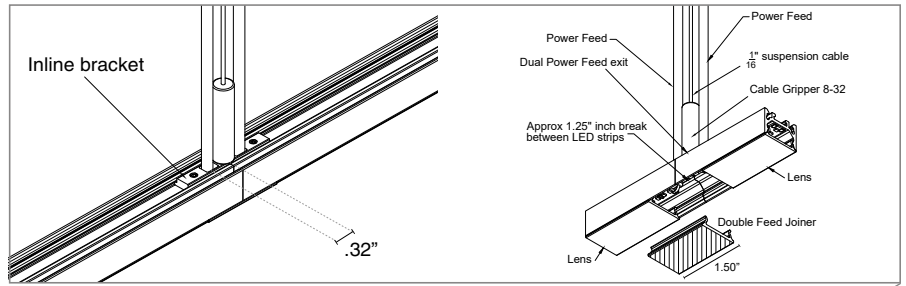

Part number example for a suspended VERS-07 dry rated static white fixture with a diffused lens in 1.5W/ft, 3000K, in a satin finish:

A VERS-07-SK-SW-1.5-30-DRY-DF-S2-BW-CLS-SV-AWM-SK-ST-144" (1X)
SK-SF-RD-5"-WH-JB-36" (2X)
SK-NF-RD-5"-WH-JB-36" (1X)

B VERS-07-SK-SW-1.5-30-DRY-DF-S2-BW-CLS-SV-AWM-SK-ST-144" (1X)
SK-DF-RD-5"-WH-JB-36" (1X)
SK-NF-RD-5"-WH-JB-36" (2X)

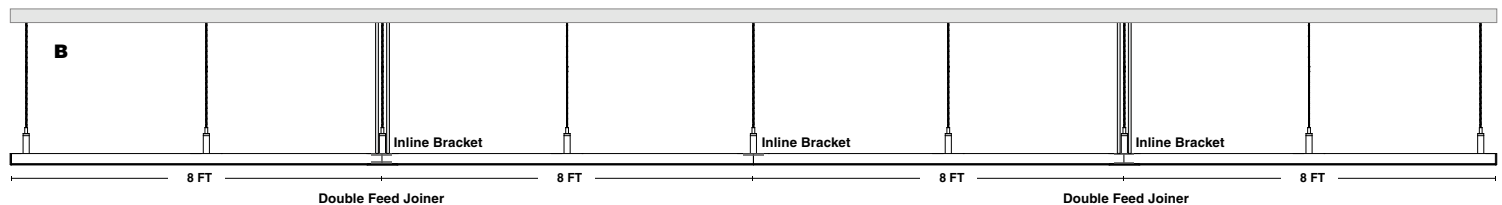
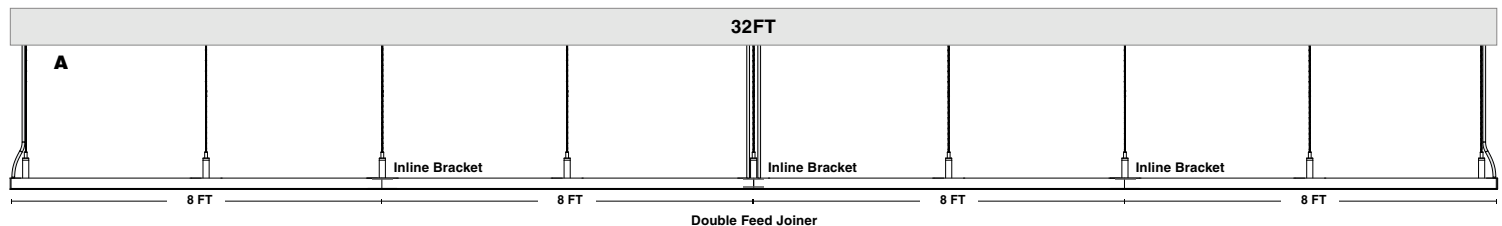
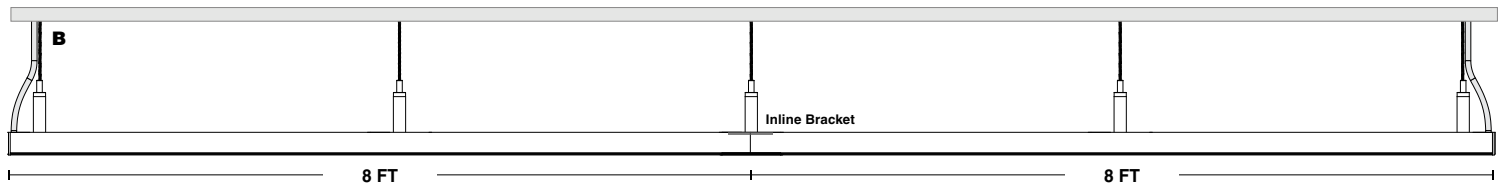
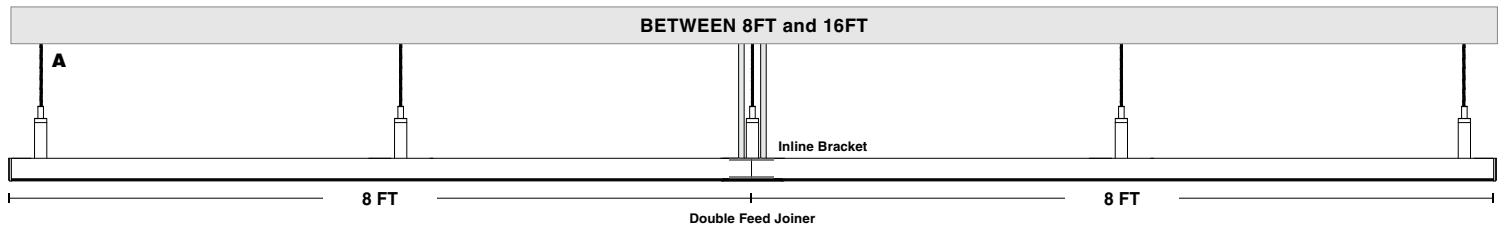

VERS-LOUVER-SK (07)

Linear Fixtures - Suspended



SUSPENSION T-BAR POWER FEED ASSEMBLY

SK-SF-RD-5-**-TB-36

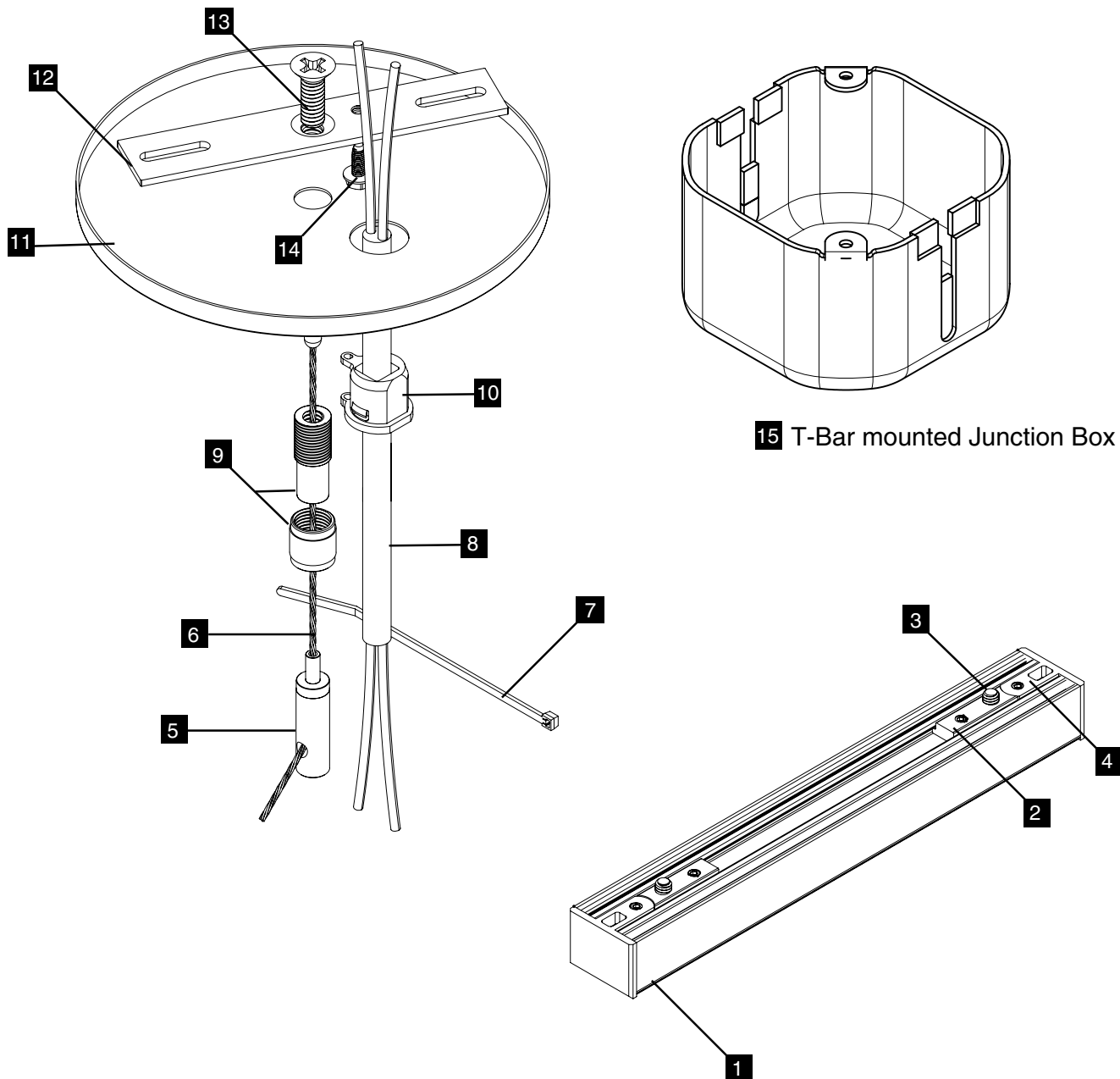

VERS SUSPENSION COMPONENTS

- | | | | | | | | | | | | | | |
|---|-----------|---|--------------------|----|---------------|----|--------|----|---------------|----|-------------|----|--------------|
| 1 | VERS | 2 | Suspension Bracket | 3 | 8-32 Screw | 4 | Endcap | 5 | Cable Gripper | 6 | 1/16" Cable | 7 | Tie |
| 8 | Lead Wire | 9 | Cable Coupler | 10 | Strain Relief | 11 | Canopy | 12 | Crossbar | 13 | 1/4"-20 | 14 | Ground Screw |

VERS-LOUVER-SK (07)

Linear Fixtures - Suspended



SUSPENSION POWER FEED ASSEMBLY - TO MOUNT TO JUNCTION BOX*

SK-SF-RD-5-**-JB-36

*JUNCTION BOX NOT INCLUDED

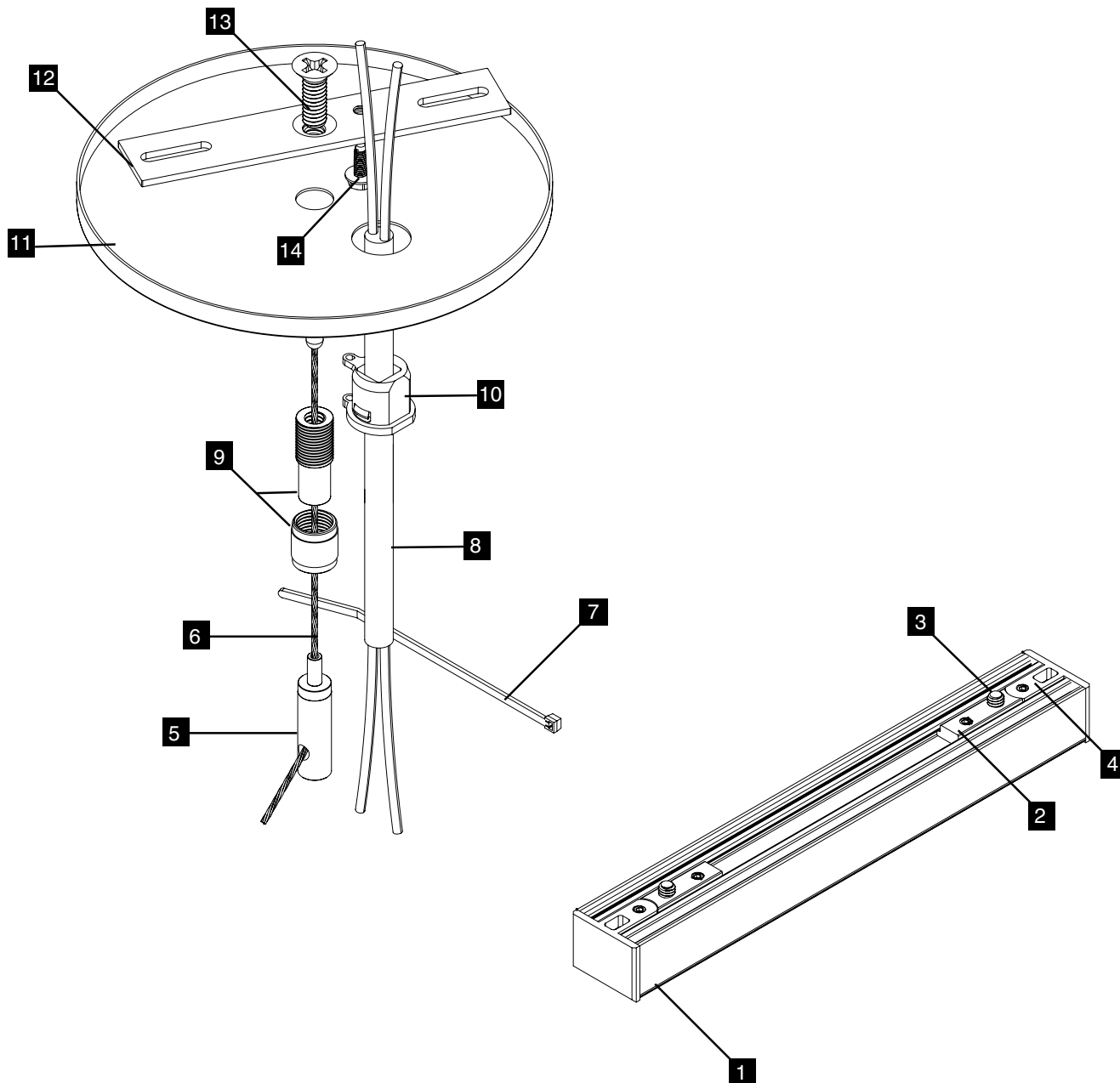

VERS SUSPENSION COMPONENTS

- | | | | | | | | | | | | | | |
|---|-----------|---|--------------------|----|---------------|----|--------|----|---------------|----|-------------|----|--------------|
| 1 | VERS | 2 | Suspension Bracket | 3 | 8-32 Screw | 4 | Endcap | 5 | Cable Gripper | 6 | 1/16" Cable | 7 | Tie |
| 8 | Lead Wire | 9 | Cable Coupler | 10 | Strain Relief | 11 | Canopy | 12 | Crossbar | 13 | 1/4"-20 | 14 | Ground Screw |

VERS-LOUVER-SK (07)

Linear Fixtures - Suspended



SUSPENSION T-BAR NON-FEED ASSEMBLY

SK-NF-RD-2-NF-^{*}-TB-36

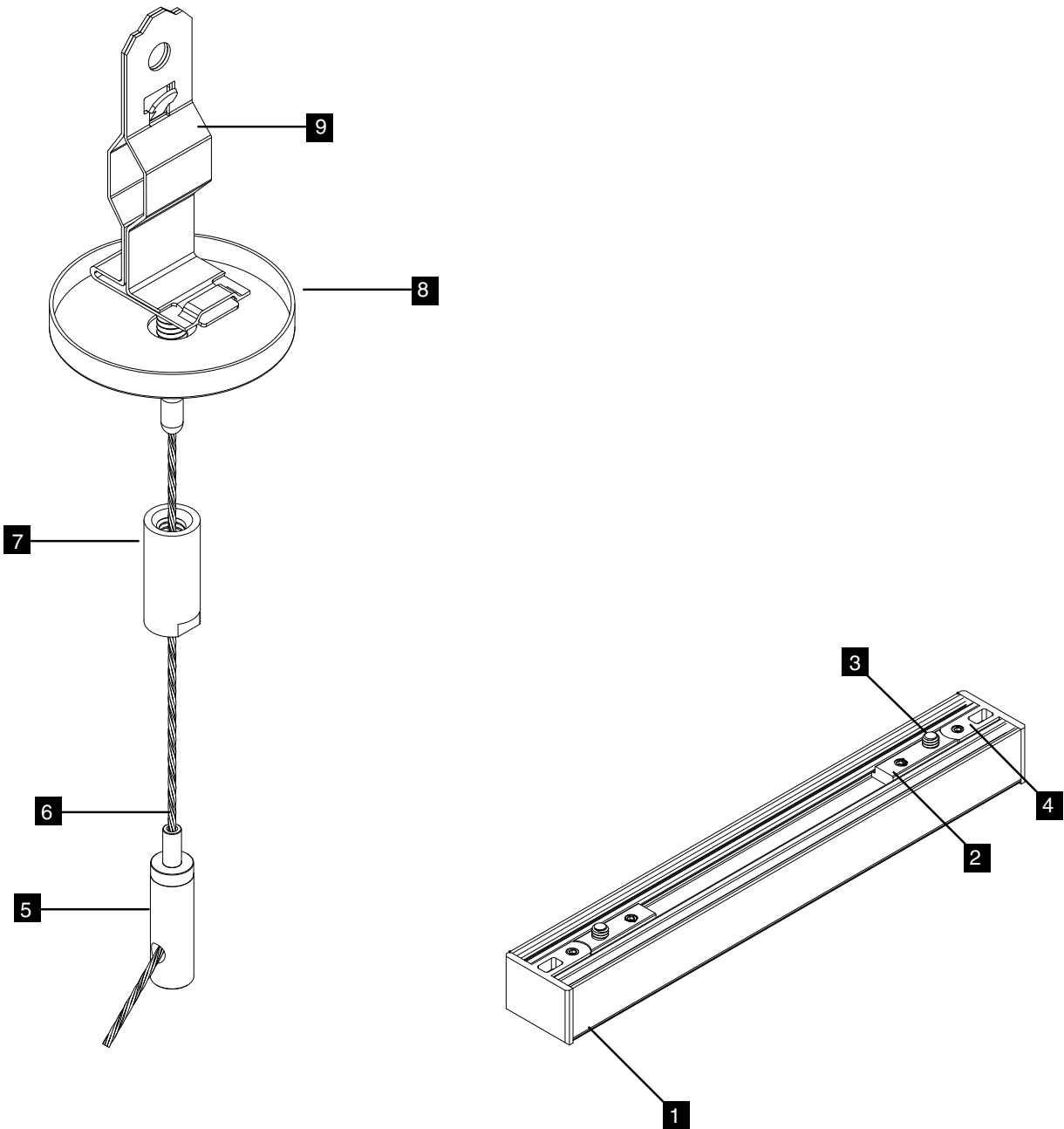

NON-POWERED FEED KIT

1	VERS	2	Suspension Bracket	3	8-32 Screw	4	Endcap	5	Cable Gripper
6	1/16" Cable	7	Cable Coupler	8	Canopy	9	T-Bar Clip		

VERS-LOUVER-SK (07)

Linear Fixtures - Suspended



LAG SCREW NON-FEED ASSEMBLY

SK-NF-RD-2-NF-*-LS-36

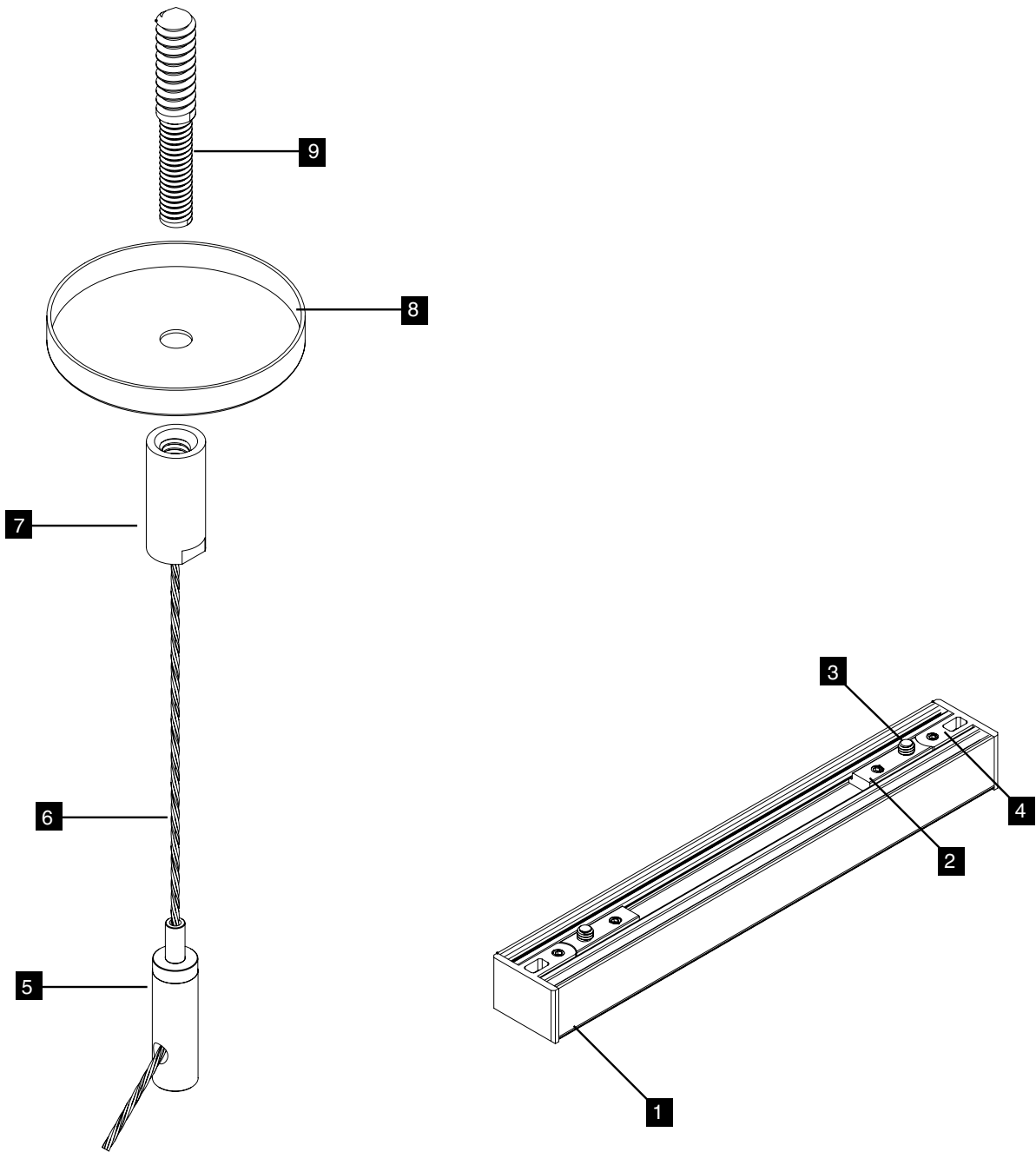

NON-POWERED FEED KIT

1 VERS	2 Suspension Bracket	3 8-32 Screw	4 Endcap	5 Cable Gripper
6 1/16" Cable	7 Cable Coupler	8 Canopy	9 Lag Screw	