

ELP

ENGINEERED LIGHTING
PRODUCTS

HITC LED SERIES

RECESSED Hole In The Ceiling Light Niche
For Plaster or Drywall

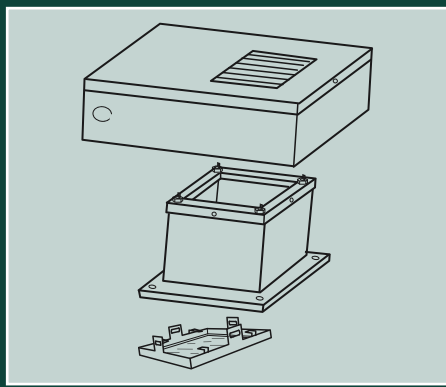
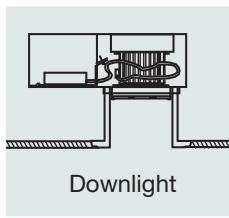

*Cast Downlights integrate into
your ceiling for the custom built
look of a drywall light niche.*

System

Round and Square aperture downlights cast with GRG (Glass fiber Reinforced Gypsum) composite material. Once installed, the fixture actually appears to be part of your ceiling and looks like a custom formed drywall "light niche" that blends with any interior motif.



HITC LED SERIES

RECESSED Hole In The Ceiling Light Niche
For Plaster or Drywall

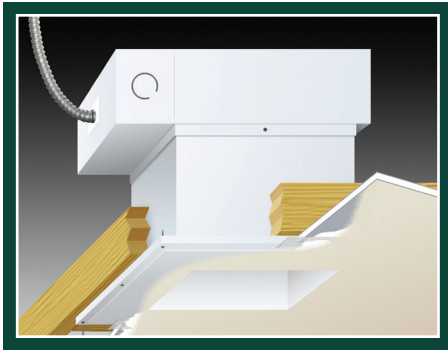

RESIDENTIAL



PERFORMING ARTS



COMMERCIAL

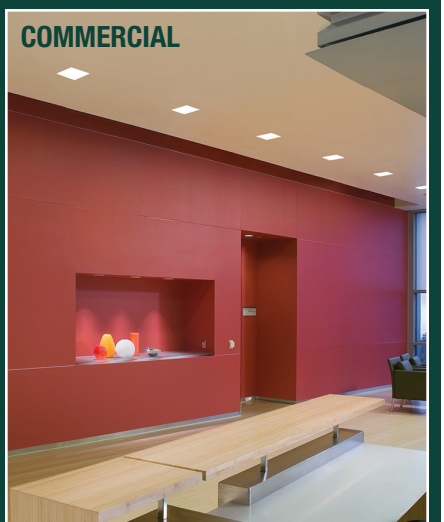

EDUCATIONAL





HITC LED SERIES

TYPE:
CATALOG #:
JOB:

RECESSED Hole In The Ceiling Light Niche
For Plaster or Drywall

Specifications

LED "Hole In The Ceiling" fixtures are available in round or square 4-1/2", 6", 8" and 10" apertures for 16, 20, 25 and 25 watts respectively. Fixtures utilize Bridgelux LEDs and are 90+CRI. These high color rendering LED lamps are an energy saving alternative to halogen and fluorescent sources. The recessed GRG fixture is fiberglass reinforced cast plaster with integral electrical components. All electrical components in the metal "Top Hat" are accessible through the bottom of the fixture. The LED dimming driver is supplied standard. Please specify.

The durable, GRG casting mounts directly to stud construction and allows 5/8" gypsum board construction butting the fixture. Metal "Top Hat" components combine 20 gauge CRS and aluminum for proper cooling of the LED. CRS components are TGIC polyester powder coated.

NOTE: Please do not specify or try to install this product without clear understanding of the installation instructions.

c/CSA/us Damp Location Listed, IC Rated - Made in the USA

Patent #7,824,059.

Options

Driver 120/277 0-10 volt, Osram OT 1% Dim (Standard)

For Alternate Dimming:

3-wire/Digital, Lutron ECO Systems L3D 1% -DM6

2-wire, Lutron LTE 1% (120v only) -DM7

Lower Lumen Output (All Driver Options) -LL**

** Consult Factory.

IC IC Rated (Standard)

LED **Must Specify* (Lumens vary per color)**

2700K -27K

3000K -30K

3500K -35K

4000K -40K

Lens Frosted Acrylic -MLF (Standard)
Frosted Glass "Lift & Shift" -LSGL
(LSGL Lens is 1-1/2" above the Ceiling)

Residential For 7-7/8" Height, -8H ♦
Height

Metal Finish White (Standard)
Anti-Microbial White -MB

Note: These models are California Title 24 compliant:

120W1-HITC-(S or R)-6 (*K)

125W1-HITC-(S or R)-8 (*K)

125W1-HITC-(S or R)-10 (*K)

** Multipliers = Lutron L3D is .9 / Lutron LTE is .75

*** S or R in Number indicates Square or Round Aperture.

♦ Available for Residential Height of 7-7/8" (Add -8H)

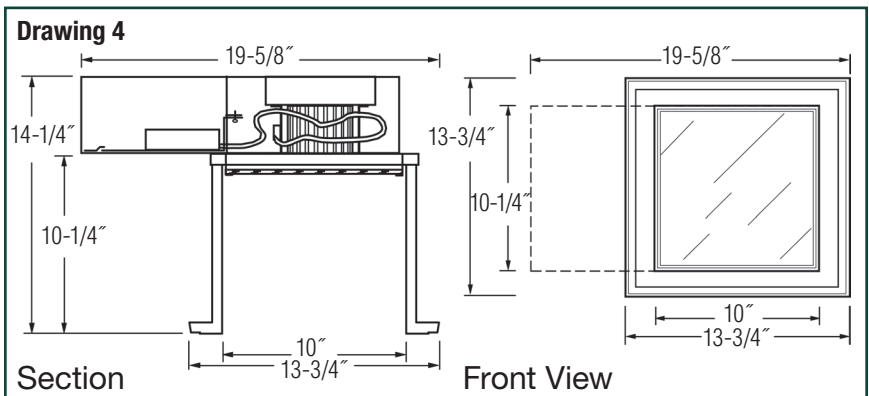
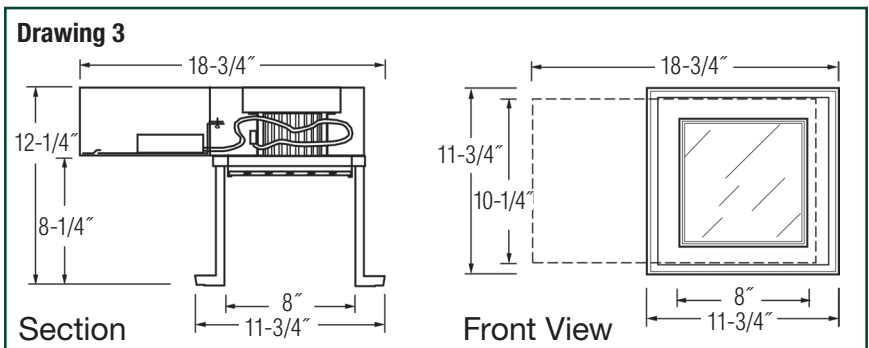
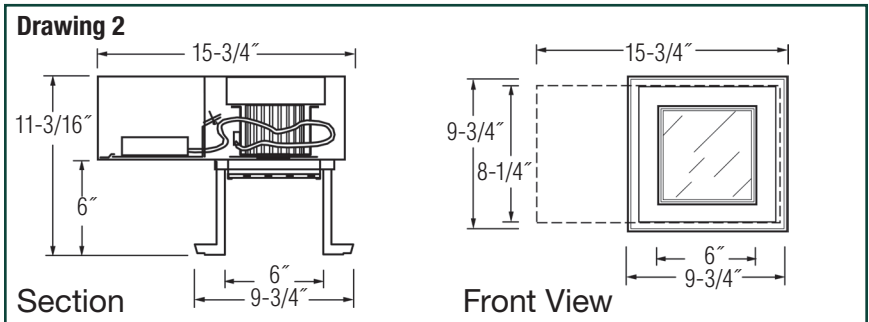
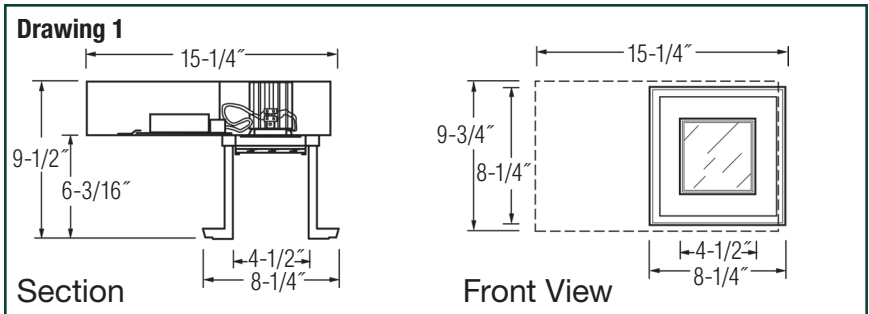

Model ***	Drawing	Watts	** Fixture Lumens for 3500K
116W1-HITC (S or R)-4 -(*K) ♦	1	16	650
120W1-HITC (S or R)-6 -(*K)	2	20	1175
125W1-HITC (S or R)-8 -(*K)	3	25	1525
125W1-HITC (S or R)-10 -(*K)	4	25	1525



HITC LED SERIES

TYPE:
CATALOG #:
JOB:

RECESSED Hole In The Ceiling Light Niche
For Plaster or Drywall

Additional Castings Available

Slope Castings for 4" Square:

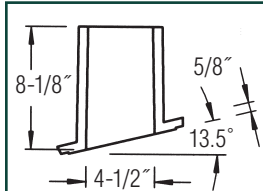

For "S-4" Fixtures, Add -13.5S
Standard Lens

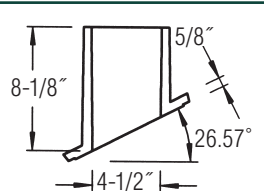

For "S-4" Fixtures, Add -26.57S
Standard Lens

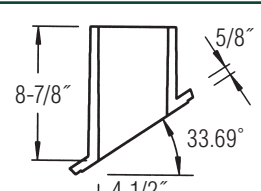

For "S-4" Fixtures, Add -33.69S
Standard Lens

Slope Castings for 4" Round:

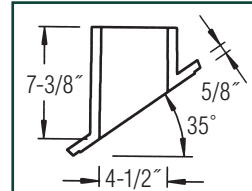

For "R-4" Fixtures, Add -35S
Standard Lens

Slope Castings for 6" Round:

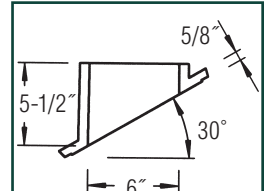

For "S-6" Fixtures, Add -30S
Lift and Shift Lens

RC18 Castings for 6" Round:

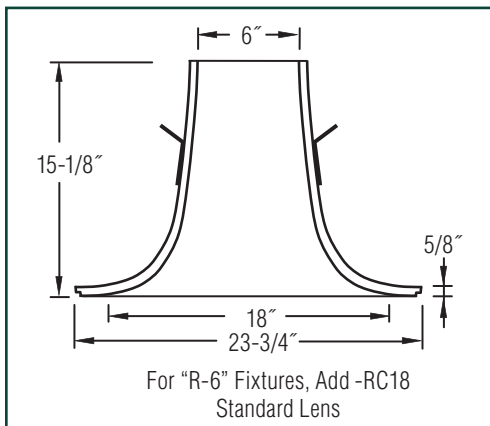

For "R-6" Fixtures, Add -RC18
Standard Lens

Custom Slope castings may be ordered. These slopes are currently available.

SEE DETAILED INSTALLATION INSTRUCTIONS

Installation

NOTE: Casting/Fixture should be installed by the drywall contractor and the metal "Top Hat" wired by the electrical contractor.

- 1) Fixture casting mounts directly to studs.
- 2) Install metal electrical unit and make connections.
- 3) Install drywall to the edge of the casting.
- 4) Use standard drywall tape and joint compound at the seam edges.
- 5) Sand and finish like typical drywall seam.
- 6) Finish fixture and ceiling.

Finished fixture appears to be a custom formed drywall light niche.

120W1-HITC-S6-35K

(9) Fixtures, 6' O.C.
Light Levels on the Lobby Floor

Ceiling at 12' Height

9	11	13	14	14	14	14	13	11	9
11	12	15	16	16	16	16	15	12	11
13	15	19	21	20	20	21	19	15	13
14	16	21	22	22	22	22	21	16	14
14	16	20	22	21	21	22	20	16	14
14	16	20	22	21	21	22	20	16	14
14	16	21	22	22	22	22	21	16	14
13	15	19	21	20	20	21	19	15	13
11	12	15	16	16	16	16	15	12	11
9	11	13	14	14	14	14	13	11	9

2' 20' 10'

IES File #120W1HITCS6_35 - Maintained Light Levels / Reflectance at .80 .50 .20