

LED POWERTAPE 800 Kit

Flexible 1.5/3.5-Meter (59-1/16" / 137-13/16") Indoor
– IP20
General Illumination

| Job Information | | |
|-----------------|--|------|
| Project Name | | Type |
| Location | | |
| Quantity | | Date |
| Contact/Phone | | |
| Notes | | |

Features

Lighting Performance

Available in 2500 lumens per meter, this high density LED tape maintains uniform intensity. Single CCT options 2700 K, 3000 K, 3500 K and 4000 K producing up to 2500 lumens per meter at 3500 K.

Color Temperature

Single CCT options 2700 K, 3000 K, 3500 K and 4000 K, with 90+ CRI.

Lumen Maintenance

LEDs reduce ongoing maintenance, has a rated life of over 50,000 hours.

Power Consumption

Operates as a constant voltage load at 24VDC, and consumes 30 Watts per meter.

Dimming

The LED tape is Wi-Fi dimmable when used with our OnCloud Adapter / High Power Oncloud Adapter (sold separately). See page 2 for driver options.

Note: Not compatible with standard dimmers.

Beam Spread

This LED tape features a 120° linear beam spread to provide even light distribution.

Operating Temperature

-20°C–42°C (-4°F–108°F).

Mounting

This flexible LED tape is provided with a 3M® high bond adhesive backing that provides secure mounting to smooth surfaces.

Environment

Suitable for dry locations; IP20 rated.

LED Driver

24V DC driver available as plug-in or hardwire, with a DC 2.1 connector. Drivers feature open and short circuit protection, and over voltage protection.

OnCloud Adapter / High Power OnCloud Adapter

An integrated constant voltage LED driver and a Wi-Fi + Bluetooth controller module. Available in 40W and 96W.

Kit Includes

- Tape at selected length with powerfeed
- LED driver
- 24V 1-channel OnCloud adapter
- DC 2.1 jack low-voltage powerfeed
- Extrusion with lens and end caps (optional)

Note: Connectors sold separately, see Accessories below.

| SPECIFICATION | |
|--------------------|---|
| Application | General Illumination |
| Approved location | Dry |
| Beam Angle | 120° |
| CCT | Single CCT (2700 K / 3000 K / 3500 K / 4000 K) |
| Certification | cETLus |
| CRI | 90+ |
| Dimming | Yes |
| Dimming Technology | Wireless OnCloud |
| LED Density | 120 LEDs/m |
| Link Connector | TP-CON-12MM2PIN-I-20 |
| Lumens | 2500lm/m (750lm/ft) |
| Lumens per watt | Up to 83 |
| Max. Op. Temp. | 42°C (108°F) |
| Maximum Run | 3.5 meters (11.5-ft) |
| Min. Start Temp. | -20°C (-4°F) |
| Power Supply Type | Constant Voltage |
| Projected Life | 70% @ 50,000 hrs |
| Voltage | 24V DC |
| Warranty | 3 Years |
| Wattage | 30W per meter |



Description

The Powertape 800 Kit includes Tape at selected length, LED driver, OnCloud Adapter, low-voltage powerfeed, and extrusion (optional). This LED tape provides ample illumination for residential, retail and commercial general illumination. Suitable for dry locations.



Notes: Accessories should be ordered separately. For additional options please consult your Liteline representative. Due to our continued efforts to improve our products, product specifications are subject to change without notice.

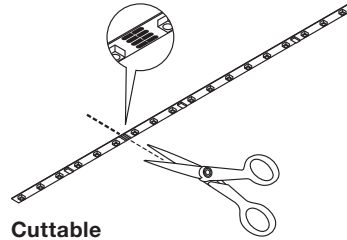
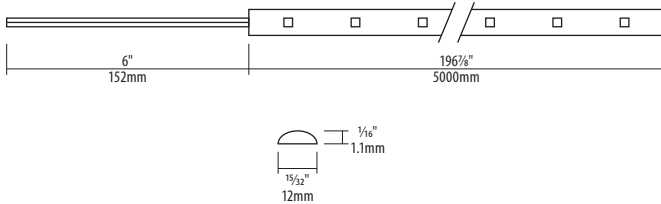

Cutttable

(Every 2" / 50mm)

Use Silicone (not included) to seal cut end.

Ordering Guide

| Length | CCT | Driver | Lens + Channel ² |
|---|--------------------|---------------------------------|------------------------------|
| TP- [] | [] | 30 - OCKIT | [] |
| 0140 : 1.5-meter, 40W Adapter | 27 : 2700 K | 1 : Hardwire | Leave blank for no extrusion |
| 0398 : 3.5-meter, 96W High Power Adapter | 30 : 3000 K | 2 : Plug-in ¹ | 2 : LED-TP-AL1715SA |
| | 35 : 3500 K | | 3 : LED-TP-AL1715RA |
| | 40 : 4000 K | | |



¹ Plug-in driver can only be used with 1.5-meter length. ² Appropriate amount will be provided in 2M (6ft) lengths, tape connectors require a gap.

Component Overview Présentation des composants

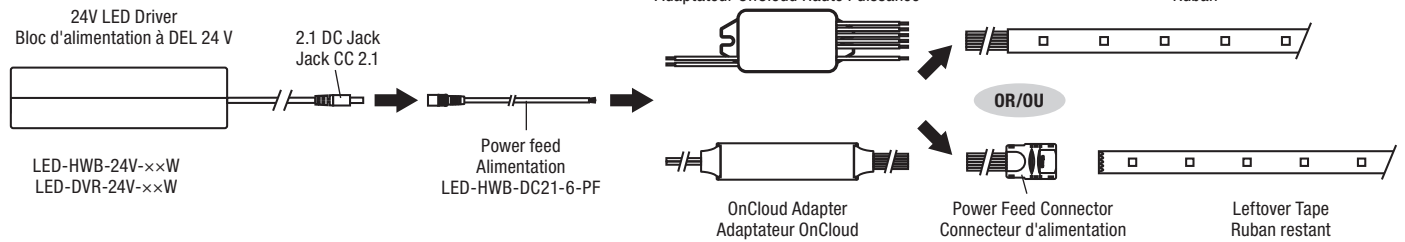

Additional Tape



TP-5M30W-2790-20

5-Meter roll, 2500lm per meter (30W per meter), IP20, 24VDC, 2700 K.



TP-5M30W-3590-20

5-Meter roll, 2500lm per meter (30W per meter), IP20, 24VDC, 3500 K.



TP-5M30W-3090-20

5-Meter roll, 2500lm per meter (30W per meter), IP20, 24VDC, 3000 K.



TP-5M30W-4090-20

5-Meter roll, 2500lm per meter (30W per meter), IP20, 24VDC, 4000 K.

Extrusions

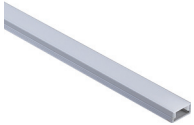

SURFACE MOUNT LED-TP-AL1607

- 7mm deep
- 1680lm/m (512lm/ft)
- Compatible with tape up to 12mm wide
- 2m (6ft)
- Includes end caps (2 pcs) and mounting clips (4 pcs)

Dot Rendering Scale



Mostly Diffused



LED-TP-AL1607-EC

End cap for LED-TP-AL1607, 2-pack.



LED-TP-AL1607-MC

Mounting clips for LED-TP-AL1607, 4-pack.

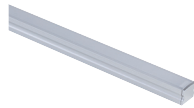

SURFACE MOUNT LED-TP-AL1715SA

- 15mm deep
- 1375lm/m (412lm/ft)
- Compatible with tape up to 12mm wide
- 2m (6ft)
- Includes end caps (2 pcs) and mounting clips (4 pcs)

Dot Rendering Scale



Fully Diffused



LED-TP-AL1715SA-EC

End cap for LED-TP-AL1715SA, 2-pack.



LED-TP-AL1715SA-MC

Mounting clips for LED-TP-AL1715SA, 4-pack.



RECESSED MOUNT LED-TP-AL1715RA

- 15mm deep
- 1375lm/m (412lm/ft)
- Compatible with tape up to 12mm wide
- 2m (6ft)
- Includes end caps (2 pcs)

Dot Rendering Scale



Fully Diffused



LED-TP-AL1715RA-EC

End cap for LED-TP-AL1715RA, 2-pack.

Connectors



TP-CON-12MM2PIN-F-20

2-Pin 24VDC 5 Amps max. 175mm power feed. For use with TP-5M30W-xx90-20. 10 pack.



TP-CON-12MM2PIN-I-20

2-Pin 24VDC 5 Amps max. "I" connector. For use with TP-5M30W-xx90-20. 10 pack.



TP-CON-12MM2PIN-P-20

2-Pin 24VDC 5 Amps max. 175mm jumper. For use with TP-5M30W-xx90-20. 10 pack.

OnCloud



LC-CRTL-SCENE-1

OnCloud Room Controller, Wi-Fi, On/OFF, CCT, Dimming and favourite scenes.



LC-CRTL-RMT01WIZ-BK

OnCloud multi-function remote control.



LC-DVR-CV96W1TP-1C

40W 24V DC 1-Channel OnCloud adapter, controls wireless dimming and on/off capability. Compatible with the WIZ app, Room Controller and smart speakers.



OC-DVR-CV96W1TP-1C

96W 24V DC 1-Channel High Power OnCloud adapter, controls wireless dimming and on/off capability. Compatible with the WIZ app, Room Controller and smart speakers.

Plug-in Drivers (non-dimming)



LED-DVR-24V-36W
LED plug-in driver with DC 2.1
jack, 24V, 36W.



LED-DVR-24V-60W
LED plug-in driver with DC 2.1
jack, 24V, 60W.

Power feed required



LED-HWB-DC21-6-PF
DC 2.1 barrel plug to bare
leads power feed.

Indoor Hardwire Drivers (non-dimming)



LED-HWB-24V-36W
LED hardwire driver with DC 2.1
jack, 24V, 36W.



LED-HWB-24V-60W
LED hardwire driver with DC 2.1
jack, 24V, 60W.



LED-HWB-24V-100W
LED hardwire driver with DC 2.1
jack, 24V, 100W.

Power feed required



LED-HWB-DC21-6-PF
DC 2.1 barrel plug to bare
leads power feed.