

ATF7335-BD

Barn Door for LED Architectural Track Head Track Lighting

| Job Information | | |
|-----------------|--|------|
| Project Name | | Type |
| Location | | |
| Quantity | | Date |
| Contact/Phone | | |
| Notes | | |

Features

Barn Door

The Barn Door is an accessory to be used in conjunction with the 35W LED architectural track head (ATF7335-30 sold separately). Constructed from aluminum and available in White and Black finishes.

Mounting

Each Barn Door can be easily attached into the track head. It's equipped with four adjustable cut-off doors.

Applications

The LED architectural track head Barn Door (ATF7335-BD) is ideal for a wide range of accent and task lighting for hospitality, commercial and residential applications.

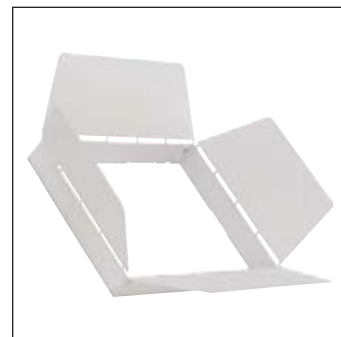

Description

The ATF7335-BD is a Barn Door to be used with the 35W LED Architectural Track Head (ATF7335-30). The barn door accessory enhances the cut-off of the light for this architectural track head. Available in White and Black .

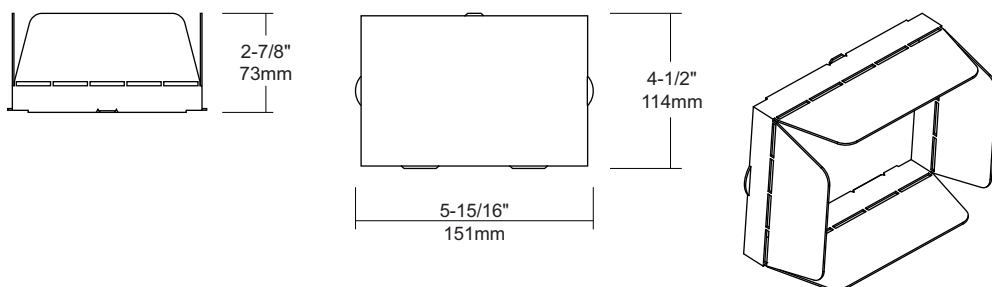

Notes: Due to our continued efforts to improve our products, product specifications are subject to change without notice.

Ordering Guide

| | |
|--------------|---------------|
| ATF7335-BD - | Colour/Finish |
| | BK : Black |
| | WH : White |

Example: ATF7335-BD-WH