

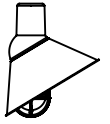

SPS-0530 REV B

**FIRE CHIEF NAUTICAL LED SIGN LIGHT**

JOB NAME: \_\_\_\_\_ FIXTURE TYPE: \_\_\_\_\_



BLE - G -	-	-	-	-	-	-	-
A	B	C	D	E	F	G	
H	I	J	K				

Order Example: BLE - G - ASFC12 - 200 - G22 - 200 - SWK - TGG - FST - 200 - DBPC - LED16.8 - 3500K

**A - SHADE SIZE****FIRE CHIEF:**

ASFC12	12" Shade
ASFC14	14" Shade

**B - SHADE FINISH****PORCELAIN FINISHES<sup>1</sup>:**

150	Black
250	White
350	Vintage Green
355	Jadite
455	Cherry Red
550	Yellow
650	Bronze
750	Cobalt Blue
765	Delphite Blue
850	Graphite
950	Metallic Chrome

**POWDER COAT FINISHES<sup>2</sup>:**

100	Black
105	Textured Black
200	White
300	Dark Green
307	Emerald Green
311	Jadite
370	Mint
380	Chartreuse
390	Teal
400	Barn Red
420	Orange
470	Watermelon
480	Blush Pink
490	Magenta
495	Sherbet Orange
500	Buttery Yellow
570	Sunflower
600	Bronze
601	Chocolate
605	Rust
615	Oil-Rubbed Bronze
700	Royal Blue
705	Navy
710	Cobalt Blue
715	Delphite Blue
790	Lavender
800	Industrial Grey
805	Charcoal Granite
810	Graphite
975	Galvanized

**NATURAL METALS<sup>3</sup>:**

995	Raw Copper
996	Weathered Copper
997	Raw Brass
998	Weathered Brass
999	Oil-Rubbed Copper

**C - GOOSENECK ARMS****GOOSENECK OPTIONS:**

G1 <sup>4</sup>	G16 <sup>4</sup>
G2 <sup>4</sup>	G17
G5 <sup>4</sup>	G22
G6	G24
G7	G25
G8	G26 <sup>4</sup>
G9	G32
G10	G34 <sup>4</sup>
G11 <sup>4</sup>	G35 <sup>4</sup>
G12 <sup>4</sup>	G36 <sup>4</sup>
G13	G64 <sup>4</sup>
G14	G65 <sup>4</sup>
G15	

**D - GOOSENECK ARM FINISH**

Please Note: See **Section B** for all applicable Gooseneck Arm Finish Options. Gooseneck Arms are also available in 980-Brushed Aluminum.  
(1) If Porcelain Finish selected, Gooseneck Arm will be Powder Coat Painted-To-Match.

980 Brushed Aluminum<sup>5</sup>**E - SWIVEL KNUCKLE**

NA	None
SWK	Swivel Knuckle <sup>4</sup>

**F - SHADE ACCESSORIES<sup>4</sup>**

NA	No Guard
TGG	Heavy Duty Guard
CGG	Cast Guard
WGG	Wire Guard

**G - GLASS OPTIONS**

CLR	Clear Glass
FST	Frosted Glass
RIB	Ribbed Glass
SMK	Smoke Crackle Glass
BLU	Blue Glass
RED	Red Glass
AMB	Amber Glass
GRN	Green Glass

**H - SHADE ACCESSORY FINISH**

Please Note: See **Section B** for all applicable Accessory Finish Options.  
(I) Guards not available in Natural Metals.  
(II) If Porcelain Finish is selected, accessory will be Powder Coat Painted-To-Match.

NA None/Not Applicable

**I - MOUNTING ACCESSORY**

Please Note: Mounting Accessories below are only applicable with select Mounting Styles. Please refer to product listings on our website for further detail.

NA	None/Not Applicable
DBPC	Decorative Backing Plate Cover
DCHX	Decorative Backing Plate Cover & Hex Cover
DD	Dusk-to-Dawn Photocell

**J - LIGHT SOURCE**

LED16.8 1600 Lumen, 16.8W LED

**K - COLOR TEMPERATURE**

2700K	2700K, Warm White
3000K	3000K, Neutral White
3500K	3500K, Bright White
4000K	4000K, Cool White

**IMPORTANT:** (1) All Porcelain Enamel finished shades feature a white interior and a black outer rim (2) All Powder Coat finished shades, Galvanized excluded, feature a white interior (3) Natural Metals have a longer estimated manufacturing time, please check the website for exact lead time. There are no returns accepted on Natural Metals (4) Not available in Natural Metals (5) Not available with the G36, G40, G64, and G65

MOUNTING STYLE

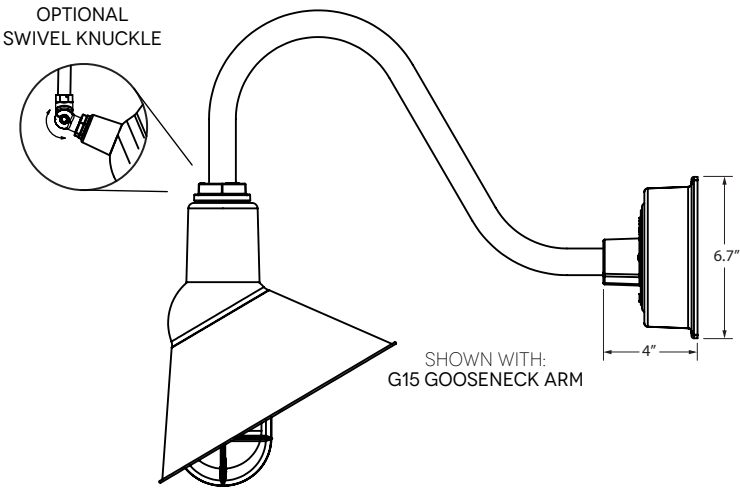

LUMINAIRE DIMENSIONS

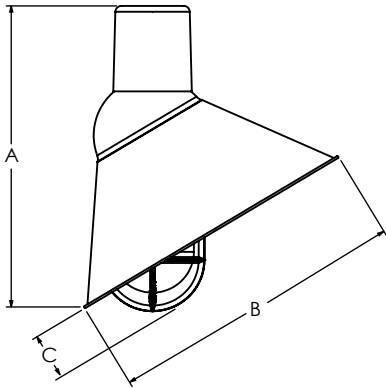

SHADE CODE	HEIGHT (A)	DIAMETER (B)	EXTENSION (C)
ASFC12	12.3"	12"	1.8"
ASFC14	13.6"	14"	1"

SPECIFICATIONS

CERTIFICATIONS, LISTINGS & WARRANTY

MADE IN THE USA  
Manufactured and Hand-Crafted in Our 60,000 Square Foot Facility Located in Titusville, FL

CSA LISTED FOR WET LOCATIONS

OPERATING TEMPERATURE RANGE  
-30°C to 40°C

LIMITED WARRANTY  
For Additional Information on Our Limited Warranty, Please See Our Terms & Conditions

CONSTRUCTION & FINISH (CONTINUED)

COPPER  
Hand-Spun from High Purity .032 Thick C11000-O60 ETP Copper

BRASS  
Hand-Spun from High Purity .050" Thick C2600-O60 Brass

GOOSENECK  
1/2" Nominal (0.84" Actual) or 3/4" Nominal (1.05" Actual) Sch 40, 6063 Aluminum Gooseneck

MAX FIXTURE WEIGHT  
10 lbs

CONSTRUCTION & FINISH

POWDER COAT SHADE  
Hand-Spun from High Purity 3003-O Temper Aluminum

GALVANIZE SHADE  
Hand Spun from High Quality Galvanized Steel

PORCELAIN SHADE  
Hand-Spun from 20 Gauge Porcelain Steel

POWDER COAT FINISHES  
Polyester Powder Coat Finishes Are Electro-Statically Applied and Thermocured

PORCELAIN FINISHES  
Applied by Hand and Fired in a High Temperature Oven

LED LIGHT SOURCE

LED TYPE: CREE LMH2 MODULE

INITIAL LUMENS DELIVERED: UP TO 1600 LUMENS

L90(6K) > 36,300 HOURS

AVAILABLE CCT: 2700K, 3000K, 3500K, 4000K  
Custom Temperatures Available upon Request

90+ CRI

2 STEP MACADAMS ELLIPSE

EFFICACY: UP TO 95 LPW  
High Efficacy Available upon Request, Consult Factory for Additional Information

SPECIFICATIONS (CONTINUED)

ELECTRICAL/LED DRIVER

DRIVER TYPE: ERP ESS/T & ESP/T

POWER FACTOR > 0.9

EFFICIENCY: UP TO 87% TYPICAL

INPUT VOLTAGE: 120–277 VAC (SEE DIMMING SECTION)

CLASS 2 POWER SUPPLY

LED DRIVER LIFETIME: > 100,000 HOURS (@ 25 DEG C AMBIENT)

IP64 MINIMUM RATING CASE WITH SILICONE–BASED POTTING

PROTECTIONS

**Output Open Load, Over-Current and Short-Circuit (hiccup), and Over-Temperature with Auto Recovery**

CONDUCTED AND RADIATED EMI

**Compliant with FCC CFR Title 47 Part 15 Class B (120 VAC), Class A (277 VAC) and EN55015 (CISPR 15) at 220, 230 and 240 VAC**

COMPLIANT WITH

**Complies with Energy Star® DLR (DesignLight Consortium®) and CA Title 24 Technical Requirements**

DIMMING

TRI–MODE DIMMING™

**Compatible with Triac (Forward-Phase or Leading-Edge), ELV (Reverse-Phase or Trailing-Edge) and 0-10V Dimmers**

DIMMING RANGE 1–100%

**The Dimming Range Is Dependent on Each Specific Dimmer. May Not Be Able to Achieve 1% Dimming with Some Dimmers**

TRIAC AND ELV DIMMING ONLY AT 120 VAC

ELV DIMMING AT 230 VAC

**Available by Request**

COMPATIBLE DIMMERS

**Consult Factory for Additional Information on Dimming**