

## PRIME 3" LED ARCHITECTURAL ROUND FLANGED OPEN/ACCENT TRIM ADJUSTABLE

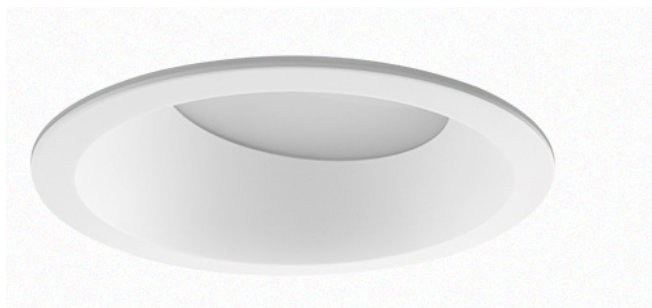

### USE OF PRODUCT

The 3" PRIME Adjustable is a small aperture fixture with shallow height that may be used in residential and commercial applications. Available with die cast or spun aluminum trims, with an assortment of color temperatures, optics and dimmable drivers.

### LED ENGINE

LED engine available with CREE LEDs in 2700K, 3000K, 3500K, or 4000K in standard 93+ CRI. 2 Step MacAdam ellipse allows for color consistency between fixtures. LED mounted to aluminum heat sink for maximum life output and thermal management. LED engine is accessible from below ceiling.

### FRAME CONSTRUCTION

IC rated housing constructed from 16 gauge heavy duty powder coated cold rolled steel frame. Junction box with 1/2" knockouts. Butterfly bracket included to accommodate adjustable bar hangers or C-channel (ordered separately).

### ADJUSTMENT

- Light engine allows for hot aiming from 0-40°.
- Housing provides for 359° locking rotation
- Aperture collar compatible up to 1 1/2" ceiling thickness.
- Accommodation for 2" or 3" ceiling thickness available upon request.

### OPTICAL LENS & FILTER (Field Replaceable)

Field replaceable optical lens available in 12°, 22°, 27°, 35° and 45°. Easily achieve narrow spot to wide flood beam pattern. Accepts up to 2 filters.

### DIMMING

Available in 8 driver selections. (ID) Standard all-inclusive ELV(120V), Triac(120V), and 0-10V(120-277V) dimming driver called Intelligent Drive, 120-277V. (PEQ0) Lutron Hi-Lume Premier Ecosystem 0.1% w/soft on, fade to black dimming, 120-277V. (LDE1) Lutron Hi-Lume 1% Ecosystem with soft on, fade to black dimming, 120-277V. (L3DA) Hi-lume 1% EcoSystem/3-Wire L3D Driver (EEI) eldoLED Eco 1% Dim (0-10V), 120-277V. (EDIO) eldoLED Solo 0.1% Dim(0-10V), 120-277V. (EDID) eldoLED Solo 0.1% Dim(DALI), 120-277V. Driver accessible from below ceiling.

### THERMAL MANAGEMENT

Ambient temperatures at fixture location should not exceed -20° to 40°C.

### EMERGENCY BATTERY

Optional emergency battery available for a minimum of 90 minutes with Remote test switch in 800 delivered lumens.

### TRIM

Trim available in die cast or spun aluminum. Consult factory for made to order finishes. Flanged trim is compatible with all ceiling materials.

### LABELS/COMPLIANCE/WARRANTY

- CSA Listed for US and Canada
- Energy Star
- Dry/Damp/Wet location rated.
- Title 24, JAS Compliant
- 5 Year limited warranty.



## ORDERING INFORMATION

### RPM

Series	Aperture Size	Lumens	Color Temperature	Voltage	Dimming	Optical Lens	Filter
RPA	3 - 3"	8L - 890 lm	27 - 2700K	UNV - 120-277	ID <sup>2</sup> - Standard all-inclusive ELV, Triac, and 0-10V dimming driver (Intelligent Drive)	12 - 12°	None - Leave blank
PRIME Series		11L - 1175 lm	30 - 3000K	120 - 20V	PEQ0 <sup>3</sup> - Lutron Hi-Lume Premier Ecosystem 0.1% w/ soft on, fade to black dimming	22 - 22°	F - Frosted filter
		16L - 1650 lm	35 - 3500K	347 - 347V	LDE1 <sup>3</sup> - Lutron Hi-Lume 1% Ecosystem with soft on, fade to black dimming	27 - 27°	H - Honey comb
		20L <sup>1</sup> - 2000 lm	40 - 4000K		LTE <sup>3</sup> - Lutron Hi-Lume 1% 2-wire	35 - 35°	S - Solite filter
					L3DA <sup>3</sup> - Hi-lume 1% EcoSystem/3-Wire L3D Driver	45 - 45°	L - Linear filter
					EEI <sup>3</sup> - eldoLED Eco 1% Dim (0-10V)		
					EDIO <sup>3,4</sup> - eldoLED Solo 0.1% Dim (0-10V)		
					EDID <sup>3,4</sup> - eldoLED Solo 0.1% Dim (DALI)		

Housing Type	Aperture	Frame Accessories	Collar	Options
IC - IC Air-tight New Construction	RFA - Round Flanged Adjustable	AH - Adjustable bar hanger C - C Channel bar hanger B - Flat bar hanger	Blank - 1.5" Depth 20 - 2" Depth 30 - 3" Depth MTO - Made to order	ER8 <sup>2</sup> - Emergency battery with remote switch (800 Lumens) CP - Chicago Plenum DF - Dead Front
NC - Non-IC New Construction				

## TRIM ORDERING INFORMATION

Aperture Size / Shape / Trim Type / Style	Bevel Opening	Bevel	Flange	Options
3RFO - 3" Round Flange Open 3RFA - 3" Round Flange Accent	Die Cast CL - Die cast large opening	W - White B - Black H - Haze BZ - Bronze C - Clear MTO - Made to order	W - White B - Black BZ - Bronze MTO - Made to order	WL - Wet Location
Spun Aluminum (Self Flanged)	AL - Spun alum. Large opening	H - Haze C - Clear MTO - Made to order		WL - Wet Location

- Notes
1. Not Available in IC
  2. Intelligent Drive is the standard driver.
  3. Ceiling access required.
  4. Must specify logarithmic or inear eldoLED diver.

## LUMEN CHART

Wattage	Delivered Lumens	Voltage	CRI
10W	890 lm	120 - 277V	93+
14W	1175 lm	120 - 277V	93+
20W	1650 lm	120 - 277V	93+
30W	2000 lm	120 - 277V	93+

\*Above chart, ordering information, and IES File name reflect delivered lumens based 3000K and 30° optical lens.  
 \*\*Lumens will vary based on CCT, optical lens, and bevel finish.

## TRIM THICKNESS

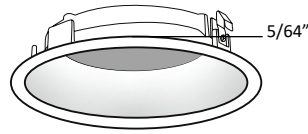

Die Cast

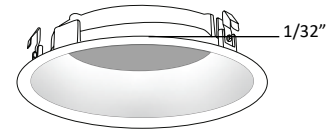

Spun Aluminum

## TRIM DIMENSION

Large Opening

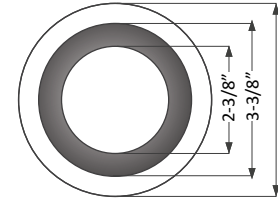
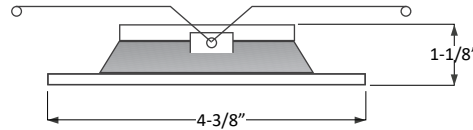

Accent Trim

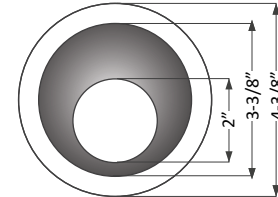
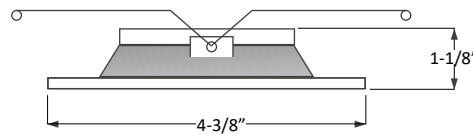

## MODULE/HEATSINK, LED HOLDER & FILTER DIMENSION

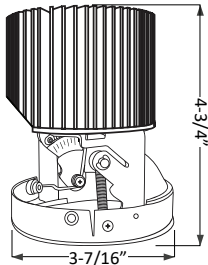

Module & Heatsink

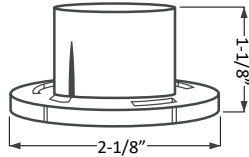

LED Holder (Body)

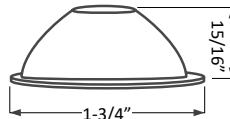

Optics

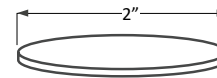

Filter

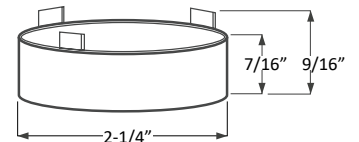

LED Holder (Head)

## HOUSING DIMENSION



NC - Non-IC New Construction

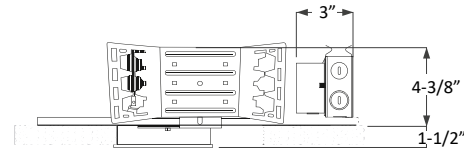
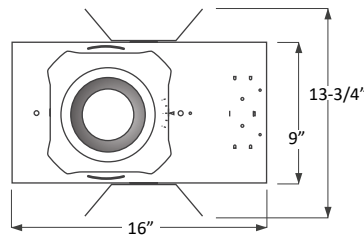

IC - Air-tight New Construction

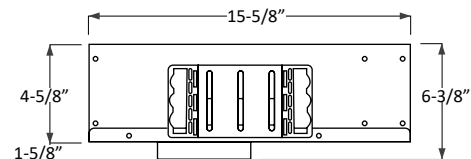
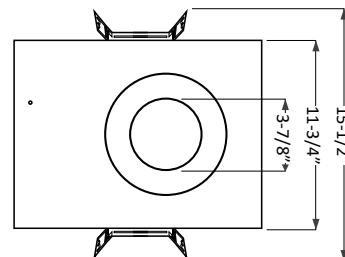

## COLLAR DEPTH PER CEILING THICKNESS

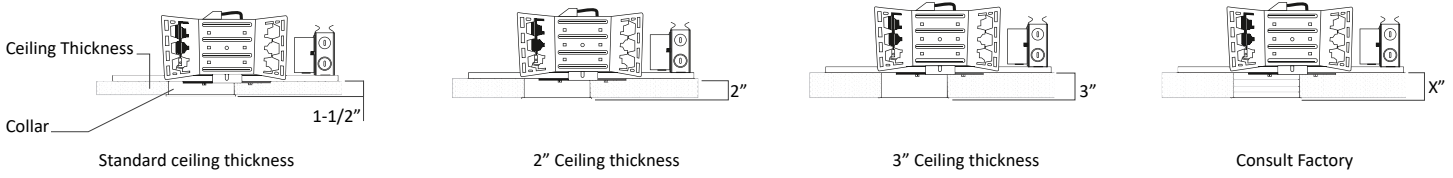

## FRAME ACCESSORIES

<p><b>B</b> Flat Bar Hanger</p>	<p>27"</p> <p>1/2"</p>
<p><b>C</b> C Channel Bar Hanger</p>	<p>25-3/16"</p> <p>1-6/16"</p>
<p><b>AH</b> Adjustable Bar Hanger</p>	<p>14 1/4" - 25 1/2"</p> <p>0°-90° Tilt</p> <p>0 - 90° Tilt</p> <p>Locked at 90°</p> <p>1/2"</p>