

PRIME 4" LED ARCHITECTURAL ROUND FLANGED WALL WASH WITH WARM DIM



WARM DIM

USE OF PRODUCT

The 3" PRIME Wall Wash is a small aperture fixture with shallow height that may be used in residential and commercial applications. Available with die cast or spun aluminum trims, with an assortment of color temperatures, optics and dimmable drivers.

PRIME FEATURES

Color Temperature: Warm Dim (3000K-1800K)
SDCM: 2 step binning
Color Rendering Index: 93+ CRI
Optical Lens: 12°, 22°, 27°, 35°, 45°
Trim: Die cast or spun aluminum
LED Life: 50,000 Hours
LED Type: Cree LED
Driver Info: 120-277V, 50/60 Hz, PF>0.9, THD<0.20
Warranty: 5 year limited warranty

LED ENGINE

LED engine available with Warm-Dim standard 90+ CRI. 2 Step MacAdam ellipse allows for color consistency between fixtures. LED mounted to aluminum heat sink for maximum life output and thermal management. Light engine provides a quick disconnect with locking strain relief to housing.

FRAME CONSTRUCTION

IC Air-tight rated housing constructed from 16 gauge heavy duty powder coated cold rolled steel frame. Junction box with 1/2" knockouts. Butterfly bracket included to accommodate adjustable bar hangers or C-channel (ordered separately).

ADJUSTMENT

- Light engine locked at 25° tilt, consult factory for other tilt setting.
- Housing provides for 359° locking rotation
- Aperture collar compatible up to 1½" ceiling thickness.
- Accommodation for 2" or 3" ceiling thickness available upon request.

OPTICAL LENS & FILTERS (Field Replaceable)

Field replaceable optical lens available in 12°, 22°, 27°, 35° and 45°. Easily achieve narrow spot to wide flood beam pattern. Accepts up to 2 filters.

DIMMING

Available in 8 driver selections. (ID) Standard all-inclusive ELV(120V), Triac(120V), and 0-10V(120-277V) dimming driver called Intelligent Drive, 120-277V. (PEQ0) Lutron Hi-Lume Premier Ecosystem 0.1% w/soft on, fade to black dimming, 120-277V. (LDE1) Lutron Hi-Lume 1% Ecosystem with soft on, fade to black dimming, 120-277V. (L3DA) Hi-lume 1% EcoSystem/3-Wire L3D Driver (EEL) eldoLED Eco 1% Dim (0-10V), 120-277V. (EDIO) eldoLED Solo 0.1% Dim(0-10V), 120-277V. (EDID) eldoLED Solo 0.1% Dim(DALI), 120-277V. Driver accessible from below ceiling.

THERMAL MANAGEMENT

Ambient temperatures at fixture location should not exceed -20° to 40°C.

EMERGENCY BATTERY

Optional emergency battery available for a minimum of 90 minutes with remote test switch in 800 delivered lumens.

TRIM

Trim available in die cast or spun aluminum. Consult factory for made to order finishes. Flanged trim is compatible with all ceiling materials.

LABELS/COMPLIANCE/WARRANTY

- CSA Listed for US and Canada
- Dry/Damp/Wet location rating.
- 5 Year limited warranty.



ORDERING INFORMATION

| Series | Aperture Size | Lumens | Color Temperature | Voltage | Dimming | Optical Lens | Filter |
|--------------|---------------|---------------|-------------------|-------------------------|---|--|--|
| RPA | 3 - 3" | 9L - 975 lm | WD - Warm Dim | UNV - 120-277 | ID ¹ - Standard all-inclusive ELV, Triac, and 0-10V dimming driver (Intelligent Drive) | 12 - 12° | None - Leave blank |
| PRIME Series | | 11L - 1100 lm | | 120 - 20V 347 - 347V | PEQ0 ² - Lutron Hi-Lume Premier Ecosystem 0.1% w/ soft on, fade to black dimming LDE1 ² - Lutron Hi-Lume 1% Ecosystem with soft on, fade to black dimming LTE ² - Lutron Hi-Lume 1% 2-wire L3DA ² - Hi-lume 1% EcoSystem/3-Wire L3D Driver EEI ² - eldoLED Eco 1% Dim (0-10V) EDIO ^{2,3} - eldoLED Solo 0.1% Dim (0-10V) EDID ^{2,3} - eldoLED Solo 0.1% Dim (DALI) | 22 - 22° 27 - 27° 35 - 35° 45 - 45° | F - Frosted filter H - Honey comb S - Solite filter L - Linear filter |

| Housing Type | Aperture | Frame Accessories | Collar | Options |
|---------------------------------|-------------------------------|---|---|---|
| IC - Air-tight New Construction | RFW - Round Flanged Wall Wash | AH - Adjustable bar hanger C - C Channel bar hanger B - Flat bar hanger | Blank - 1.5" Depth 20 - 2" Depth 30 - 3" Depth MTO - Made to order | ER8 ² - Emergency battery with remote switch (800 Lumens) CP - Chicago Plenum |

TRIM ORDERING INFORMATION

| Aperture Size / Shape / Trim Type / Style | Bevel Opening | Bevel | Flange | Options |
|---|---|---|--|--------------------------|
| 3RFA - 3" Round Flange Accent | <p>Die Cast</p> <p>CL - Die cast large opening</p> | <p>W - White B - Black H - Haze BZ - Bronze C - Clear MTO - Made to order</p> | <p>W - White B - Black BZ - Bronze MTO - Made to order</p> | <p>WL - Wet Location</p> |
| | <p>Spun Aluminum (Self Flanged)</p> <p>AL - Spun alum. Large opening</p> | <p>H - Haze C - Clear MTO - Made to order</p> | | <p>WL - Wet Location</p> |

Notes
1. Intelligent Drive is the standard driver.
2. Ceiling access required.
3. Must specify logarithmic or inear eldoLED diver.

LUMEN CHART

| Wattage | Delivered Lumens | Voltage | CRI |
|---------|------------------|------------|-----|
| 10W | 975 lm | 120 - 277V | 93+ |
| 12W | 1100 lm | 120 - 277V | 93+ |

TRIM THICKNESS

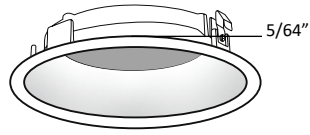

Die Cast

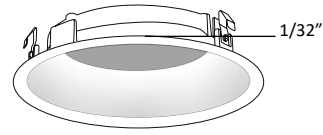

Spun Aluminum

TRIM DIMENSION

Accent Trim

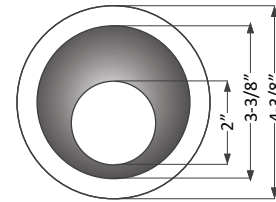
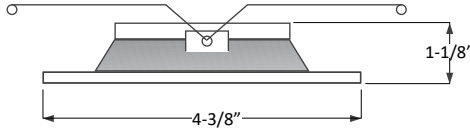

MODULE/HEATSINK, LED HOLDER & FILTER DIMENSION

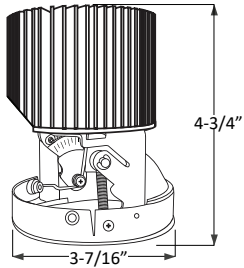

Module & Heatsink

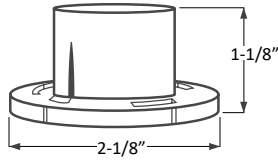

LED Holder (Body)

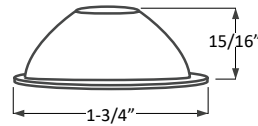

Optics

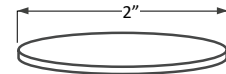

Filter

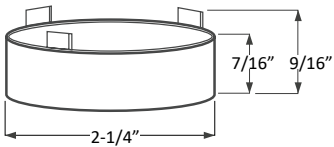

LED Holder (Head)

HOUSING DIMENSION

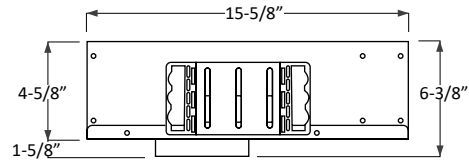
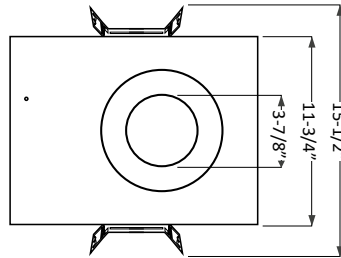

COLLAR DEPTH PER CEILING THICKNESS

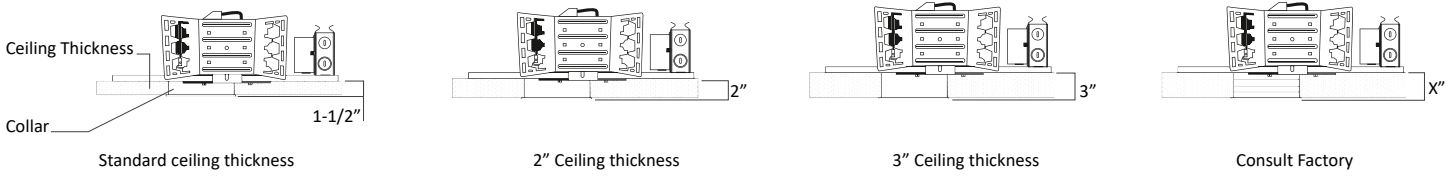

FRAME ACCESSORIES

