

PRIME 6" LED ARCHITECTURAL SQUARE LUMINAIRE



USE OF PRODUCT

PRIME Square Luminaire Series may be used in hospitality, commercial, retail, and residential applications. This product will reduce energy consumption, emits little heat, and reduces cooling loads for added costs savings. Approximately 75% in energy savings compared to incandescent light source

LED ENGINE

LED engine available with CREE LEDs in 2700K, 3000K, 3500K, or 4000K in standard 93+ CRI. 2 Step MacAdam ellipse allows for color consistency between fixtures. LED mounted to aluminum heat sink for maximum life output and thermal management.

LED DRIVER

Durable dimmable driver provides high power factor with optimum thermal management to prevent damage caused by high temperature.

OPTICS

Field replaceable optical lens available in 18°, 30°, 50°, and 80°. Easily achieve narrow spot to wide flood beam pattern. Option for frosted, honeycomb, or solite filter (2 Maximum).

HOUSING

Rugged aluminum housing.

MOUNTING

The PRIME Cylinder Series may be cable hung, stem mount, surface mount or wall mounted.

DIMMING

Available in 10 driver selections. (ID) Standard all-inclusive ELV, Triac, and 0-10V dimming driver called Intelligent Drive, 120-277V. (PEQ0) Lutron Hi-Lume Premier Ecosystem 0.1% w/soft on, fade to black dimming, 120-277V. (PEQ1) Lutron Hi-Lume Premier Ecosystem 1% w/soft on, fade to black

dimming, (LDE1) Lutron Hi-Lume 1% Ecosystem with soft on, fade to black dimming, 120-277V. (LTE) Lutron Hi-Lume 1% 2-wire, 120V. (L3DA) Hi-lume 1% EcoSystem/3-Wire L3D Driver (EEI) eldoLED Eco 1% Dim (0-10V), 120-277V. (EDIO) eldoLED Solo 0.1% Dim(0-10V), 120-277V. (EDID) eldoLED Solo 0.1% Dim(DALI), 120-277V.

LABELS / COMPLIANCE

- CSA Listed for US and Canada
- 5 year limited warranty.



ORDERING INFORMATION

RPA

Diameter Shape Length Directional Lumens Color Temp. Voltage Dimming Optical Lens Filter Bevel Finish Cylinder Finish Mounting Option

Series	Diameter	Shape	Length	Directional	Lumens	Color Temperature	Voltage	Dimming	Optical Lens ⁵	Filter	Bevel Finish	Cylinder Finish	Mounting	Option	
RPA PRIME Series	6 - 6"	SL - Square Luminaire	12 - 12"	DL - Down Light	10L - 1045 lm	27 - 2700K	UNV - 120-277	ID ¹	18 - 18° 30 - 30° 50 - 50° 80 - 80°	None - Leave blank F - Frosted Filter H - Honey comb S - Solite filter	W - White B - Black H - Haze S - Specular Clear W - Wheat MTO - Made to order	BL - Black WH - White SL - Silver MTO - Made to order	PH - Pendant SC - Single Cable DC - Double Cable TC - Triple Cable SM - Surface Mount WM - Wall Mount	ER - Remote Emergency Battery EI4W - Integral Emergency Battery	
				UP - Up Light	13L - 1345 lm	30 - 3000K		PEQ0							
					16L - 1645 lm	35 - 3500K		LDE1							
					21L - 2145 lm	40 - 4000K		LDES							
					25L - 2505 lm			LTE ²							
				L3DA											

- Intelligent Drive is the standard driver.
- 120V only.
- Must specify logarithmic or linear eldoLED driver.
- Confirm dimming curve: linear or logarithmic.
- Without standard frosted acrylic diffuser
- 18" standard length, consult factory for other.
- 5ft standard cable length.

LUMEN CHART

Wattage	Delivered Lumens	Voltage	CRI
11W	1045 lm	120 - 277V	93+
16W	1345 lm	120 - 277V	93+
20W	1645 lm	120 - 277V	93+
30W	2145 lm	120 - 277V	93+
31W	2505 lm	120 - 277V	93+

*Above chart, ordering information, and IES File name reflect delivered lumens based 3000K and 30° optical lens.
 **Lumens will vary based on CCT, optical lens, and bevel finish.

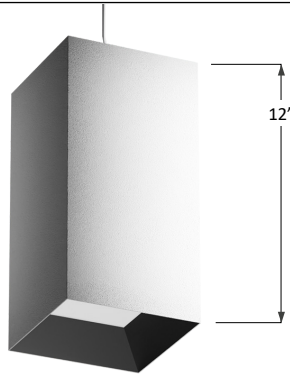

TRIM HEIGHT

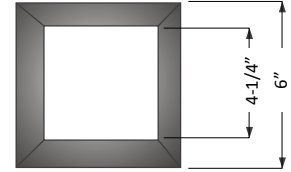
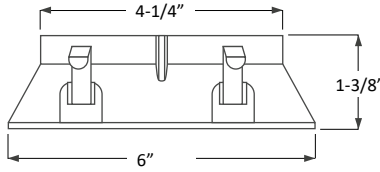
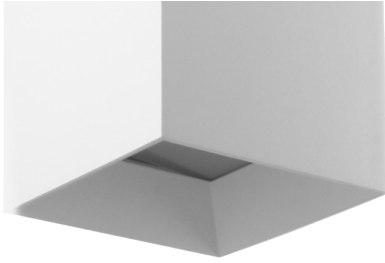

LED HOLDER & FILTER DIMENSION

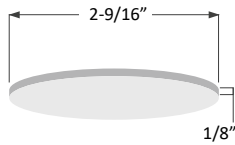

Filter

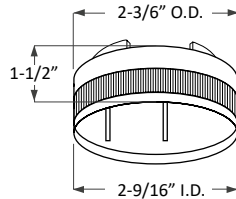

LED Holder

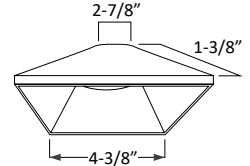
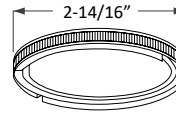

Light Enhancer

MOUNTING INFO

CABLE HUNG DIMENSION

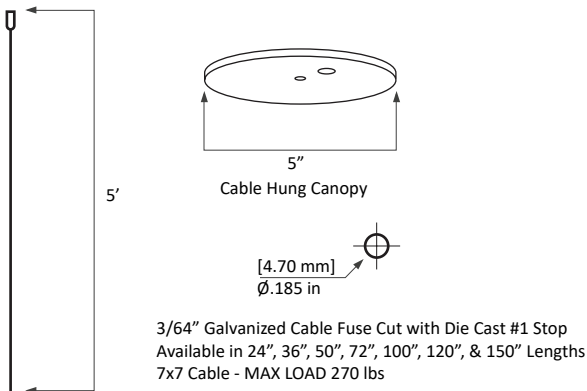

STEM MOUNT DIMENSION

