



WARM DIM

USE OF PRODUCT

The 6" Prime Adjustable Series Downlight is the ideal product for architectural energy efficient lighting in commercial and residential applications where adjustability is required. Available in die cast trims, with an assortment of optics and dimmable drivers. Color Temperature gradually transitions from 3000K to 1800K simulating natural sunsets.

LED ENGINE

LED engine available with Warm-Dim standard 90+ CRI. 2 Step MacAdam ellipse allows for color consistency between fixtures. LED mounted to aluminum heat sink for maximum life output and thermal management. Light engine provides a quick disconnect with locking strain relief to housing.

FRAME CONSTRUCTION

Constructed from 16 gauge heavy duty powder coated cold rolled steel frame with a large access junction box.

ADJUSTMENT

- Light engine allows for hot aiming from 0-35°.
- Housing provides for 360° locking rotation
- Aperture collar adjusts 15°± horizontally within frame for square ceiling alignment
- Collar notch allows for easy alignment for square applications.

- Aperture collar compatible up to 1½" ceiling thickness.
- Accommodation for 2" or 3" ceiling thickness available upon request.

OPTICS

Field replaceable optical lens available in 18°, 30°, 50°, and 80°. Easily achieve narrow spot to wide flood beam pattern. Option for frosted, honeycomb, or solite filter (2 maximum).

DIMMING

Available in 8 driver selections. (ID) Standard all-inclusive ELV, Triac, and 0-10V dimming driver called Intelligent Drive, 120-277V. (PEQ0) Lutron Hi-Lume Premier Ecosystem 0.1% w/soft on, fade to black dimming, 120-277V. (LDE1) Lutron Hi-Lume 1% Ecosystem with soft on, fade to black dimming, 120-277V. (LTE) Lutron Hi-Lume 1% 2-wire, 120V. (L3DA) Hi-lume 1% EcoSystem/3-Wire L3D Driver (EEI) eldoLED Eco 1% Dim (0-10V), 120-277V. (EDIO) eldoLED Solo 0.1% Dim(0-10V), 120-277V. (EDID) eldoLED Solo 0.1% Dim(DALI), 120-277V.

THERMAL MANAGEMENT

Ambient temperatures at fixture location should not exceed -20° to 40°C.

EMERGENCY BATTERY

Optional emergency battery available for a minimum of 90 minutes with both integral or remote test switch in 800 or 1700 delivered lumens.

TRIM OPTIONS

- All trims are self flanged die cast or anodized.
- Trim includes standard frosted acrylic diffuser.
- 12% lumens increase if remove standard frosted acrylic diffuser in field.
- Optical Enhancer reflects light evenly across the diffusion lens.
- Trims available in round or square in an assortment of standard or made to order finishes.

LABELS/COMPLIANCE/WARRANTY

- CSA Listed for US and Canada
- Dry/Damp/Wet location rated.

**ORDERING INFORMATION****RPA**

| Series | Aperture size | Lumens | Color Temperature | Voltage | Dimming | Optical Lens | Filter |
|--------------|---------------|---------------|-------------------|---------------|---------------------|---|----------|
| RPA | 6 - 6" | 9L - 975 lm | WD - Warm Dim | UNV - 120-277 | ID ¹ | Standard all-inclusive ELV, Triac, and 0-10V dimming driver (Intelligent Drive) | 18 - 18° |
| PRIME Series | | 11L - 1100 lm | | 120 - 20V | PEQ0 | Lutron Hi-Lume Premier Ecosystem 0.1% w/soft on, fade to black dimming | 30 - 30° |
| | | | | 347 - 347V | LDE1 | Lutron Hi-Lume 1% Ecosystem with soft on, fade to black dimming | 50 - 50° |
| | | | | | LTE ² | Lutron Hi-Lume 1% 2-wire | 80 - 80° |
| | | | | | L3DA | Hi-lume 1% EcoSystem/3-Wire L3D Driver | |
| | | | | | EEI ^{3,4} | eldoLED Eco 1% Dim (0-10V) | |
| | | | | | EDIO ^{3,4} | eldoLED Solo 0.1% Dim (0-10V) | |
| | | | | | EDID ^{3,4} | eldoLED Solo 0.1% Dim (DALI) | |

| Housing Type | Aperture | Frame Accessories | Collar | Options |
|---------------------------------|---|--------------------------|---------------------|--|
| NC - Non-IC New Construction | SLDP - Square Flangeless Adjustable Plaster | C - C-Channel bar hanger | Blank - 1.5" Depth | EI8 - Emergency battery with integral switch(800 Lumens) |
| IC - Air-tight New Construction | SLDM - Square Flangeless Adjustable Milwork | B - Flat bar hanger | 20 - 2" Depth | ER8 - Emergency battery with remote switch (800 Lumens) |
| | | | 30 - 3" Depth | EI17 - Emergency battery with integral switch(1700 Lumens) |
| | | | MTO - Made to order | ER17 - Emergency battery with remote switch (1700 Lumens) |
| | | | | FCJS-E - Vive wireless individual controller(Ecosystem) |
| | | | | FCJS-0 - Vive wireless individual controller(0-10) |
| | | | | CP10 - Chicago Plenum |

TRIM ORDERING INFORMATION

| Aperture Size / Shape / Trim Type / Style | Bevel Finish | Options |
|---|---------------------|-------------------|
| 6SLO - 6" Square Flangeless Open | W - White | WL - Wet Location |
| 6SLA - 6" Square Flangeless Accent | B - Black | |
| | H - Haze | |
| | S - Specular clear | |
| | WE - Wheat | |
| | MTO - Made to order | |

1. Intelligent Drive is the standard driver.
2. 120V only.
3. Must specify logarithmic or linear eldoLED driver.
4. Confirm dimming curve: linear or logarithmic.

LUMEN CHART

| Wattage | Delivered Lumens | Voltage | CRI |
|---------|------------------|------------|-----|
| 10W | 975 lm | 120 - 277V | 90+ |
| 12W | 1100 lm | 120 - 277V | 90+ |

TRIM DIMENSION

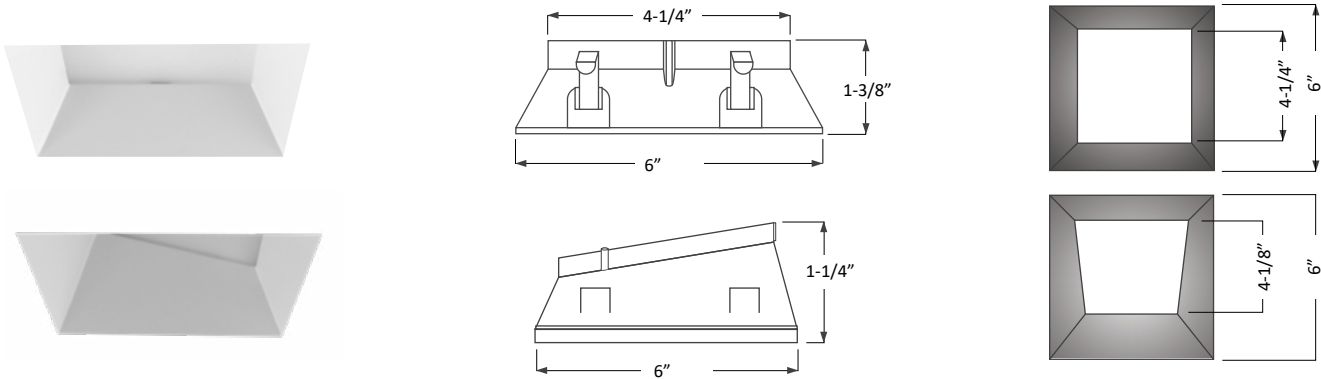

LED HOLDER & FILTER DIMENSION

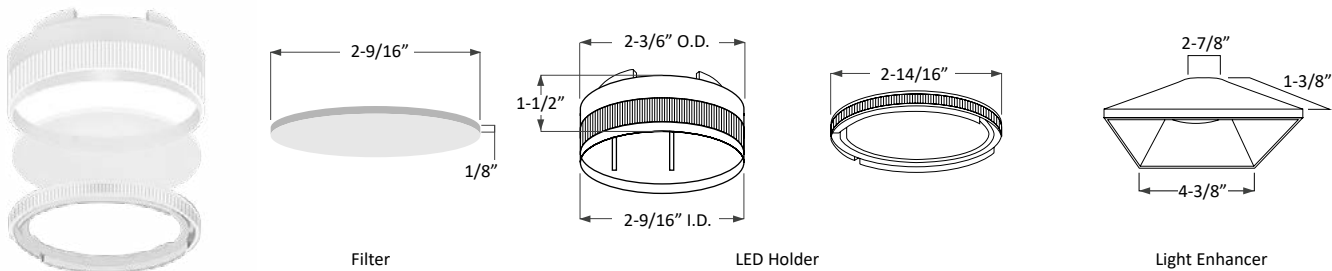

HOUSING DIMENSION

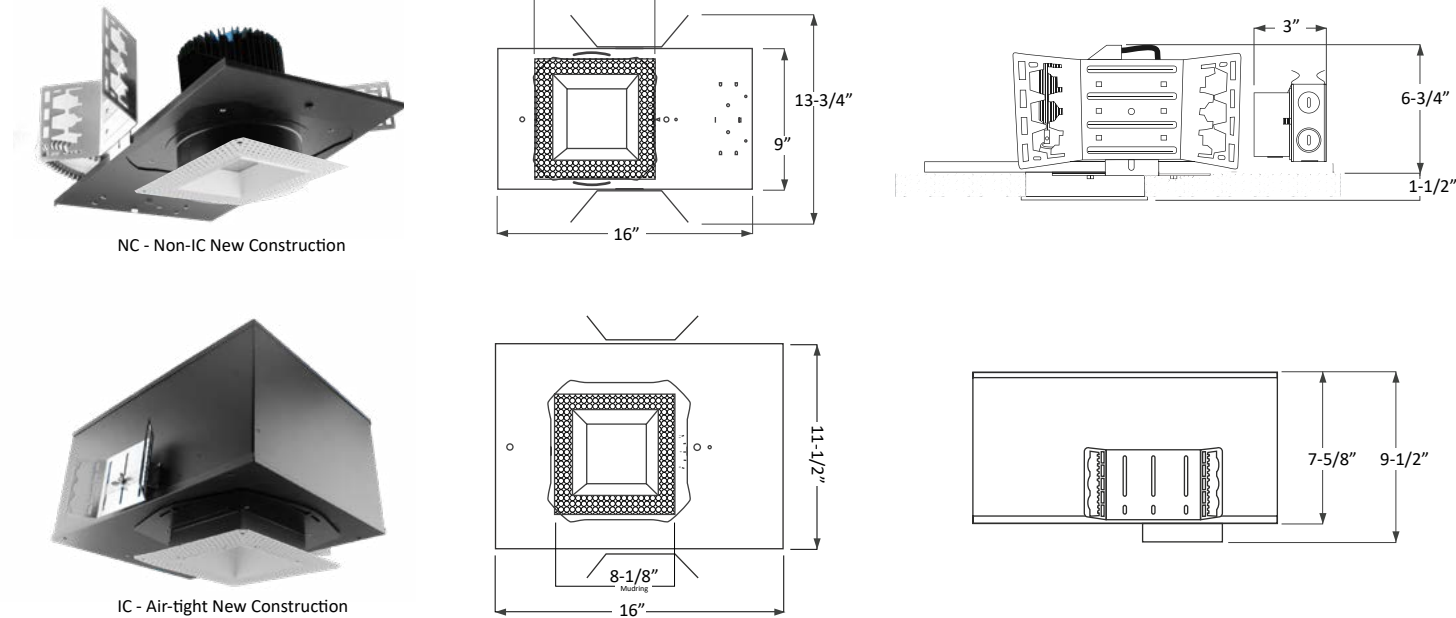

COLLAR DEPTH PER CEILING THICKNESS

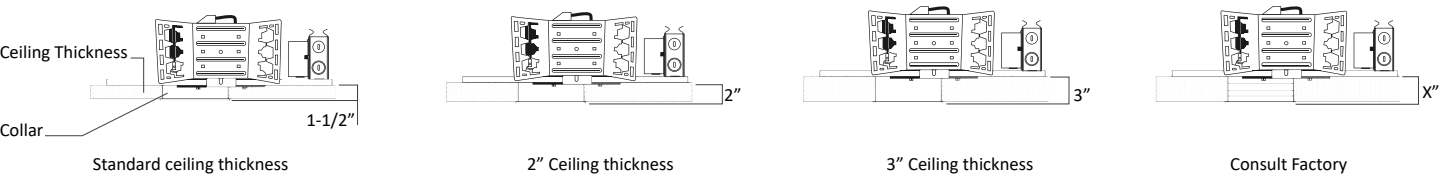

FRAME ACCESSORIES

