

# ELEVATE MULTIPLES

ARCHITECTURAL CABLE SUSPENDED

**integer**  
Lights

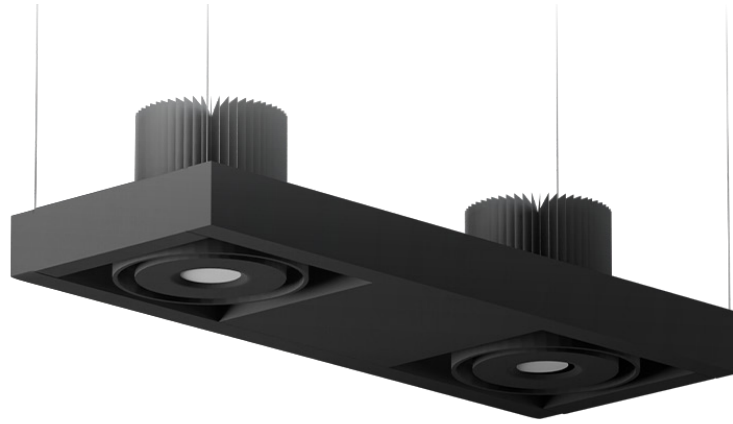

## LED ENGINE

LED engine available with CREE LEDs in 2700K, 3000K, 3500K, or 4000K in standard 93+ CRI. 2 Step MacAdam ellipse allows for color consistency between fixtures. LED mounted to aluminum heat sink for maximum life output and thermal management. Light engine provides a quick disconnect with locking strain relief to housing.

## FRAME CONSTRUCTION

Constructed from heavy duty aluminum with powder coat finish. Extruded Frame Dimensions: 1.50" x 1.50" x .125"

## ADJUSTMENT

Double gimbal adjustment with locking mechanism. 35° X 35°

## OPTICS

Field replaceable TIR optics available in 12°, 22°, 27°, 35°, and 45°. Easily achieve narrow spot to wide flood beam pattern. Option for frosted, honeycomb, or solite filter (2 maximum).

## DIMMING

Available in 8 driver selections. (ID) Standard all-inclusive ELV, Triac, and 0-10V dimming driver called Intelligent Drive, 120-277V. (PEQO) Lutron Hi-Lume Premier Ecosystem 0.1% w/soft on, fade to black dimming, 120-277V. (LDE1) Lutron Hi-Lume 1% Ecosystem with soft on, fade to black dimming, 120-277V. (LTE) Lutron Hi-Lume 1% 2-wire, 120V. (L3DA) Hi-lume 1% EcoSystem/3-Wire L3D Driver (EEI) eldoLED Eco 1% Dim (0-10V), 120-277V. (EDIO) eldoLED Solo 0.1% Dim(0-10V), 120-277V. (EDID) eldoLED Solo 0.1% Dim(DALI), 120-277V. All drivers are field replaceable.

## THERMAL MANAGEMENT

Ambient temperatures at fixture location should not exceed -20° to 40°C.

## MOUNTING

Suspended ceiling mount with aircraft cable.

## LABELS/COMPLIANCE/WARRANTY

- CSA Listed for US and Canada  
- 5 Year limited warranty



## ORDERING INFORMATION

**RPM** — Housing Size — Profile — Mounting types — Module Configuration — Lumens Per Head — Color Temperature — Voltage — Dimming — Optical Lens — Filter — Trim Type — Frame Finish

Series	Housing Size	Profile	Mounting Types	Module Configuration	Lumens Per Head	Color Temperature	Voltage
RPM	M - medium	150 - 1.50"	CS <sup>1</sup> - Cable suspended	2I - Two module, integral driver	8L - 890 lm 11L - 1175 lm 16L - 1650 lm	27 - 2700K 30 - 3000K 35 - 3500K 40 - 4000K	UNV - 120-277V 120 - 120V
Elevate Multiples Series							

Dimming	Optical Lens	Filter	Trim Type	Frame Finish	Note
<b>ID<sup>2</sup></b> Standard all-inclusive ELV, Triac, and 0-10V dimming driver (Intelligent Drive)	12 - 12° 22 - 22°	<b>None</b> - Leave blank <b>F</b> - Frosted filter	<b>B</b> - Bevel <b>R</b> - Regress <b>S</b> - Snoot	<b>B</b> - Black <b>MTO</b> - Made to Order	1. 5ft standard cable length. 2. Intelligent Drive is the standard driver. 3. 120V only. 4. Must specify logarithmic or linear eldoLED driver. 5. Confirm dimming curve: linear or logarithmic.
<b>PEQO</b> Lutron Hi-Lume Premier Ecosystem 0.1% w/soft on, fade to black dimming	27 - 27° 35 - 35°	<b>H</b> - Honey comb <b>S</b> - Solite filter			
<b>LDE1</b> Lutron Hi-Lume 1% Ecosystem with soft on, fade to black dimming	45 - 45°				
<b>LTE<sup>3</sup></b> Lutron Hi-Lume 1% 2-wire					
<b>L3DA</b> Hi-lume 1% EcoSystem/3-Wire L3D Driver					
<b>EEI<sup>4,5</sup></b> eldoLED Eco 1% Dim (0-10V)					
<b>EDIO<sup>4,5</sup></b> eldoLED Solo 0.1% Dim (0-10V)					
<b>EDID<sup>4,5</sup></b> eldoLED Solo 0.1% Dim (DALI)					

## LUMEN CHART

Wattage	Delivered Lumens	Voltage	CRI
10W	890 lm	120 - 277V	93+
14W	1175 lm	120 - 277V	93+
20W	1650 lm	120 - 277V	93+

\*Above chart, ordering information, and IES File name reflect delivered lumens based 3000K and 30° optical lens.  
 \*\*Lumens will vary based on CCT, optical lens, and bevel finish.

## DIMENSION

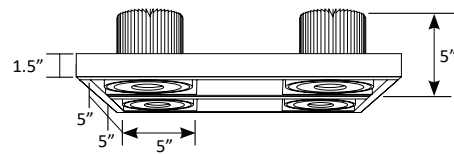
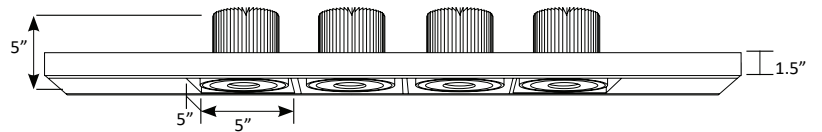
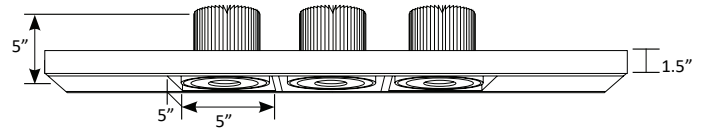
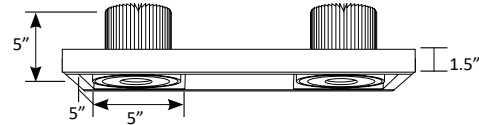
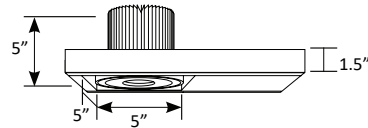
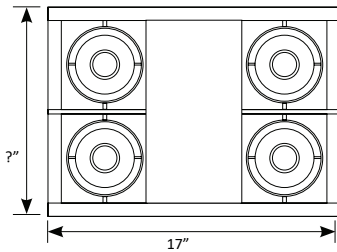
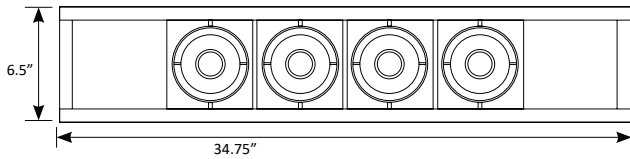
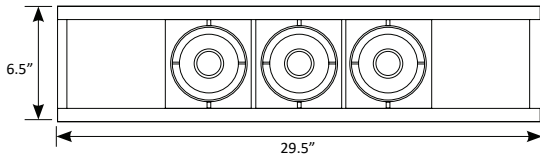
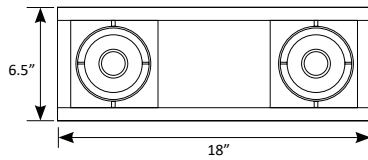
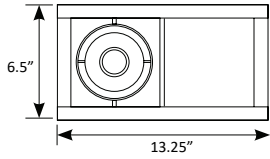

## OPTICAL



12°, 22°, 27°, 35°, 45°

## FILTERS

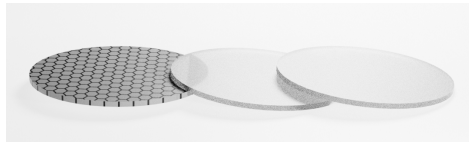

H - Honey comb F - Frosted filter S - Solite filter

## TRIM TYPE

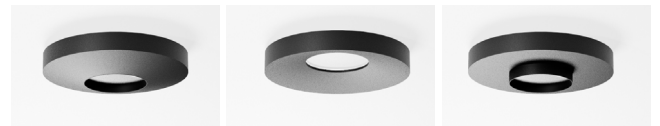

B - Bevel R - Regress S - Snoot