

RFL4A SERIES

4" LED Adjustable Recessed Module

PROJECT: _____

MODEL #: _____

LOCATION: _____

CONTACT: _____

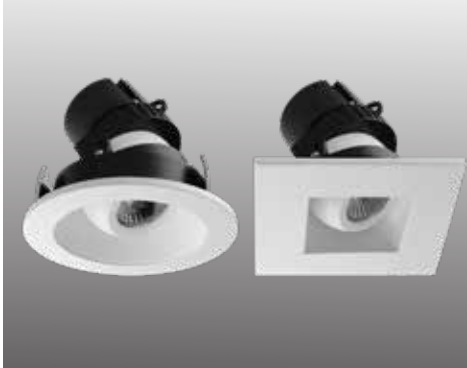

DIMENSIONS

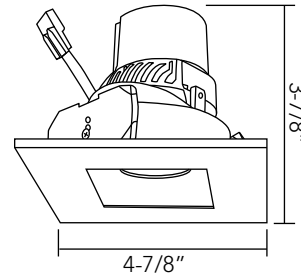
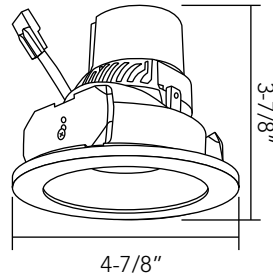

USE OF PRODUCT

The Versatrim RFL4A Series is the ideal product for energy efficient lighting in existing retrofit, remodel, or new construction housings. This product may be used in hospitality, health care, commercial, retail, and residential applications where lights need to be controlled such as to focus on artwork, displays, objects, etc. The Versatrim Adjustable will reduce energy consumption, emits little heat, and reduces cooling loads for added costs savings. Approximately 75% in energy savings compared to incandescent light source.

VERSATRIM FEATURES



- Watts: 11W
- Lumens: 900 Lumens
- Voltage: (120V standard); 120-277V (with optional 0-10V dimming driver)
- Color Temperature: 2700K, 3000K, 3500K, or 4000K
- Beam Angle: 18°, 38°, 60°
- Color Rendering Index: 93+ CRI Typical
- R9 Value: 85
- LED Life: 50,000 hours

- LED Type: Cree LED for maximum light output
- Versatility: Interchangeable trim in round and square
- EM Battery: 90 min
- Warranty: 5 Year Limited Warranty

LED DRIVER

Durable 120V dimmable driver provides high power factor with the optimum thermal management to prevent damage caused by high temperature. Driver protections include: output open load, over-current and short circuit, and over temperature with auto recovery.

DIMMING

Available in 8 driver selections. Standard Triac/ELV, 120V. (019) 0-10V dimming in 900 lumens, 120-277V. (PEQ0) Lutron Hi-Lume Premier Ecosystem 0.1% w/soft on, fade to black dimming, 120-277V. (LDE1) Lutron Hi-Lume 1% Ecosystem with soft on, fade to black dimming, 120-277V. (LTE) Hi-Lume 1% 2-wire, 120V. (L3DA) Hi-Lume 1% EcoSystem/3-Wire L3D Driver (EEI) eldoLED Eco 1% Dim (0-10V), 120-277V. (EDIO) eldoLED Solo 0.1% Dim(0-10V), 120-277V. (EDID) eldoLED Solo 0.1% Dim(DALI), 120-277V.

FILTER ACCESSORIES

A multitude of filter accessories are available to achieve a particular light effect. Available in frosted, honeycomb, or solite filter options.

EMERGENCY BATTERY

Optional emergency battery with up to 90 minute illumination time.

MOUNTING

Torsion clips supplied for convenient mounting to existing, remodel, or new construction housing.

LABELS/COMPLIANCE

- CSA Classified for damp location
- JAB certified

ORDERING INFO

RFL4A	9L						
-------	----	--	--	--	--	--	--

Series	Lumens	Color Temp.	Lens Holder Finish	Beam Angle	Reflector	Trim	Dimming
Versatrim Adjustable	9L - 900 Lumens	27 - 2700K	HW - White	18 - 18°	4ARLW - White	ROUND 4TLW - White 4TLC - Copper 4TLB - Black 4TLH - Haze 4TLSN - Satin Nickel 4TLBZ - Bronze 4TLCX - Custom	Leave blank ² - Triac/ELV 019 ³ - 0-10V Dimming LDE1 ³ - Lutron Hi-Lume 1% Ecosystem with soft on, fade to black dimming PEQ0 ³ - Lutron Hi-Lume Premier Ecosystem 0.1% w/soft on, fade to black dimming LTE ²³ - Hi-Lume 1% 2-wire L3DA - Hi-Lume 1% EcoSystem/3-Wire L3D Driver EEI ^{3,4} - eldoLED Eco 1% Dim (0-10V) EDIO ^{3,4} - eldoLED Solo 0.1% Dim (0-10V) EDID ^{3,4} - eldoLED Solo 0.1% Dim (DALI)
		30 - 3000K	HB - Black	38 ¹ - 38°	4ARLB - Black		
		35 - 3500K	HS - Silver	60 - 60°	4ARLCH - Chrome 4ARLH - Haze 4ARLBZ - Bronze 4ARLSN - Satin Nickel 4ARLCX - Custom		
		40 - 4000K					
						SQUARE 4STLW - White 4STLB - Black 4STLH - Haze 4STLSN - Satin Nickel 4STLBZ - Bronze 4STLCX - Custom	

1. Standard beam angle.
 2. 120V only.
 3. Requires dedicated Rayon housing.
 4. Must specify logarithmic or linear eldoLED diver.

Options

- SBA - Screw base adapter
- EM³ - Emergency back-up
- SDT³ - Step down transformer
- H - Honeycomb filter
- F - Frosted filter
- S - Solite filter

NEW CONSTRUCTION/REMODEL DIMENSIONS

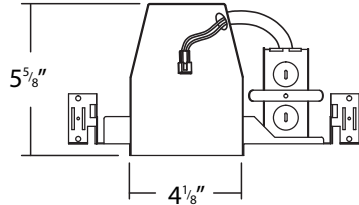
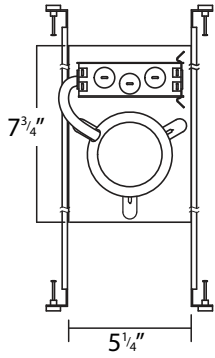

RHL4-ICAT
New Construction LED Housing

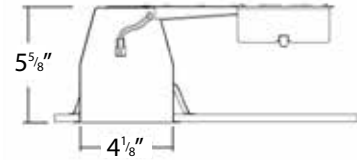
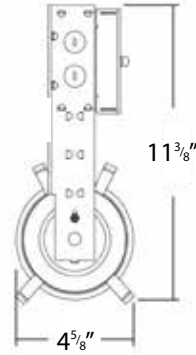

RHL4R-ICAT
Remodel LED Housing

RFL4A Module

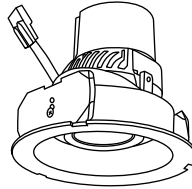

REFLECTOR/TRIM DIMENSIONS

REFLECTOR

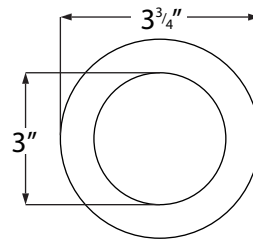

Round Trim

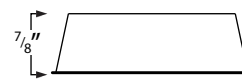

Square Trim

TRIM

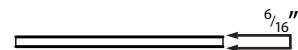
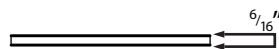
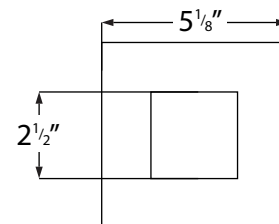
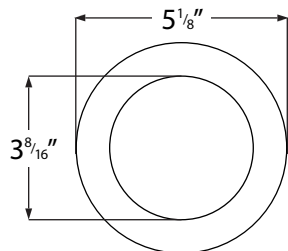



RHL4-ICAT

4" IC Air-tight
New Construction LED Housing

PROJECT: _____

MODEL #: _____

LOCATION: _____

CONTACT: _____

4" IC Air-Tight New Construction LED Housing

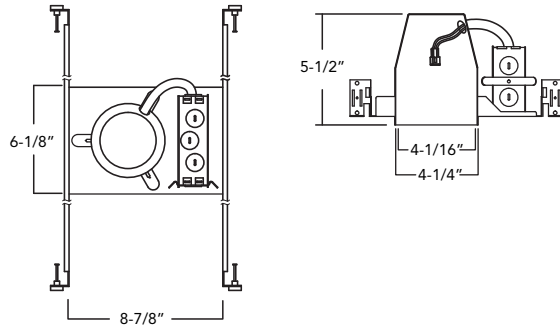
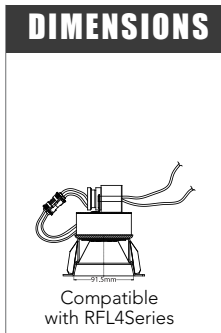

USE OF PRODUCT

The RHL4-ICAT is the ideal product for general purpose recessed LED housing for residential, commercial, hospitality, health care, restaurant and retail applications. This product is compatible with the Versatrim RFL4 Series in round or square in various baffle, reflector, and trim ring color selections to achieve a particular look.

CONSTRUCTION

- Minimum Clearance Rated for IC/ Non - IC application. "IC" or insulated ceiling housings are rated for direct contact with insulation. No minimum clearance is required.
- Ceiling Thickness Up to 1 1/4".
- Bar Hangers Bar Hangers are adjustable from 13-5/8 to 25" and can be repositioned to 90° on plaster frame. Pre-installed "real nail" easily installs in regular lumber, engineered lumber
- Junction Box Junction box is listed for through branch circuit wiring and contains seven 7/8" knockouts and four ROMEX pryouts with Romex cable clamp. Ground wire provided on J-Box.
- New Construction Frame Galvanized steel construction.
- Connection Quick connect provided for easy connection to VersaTrim RFL4 Series LED module to meet non-screw base socket requirements per California Title 24.

EMERGENCY

Optional emergency back-up may be ordered separately. Unit operates for 90 minutes with LED modules up to 20 Watts and is Damp location rated , 120/277AC operational.

MODULE COMPATIBILITY

RHL4-ICAT is compatible with the Versatrim RFL4 Series in round or square in various baffle, reflector, and trim ring color selections to achieve appearance of choice.

LABELS/COMPLIANCE

cUL listed for Wet location
Certified under ASTM-283 for Air-Tight Construction
Title 24 Compliant

ORDERING INFO

RHL4-ICAT	
Series	Options
RHL4-ICAT - 4" IC Air-Tight New Construction LED Housing	EM - Emergency battery 019 - 0-10V (900 Lumens) 277SDT - 277V Step down transformer 347SDT - 347V Step down transformer

www.rayonlighting.com
info@rayonlighting.com

tel: 323.446.2626
fax:323.446.2606

Specification and product availability
subject to change without notice

RHL4R-ICAT

4" IC Air-tight Remodel LED Housing

PROJECT: _____

MODEL #: _____

LOCATION: _____

CONTACT: _____

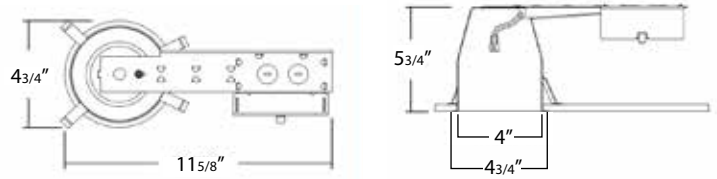
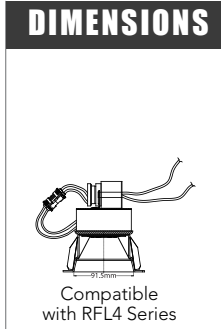

USE OF PRODUCT

The RHL4R-ICAT is the ideal product for general purpose recessed LED housing for residential, commercial, hospitality, health care, restaurant and retail applications. This product is compatible with the Versatrim RFL4 Series in round or square in various baffle, reflector, and trim ring color selections to achieve a particular look.

CONSTRUCTION

- Minimum Clearance "IC" or insulated ceiling housings are rated for direct contact with insulation. No minimum clearance is required.
- CEILING THICKNESS Up to 1 1/4".
- BAR HANGERS Bar Hangers are adjustable from 13-5/8" to 25" and can be repositioned to 90° on plaster frame. Pre-installed "real nail" easily installs in wood or composite joists.
- JUNCTION BOX Junction box is listed for through branch circuit wiring and contains seven 7/8 knockouts and four ROMEX pryouts with Romex cable clamp. Ground wire provided on J-Box.
- REMODEL FRAME Galvanized steel construction
- CONNECTION Quick connect provided for easy connection to Versatrim RFL4 Series LED module to meet non-screw base socket requirements per California Title 24.

EMERGENCY

Optional emergency back-up may be ordered separately. Unit operates for 90 minutes with LED modules up to 20 Watts and is Damp location rated, 120/277AC operational.

MODULE COMPATIBILITY

RHL4R-ICAT is compatible with the Versatrim RFL4 Series in round or square in various baffle, reflector, and trim ring color selections to achieve appearance of choice.

LABELS/COMPLIANCE

cUL listed for Wet location
 Certified under ASTM-283 for Air-Tight Construction
 Title 24 Compliant

4" IC Air-Tight Remodel LED Housing

ORDERING INFO

RHL4R-ICAT

Series

Options

RHL4R-ICAT - 4" IC Air-Tight Remodel LED Housing

- EM** - Emergency battery
- 019** - 0-10V (900 Lumens)
- 277SDT** - 277V Step down transformer
- 347SDT** - 347V Step down transformer

www.rayonlighting.com
 info@rayonlighting.com

tel: 323.446.2626
 fax: 323.446.2606

Specification and product availability
 subject to change without notice