

TPR WESTFLEX® 4-IN-1 RGBW TAPE LIGHT

IP67

Description:

The **TPR Westflex® 4-in-1 RGBW** is a solid state tape light for Architectural and Entertainment markets. It is flexible, cuts to length every 2" and uses a high brightness 5050 LED for maximum performance. It is available in indoor or outdoor (IP67) jackets, and is fully controllable via DMX512 when used in conjunction with the WestPower® 300-4 data box. The White quadrant of the LED chip is available in 3200K and 4200K.

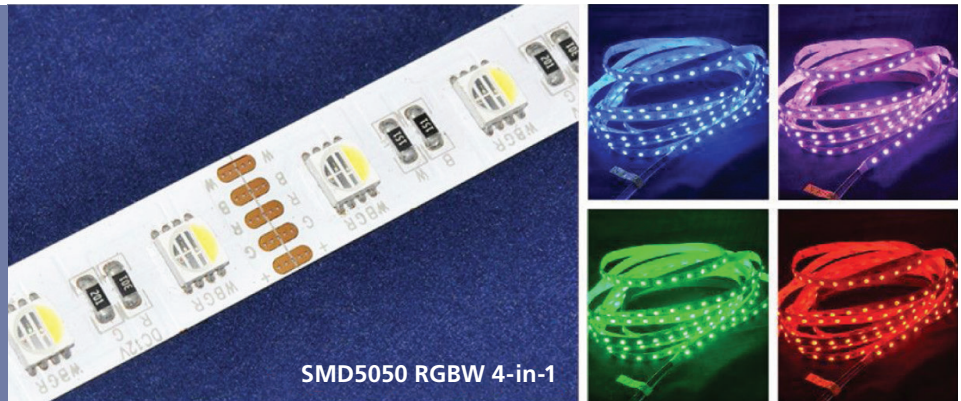

SMD5050 RGBW 4-in-1

Westflex FL-SMD-WP-MC-IP
Mounting Clip

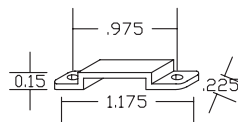

Westflex FL-SMD MT
Mounting Track

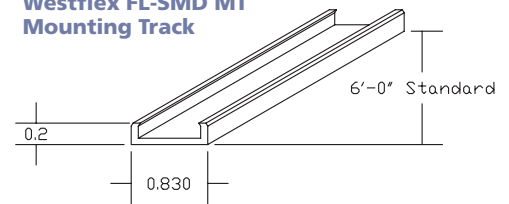

Specifications:

Lumens:	360lm/ft	Max Run:	10' on Single Power Feed.
Power:	4.4W/ft	Lamp Life:	50,000hrs @70% lumen maintenance
Operating Voltage:	12VDC	Max Lead:	35' with AWG18
Operating Temp:	-4F to 104F (-20C to 40C)	Viewing Angle:	120 Degrees
Dimensions:	0.5"W x 0.2"H	Cut Length:	2"

Ordering Logic:

MODEL	FIXTURE LENGTH (in Feet)		CCT (White)	TAIL LENGTH (In Feet)		RATING
TPR-FL-SMD-RGBW4	-	Ex: 3'	3200K 4200K	-	Ex: 5'	NP (No Jacket) IP (Indoor Jacket) WP (IP67)