

TPR WESTFLEX® SMD



Specifications:*

- 2 watts/linear foot
- 16' Maximum run length **
- Cutable increments 2" (3 LEDs)
- Approx 70% light output at 25,000 hrs
- 50,000+ hrs expected life
- Dimmable
- Voltage: 12V DC
- LED spacing: 18 LEDs per foot
- Viewing angle: 120 degree
- Turning radius: 1" along the vertical plane
- Available for Indoor/Outdoor (IP67)
- 12mm PCB

Product Information:

Color Options	Approximate output for 18" section
CW (Cool White) 4000K	148 lm/ft
WW (Warm White) 3000K	140 lm/ft
Dimensions	0.225"h x 0.625"w w/Clip & Connector
LED Type	Single Color/Surface Mounted Diode
Mounting	MS – 3M Self Adhesive (Usable with NP version only) MC – Adhesive Mounting Clip MCIP – Screw Mounting Clip MT(B) – Aluminum Track Silver (or Black)
Shortest Segment	2" (3 LEDs)
Max Lead Length	35' with #20AWG
Shipping Lengths	20'-0" roll and field cut to length in 2" increments Pre-cut to length by factory also available
Connection Methods	T0 – Field Soldered Tail (Standard) TC – 19" Clip-on lead T1 – 12" Factory installed lead (Standard) T__ – Factory installed lead cut to custom length
Listing & Standard	ETL Class 2 – UL 2108 (LV Lighting) IP67 on WP version
Warranty	Contact Factory for Warranty and Terms of Sale

*Specifications subject to change without notice.

**Note: For optimum uniformity, refer to factory for recommended run lengths.

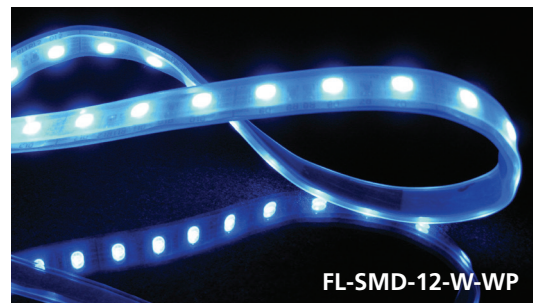

Westflex FL-SMD-WP-MC-IP Mounting Clip

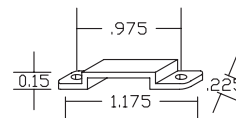

Westflex FL-SMD MT Mounting Track

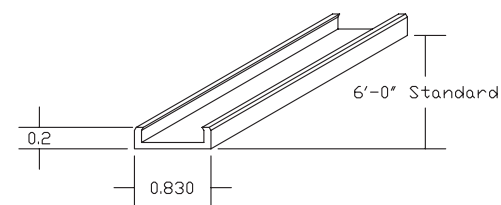

Ordering Logic:

TYPE	COLOR	RATING	MOUNTING	LENGTH	LEAD
TPR-FL-SMD	WW	WP	MT	10'	T1
TPR-FL-SMD	CW (Cool White) WW (Warm White)	IP - Indoor Protected NP - No Protection added	MC - Adhesive Mounting Clip MS - Self Adhesive (NP only)	Cut to lengths in 2" increments	TC - 19.5" clip-on lead T0 - Field soldered tail (Standard)