



OUR MOST VERSATILE LUMINAIRE

We have extended the reach of our alumLEDs series, by proudly introducing our new mud-in recessed system, ALS50T-MI. Our new luminaire adds a touch of elegance to a contemporary space, while integrating together with the architecture creating an invitine atmosphere.

- CRI > 90
- DIMMING
Forward / Reverse Phase
0-10V
Lutron
DMX
DALI
- GRAZER OR DIRECT VIEW LIGHTING
15°, 30°, 45°, 60°, 120° or Asymmetric Optics
- NO PIXELATION
"Line of Light"



CALIFORNIA ACCENT LIGHTING INC

Lighting for the Professional Designer

ALS50T-MI PRODUCT FEATURES

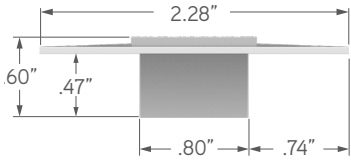

Clear Lens (CL)
Semi-Frosted Lens (SF)
Frosted Lens (F)

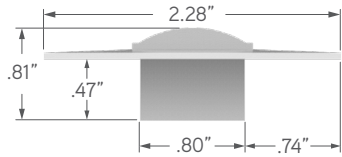

Asymmetric Lens (ASM)
Optic Lens (15D, 30D, 45D, 60D)

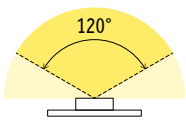

120° x 120° Beam
Clear Lens (CL)
Semi-Frosted Lens (SF)
Frosted Lens (F)

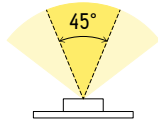

45° x 60° Beam
Asymmetric Lens (ASM)

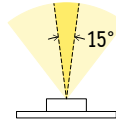

15° x 60° Beam
Optic Lens (15D)

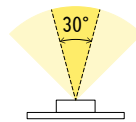

30° x 60° Beam
Optic Lens (30D)

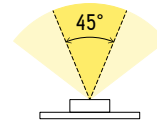

45° x 60° Beam
Optic Lens (45D)

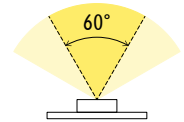

60° x 60° Beam
Optic Lens (60D)

Architects and lighting designers can now integrate the ALS50T-MI into their design to become one with the architecture, and together, the space and lighting system, will create a distinguished look with an inviting atmosphere.

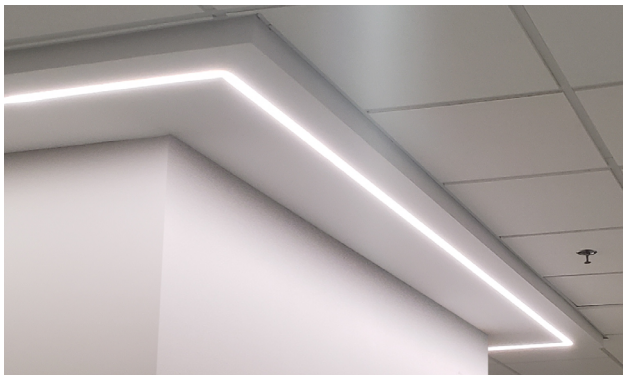

FEATURES

APPLICATIONS	Grazer or Direct View Lighting
LAMP TYPE	LEDs (No Mercury)
CRI	> 90
LENS	Clear, 50% Semi-Frosted, or 100% Frosted
OPTICS AND ASYMMETRIC	15°, 30°, 45°, 60°, 120°, or Asymmetric Optics
LENGTH	Built to Order
CONSTRUCTION	Aluminum Extrusion
WEIGHT	0.37 lbs per foot
MOUNTING	Mud-In
LISTING	Dry or Damp Location UL1598, CSA C22.2#250.0 UL8750, CSA250 UL2108, CSA C22.2 #9
ELECTRICAL	
DIMMING	Forward / Reverse Phase, 0-10V, Lutron, DMX, DALI
MAXIMUM RUN (Class 2 Applications)	36' (1.5W, 2W), 28' (3W), 21' (4W), 17' (5W), 14' (6W), 10' (8W), 7' (12W)
PRIMARY VOLTAGE	120V or 277V(UNV) or 120V (Lutron LTEA Only)
SECONDARY VOLTAGE	24VDC
DRIVER	Remote
TEMPERATURE RATINGS	Operating / Startup: -20° to 48°C (-4° to 120°F) Storage: -40° to 76°C (-40° to 170°F)

PERFORMANCE

Polar Graph

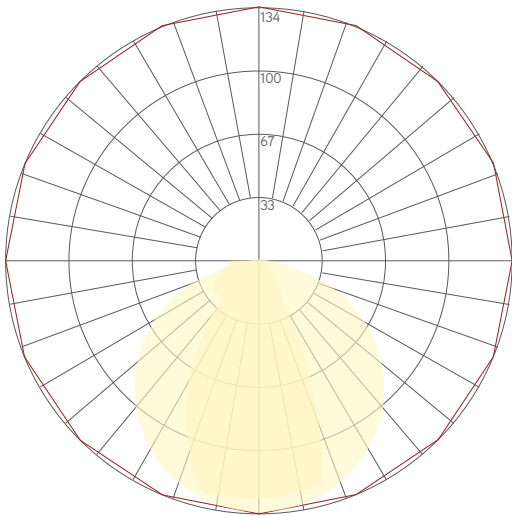

Chromaticity Diagram

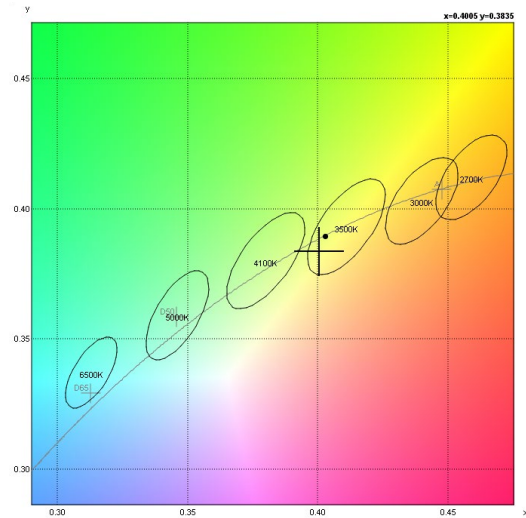

LAMP SPECIFICATIONS

LAMP NUMBER	CORRELATED COLOR TEMPERATURE	EFFICACY (LUMENS / WATT)	JA8	L70 LED LIFE
2.4K	2400K Incandescent White	85	Yes	60,000 hrs.
2.7K	2700K Warm White	85	Yes	60,000 hrs.
3.0K	3000K Warm White	90	Yes	60,000 hrs.
3.5K	3500K Neutral White	90	Yes	60,000 hrs.
4.0K	4000K Neutral White	90	No	60,000 hrs.
4.5K	4500K Neutral White	90	No	60,000 hrs.
5.0K	5000K Cool White	95	No	60,000 hrs.
5.7K	5700K Cool White	95	No	60,000 hrs.
R	Red (621nm)	N/A	No	40,000 hrs.
G	Green (525nm)	N/A	No	40,000 hrs.
B	Blue (470nm)	N/A	No	40,000 hrs.

Consult factory for cooler white color temperatures.

CUSTOM LENSES

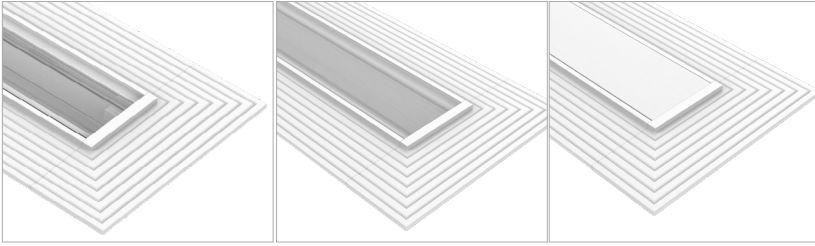

Clear Lens
Visible Diode Image
(CL)



50% Semi-Frosted Lens
Slight Diode Image
(SF)



100% Frosted Lens
No Diode Image (Line of Light)
(F)

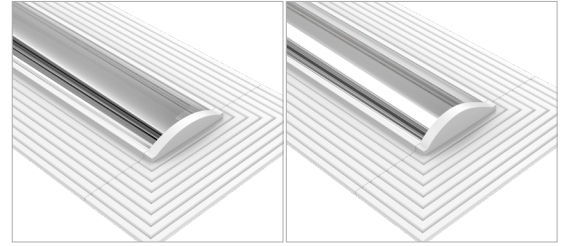

Optic Lens
Slight Diode Image
(15D, 30D, 45D, 60D)



Asymmetric Lens
Slight Diode Image
(ASM)

ACCESSORIES

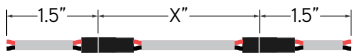

Continuous Connector
(18/2 Gauge Plenum Rated Wire)
ALS50T-MI-CC-PLM (6" Standard)
ALS50T-MI-CC-PLM-X (X = Specify Length)

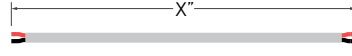

Power Connector
(18/2 Gauge Plenum Rated Wire)
ALS50T-MI-PC-PLM (10" Standard)
ALS50T-MI-PC-PLM-X (X = Specify Length)

Note: Connector type subject to change without notice

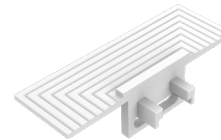

Standard End Cap
(ALS50T-MI-EC)

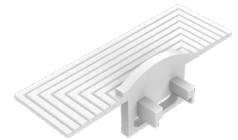

Optic & Asymmetric End Cap
(ALS50T-MI-XD-EC)

FACTORY-BUILT MITER CORNERS (Sold Separately)

Note: Mitered Corners are used to avoid field cutting. Consult factory for other mitered angle options.

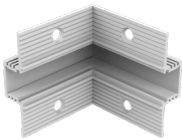

90° Internal Corner
(ALS50T-MI-90D-IN)

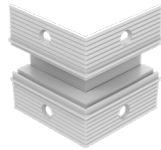

90° External Corner
(ALS50T-MI-90D-EX)

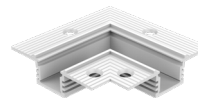

90° Linear Corner
(ALS50T-MI-90D)

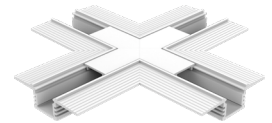

90° X-Corner
(ALS50T-MI-90D-XC)

SERIES	LENS / OPTICS*1	FINISH	CCT LED	WATTS PER FOOT	DIMMING	LISTING	LUMINAIRE VOLTAGE	FIXTURE LENGTH
ALS50T-MI	Clear Lens (CL)	White (WH)	2400K (2.4K)	1.5 Watts (1.5W)	0-10V: 100% - 1% (10V)	Indoor (DRY)	120V - 277V (UNV)	Specify Length in Feet & Inches Example: 7'8"
	50% Semi-Frosted Lens (SF)	Consult Factory for Other Finish Options	2700K (2.7K)	2 Watts (2W)	Phase Dimming: Forward Phase / Reverse Phase (PH)			
	100% Frosted Lens: Line of Light (F)		3000K (3.0K)	3 Watts (3W)		Outdoor (DAMP)	120V (LTEA Only) (120V)	
			3500K (3.5K)	4 Watts (4W)				
	Asymmetric Lens (ASM)		4000K (4.0K)	5 Watts (5W)				
			4500K (4.5K)	6 Watts (6W)				
	15° (15D)		5000K (5.0K)	8 Watts (8W)				
	30° (30D)		5700K (5.7K)	12 Watts (12W)				
	45° (45D)		Red (R)					
	60° (60D)		Green (G)					
		Blue (B)						

Note: Remote drivers sized based on wattage per length. Example: 10 feet x 8 watts = 80 watts. Driver will be sized based on 80 watts

*1 Flexible Lens only available in Clear (CL), Semi-Frosted (SF), and Frosted (F). Lens ships in rolls up to 100'. Other lenses ship in 8' sections

*2 Only available in High Output (HO) LEDs

*3 Only available in Mid Output (MO) or Standard Output (SO) LEDs

*4 (LTEA) 40 watt max Hi-Lume 1% LTEA2W #LTEA4U1UKL-CV240

*5 (L3DA) 40 watt max Hi-Lume 1% L3DA3W #L3DA4U1UKL-CV240

*6 (L3D0) 96 watt max Hi-Lume Premier 0.1% #L3D0-96W24V-U

*7 Default DMX address is 001. Consult third party DMX commissioner to modify. Minimum fixture length: 2'

*8 DALI commissioning to be performed by a third party at time of installation. CALI does not provide DALI commissioning

DESIGN GUIDELINE

Individual Fixture (Dry or Damp Location)

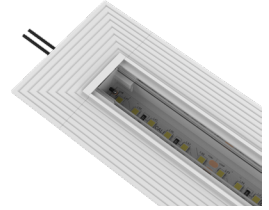
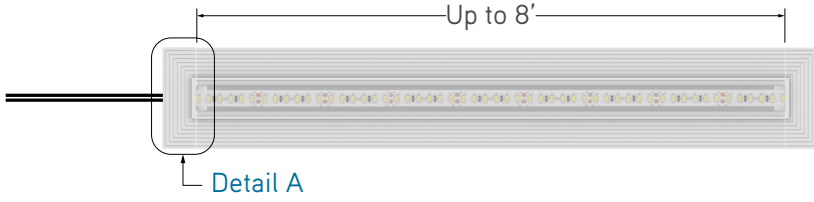

Detail A
End Cap
(ALS50T-MI-EC)

135° Miter (Dry or Damp Location)

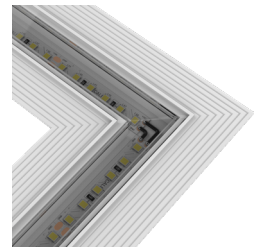
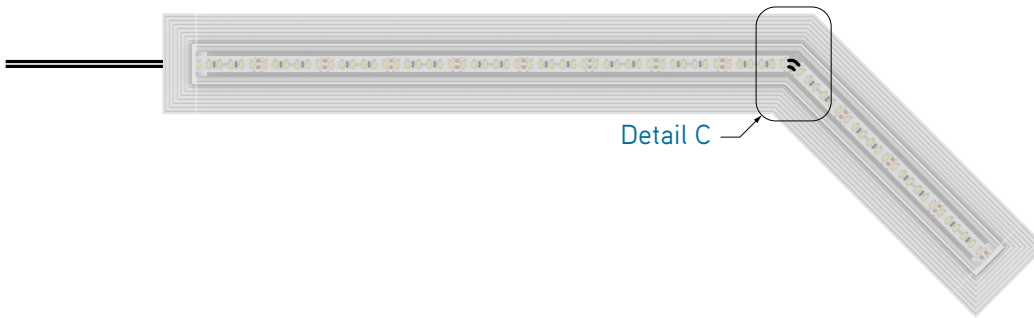

Detail B
90° Miter

Rectangular Run - 90° Miter (Dry or Damp Location)

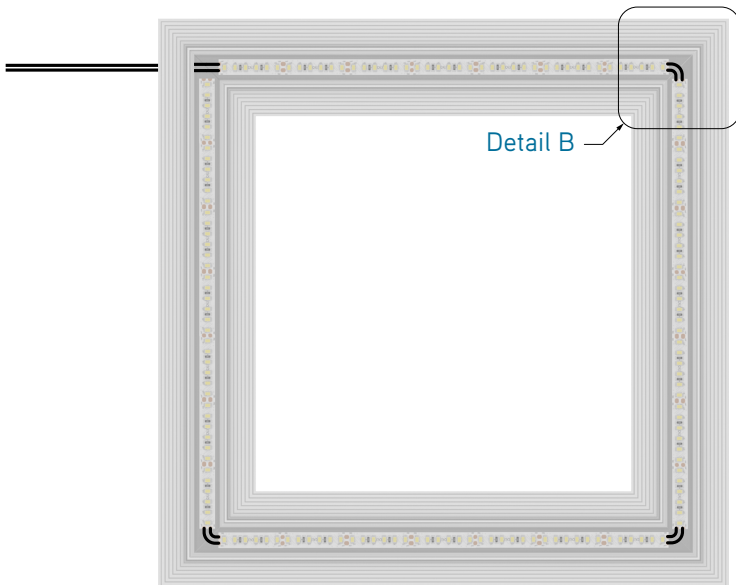

Detail C
135° Miter



CALI

CALIFORNIA ACCENT LIGHTING, INC.

2820 E. Gretta Lane, Anaheim, CA 92806

ph. 800.921.CALI (2254) | fx. 714.535.7902 | info@calilighting.com | calilighting.com

© CALI. All rights reserved. CALI reserves the right to make changes or withdraw specifications without prior notice.



7.03.2020