

PROJECT NAME:	APPROVED BY:
CATALOG NO:	TYPE NO:

SOVEREIGNII - Versatile LED Exit Signs

Chicago Approved Architectural Edgelit

All New SOCII

Same high quality and performance as the original Sovereign and now with added versatility and enhanced features such as "SU" Surface Universal mounting eliminating the need to specify surface mounting. New design "snap-fit" lens can easily be changed in the field from single to double face. Recessed backbox features adjustment screws to allow for ceiling depths of up to 1-3/4". Recessed backbox hanger bars require no assembly for ease of installation. All new Square Architectural pendant with finishes to match the body of the exit sign. Seismically designed Architectural pendant capable of swiveling 360° at a 45° angle

The Sovereign has been designed with the latest high efficiency LED light sources to provide vivid pronouncement of its exit legend with exceptional uniformity and luminance levels. Unique City of Chicago approved field installable directional arrows or can be factory installed. Engineered for reliability and ease of installation, Sovereign comes in many cost-effective configurations offering superlative quality, performance, and aesthetics.

- Field applied directional arrows reduce inventory to just single and double face signs
- Three hour run time is standard
- Both legend characters and background are illuminated
- Excellent uniformity: legend 1.4:1, avg. 6cd/m², Background 2.5:1, avg. 31 mcd/m²
- Last to assemble snap in lens
- <3 watt power consumption

Construction

- Plenum rated back-box can be pre-shipped for early installation
- Contoured crystal clear laser formed edgelit lens
- Lens Panel is "Last-to-Assemble" snap-in for versatility and ease of installation
- Field applied directional arrow kit includes locating template, arrow adheres to lens to prevent removal
- Field applied directional arrows reduce inventory to just single or double face
- Improved low profile mounting canopy for surface ceiling, surface wall and surface end mounting
- Available with SU Surface Universal mount option for field configurable surface mounting
- Precision pressure die cast aluminum legend holder, trim and surface mount canopy
- Quality brushed aluminum sealed finish is standard, White, Black, Brushed, Painted Brass, Bronze finishes available, consult factory for custom finishes
- Hinged retaining springs eliminate exposed mounting hardware on recessed model
- Modular design provides ease of installation and matching configurations
- Low profile recessed housing is suitable for old or new work installations and is Type IC Rated
- Recessed ceiling back-box features universal adjustable mounting brackets with quick-fit retaining clips to suit most ceilings
- Slimline low profile surface mount housing eliminates need for recessing box in wall mount applications
- New design Architectural Swivel pendants available with matching finishes



Pictured with optional Flat Panel

Electrical

- Diagnostic Battery Monitoring on all "EM" models
- Maintenance free LED Light source with 25+ years life expectancy
- Red letters are 6" high with 3/4" stroke, power consumption is < 3 Watts for all models
- Battery Diagnostic Circuit monitors battery status, detects cell failure and issues alert of reduced capacity and the need to replace battery
- Unique electronic driver circuit provides current control and protection ensuring optimum LED efficiency and life
- Universal 120/277 VAC field selectable input. All versions feature fully integral electronic components
- Premium long life high temperature rated, fused Nickel Cadmium battery, operating temperature 10° to 40°C
- Recessed AC Indicator Test Switch
- Brownout sensing assures emergency illumination during periods of low line voltage
- Self-compensating solid state Constant Current Charger provides extended float life and rapid recharge
- Zero current LVCO ensures positive charge acceptance following extended discharge

Illumination

- Refractive light guide engineered to optimize LED utilization and illumination uniformity
- Both the legend and characters are illuminated with excellent legend uniformity 1-4:1 background, 2.5:1 Avg. 31cd/m², avg. 6cd/m²
- Available with a range of information signage or custom graphics to order

Certification

- City of Chicago approved with field-installable universal arrows
- UL Listed 3 hour emergency duration standard
- City of Chicago approved, UL 924 Listed by Underwriters Laboratories and meets or exceeds all performance standards as required by NFPA 101, NFPA 70-NEC and OSHA



Warranty

- 5 year limited warranty

SovereignII LED Exit Signs

ORDERING GUIDE – SOCII

Example: SOCII-EM-3UA-BA-RC-SD-FT

Model	Operation	Legend Code Number		Trim/Housing Color	Mounting	Options	
SOCII	AC	AC Only	Single Face	Double Face	BA Brushed Aluminum (standard) WH White Finish BK Black Finish BR Painted Brass BZ Painted Bronze CC Custom Color (specify)	Standard Mounting RC Recessed Ceiling UP RC w/Preshipped backbox SC Surface Ceiling SW Surface Wall SE Surface End Optional Mounting MU Mullion Mount SU Surface Universal PA 12" Swivel Pendant Mount PB 24" Swivel Pendant Mount PC 36" Swivel Pendant Mount PD 48" Swivel Pendant Mount PE 60" Swivel Pendant Mount PF 72" Swivel Pendant Mount	DK Two Circuit Input, 120 or 277 (specify Voltage AC Models Only) SD Self-Test / Self-Diagnostics (EM Models Only) IR Self-Diagnostics with Infrared remote Testing (EM models only) TLRT Infrared hand held Transmitter (order separately) F Flash in Emergency Mode (EM Models) or continuous Flash in AC models FA Flash in AC and Emergency mode on 12-24V (AC or DC) normally-off fire alarm signal (Available for AC and EM models) FB FA Option including Buzzer FZ F Option including Buzzer DL Damp location listed FT Flat Trim for Recessed Ceiling Mount FP Flat Panel (no curve on panel bottom) IN Inverted Legend – Use with Mullion Mount OW Old Work Clips
	EM	NiCad Battery Backup	3 Exit (No Arrow) 3UA Exit (w/Field Installed Universal Arrow Kit) 6 Exit (Right Arrow) 9 Exit (Left Arrow) 12 Exit (Double Arrow) 2 Stairs (No Arrow) 2UA Stairs (w/Field Installed Universal Arrow Kit) 5 Stairs (Right Arrow) 8 Stairs (Left Arrow) 11 Stairs (Double Arrow)	18 Exit (No Arrow) 18UA Exit (w/Field Installed Universal Arrow Kit) 21 Exit (Right or Left Arrow) 24 Exit (Double Arrow) 17 Stairs (No Arrow) 17UA Stairs (W/Field Installed Universal Arrow Kit) 20 Stairs (Right or Left Arrow) 23 Stairs (Double Arrow)			
SOCII							

Fill in fields from categories above and complete type and part number.

Type Number:

Full Part Number:

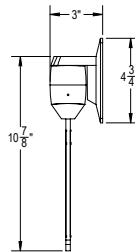
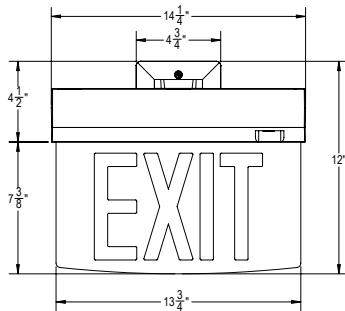

(SW) Surface Wall Mount



Pictured with optional Flat Panel

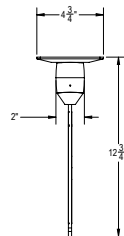
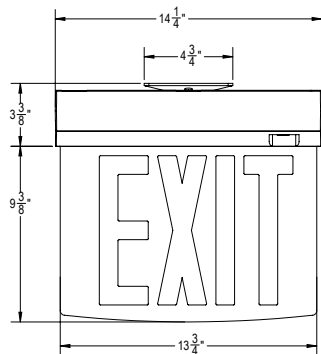

(SC) Surface Ceiling Mount

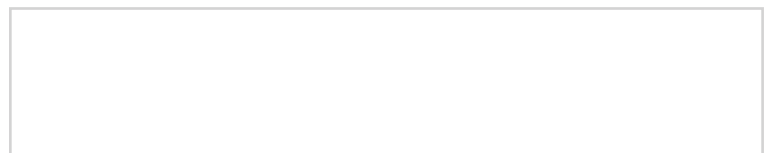

SovereignII LED Exit Signs

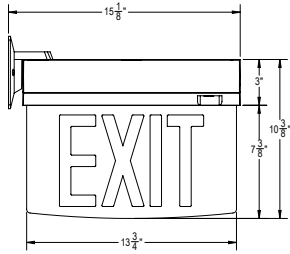

(SE) Surface End Mount



Pictured with optional Flat Panel

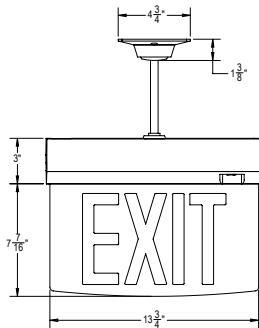

(AP) Architectural Pendant Mount

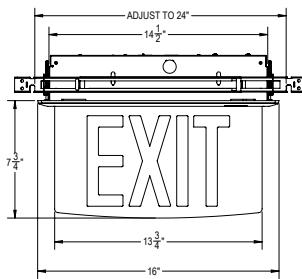
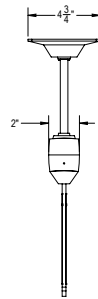

(RC) Accented Trim Recessed Ceiling Mount

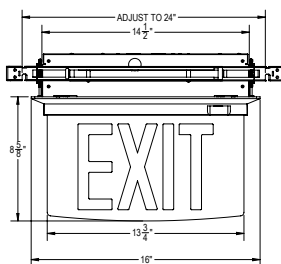
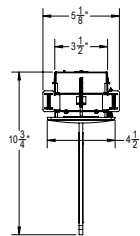

(RC FT) Flat Trim Recessed Ceiling Mount

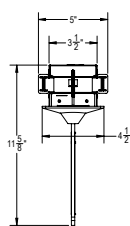

Pictured with optional Flat Panel

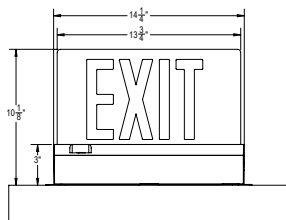

(MM) Mullion Mount

