



FEATURES:

- ✓ Architectural sound absorbing Eco Felt Acoustic panel.
- ✓ Made from recyclable plastic material available in different thicknesses.
- ✓ Class1 Fire rated with 0.7 Noise Reduction Coefficient/1" Acoustic.
- ✓ Light source: COB LED.
- ✓ Low glare opal lens is built in to the integral specular reflector.
- ✓ Steel body of the luminaire with integral diver.
- ✓ Available with matte white, black and grey finish.
- ✓ LED Spot is rated for 60,000hrs. L70 with +85 CRI.
- ✓ Has a proven record in office, commercial and retail installations.
- ✓ Custom modifications are available.
- ✓ ED luminaires are certified to CSA and UL Standards.

reinventlight

SPECIFICATION:

Sonic PRO+ - - - - - - - - - -

Enter the Product Code into the boxes above.

TYPE

- CS - Cylinder

HEIGHT

- 12 Inch
- 16 Inch
- 24 Inch

SOURCE

- 10W LED
- 20W LED
- 30W LED

VOLTAGE

- 120V
- 277V

DRIVER

- ST - Standard
- DL - 0-10V Dimming
- DT - TRIAC
- *

* Please specify dimming method (ELV).

MOUNTING

- S4-Suspension 4Feet
- S6-Suspension 6Feet
- S Feet*

*Please specify required Length.

LENS

- OP - Opal
- PR - Prismatic

ED PRO+ FINISH

- WH - White
- BK - Black
- GR - Grey*

*Supply with White Cord & Canopy

CCT

- 30K - 3000Kelvin
- 35K - 3500Kelvin
- 40K - 4000Kelvin

*Other options are available.

ACOUSTIC FINISH*

01 02 03 04 05 06 07 09 11 12
 15 18 24 25 26 28 30 31 32 33

* Please specify Acoustic Trim & Body finish, for example (02/32)

LUMEN OUTPUT:

Watts	30K	35K	40K
10W	975 lm	1000 lm	1025 lm
20W	1950 lm	2000 lm	2050 lm
30W	2950 lm	3000 lm	3075 lm

Project:

Type:

SIZE:

H - Height	Diameter
12 Inch = 11.75 Inch	12.00 Inch
16 Inch = 15.75 Inch	12.00 Inch
24 Inch = 23.75 Inch	12.00 Inch

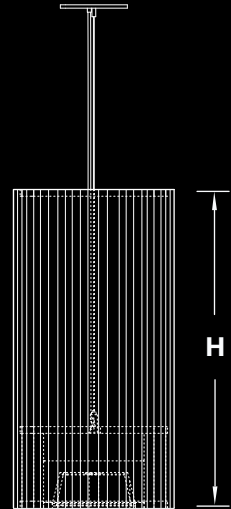
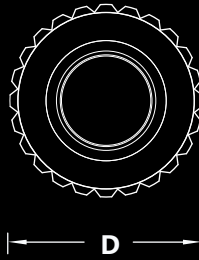

FINISHES



(02/01)



(02/32)



(02/11)



(02/25)



(02/06)



(02/26)



(02/15)



(25/09)