

# BILLET

SYMMETRICAL BAFFLES - WET LOCATION

**bold**  
lighting

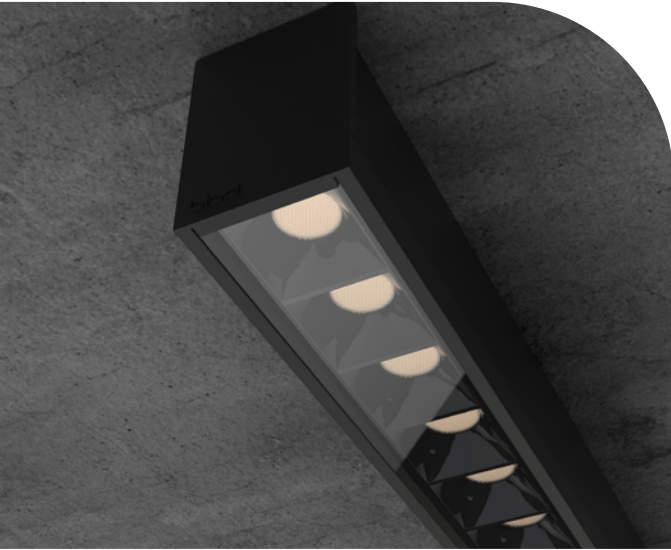

The Billet family of products allows you to achieve uniformity throughout indoor and outdoor spaces while maintaining the same optical performance, light consistency, and overall aesthetics.

The Billet Symmetrical Baffles were designed to provide bold illumination while maintaining minimal glare. Like all Bold products, the Billet confidently delivers a flawless light distribution and a beautifully finished product.

## CONSTRUCTION

**Product Type :** Linear  
**Body Material :** Extruded Aluminum  
**Body Finish :** Black / Grey / White  
 Custom RAL  
**IP Rating :** IP67 Inground  
 IP66 Ceiling Recessed  
**IK Rating :** IK10

## LIGHT SOURCE

**Direct Light Source :** Mid-power LEDs  
**Luminous Output :** from 690lm/ft. to 1650lm/ft. (Delivered)  
**Light Source CCT :** 2700K / 3000K  
 3500K / 4000K / Tunable White  
 (2700K-5000K) / Dim-to-Warm  
 (3000K-1800K) / RGBW  
**Color Rendering Index :** Ra80 / Ra90

## INSTALLATION

**Environment :** Wet Location  
**Mounting :** Inground / Ceiling Recessed (Trim & Trimless) / Wall Recessed (Trim & Trimless)  
 Surface Mounted / Pendant

## ELECTRICAL

**Input Voltage :** 120V / UNV 120-277V - 50Hz/60Hz  
**Load :** 4W/ft. to 19W/ft.  
**Output Type :** Constant Current  
**Driver Type :** Integral  
**Dimming :** 0-10V / DALI / ELV / DMX  
 Lutron Hi-Lume

## OPTICS

**Optical Distribution :** 10° / 20° / 28° / 50°  
 Elliptical (10°x28°) (10°x36°)  
**Glare Control :** UGR<19

Code example: **BOS**-P12W-L1B-W-E827-0

Series	Mounting	Nominal Length
<b>BOS</b>	<b>R</b> Recessed with Trim	<b>12</b> 12"
	<b>T</b> Recessed Trimless	<b>18</b> 18"
	<b>S</b> Surface Mounted	<b>24</b> 24"
	<b>P</b> Pendant	<b>30</b> 30"
	<b>I</b> Inground	<b>36</b> 36"
		<b>42</b> 42"
		<b>48</b> 48"
		<b>54</b> 54"
		<b>60</b> 60"
	<b>XX</b> Custom in	
<b>LX</b> Elbow		
For exact lengths refer to dimensions table.		

Body Finish	Output <sup>1</sup>	Voltage	Dimming	Baffles	Beam Angle	CRI	Color Temp	Emergency	
<b>W</b> White	<b>L</b> 690lm/ft (4W)	<b>1</b> 120V	<b>A</b> No Dimming	<b>W</b> Flat White	<b>S</b> 10°	<b>8</b> +80	<b>27</b> 2700K	<b>0</b> no	
<b>B</b> Black	<b>M</b> 1140lm/ft (9W)			<b>B</b> Flat Black	<b>M</b> 20°		<b>9</b> +90		<b>30</b> 3000K
<b>G</b> Grey	<b>H</b> 1810lm/ft (15W)			<b>N</b> Black Nickel	<b>F</b> 28°		<b>35</b> 3500K		
<b>X</b> Custom RAL	<b>V</b> 2650lm/ft (22W)			<b>C</b> Specular Chrome	<b>B</b> 50°		<b>40</b> 4000K		
			<b>E</b> DALI to 1%	<b>G</b> Bright Gold	<b>E</b> 10°x 28°		<b>WD<sup>4</sup></b> 3000K- 1800K		
			<b>F</b> DMX	<b>E</b> Diffuse Gold	<b>G</b> 10°x 36°		<b>TW<sup>5</sup></b> 2700K - 5000K		
			<b>G<sup>3</sup></b> LUTRON	<b>X</b> Custom			<b>CC</b> RGBW		

### Notes:

- <sup>1</sup> Denotes output at 3000K, unless otherwise noted.
- <sup>2</sup> Not applicable for ELV dimming.
- <sup>3</sup> Hi-Lume 1% EcoSystem Soft-on, Fade-to-Black dimming.
- <sup>4</sup> Denotes output specific to Dim-to-Warm at 3000K.
- <sup>5</sup> Denotes output specific to Tunable White at full on.

Consult factory for lead-times.  
 Consult factory for systems using multiple optics and mounting configurations.



**Bold Lighting**  
 4710 Ecton Dr. Unit F & G, Marietta, GA 30066, USA  
 info@boldlighting.us www.boldlighting.us  
 t: +1-678-903-4061

# OPTICAL FLEXIBILITY

## NARROW BEAM SYMMETRICAL BAFFLE

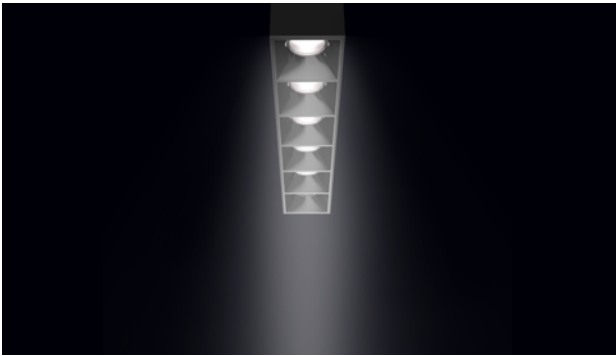

10° Beam Angle

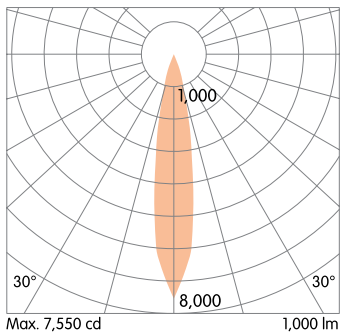

A narrow 10° beam is ideal for high-ceiling applications and for emphasizing texture on vertical surfaces and architectural elements.

## MEDIUM BEAM SYMMETRICAL BAFFLE



25° Beam Angle

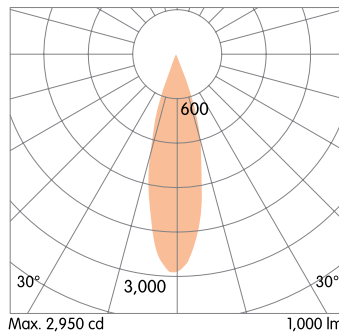

The 25° medium beam is a versatile distribution that works in a wide range of applications and spaces. This optic is a nice balance between light punch and ambient uniformity.

## FLOOD BEAM SYMMETRICAL BAFFLE



40° Beam Angle

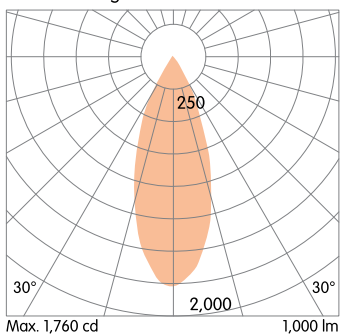

A 40° flood beam is the optimal option for achieving efficient ambient lighting with excellent uniformity and very low glare.

## ELLIPTICAL DISTRIBUTION

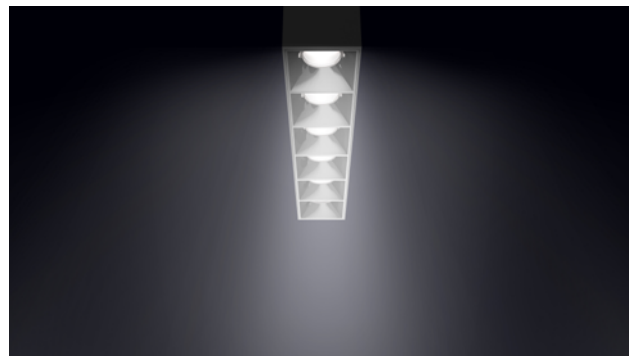

Elliptical Beam Angle

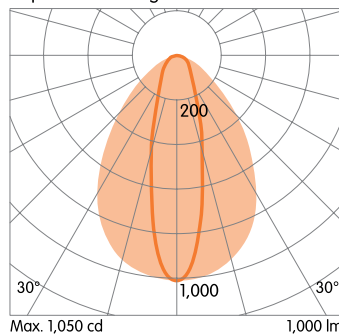

Elliptical distributions can be used anywhere focused illumination is needed. Bille's elliptical beam is ideal for applications such as grazing texture on vertical surfaces and illuminating long narrow spaces without scallops.

# MOUNTING FLEXIBILITY

## SURFACE MOUNTED

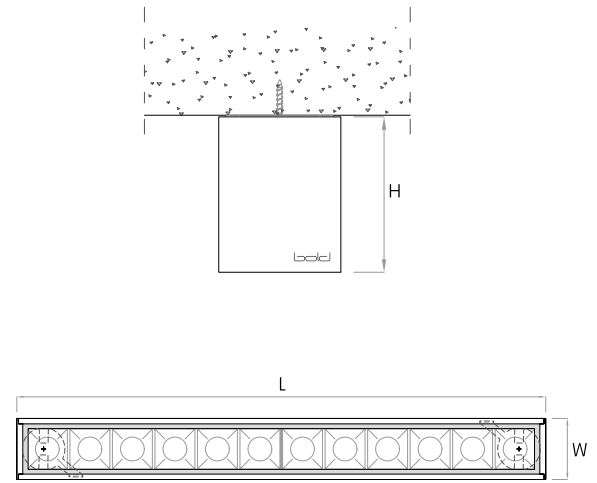

Actual

L= 24<sup>1</sup>/<sub>2</sub>" | 36<sup>5</sup>/<sub>16</sub>" | 48<sup>1</sup>/<sub>8</sub>" | 59<sup>5</sup>/<sub>16</sub>" | Continuous runs

W= 2<sup>13</sup>/<sub>16</sub>"

H= 3<sup>9</sup>/<sub>16</sub>"

## RECESSED WITH TRIM

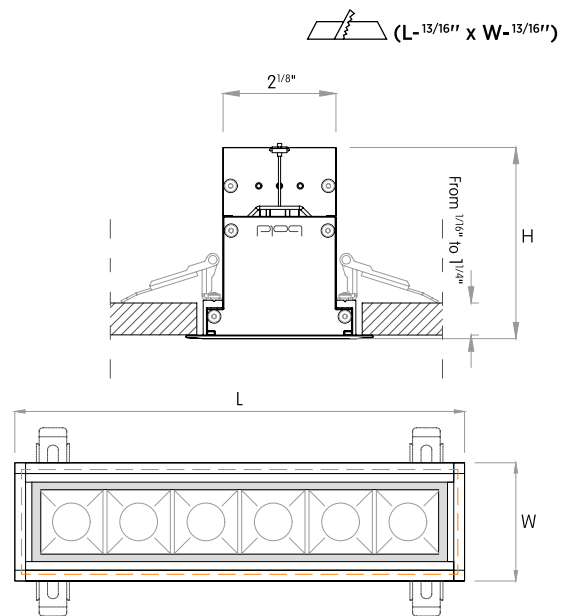
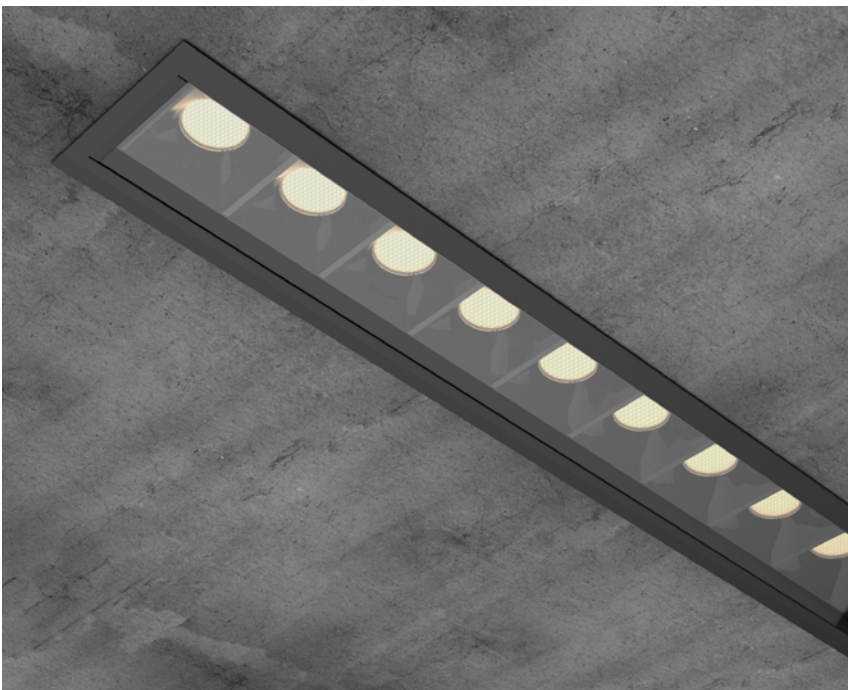

Actual

L= 13<sup>3</sup>/<sub>16</sub>" | 25" | 36<sup>13</sup>/<sub>16</sub>" | 48<sup>5</sup>/<sub>8</sub>" | 60<sup>7</sup>/<sub>16</sub>" | Continuous runs

W= 3<sup>7</sup>/<sub>16</sub>"

H= 3<sup>9</sup>/<sub>16</sub>"

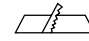

# MOUNTING FLEXIBILITY

 ( $L + 1/16'' \times W + 1/16''$ )

## RECESSED TRIMLESS

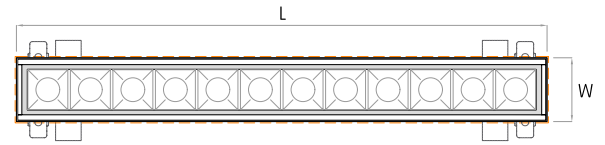
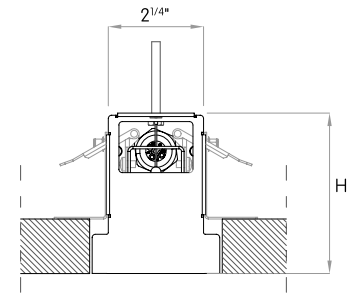
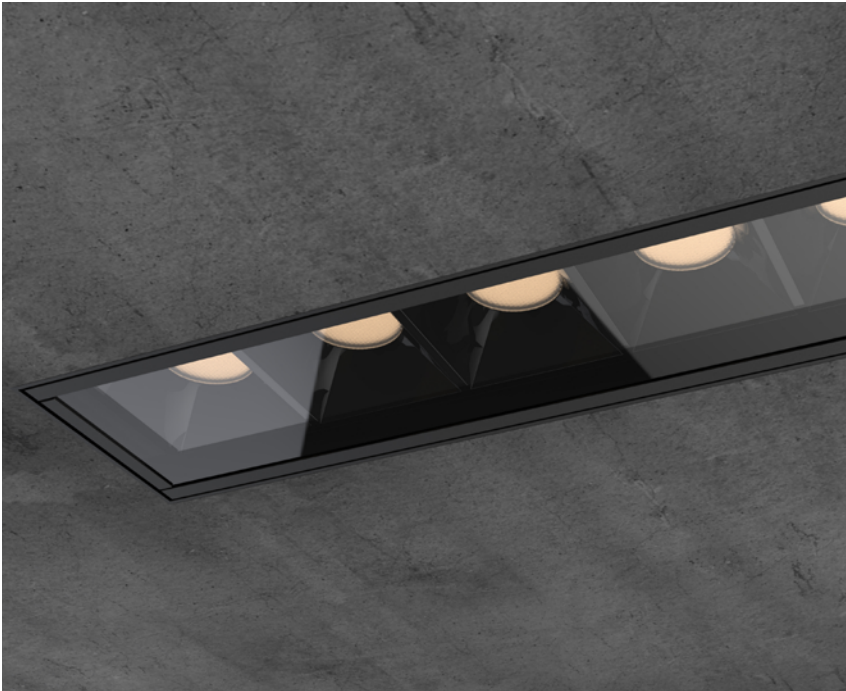

Actual

L = 24<sup>5/8</sup>" | 36<sup>3/8</sup>" | 48<sup>1/4</sup>" | 60" | Continuous runs

W = 2<sup>15/16</sup>"

H = 3<sup>1/16</sup>"

## INGROUND

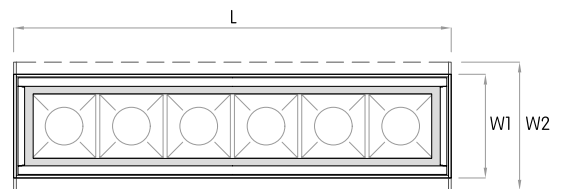
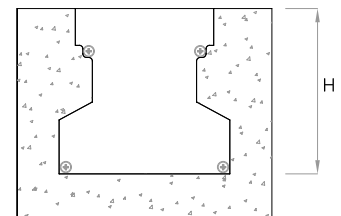
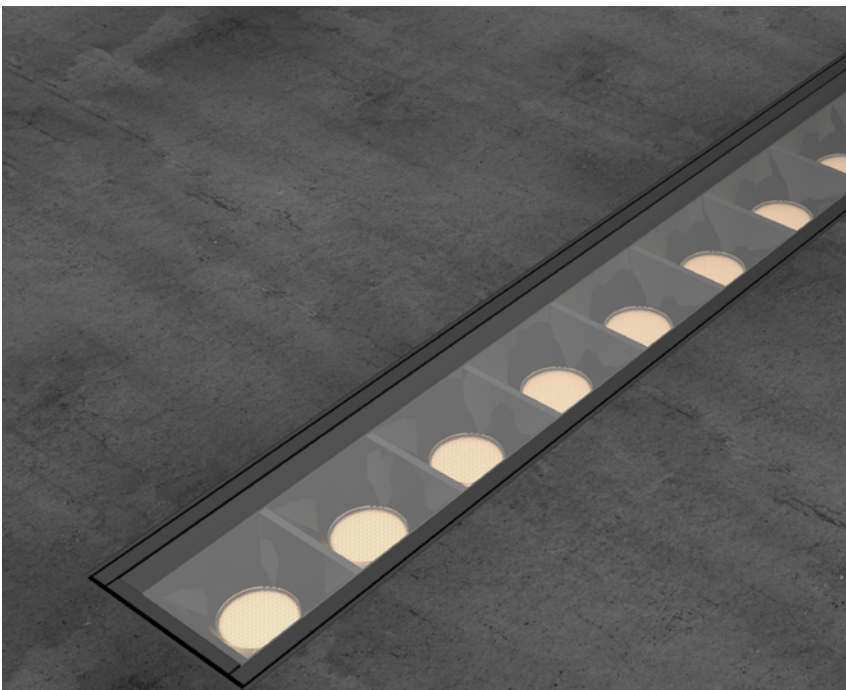

Actual

L = 12<sup>13/16</sup>" | 24<sup>5/8</sup>" | 36<sup>7/16</sup>" | 48<sup>1/4</sup>" | 60" | Continuous runs

W1 = 3" | W2 = 3<sup>3/4</sup>"

H = 3<sup>5/8</sup>"





# MOUNTING FLEXIBILITY

## PENDANT

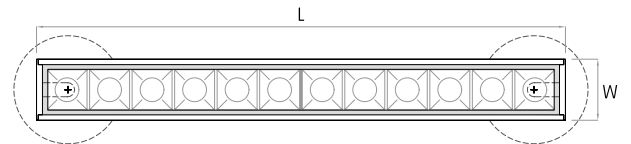
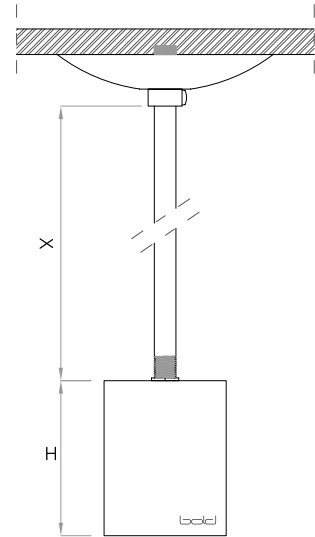

Actual

L= 24<sup>1</sup>/<sub>2</sub>" | 36<sup>5</sup>/<sub>16</sub>" | 48<sup>1</sup>/<sub>8</sub>" | 59<sup>15</sup>/<sub>16</sub>" | Continuous runs

W= 2<sup>13</sup>/<sub>16</sub>"

H= 3<sup>9</sup>/<sub>16</sub>"

X= 59"



## DELIVERED LUMEN OUTPUT

Output		Watts			CRI +80			CRI +90					
<b>STATIC-WHITE</b>			<b>2700K</b>	<b>3000K</b>	<b>4000K</b>		<b>2700K</b>	<b>3000K</b>	<b>4000K</b>				
<b>L</b>	4W		660lm	690lm	730lm		560lm	580lm	610lm				
<b>M</b>	9W		1080lm	1140lm	1180lm		910lm	940lm	1000lm				
<b>H</b>	15W		1710lm	1810lm	1880lm		1450lm	1490lm	1580lm				
<b>V</b>	22W		2550lm	2650lm	2790lm		2100lm	2180lm	2300lm				
<b>DIM-TO-WARM 3000K-1800K</b>								<b>3000K</b>					
<b>L</b>	9W							1000lm					
<b>V</b>	18W							1820lm					
<b>TUNABLE WHITE 2700K-5000K</b>													
<b>L</b>	12W			1220lm				1030lm					
<b>V</b>	22W			1710lm				1450lm					
<b>RGBW</b>								<b>R</b>	<b>G</b>	<b>B</b>	<b>W</b>		
<b>TOTAL</b>	47.5W							(9W) 240lm	(13.5W) 700lm	(13W) 220lm	(12W) 630lm		

## DIMENSIONS TABLE

		12"		24"		36"		48"		60"					
		Height		Width		Actual Length		Actual Length		Actual Length					
		mm	inch	mm	inch	mm	inch	mm	inch	mm	inch				
<b>Surface Mounted</b>		91	3 9/16	72	2 13/16			623	24 1/2	923	36 5/16	1223	48 1/8	1523	59 15/16
<b>Recessed with Trim</b>		91	3 9/16	88	3 7/16	335	13 3/16	635	25	935	36 13/16	1235	48 5/8	1535	60 7/16
<b>Recessed Trimless</b>		93	3 11/16	75	2 15/16			625	24 5/8	925	36 3/8	1225	48 1/4	1525	60
<b>Pendant</b>		91	3 9/16	72	2 13/16			623	24 1/2	923	36 5/16	1223	48 1/8	1523	59 15/16
<b>Inground (with housing)</b>		92	3 5/8	95	3 3/4	325	12 13/16	625	24 5/8	925	36 7/16	1225	48 1/4	1525	60

