

# L154

EXTERIOR | INTERIOR

Surface Mount Downlights | For under benches or stair treads

- Wet, Damp, and Dry location

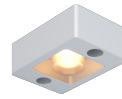

shown with round lens

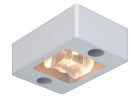

shown with ribbon lens  
not available with C (cover)

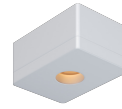

shown with C (cover)

## Ordering Information

Clear Form

Date : \_\_\_\_\_

Quantity : \_\_\_\_\_

Project : \_\_\_\_\_

Note : \_\_\_\_\_

Type : \_\_\_\_\_

## Specifications

Luminaire | Example Code: L154-4-W30H-N-[ ]-MA

Product	Wattage	CCT & CRI <sup>1</sup>	Beam Angle <sup>2</sup>	Accessories (optional)	Finish <sup>4</sup>
L154	2				MA
	2 2W	<b>Standard (80+) CRI:</b> W22S 2200K 80+  <b>High (90+) CRI:</b> W27H 2700K 90+ W30H 3000K 90+ W35H 3500K 90+ W41H 4100K 90+	S spot 12° N narrow flood 30° E1 elliptical 18°+ 47° E2 elliptical 10°+ 170° <sup>3</sup>	C cover	<b>Aluminum Finishes:</b> MA matte clear anodized

### System Components (Ordered Separately)

Remote Driver : \_\_\_\_\_

Control System : \_\_\_\_\_

**On/Off | Dimming** ELV or 0-10 dimming  
**Other options (consult factory)** TRIAC/MLV, DMX, DALI, Casambi, PoE

### Important Notes

#### Specification

- Refer to pg.02 - Light Quality & Colour Consistency details.
- Adding a cover changes the Elliptical Beam for this Luminaire. Shown in the table are the angles without cover interference. With cover the Elliptical Beam is 18°+ 43°.
- E2 beam angle is not compatible with Cover accessory.
- Refer to Appendix or MP Lighting website for complete look of luminaire with different finish options.

#### Warranty Notes & Disclaimer

Malfunction and damage to product due to incompatible dimming system or misuse will not be covered under warranty. Consult MP Lighting for recommended drivers. If the fixture has an option to be installed with a dimming control system, consult a dimming system manufacturer with minimum load before installing. MP Lighting reserves the right, at its sole discretion, at any time and without notice, to make design changes to any of our products. Consult MP Lighting website for most updated documentation.

# L154

EXTERIOR | INTERIOR

Surface Mount Downlights | For under benches or stair treads

- Wet, Damp, and Dry location

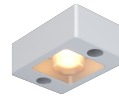

shown with round lens

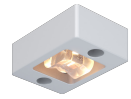

shown with ribbon lens  
not available with C (cover)

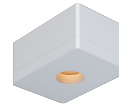

shown with C (cover)

## Performance

Wattage	Forward Current	Power Consumption Budget per fixture (including driver)	LED output (Source)	Fixture Output (Delivered)
2W	700mA	2.5W	220 lm	150-216 lm

## Application

Environment	Wet, Damp, Dry Location approved. IP 66.
Mounting	<b>Surface-mounted:</b> Mounts directly to surface with two screws. Comes with 3' (914mm) wire lead.

## Electrical

LED Light Source	<b>W22S</b> = CCT: 2200K, CRI (Ra): 80+, Colour Consistency: 3SDCM <b>W27H</b> = CCT: 2700K, CRI (Ra): 90+, Colour Consistency: 2SDCM <b>W30H</b> = CCT: 3000K, CRI (Ra): 90+, Colour Consistency: 2SDCM <b>W35H</b> = CCT: 3500K, CRI (Ra): 90+, Colour Consistency: 2SDCM <b>W41H</b> = CCT: 4100K, CRI (Ra): 90+, Colour Consistency: 3SDCM
Power Supplies	Remote LED drivers (120-277V AC input, <b>constant current output</b> ): fixtures to be wired in series.
Control	<b>On/off control</b> <b>Dimming:</b> ELV or 0-10V dimming with appropriate drivers. <b>Other options (consult factory):</b> TRIAC/MLV, DMX, DALI, Casambi, Power over Ethernet.

## Luminaire Construction

Weight	N/A
Material	<b>Fixture:</b> machined marine-grade aluminum with PMMA lens
Supplied with	<b>Standard installation housing:</b> Comes with two screws. <b>Cable:</b> 3' (914mm) factory-installed wire lead.
Warranty & LED Life	5 years limited warranty. Estimated useful life of LED is 50,000 hours.

## Ordered Separately

System Components	<b>Power supplies:</b> remote driver. Please consult factory or visit <a href="#">Recommended Drivers</a> for available driver options.
-------------------	--

Mounting Options & Dimensions

LED Insert Dimensions

Fixture

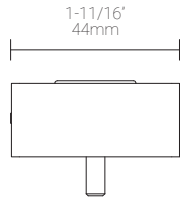

Side & Top View

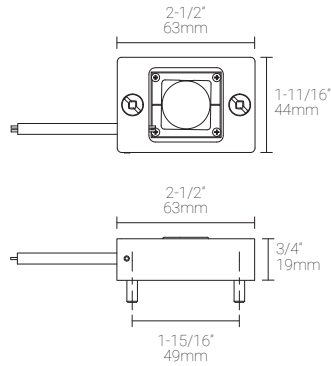

3D View

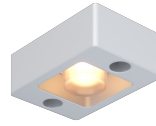

Beam

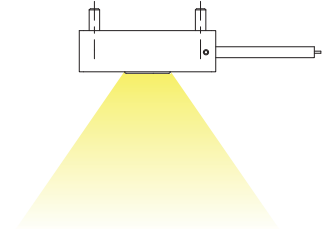

LED Insert Dimensions | Shown with Cover

Fixture

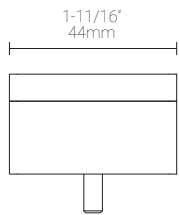

Side & Top View

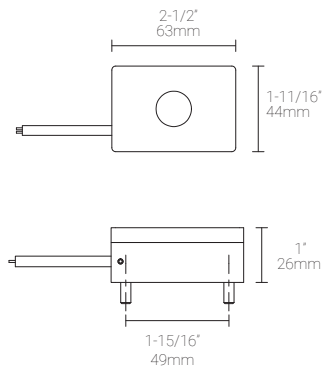

3D View

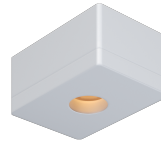

Beam

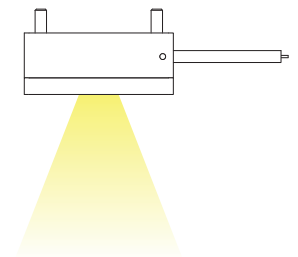

LED Insert Dimensions | Shown with Elliptical beam 2

Top View

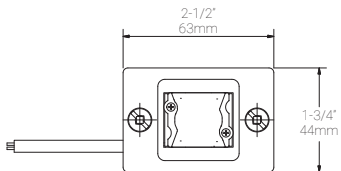

Side View

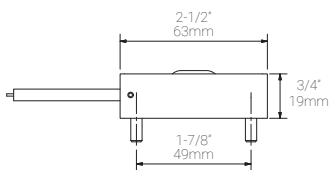

3D View

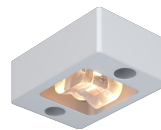

Beam (Front View)

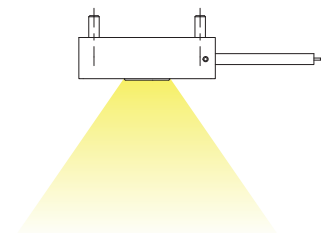

2W, 3000K, 90+ CRI, without cover

Polar Candela Distribution

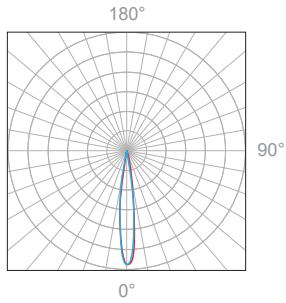

Beam Width: 12°



Illuminance at a Distance

Distance		Center Beam fc	Beam Width			
1.5ft	0.46m	1031fc	0.3ft	0.09m	0.3ft	0.09m
3.0ft	0.91m	258fc	0.7ft	0.21m	0.7ft	0.21m
4.5ft	1.37m	115fc	1.0ft	0.30m	1.0ft	0.30m
6.0ft	1.83m	64.4fc	1.4ft	0.42m	1.4ft	0.42m
7.5ft	2.29m	41.2fc	1.7ft	0.52m	1.7ft	0.52m
9.0ft	2.74m	28.6fc	2.1ft	0.64m	2.1ft	0.64m

Delivered Lumen: 215.1lm  
 ■ Vertical Beam Spread: 13.1°  
 ■ Horizontal Beam Spread: 13.2°

Polar Candela Distribution

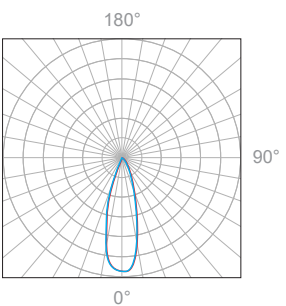

Beam Width: 30°

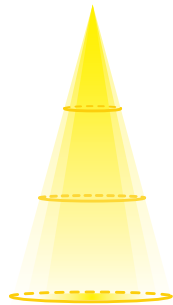

Illuminance at a Distance

Distance		Center Beam fc	Beam Width			
1.5ft	0.46m	239fc	0.8ft	0.24m	0.8ft	0.24m
3.0ft	0.91m	59.8fc	1.6ft	0.48m	1.6ft	0.48m
4.5ft	1.37m	26.6fc	2.5ft	0.76m	2.4ft	0.73m
6.0ft	1.83m	15.0fc	3.3ft	1.00m	3.3ft	1.00m
7.5ft	2.29m	9.58fc	4.1ft	1.25m	4.1ft	1.25m
9.0ft	2.74m	6.65fc	4.9ft	1.49m	4.9ft	1.49m

Delivered Lumen: 175.5lm  
 ■ Vertical Beam Spread: 30.7°  
 ■ Horizontal Beam Spread: 30.4°

2W, 3000K, 90+ CRI, without cover | Elliptical beam 1

Polar Candela Distribution

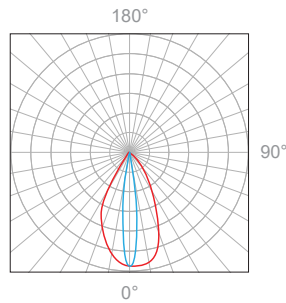

Beam Width: 18° + 47°

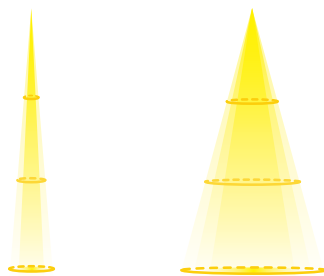

Illuminance at a Distance

Distance		Center Beam fc	Beam Width			
1.5ft	0.46m	180fc	0.5ft	0.15m	1.3ft	0.39m
3.0ft	0.91m	45fc	0.9ft	0.27m	2.6ft	0.79m
4.5ft	1.37m	20fc	1.4ft	0.42m	3.9ft	1.18m
6.0ft	1.83m	11.3fc	1.9ft	0.58m	5.2ft	1.58m
7.5ft	2.29m	7.2fc	2.3ft	0.70m	6.5ft	1.98m
9.0ft	2.74m	5.0fc	2.8ft	0.85m	7.8ft	2.03m

Delivered Lumen: 150.8lm  
 ■ Vertical Beam Spread: 17.6°  
 ■ Horizontal Beam Spread: 46.8°

2W, 3000K, 90+ CRI, without cover | Elliptical beam 2

Polar Candela Distribution

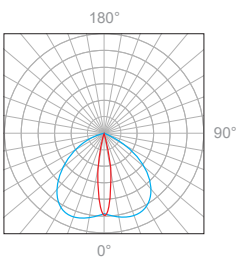

Beam Width: 10° + 170°

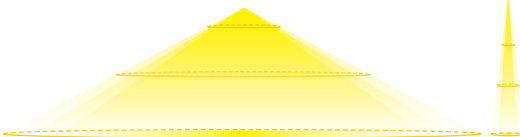

Illuminance at a Distance

Distance		Center Beam fc	Beam Width			
1.5ft	0.46m	101fc	3.2ft	0.97m	0.4ft	0.12m
3.0ft	0.91m	25.2fc	6.4ft	1.95m	0.8ft	0.24m
4.5ft	1.37m	11.2fc	9.7ft	2.95m	1.2ft	0.36m
6.0ft	1.83m	6.30fc	12.9ft	3.93m	1.5ft	0.45m
7.5ft	2.29m	4.03fc	16.1ft	4.90m	1.9ft	0.58m
9.0ft	2.74m	2.80fc	19.3ft	5.88m	2.3ft	0.70m

Delivered Lumen: 125.5 lm  
 ■ Vertical Beam Spread: 94.0°  
 ■ Horizontal Beam Spread: 14.7°

2W, 3000K, 90+ CRI, with cover

Polar Candela Distribution

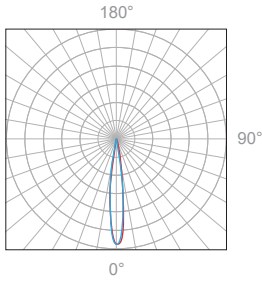

Beam Width: 12°



Illuminance at a Distance

Distance		Center Beam fc	Beam Width			
1.5ft	0.46m	950fc	0.3ft	0.09m	0.3ft	0.09m
3.0ft	0.91m	238fc	0.7ft	0.21m	0.7ft	0.21m
4.5ft	1.37m	106fc	1.0ft	0.30m	1.0ft	0.30m
6.0ft	1.83m	59.4fc	1.4ft	0.42m	1.4ft	0.42m
7.5ft	2.29m	38fc	1.7ft	0.52m	1.7ft	0.52m
9.0ft	2.74m	26.4fc	2.1ft	0.64m	2.1ft	0.64m

Delivered Lumen: 186.5lm  
 ■ Vertical Beam Spread: 13.1°  
 ■ Horizontal Beam Spread: 13.3°

Polar Candela Distribution

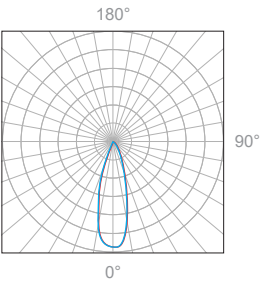

Beam Width: 30°

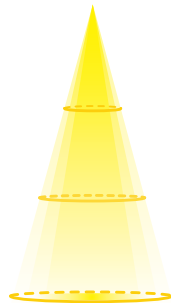

Illuminance at a Distance

Distance		Center Beam fc	Beam Width			
1.5ft	0.46m	228fc	0.8ft	0.24m	0.8ft	0.24m
3.0ft	0.91m	57fc	1.7ft	0.51m	1.7ft	0.54m
4.5ft	1.37m	25.3fc	2.5ft	0.76m	2.5ft	0.76m
6.0ft	1.83m	14.2fc	3.4ft	1.03m	3.4ft	1.03m
7.5ft	2.29m	9.12fc	4.2ft	1.28m	4.2ft	1.28m
9.0ft	2.74m	6.33fc	5.1ft	1.55m	5.0ft	1.52m

Delivered Lumen: 172.5lm  
 ■ Vertical Beam Spread: 31.6°  
 ■ Horizontal Beam Spread: 31.3°

2W, 3000K, 90+ CRI, with cover | Elliptical beam 1

Polar Candela Distribution

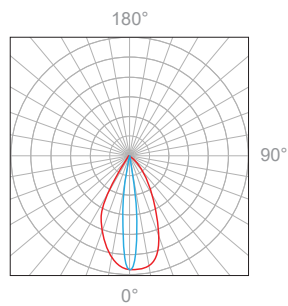

Beam Width: 18°+ 47°

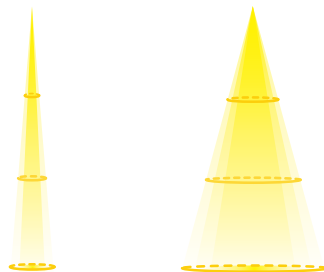

Illuminance at a Distance

Distance		Center Beam fc	Beam Width			
1.5ft	0.46m	174fc	0.5ft	0.15m	1.2ft	0.36m
3.0ft	0.91m	43.4fc	0.9ft	0.27m	2.3ft	0.70m
4.5ft	1.37m	19.3fc	1.4ft	0.42m	3.5ft	1.06m
6.0ft	1.83m	10.9fc	1.8ft	0.55m	4.7ft	1.58m
7.5ft	2.29m	6.95fc	2.3ft	0.70m	5.8ft	1.76m
9.0ft	2.74m	4.82fc	2.8ft	0.85m	7.0ft	2.13m

Delivered Lumen: 150.8lm  
 ■ Vertical Beam Spread: 17.6°  
 ■ Horizontal Beam Spread: 42.5°