

LUMUX

Date :

Project :

Type:

Agency :

Distributor :



Description : Low copper aluminum die cast, oval wall and ceiling luminaries . Vandal resistance stainless steel Wall luminaire with open round trim for general purpose applications. Die-cast aluminum body and trim. The unit is painted with high corrosion resistance polyester powder coat. Available in electronic ballast with silicone wires. Stainless steel screws. Opal glass diffuser.. UL & CUL listed for wet locations. Fully gasketed for tight weather operation. 1/8" Prismatic glass diffuser

SPECIFICATION:

Housing : Low copper aluminum die cast. Vandal resistance stainless steel screws. Silicon gasketed for weather tight operation.

Diffuser : 1/8" Frosty Prismatic glass

Electrical : Voltage : 120 / 277
Lamp: Incandescent, Compact Fluorescent.
Socket : A19, G23-2, G24Q-4.
Ballast : Class P, Electronic Ballast

Installation: Unit is provided with standard cross bar bracket.

DIMENSIONS:

A = 10 5/16"
B = 6.0"

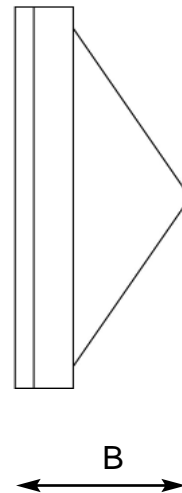
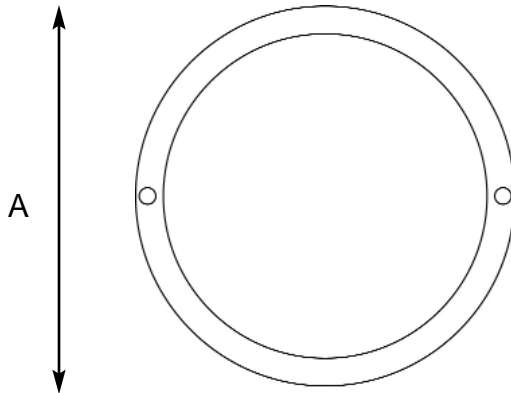

Lumux - L300

Lumux reserves the right to modify the above details to reflect changes in the cost of materials and/or design without prior notice.

Lumux Lighting Inc	877-895-5552	Rev : C	Drawing Number L300
--------------------	--------------	---------	------------------------

LUMUX

Date :

Project :

Type:

Agency :

Distributor :

ORDERING GUIDE:

L300 / XXX / XXX / xxx

Inc.
PL9
PL13
PL18
PL26

120
277

White
Black
Silver
Bronze
RAL
(optional)

Lumux - L300

PROJECT NOTES:

Comments

Approval

Lumux reserves the right to modify the above details to reflect changes in the cost of materials and/or design without prior notice.

Lumux Lighting Inc	877-895-5552	Rev :C	Drawing Number L300
---------------------------	---------------------	---------------	-------------------------------