

# M400/MCLR4W

120V-277VAC LED 4", Non-IC, Architectural Frame-in Kit  
Down Light with interchangeable Reflector Trims

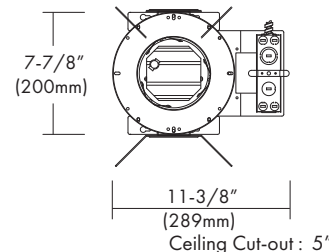
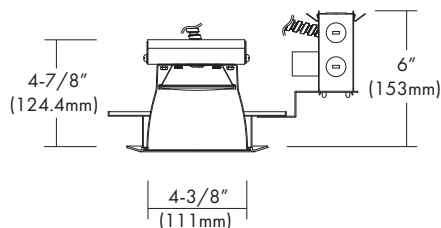

## DESCRIPTION

The M400/MCLR4W is a 4" LED, Non-IC, Frame-in kit and is available with multiple Trim styles. Designed for use in non-insulated ceilings, Insulation material must be kept a minimum of 3" from fixture. Available with a 14W or 23W, high efficacy LED engine and universal, dimmable drivers. The special optical diffuser produces high lumen transmission and even illumination. Suitable for Wet Locations.

## DESIGN FEATURES

### Mounting Ring

- 20-gauge CRS mounting ring, painted black. The 1-5/8" deep collar may be used with various ceiling material thicknesses.

### LED Module & Trim

- Painted, extruded aluminum heat sink designed to facilitate efficient heat dissipation for superior thermal management and reliability.
- LED engine includes LED, heat sink and lens assembly.
- Heavy gauge aluminum reflector anodized in clear haze or white paint finishes. Multiple trim styles and finishes are available.

### LED Driver

- Universal, 120~277V input, high efficacy drivers with dimming capability by a Triac 120V low voltage electronic dimmer switches or 0-10V, Triac & ELV dimmer switches.
- Drivers feature power factor >.90, THD <20% with integral thermal protection to sense over temperature or electrical issues.
- Driver mounts externally to the module to allow future replacement or upgrading if desired.

### Mounting Channel Bracket

- Commercial mounting kit provides up to 5" vertical adjustment and accommodates 1/2" EMT conduit. Optional HB-24 or HBC-24 bar hanger or lathing channels for T-bar grid or concealed spline ceiling are also available.

### Junction Box

- Listed for through branch circuit wiring. (Max.8 No 12 AWG 90 °C branch circuit conductors: 4 in, 4 out)
- (5) 1/2" knockouts with pry-out slots and (4) knockouts with Romex cable clamps.
- Ground wire provided on J-box.

### Options

- Emergency battery back-up : Available in mounted to fixture or remote adjacent to luminaire (consult with factory for space requirements).

### Limited Warranty

- LED Module: 5 years/50K hours
- Product/Driver: 3 years

### Listing

- cETLus Wet Location
- ENERGY STAR
- California Title 24

Catalog		Type
Project		Date
Prepared		

## 4" LED Architectural Frame-in Kit

SPECIFICATION		
Input Voltage	120-277VAC	
Wattage (+/-5%)	14 W	23W
Lumen (+/-5%)	950 lm	1,740 lm
Efficacy (LPW)	67.9 lm/W	75.6 lm/W
Beam Angle	67.7°	69.3°
CRI (Typical)	80, 90	
CCT (Color +/-5%)	2700K, 3000K, 3500K, 4000K	
Dimming	Triac (Standard), 0-10V	
LED Module	5 yr/50K hr	
Environment	Wet Location	

Triac Approved Dimmers
* Lutron : NovaT (Ntely 300 & 600) Diva (Dvelv-300P&303P)
* Leviton: Acenti: Ate06-1Lw
* Leviton Trimatron #705W(incandescent)
0-10V Approved Dimmers
* Lutron : Nova® 0-10V : NTFTV Diva® 0-10V : DVTV
* Leviton: Decora 0-10V : IP710DL
Consult tech. service or factory for additional dimmers

* Provided: Easy-quick connector case (patent pending)

# M400/MCLR4W

120V-277VAC LED 4", Non-IC, Architectural Frame-in Kit  
Down Light with interchangeable Reflector Trims

Catalog		Type
Project		Date
Prepared		

## TRIM

\* Wide beam reflector is standard. Also available narrow beam in reflector(consult with factory).



### MCLR4W-HC

Specular Open

### MCLR4W-B

Reflector Baffle w/  
Reflector

### MCLR4W-BL

Baffle w /  
Regressed Lens

### MCLR4W-CL

Reflector w /  
Regressed Lens

### MCLR4W-HCW

Wall Wash w /  
Reflector Plate

### MCLR4W-DL

Reflector w /  
Frosted Floating Lens

\*All trims are rated for damp location and regressed lens trims are wet location listed.

## PHOTOMETRIC REPORT

\* Contact Factory for IES File

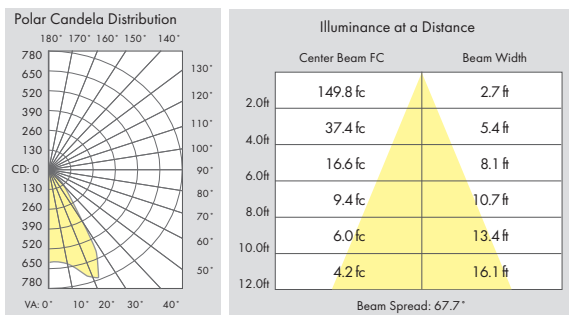

[M400-14-830/MCLR4W-HC-WH]

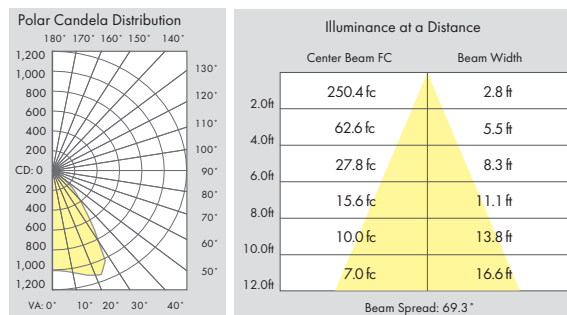

[M400-23-830/MCLR4W-HC-WH]

## Ordering Information

Model	-Watts	-CRI	Color Temp.*	Driver*	Trim	-Reflector Finish **	Baffle Finish for B & BL	Optional Metal Trim Ring Finish
M400 = 4", Non-IC, Architectural Frame-in Down Light Kit 5/8" Collar	-14= 14W -23= 23W	-8= 80 -9= 90	27= 2700K 30= 3000K 35= 3500K 40= 4000K	T = 120~277VAC, Triac: 10-100% Dimming Z = 120~2 77V, 0-10V, Triac & ELV: 1-100% Dimming *- Option -EM= Emergency battery backup	MCLR4W-HC MCLR4W-B MCLR4W-BL MCLR4W-CL MCLR4W-HCW MCLR4W-DL	-HC= Haze Clear -WH= White Painted	-WH= White -BK= Black	-WH= White Plastic Trim Ring (Standard) -WMR= White Metal Ring -SN= Satin Nickel -CH= Chrome -SF= Polished Self-Flange

Example : M400-23-830-Z

MCLR4W-HC-WH

\*\* Consult factory for other Color Temperatures and Finishes