

Date: _____ Customer: _____

Project: _____

Type: _____ Qty: _____



Holon's timeless design enables this fitting to find application in a vast range of projects. The simple and yet strong geometrical form earns its place in residences, office lobbies, corridors, meeting rooms and other public areas.

Holon 80, the larger counterpart of Holon 40, is a product range of directional spotlights and downlights. Various options in LED colour temperature, beam angles, lenses and drivers are available to optimize the desired light effect for each project, either residential, commercial, or hospitality.

Holon 80 directional rotates 360° and tilts up to 90°. The hinge of Holon 80 directional is permanently tensioned, allowing the luminaire to remain at any angle, from 0° to 90°, while allowing effortless adjustment.

In addition to the directional spotlight, this product range comes with a second variety: Holon 80 fixed. This downlight is designed for rooms that embrace the language of form of this luminaire, but don't require an adjustable luminaire head.

Construction

Luminaire

Made from zamak die cast aluminum alloy.

Finishes

- White (RAL 9016)
- Black (RAL 9004)
- RAL color finish upon request

Mounting Options

Directional recessed mounted, directional surface mounted, or fixed. Suitable for installation on drywall, wood panel or grid ceilings with acoustic tiles.

Classifications

Dry locations only



Electrical Characteristics

LED Specification

Xicato Zhaga compliant LED module with Corrected Cold Phosphor Technology® (remote phosphor to limit color shift over time. Tight color consistency within 1x2 MacAdam Ellipses).

For Warm Dim, Tunable White and Full Color Tunable Options

Lumenetix Araya 5 LED module - 5 color chip array to stabilize coloring across full spectrum, with all 1640-8000K whites occurring fully on black body curve, maintaining

95CRI or better. Tight color consistency with Max 2 SSD.

LED Life

L80 greater than 50,000 hours.

Correlated Color Temperature (CCT)

- Available in 2700K, 3000K, 3500K and 4000K Warm Dim range 1800K-3000K, tunable white range 1650K-8000K, and fully saturated color with color tunable option.
- CRI 80+, 95+, 98+.

Gear

Standard 0-10V dimming, universal voltage (120-277V). For non-dimming applications, cap off dimming wires.

Holon 80 – Surface Mounted Monopoint, 3” Aperture



Ordering Codes

HOL -	80 -	-	-	-	-	-	-	-	-	-	-
KREON HOLON	APERTURE SIZE	MOUNTING TYPE	CEILING TYPE ²	BEAM ANGLE	LIGHT SOURCE AND CCT	LUMEN PACKAGE ³	CRI	COLOR ⁴	DIMMING	DRIVER LOCATION	OPTIONAL ACCESSORIES ⁵ (BLANK FOR NONE)
HOL – Holon	80 mm ~3” diameter	DRR ¹ – Directional Recessed Mounted DRS – Directional Surface Mounted FX – Fixed PESF – Pendant Mounted Stem, Fixed PESD – Pendant Mounted Stem, Directional PECF – Pendant Mounted on cable, Fixed	DWF – Drywall/ Sheetrock Flush DWSG – Drywall/ Sheetrock w/Shadow Gap WD – Wood panel GR – Grid ceiling with acoustic tile	SP – Spot 15° FL – Flood 30° WFL – Wide Flood 40°	27 – 2700K 30 – 3000K 35 – 3500K 40 – 4000K WD – warm dim TW – Tunable white CT – full color tunable	SO – Standard Output MO – Medium Output HO – High Output (Not available with SP beam angle or 98 CRI option) (See below for source lumens.)	80 – 80+ min CRI 95 – 95 CRI (For WD, TW, CT) 98 – 98+ min CRI	WHT – White BLK – Black	D1 – TRIAC phase dim (120V only) D2 – 0-10V dim (10%) D3 – Lutron Hi-Lume dim to 1% (consult factory for 2-wire, 3-wire, or digital control) D4 – EldoLED 0% dim to dark	IN – Driver Integral (Only available with D2 dim, DRS or FX Module type and SO Lumen Package with any beam angle or MO with NR or FL beam angle) RM – Remote (number of luminaires per driver depends on Dimming option)	DL – diffusing lens SC – sculpture lens AG – anti-glare louver Consult factory for IP44 rated option for wet locations
Ordering Example: HOL-80-DRS-DWF-NR-35-SO-80-BLK-D3-RM-DL											
¹ Not available with integral driver.											
² Suitable for installation in ceiling thickness between 3/8” to 1”											
³ Lumen Package designates module lumens. CRI, Beam Angle, and Optional Accessories will all impact light output. Please see IES files for delivered lumens.											
⁴ Consult factory for custom RAL finish color options.											
⁵ Maximum one accessory per fixture.											

Luminance Combinations — Source lumens; for delivered lumens, please reference IES files on www.kreon.com

Lumen Package	Beam Angle	CRI	Source Lumens	Watts	Driver
SO	SP	80+	1300	16	Integral
SO	SP	98+	930	16	Integral
MO	SP	80+	2000	30	Remote
MO	SP	98+	1560	30	Remote
SO	NR, or FL	80+	1300	13	Integral
SO	NR, or FL	98+	1300	16	Integral
MO	NR, or FL	80+	2000	20	Integral
MO	NR, or FL	98+	2000	26	Remote
HO	NR, or FL	80+	3000	30	Remote



Holon luminaires are ETL listed for dry or damp locations. Holon luminaires lend support for LEED credits and certification.

Photometry — For full photometry, please reference IES files on www.kreon.com

KUHOL-80-DRR-DW-SP-27-SO-80 (no accessories)

Light Engine: 1300 lumens
 CCT: 2700K
 CRI: 80+
 Power: 16W
 Luminaire Output: 780 lumens (49 lm/W)

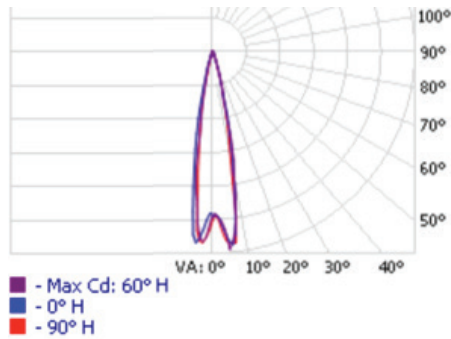

KUHOL-80-DRR-DW-FL-27-MO-80 (no accessories)

Light Engine: 2000 lumens
 CCT: 2700K
 CRI: 80+
 Power: 20W
 Luminaire Output: 1325 lumens (66 lm/W)

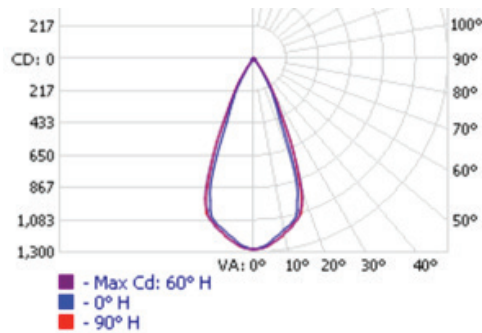

Color Rendering Index (3000K Typical), 80+ CRI

	Ra	R1	R2	R3	R4	R5	R6	R7	R8	R9	R10	R11	R12	R13	R14	R15
Standard Series	83	82	89	95	84	82	87	86	65	16	64	79	58	81	93	75

Color Rendering Index (3000K Typical), 98+ CRI

	Ra	R1	R2	R3	R4	R5	R6	R7	R8	R9	R10	R11	R12	R13	R14	R15
Artists Series	98	98	99	98	98	98	97	98	98	98	99	98	88	98	98	98



Holon luminaires are ETL listed for dry or damp locations.
 Holon luminaires lend support for LEED credits and certification.

Mounting Examples

Fixed (driver inclusive, sheetrock ceiling)

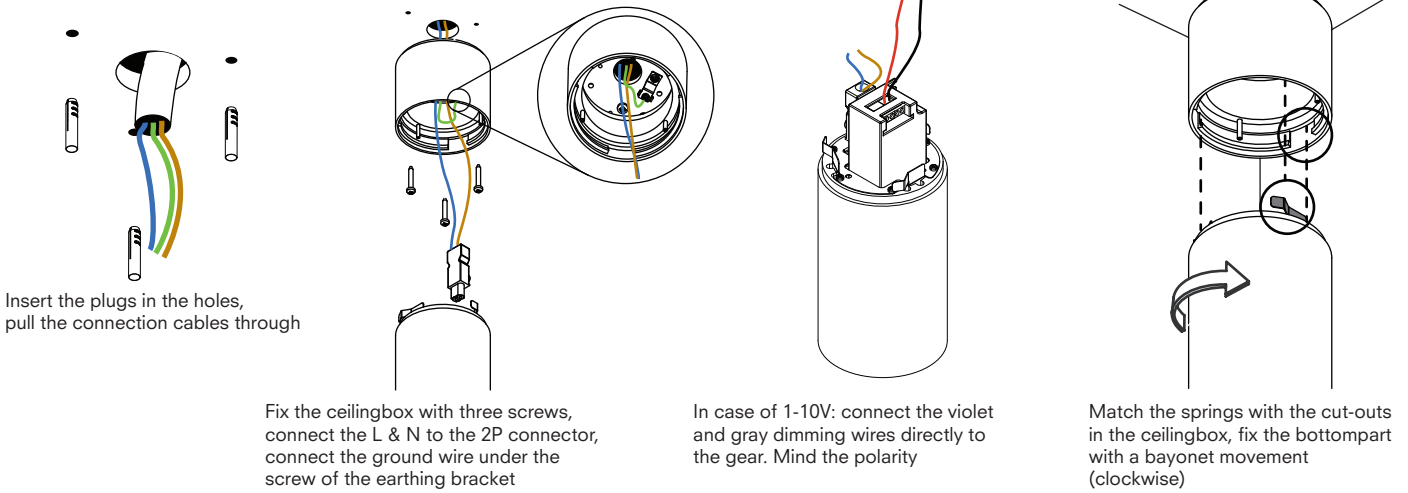

Directional Surface Mounted (driver inclusive, sheetrock ceiling)

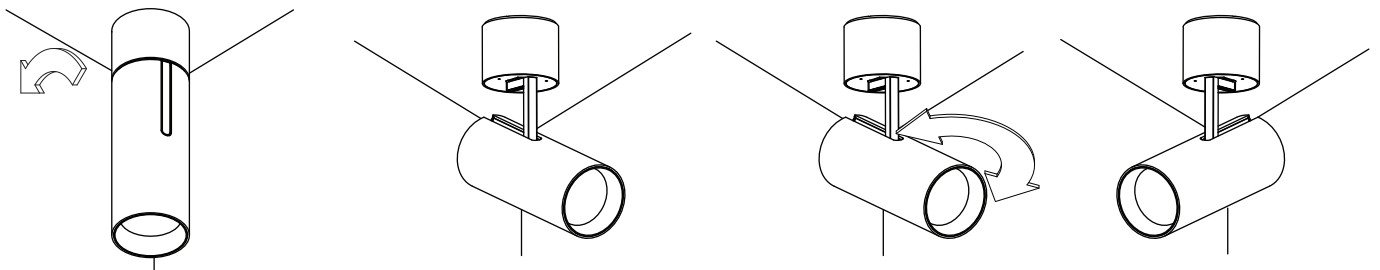
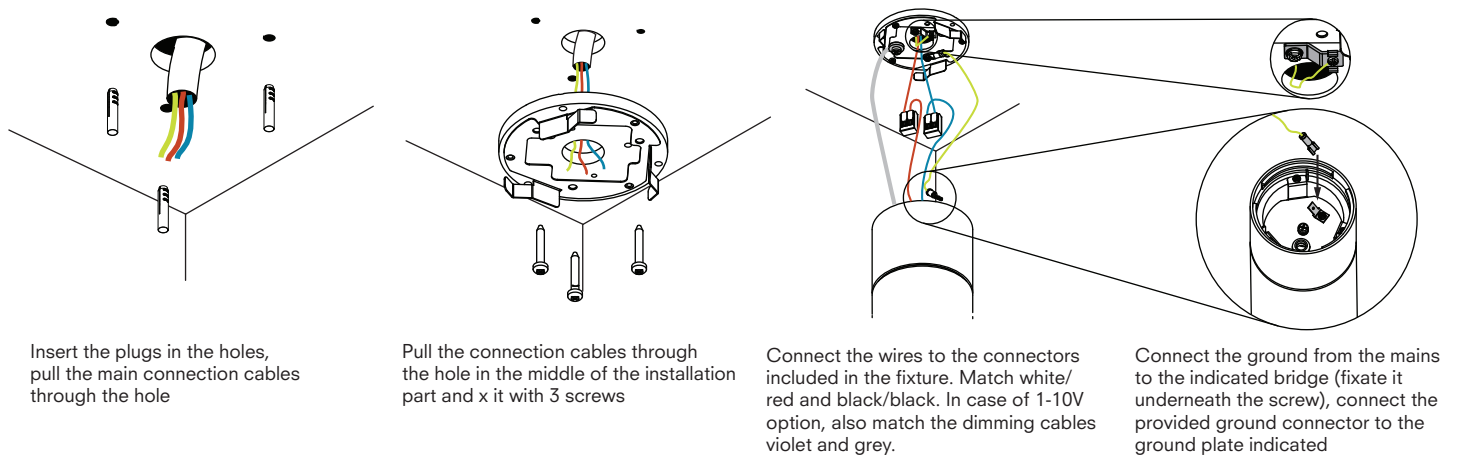

Mounting Examples

Directional Recessed Mounted (remote driver, sheetrock ceiling)

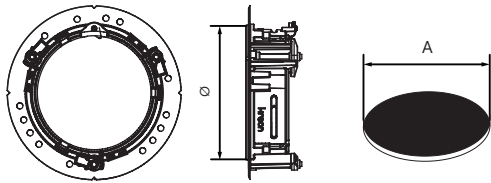

name	reference	visible Ø	cut out A	B*	C
Holon 80 plasterkit no shadow gap	KR717104	3.15"	Ø 4"	2.36"	**
Holon 80 plasterkit shadow gap	KR717108	3.4"	Ø 4"	2.36"	**

* installation depth B is in case the driver is placed at a distance, and accessible from another location.

** installation depth C is in case the driver has to be pushed through the plasterkit in order to be close to the fixture. The length of the driver determines C as it has to be pushed perpendicular through the plasterkit.

Depth = length of the driver + 1.18"

If the length of the driver is e.g. 4" then C = 5.18"

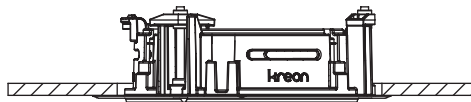
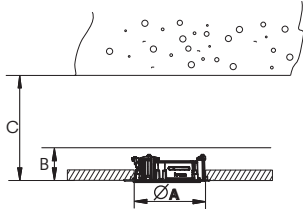

Put the plasterkit in the hole in the ceiling

Fix the plasterkit with screws

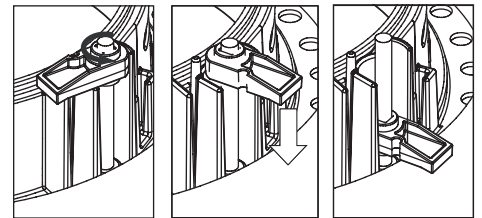

Fix the stoppers, until they are blocked against the ceiling

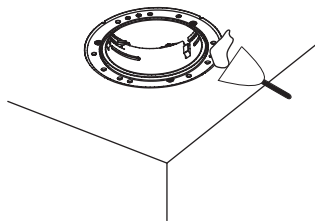

Fill around perimeter of plasterkit using suitable filler and plaster to hide screws and plasterkit.

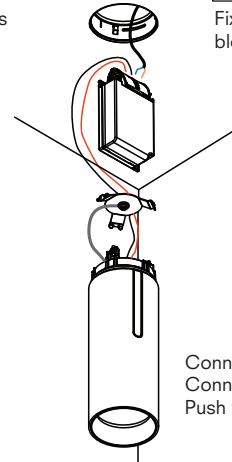
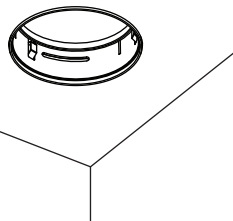

Connect the mains voltage to the gear.
Connect the cables coming from the fixture to the gear.
Push the gear through the plasterkit onto the ceiling.

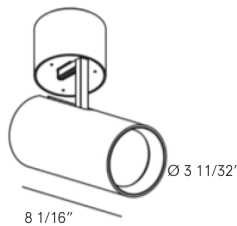

Holon 80 Directional Surface Mounted

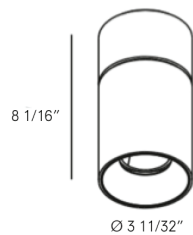

Holon 80 Fixed

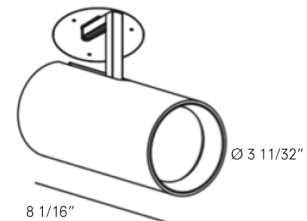

Holon 80 Directional Recessed Mounted

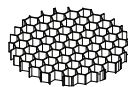

AG: Anti-Glare louver

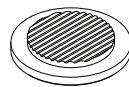

SL: Sculpture Lens

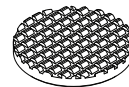

DL: Diffusing Lens



Holon luminaires are ETL listed for dry or damp locations.
Holon luminaires lend support for LEED credits and certification.