

Date: _____ Customer: _____

Project: _____

Type: _____ Qty: _____



Cana, creating rhythms and patterns.

kreon cana is a minimal architectural lighting channel that can be equipped with a wide range of LED luminaires. When recessed, kreon cana in white gives depth to ceiling planes whilst kreon cana in black provides a visible separation or an impression of a void beyond. When surface or pendant mounted, kreon cana provides an architectural beam for lighting integration.



kreon cana 80 is offered in three widths and can accommodate kreon holon circular, kreon prologe square semi-recessed spotlights, kreon holon surface spotlights, and kreon ligna continuous lines of light. The wide choice of luminaires can be mixed and arranged to suit the various demands and present illumination where it is required.

Any combination of light modules can be specified in a made to measure channel creating a unique installation for every project. Channel runs are delivered pre-assembled for ease of installation on site guaranteeing the finished product is exactly as designed.

Cana 80 Tools of Light (other options available. See Ordering Options section for full range)

Construction

Linear Profile & Cover Plate – Made from extruded aluminum

Cana 80 Luminaires – Made from die cast aluminum alloy. Integrated optic

Finishes for Cana 80 Linear Profile

Matte black or white powder coated vertical run with matte black or white cover plate.

Finishes for Cana 80 Linear Channel and Luminaires

- White (RAL 9016)
- Black (RAL 9004)
- RAL color finish on request

Mounting Options

Recessed, surface, or pendant mounted



Holon 80 Single and Holon 80 Directional in-Cana recessed

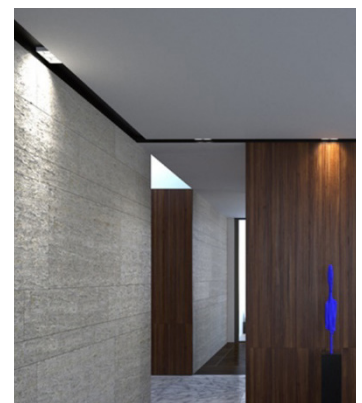

Prologe 80 twin in-Cana recessed

Electrical Characteristics

LED Specification
Cana 80 Luminaires — Xicato Zhaga compliant LED module with Corrected Cold Phosphor Technology® and remote phosphor to limit color shift over time. Tight color consistency within 1x2 MacAdam Ellipses.

For Warm Dim, Tunable White and Full Color Tunable Options
 Lumenetix Araya 5 LED module - 5 color chip array

to stabilize coloring across full spectrum, with all 1640-8000K whites occurring fully on black body curve, maintaining 95CRI or better. Tight color consistency with Max 2 SSD.

LED Life – L80 greater than 50,000 hours.

Correlated Color Temperature (CCT)

Available in 2700K, 3000K, 3500K and 4000K, Warm Dim range 1800K-3000K, tunable white range 1650K-8000K, and fully saturated color with color tunable option.

CRI 85+, 95+, 98+

Gear

Standard 0-10V dimming, universal voltage (120-277V), or TRIAC phase dimming (120V only). For non-dimming applications, cap off dimming wires. Additional dimming options available. See ordering codes for full list of options. Some lighting elements require different circuits.

Ordering Codes and Options

The Cana 80 linear system offers the designer incredible flexibility to combine single, double, round, square, or mono-point luminaires in virtually any configuration imaginable within an architecturally detailed recessed channel system. Cana systems are made to order for each project. To customize each run, please use the configuration sequence below. Configurations can be remodeled in the field without removing the recessed channel, but may require additional components from Kreon.

The Cana 80 series is made to measure and suit many architectural needs. Each run will consist of a linear aluminum profile/channel, and different types of lighting elements. To place an order, please follow these steps to specify each unique run or type. First choose the channel details (length, finish color, mounting condition, etc), then select details for each lighting element you want to specify. Transfer individual codes to section at bottom for final specification. Lighting configuration determined via shop drawings.

Cana 80 Channel Options

Combine with ordering codes for lighting elements on pages 3-4. Write down your choices on the grey boxes.

KUCANA -	80 -	___ -	___ -	___ -	___ -	___ -	___ -	___ -	___ -
KREON CANA LINEAR SYSTEM	APERTURE SIZE	CHANNEL LENGTH (IN)	CHANNEL FINISH*	CHANNEL FACEPLATE FINISH	FIXTURE FINISH	MOUNTING OPTION	CEILING TYPE	DIMMING	NUMBER OF CIRCUITS
	80 mm (internal) ~4" outer dimension	Channel length in inches. Use three numbers, for example, 92 inches would be 092. (Consult factory for increments smaller than 1")	1 – White 2 – Black Finish color for vertical panels and exterior (if visible).	IC1 – White IC2 – Black	F1 – White F2 – Black	RN – Recessed, no flange SF – Surface Mounted	DW – Drywall/ sheetrock (trimless installation) GR – ACT panels with grid ceiling OT – Other, please consult factory	D1 – Triac Phase Dim (120V only) D2 – 0-10V dim (10%) (120V – 277V) D2LD – 0-10V dim (1%) (120-277V) D3 – Lutron Hi-Lume 1% dim (consult factory for 2-wire, 3-wire, or digital control) D4 – EldoLED 0% Dim to Dark (multiple circuits per run possible)	Number of circuits or switch groups for this run
KUCANA -	80 -	___ -	___ -	___ -	___ -	___ -	___ -	___ -	___ -

*Consult factory for custom RAL finish color options.

System available with 90 degree or custom corner segments. Consult factory for details and configuration





Cana luminaires are ETL Listed for dry and damp locations.
Cana luminaires lend support for LEED credits and certification.

Lighting Element Ordering Codes

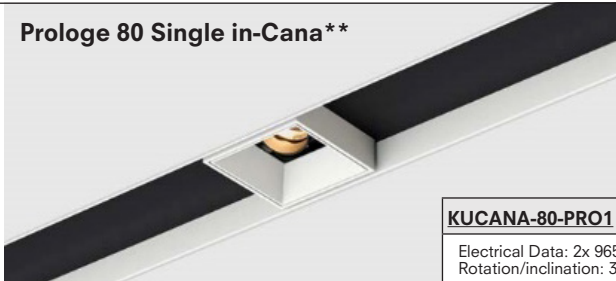
Combine with ordering codes for linear segments on page 2. Write down your choices on the grey boxes.

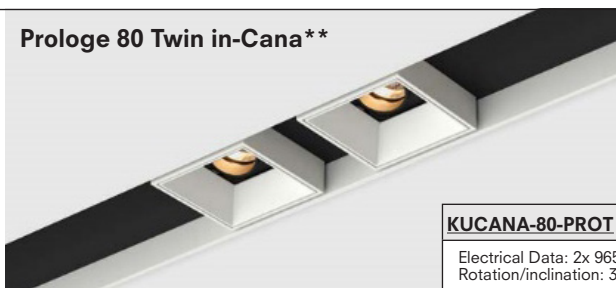
	FINISH COLOR	CCT	CRI (MIN)	BEAM ANGLE	QUANTITY PER RUN	ACCESSORIES
	WHT BLK 27 2700K 30 3000K 35 3500K 40 4000K WD warm dim TW tunable white CT full color tunable	27 2700K 30 3000K 35 3500K 40 4000K WD warm dim TW tunable white CT full color tunable	85 95 ** 98	SP 16° NR 28° FL 36°	(Write down desired number of fixtures per run)	AG Hexagonal AGL Anti-Glare Louver DL Diffusing Lens SC Sculptured Lens
KUCANA-80-PRO1						
Electrical Data: 2x 965 lm @ 2x 11W (2x 700 lm @ 2x 11W for 98+ CRI) • Minimum Spacing*: 13" on center Rotation/inclination: 360°/30° • Size: 3 1/3" x 3 1/3" • ** 95 CRI for WD, TW, CT options only.						

	FINISH COLOR	CCT	CRI (MIN)	BEAM ANGLE	QUANTITY PER RUN	ACCESSORIES
	WHT BLK 27 2700K 30 3000K 35 3500K 40 4000K WD warm dim TW tunable white CT full color tunable	27 2700K 30 3000K 35 3500K 40 4000K WD warm dim TW tunable white CT full color tunable	85 95 ** 98	SP 16° NR 28° FL 36°	(Write down desired number of fixtures per run)	AG Hexagonal AGL Anti-Glare Louver DL Diffusing Lens SC Sculptured Lens
KUCANA-80-PROT						
Electrical Data: 2x 965 lm @ 2x 11W (2x 700 lm @ 2x 11W for 98+ CRI) • Minimum Spacing*: 8" on center Rotation/inclination: 360°/30° • Size: 3 1/3" x 7 1/2" • ** 95 CRI for WD, TW, CT options only.						

	FINISH COLOR	CCT	CRI (MIN)	BEAM ANGLE	QUANTITY PER RUN	ACCESSORIES
	WHT BLK 27 2700K 30 3000K 35 3500K 40 4000K WD warm dim TW tunable white CT full color tunable	27 2700K 30 3000K 35 3500K 40 4000K WD warm dim TW tunable white CT full color tunable	85 95 ** 98	SP 16° NR 28° FL 36°	(Write down desired number of fixtures per run)	AG Hexagonal AGL Anti-Glare Louver DL Diffusing Lens SC Sculptured Lens
KUCANA-80-HOL1						
Electrical Data: 965 lm @ 11W (700 lm @ 2x 11W for 98+ CRI) • Minimum Spacing*: 6.5" on center Rotation/inclination: 360°/30° • Size: 3 1/3" diameter • ** 95 CRI for WD, TW, CT options only.						

	FINISH COLOR	CCT	CRI (MIN)	BEAM ANGLE	QUANTITY PER RUN	ACCESSORIES
	WHT BLK 27 2700K 30 3000K 35 3500K 40 4000K WD warm dim TW tunable white CT full color tunable	27 2700K 30 3000K 35 3500K 40 4000K WD warm dim TW tunable white CT full color tunable	85 95 ** 98	SP 16° NR 28° FL 36°	(Write down desired number of fixtures per run)	AG Hexagonal AGL Anti-Glare Louver DL Diffusing Lens SC Sculptured Lens
KUCANA-80-HOLT						
Electrical Data: 2x 965 lm @ 2x 11W (700 lm @ 2x 700lm @ 2x 11W for 98+ CRI) • Minimum Spacing*: 13" on center Rotation/inclination: 360°/30° • Size: 3 1/3" x 7 1/2" diameter • ** 95 CRI for WD, TW, CT options only.						



Cana luminaires are ETL Listed for dry and damp locations.
 Cana luminaires lend support for LEED credits and certification.

Lighting Element Ordering Codes

Combine with ordering codes for linear segments on page 2. Write down your choices on the grey boxes.

Holon 80 Directional in-Cana**	FINISH COLOR	CCT	CRI (MIN)	BEAM ANGLE	LUMEN SOURCE	QUANTITY PER RUN	ACCESSORIES
	WHT	27 2700K	85	SP 16°	SO 130 / 965lm (15W)	(Write down desired number of fixtures per run)	AG Hexagonal AGL Anti-Glare Louver DL Diffusing Lens SC Sculptured Lens
BLK	30 3000K	95* *	NR 28°	MO 200 / 1560lm (15W)			
	35 3500K	98	FL 36°	HO 3000 / 2200lm (30W)			
WD	warm dim						
TW	tunable white						
CT	full color tunable						
KUCANA-80-HOLD _____							
Electrical Data: 850 lm @ 9W (650 lm @ 9W for 90+ CRI) • Minimum Spacing*: 4" on center • Rotation/inclination: 355°/90° • Size: 3 1/3" dia x 8" H • ** WD, TW, CT options - SO and MO only. 95 CRI Max.							

Ligna 80 in-Cana	LENGTH	CCT	CRI (MIN)	QUANTITY PER RUN
	012 1 foot	27 2700K	85	SO 130 / 965lm (15W) MO 200 / 1560lm (15W) HO 3000 / 2200lm (30W)
024 2 foot	30 3000K	95* *		
--- 1 ft	35 3500K	98		
--- incr	40 4000K			
	WD warm dim			
	TW tunable white			
	CT full color tunable			
KUCANA-80-LIG _____				
Electrical Data: 850 lm @ 9W (650 lm @ 9W for 90+ CRI) Avail in increments of 1ft • ** For WD, TW & CT options : 1,000LM/FT @ 10W/FT for 95 CRI. Avail. in 11", 22" or 24" increments.				

Lighting Elements Ordering Codes Summary (leave blank if not used)

Prologe 80 Single in-Cana:	KUCANA-80-PRO1 -	_____ - _____ - _____ - _____ - _____ - _____
Prologe 80 Twin in-Cana	KUCANA-80-PROT -	_____ - _____ - _____ - _____ - _____ - _____
Holon 80 Single in-Cana	KUCANA-80-HOL1 -	_____ - _____ - _____ - _____ - _____ - _____
Holon 80 Twin in-Cana	KUCANA-80-HOLT -	_____ - _____ - _____ - _____ - _____ - _____
Holon 80 Directional in-Cana	KUCANA-80-HOLD -	_____ - _____ - _____ - _____ - _____ - _____
Ligna 80 in-Cana	KUCANA-80-LIG -	_____ - _____ - _____ - _____ - _____ - _____

* The minimum module spacing is the minimum center distance to the next in-Cana 80 module.

Holon 80 accessories: **AG – Hexagonal Anti-Glare Louver

DL – Diffusing Lens

SC – Sculpture Lens

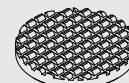
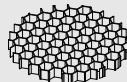

Cana luminaires are ETL Listed for dry and damp locations. Cana luminaires lend support for LEED credits and certification.

Construction



Black Prologe 80 in-Cana single in lack recessed mounted profile



White Holon 80 in-Cana single in hite recessed mounted profile

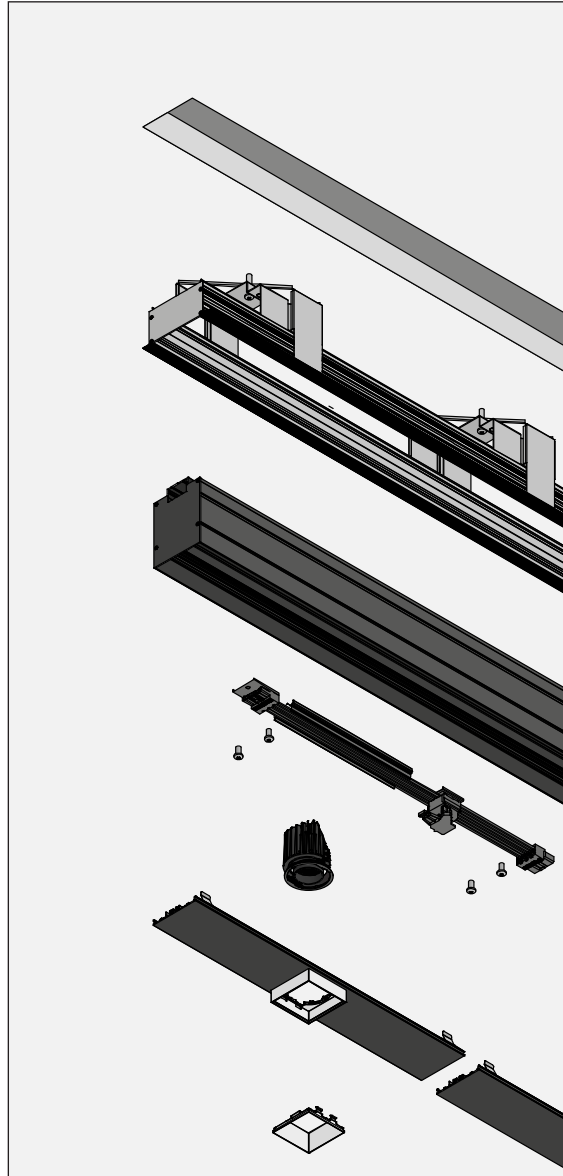

Schematic representation of assembly Prologe 80 single in-Cana: plasterkit + luminaire + louvre

cana 80 surface mounted profile

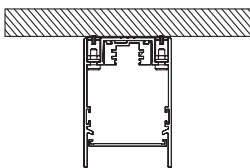

cana 80 recessed mounted profile

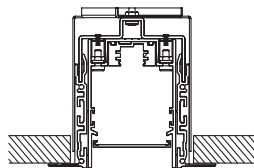

Cana Surface Mount Profile

L x W x H

L x 4" x 5 1/2"



Cana luminaires are ETL Listed for dry and damp locations. Cana luminaires lend support for LEED credits and certification.