

WMA9U/WMA9D

CONTEMPORARY WALL MOUNT ARM

DATE:	LOCATION:
TYPE:	PROJECT:
CATALOG #:	

AAL ARMS

SPECIFICATIONS

CONSTRUCTION

- The arm shall be of one piece unitized aluminum construction, fully welded and assembled. The back plate shall be one piece cast aluminum. The arm shall be prewired with a quick connector for easy installation.
- The arm shall have a cast aluminum fitter welded to the top of the arm(s) for attaching the fixture. The fixture shall be mounted with three stainless steel bolts through the top of the arm fitter into the fixture. The attachment point shall have a silicone pad for sealing the fixture to arm connection.
- Mounting hardware and J-box by others.
- NOTE: Fixture type and mounting orientation will determine size of arm tail



ORDERING GUIDE

CATALOG # **Example: WMA9D-BLT**

HOUSING

Arm		Color	
WMA9U	Weight: 8 lbs.	BLS	Black Gloss Smooth
WMA9D	Weight: 6 lbs.	BLT	Black Matte Textured
		DBS	Dark Bronze Gloss Smooth
		DBT	Dark Bronze Matte Textured
		GTT	Graphite Matte Textured
		LGS	Light Grey Gloss Smooth
		LGT	Light Grey Matte Textured
		PSS	Platinum Silver Gloss Smooth
		VGT	Verde Green Matte Textured
		WHS	White Gloss Smooth
		WHT	White Matte Textured
		Color Option	
		CC ¹	Custom Color

Notes:

- 1 Consult factory for custom color, marine and corrosive finish

DIMENSIONS

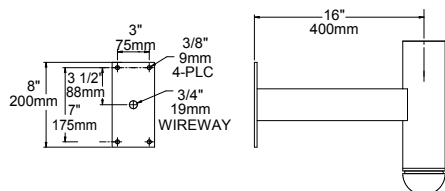

WMA9U

Note: Back plate is welded to the arm.

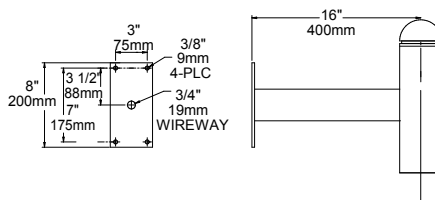

WMA9D

Note: Back plate is welded to the arm.