

UEU-20406

Eurasia 1 Medium Shade Post Top

LIGMAN
LIGHTING USA



41w COB
993 Lumens

IP55
Suitable for wet locations

IK08
Impact Resistant [Vandal Resistant]

EPA - 1.09

Weight - 53.5 lbs

POLE NOT INCLUDED

Construction

Aluminum

Less than 0.1% copper content - Marine Grade 6060 extruded & LM6 Aluminum High Pressure die casting provides excellent mechanical strength, clean detailed product lines and excellent heat dissipation.

Pre paint

8 step degrease and phosphate process that includes deoxidizing and etching as well as a zinc and nickel phosphate process before product painting.

Memory Retentive -Silicon Gasket

Provided with special injection molded "fit for purpose" long life high temperature memory retentive silicon gaskets. Maintains the gaskets exact profile and seal over years of use and compression.

Thermal management

LM6 Aluminum is used for its excellent mechanical strength and thermal dissipation properties in low and high ambient temperatures. The superior thermal heat sink design by Ligman used in conjunction with the driver, controls thermals below critical temperature range to ensure maximum luminous flux output, as well as providing long LED service life and ensuring less than 10% lumen depreciation at 50,000 hours.

Surge Suppression

Standard 10kv surge suppressor provided with all fixtures.

BUG Rating

B1 - U3 - G1

Finishing

All Ligman products go through an extensive finishing process that includes fettling to improve paint adherence.

Paint

UV Stabilized 4.9Mil thick powder coat paint and baked at 200 Deg C. This process ensures that Ligman products can withstand harsh environments. Rated for use in natatoriums.

Hardware

Provided Hardware is Marine grade 316 Stainless steel.

Anti Seize Screw Holes

Tapped holes are infused with a special anti seize compound designed to prevent seizure of threaded connections, due to electrolysis from heat, corrosive atmospheres and moisture.

High Impact Acrylic Lens

Manufactured with Ultra High Impact, Naturally UV Stabilized Injection Molded Acrylic.

Optics & LED

Precise optic design provides exceptional light control and precise distribution of light. LED CRI > 80

Lumen - Maintenance Life

L80 /B10 at 50,000 hours (This means that at least 90% of the LED still achieve 80% of their original flux)

High-visual-comfort post top family. Robust but decorative urban lighting family with perfect glare-controlled lateral light distribution.

A post top decorative lantern with a symmetrical light distribution. Developed to complement the Eurasia range of pillar light, wall light and bollard luminaires using energy saving COB LED lamps.

Designed for various applications including car parks, precincts, pathways and town centers. The luminaire rated as CLASS I with integral driver. Colour temperature 2700K, 3000K, 3500K and 4000K, LED CRI >80 and life time 50,000 Hours. Low copper content die cast housing with high corrosion resistance. Stainless steel screws. Durable silicone rubber gasket and clear impact resistant UV stabilized polycarbonate diffuser.

Housing is treated with a chemical chromated protection before powder coating, ensuring high corrosion resistance. Anodized high purity aluminum reflector.

Additional Options (Consult Factory For Pricing)



A20491
Root Mount Kit

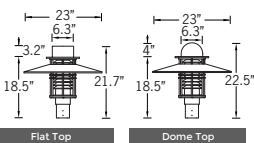
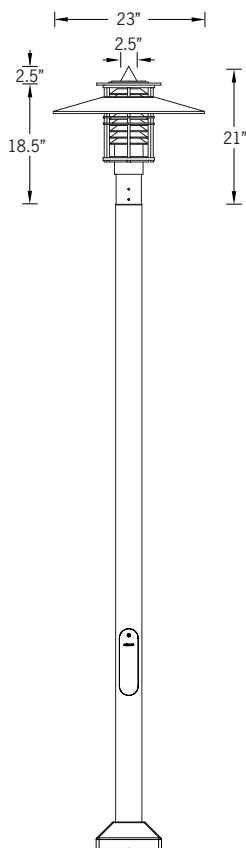

Lantern Detail

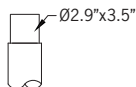

Tenon Detail



PROJECT					DATE	
QUANTITY		TYPE		NOTE		

ORDERING EXAMPLE || UEU - 20406 - 41w - 2 - W30 - 02 - 120/277v - Options

UEU-20406					
	LAMP	TOP	LED COLOR	FINISH COLOR	VOLTAGE
	41w COB 993 Lumens	1 - Dome Top 	W27 - 2700K W30 - 3000K W35 - 3500K W40 - 4000K	01 - BLACK RAL 9011 02 - DARK GREY RAL 7043 03 - WHITE RAL 9003 04 - METALLIC SILVER RAL 9006 05 - MATTE SILVER RAL 9006 06 - LIGMAN BRONZE 07 - CUSTOM RAL	 120/277v Other - Specify
		2 - Flat Top 			
		3 - Pointed Top 			

ADDITIONAL OPTIONS		

DIM - 0-10v Dimming
NAT - Natatorium Rated
A20491 - Root Mount Kit

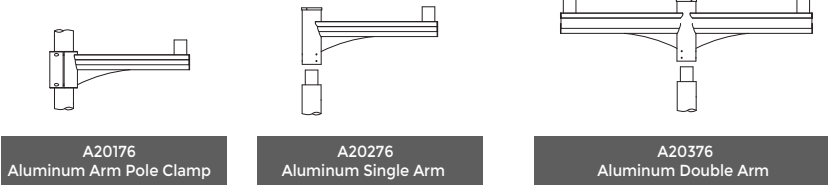

Eurasia Product Family



Eurasia 1

• UEU-30216-41w-991lm



Eurasia 1

• UEU-10016-41w-991lm [37°]
• UEU-10026-41w-991lm [48°]



Eurasia 1

• UEU-20286-41w-991lm



Eurasia 1

• UEU-20406-41w-993lm



Eurasia 2

• UEU-30226-41w-1053lm



Eurasia 2

• UEU-10036-41w-1053lm [37°]
• UEU-10046-41w-1053lm [48°]



Eurasia 2

• UEU-20256-41w-993lm