

ULH-31156

Lightsoft Mini 2 Square Surface

7144 NE Progress Ct | T:503.645.0500
Hillsboro, Oregon 97124 | F:503.645.8100
www.ligmanlightingusa.com



Length 7.5" | Height 12.2" | Weight 6 lbs

IP65 • Suitable For Wet Locations

IK08 • Impact Resistant (Vandal Resistant)

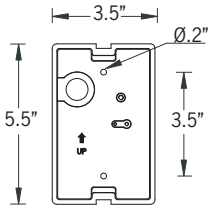
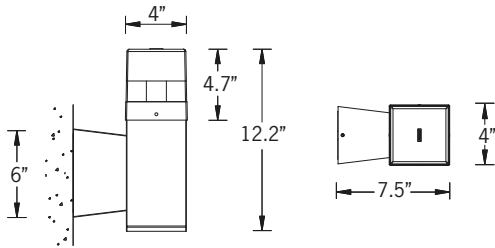

Construction

Aluminum

Less than 0.1% copper content - Marine Grade 6060 extruded & LM6 Aluminum High Pressure die casting provides excellent mechanical strength, clean detailed product lines and excellent heat dissipation.

Pre paint

8 step degrease and phosphate process that includes deoxidizing and etching as well as a zinc and nickel phosphate process before product painting.

Memory Retentive -Silicon Gasket

Provided with special injection molded "fit for purpose" long life high temperature memory retentive silicon gaskets. Maintains the gaskets exact profile and seal over years of use and compression.

Thermal management

LM6 Aluminum is used for its excellent mechanical strength and thermal dissipation properties in low and high ambient temperatures. The superior thermal heat sink design by Ligman used in conjunction with the driver, controls thermals below critical temperature range to ensure maximum luminous flux output, as well as providing long LED service life and ensuring less than 10% lumen depreciation at 50,000 hours.

Surge Suppression

Standard 10kv surge suppressor provided with all fixtures.

BUG Rating

B0 - U2 - G0

Finishing

All Ligman products go through an extensive finishing process that includes fettling to improve paint adherence.

Paint

UV Stabilized 4.9Mil thick powder coat paint and baked at 200 Deg C. This process ensures that Ligman products can withstand harsh environments. Rated for use in natatoriums.

Hardware

Provided Hardware is Marine grade 316 Stainless steel.

Anti Seize Screw Holes

Tapped holes are infused with a special anti seize compound designed to prevent seizure of threaded connections, due to electrolysis from heat, corrosive atmospheres and moisture.

High Impact Acrylic Lens

Manufactured with Ultra High Impact, Naturally UV Stabilized Extruded Acrylic.

Optics & LED

Precise optic design provides exceptional light control and precise distribution of light. LED CRI > 80

Lumen - Maintenance Life

L80 /B10 at 50,000 hours (This means that at least 90% of the LED still achieve 80% of their original flux)

Surface wall-mounted wall decorative family. Hidden-source, perfectly glare free contemporary ambient lighting fixtures.

A decorative range of cylindrical and square shape surface mount wall sconces with a symmetrical light distribution. Developed to complement the Lightsoft, Mini Lightsoft and Lightwave bollard. Integral Designed for lighting of entrances and residential areas by providing wide spread ground illumination on driveways, pathways, squares. The Mini Lightsoft comes standard with a unique waterproof internal driver housing compartment that is situated at the top of the fixture to stop water and dust from entering the electrical components

The innovative reflector technology of the Mini Lightsoft guarantees a high degree of efficiency and optimal visual comfort while fulfilling the dark sky criteria. Mounts over a 3" junction box.

All Ligman fixtures can be manufactured using a special pre-treatment and coating process that ensures the fixture can be installed in natatoriums as well as environments with high concentrations of chlorine or salt and still maintain the 5 year warranty. For this natatorium rated process please specify NAT in options.

Mounting Detail

Lightsoft Product Family



ULH-31146



ULH-10655



ULH-10675



ULH-10573



ULH-10593



ULH-31156

Lightsoft Mini 2 Square Surface

7144 NE Progress Ct | Hillsboro, Oregon 97124 | www.ligmanlightingusa.com
T:503.645.0500 | F:503.645.8100



PROJECT		DATE	
----------------	--	-------------	--

QUANTITY		TYPE		NOTE	
-----------------	--	-------------	--	-------------	--

ORDERING EXAMPLE || ULH - 31156 - 14w - W30 - 02 - 120/277v - Options

LAMP	LED COLOR	FINISH COLOR	VOLTAGE
14w COB 346 Lumens	W27 - 2700K W30 - 3000K W35 - 3500K W40 - 4000K	01 - BLACK RAL 9011 02 - DARK GREY RAL 7043 03 - WHITE RAL 9003 04 - METALLIC SILVER RAL 9006 05 - MATTE SILVER RAL 9006 06 - LIGMAN BRONZE 07 - CUSTOM RAL	120/277v Other - Specify

ADDITIONAL OPTIONS		

- NAT - Natatorium Rated
- 4MP - 4" Mounting Plate
- DIM - 0-10v Dimming

